



अंतरा



Sky is the limit



Geeta Constructions is founded on the dream of building quality homes.  
Our aim is to provide our clients with a modern, spacious and smart home.

Project by :

Sapna & Kunal Mehta

3-BHK

Limited **10** flats at affordable price

Sample flat ready

अंतरंग



## Specification

---

- **Flooring**  
Vitrified Tiles
- **Kitchen**  
Granite Platform With SS Sink & Glazed Tiles Upto Lintel Level
- **Bathrooms**  
Branded Sanitary & Plumbing Fixtures  
Hot & Cold Water Supply In Master Bedroom & Wash Area
- **Doors**  
Main Door - Laminated With Safety Door  
Internal Doors - Wooden Flush Doors
- **Windows**  
Ionised Aluminium Full Height
- **Electric**  
Concealed ISI Copper Wiring With Branded Modular Switches.  
Sufficient Points For All the Appliances.

## Salient Features

---

- CCTV Camera
- Power Back-Up For Common Areas
- Solar Water Heater
- Allotted Car Parking & Two Wheeler Parking
- Auto Door Lift
- Intercom Telephone Systems
- Earthquake Resistant Structure
- Rooftop Activities

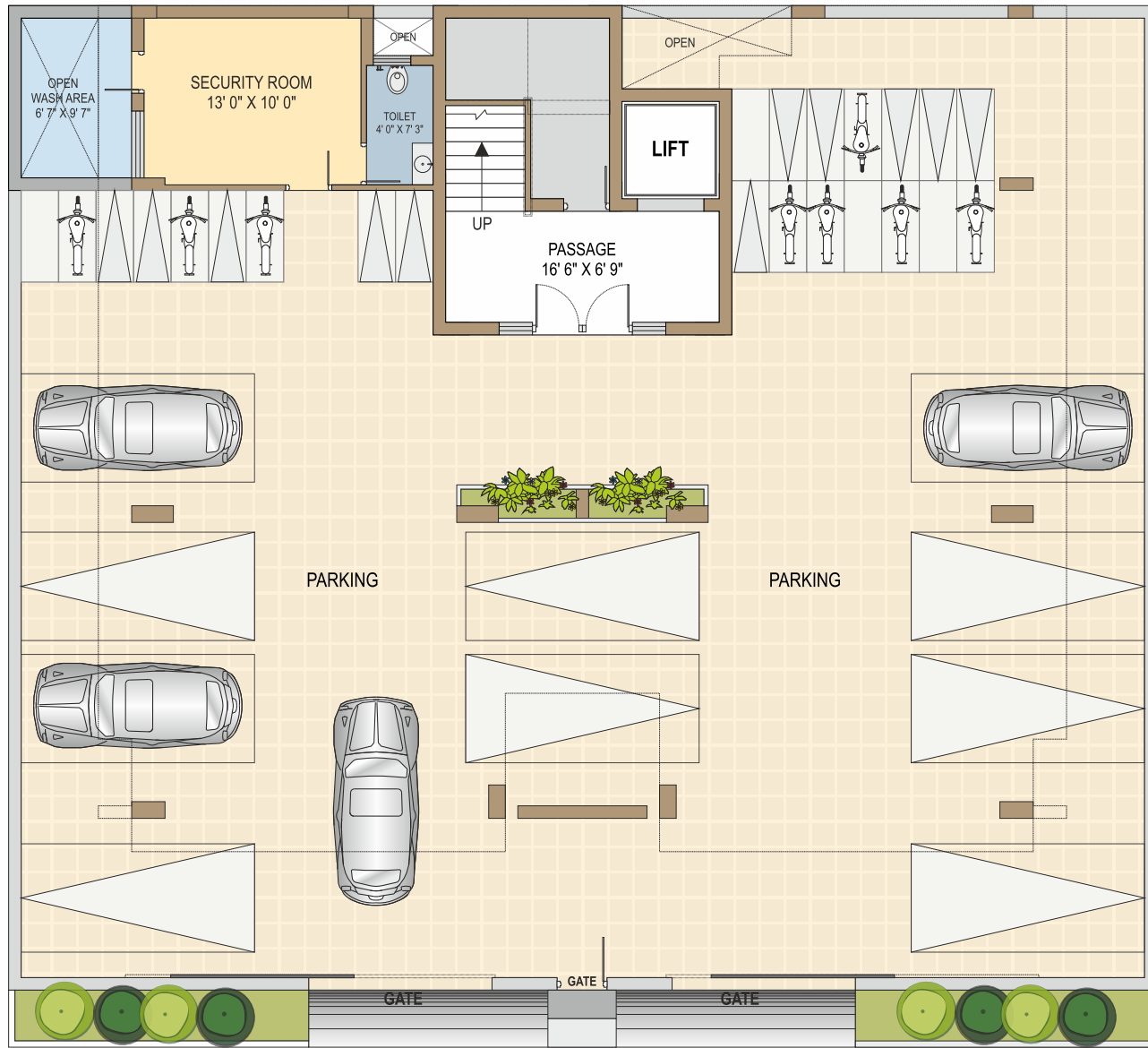

GROUND FLOOR PLAN



TYPICAL FLOOR PLAN





Enjoy all the Connectivities of the City from this Cool, Quite and Serene Environment.





अंतरंग

3-BHK



अंतरंग

3-BHK



अंतरंग

3-BHK



अंतरंग

3-BHK



अंतरंग

3-BHK



अंतरंग

3-BHK





अंबरग

3-BHK



अंतरंग

3-BHK



अंतरंग

3-BHK



अंतरंग

3-BHK



अंतरंग

3-BHK



अंतरंग

3-BHK

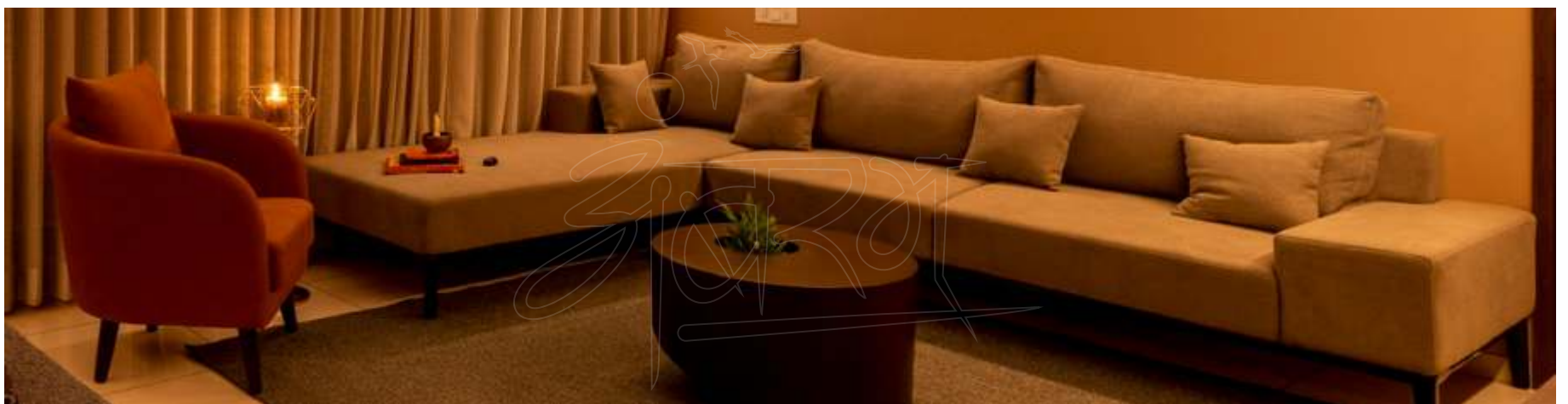

---

Developers :



---

Ask for more detail

**89809 22999**

---

---

Architects :



Structure Eng. :  
**Varun Suchak**

---



---

**DISCLAIMER**

Stamp Duty & Registration charges would be charged extra • GST and any such additional taxes would be charged extra • Maintenance deposit would be charged extra • Internal and external changes would not be permitted • Gas, PGVCL & Water connection charges would be extra.

**Note :**

This brochure is for information purpose only. All the dimension, architectural views and photographs are for reference only.  
This brochure does not form a part of the agreement or any legal document.

---