



iKon-2
TIMELESS LUXURY BUSINESS HUB

B/h. Raj Palace, Sadhu Vasvani Road, Rajkot - 360 005

J-Vision_+91 98248 20030

iKon-2
TIMELESS LUXURY BUSINESS HUB



LAYING
THE **BUILDING BLOCKS**
FOR NEW **OPPORTUNITIES**
AND A BRIGHTER
FUTURE



SAY HELLO TO NEW POSSIBILITIES

Welcome to the future of expansion and opportunities. A one stop solution to growth and new avenues that will guide you towards success.

Changing lives,
with changing times



A sanctuary of success



MARKING **THE BEGINNING**
OF SOMETHING NEW,
SOMETHING **DIFFERENT**
& **UNFORGETTABLE.**

A vision of the future – encompassed in a space.
Find yourself surrounded in benefits of amenities galore.

ikon-2
TIMELESS LUXURY BUSINESS HUB

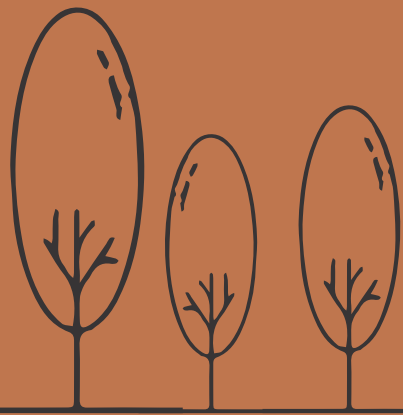

YOUR CHOICE FROM TODAY,
FOR YOUR SUCCESS OF TOMORROW

In this fast-changing world, it is important to make the right choices that represent your stature, talent, hard work and determination. It will be these choices that determine the success you find in all your tomorrows.

Infinite possibilities



The time to shine



A LEAP OF FAITH, WITH A SAFE LANDING

Often it is the risk-takers that reap the most benefits. With the freedom, space and safety we provide you – even taking risks will be a comfortable experience.

The sky is the limit



Success shall follow

iKon-2
TIMELESS LUXURY BUSINESS HUB





A SET UP TO SUCCESS
Allow our amenities to take care of you while you only take care of your business. As you fly, we will be runway to your dreams.

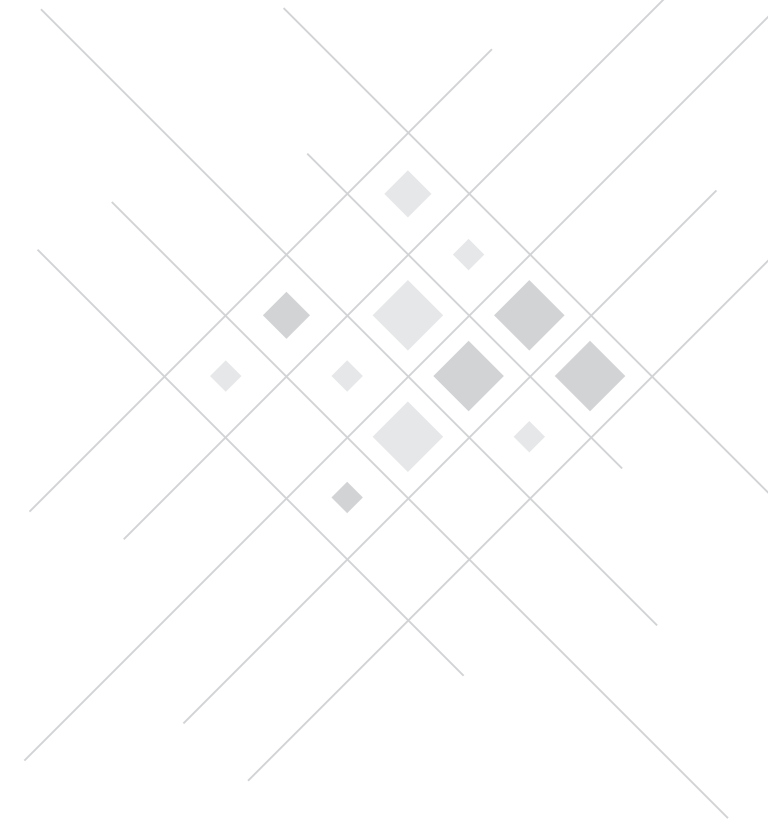

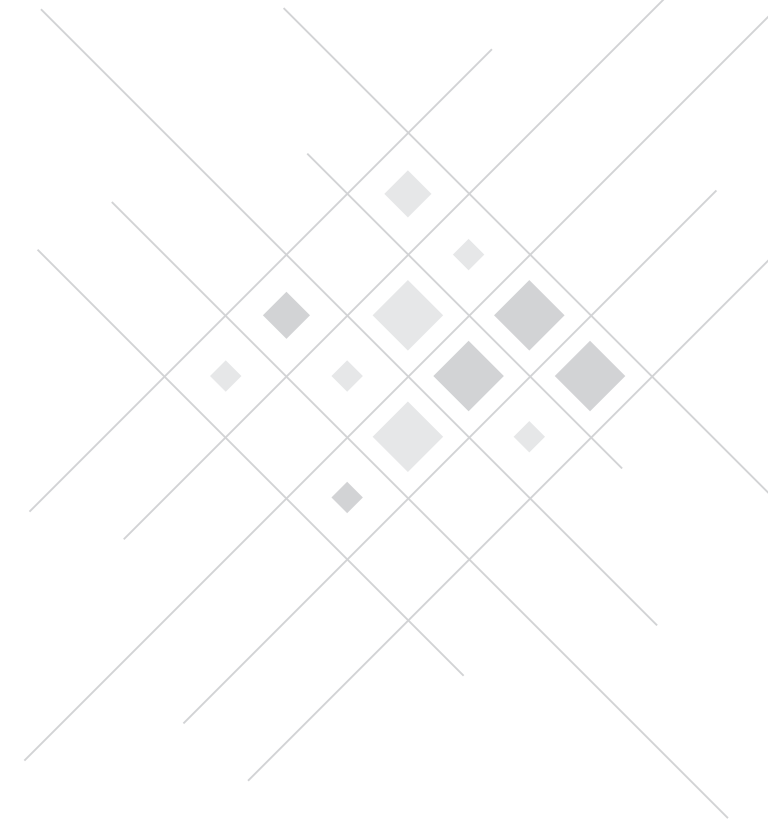

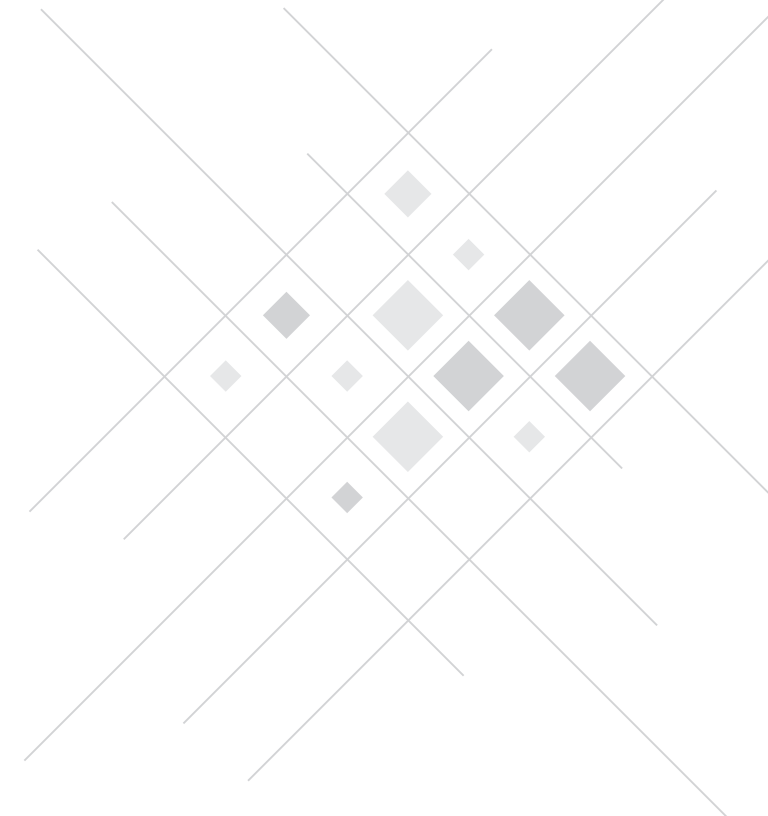

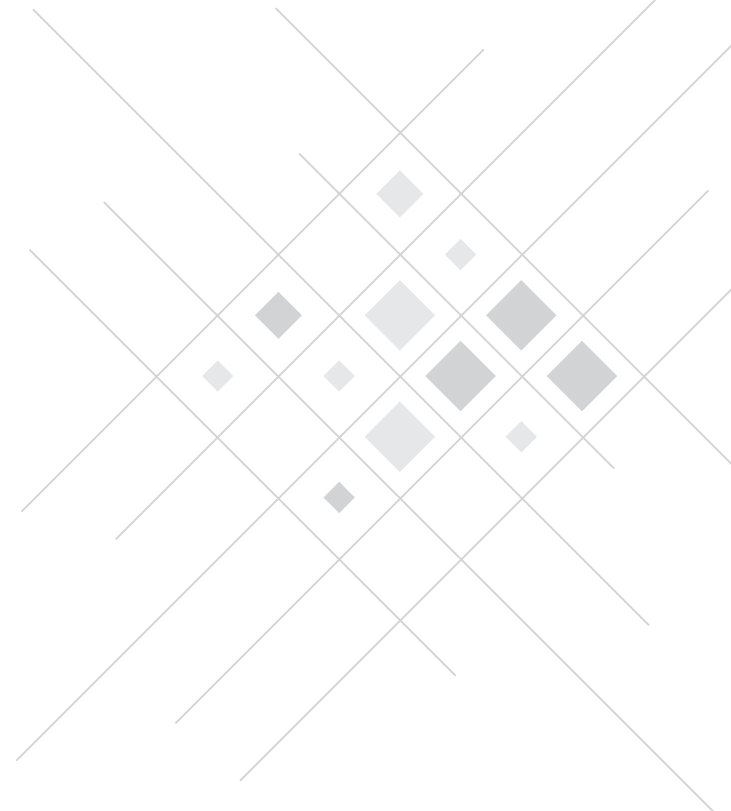
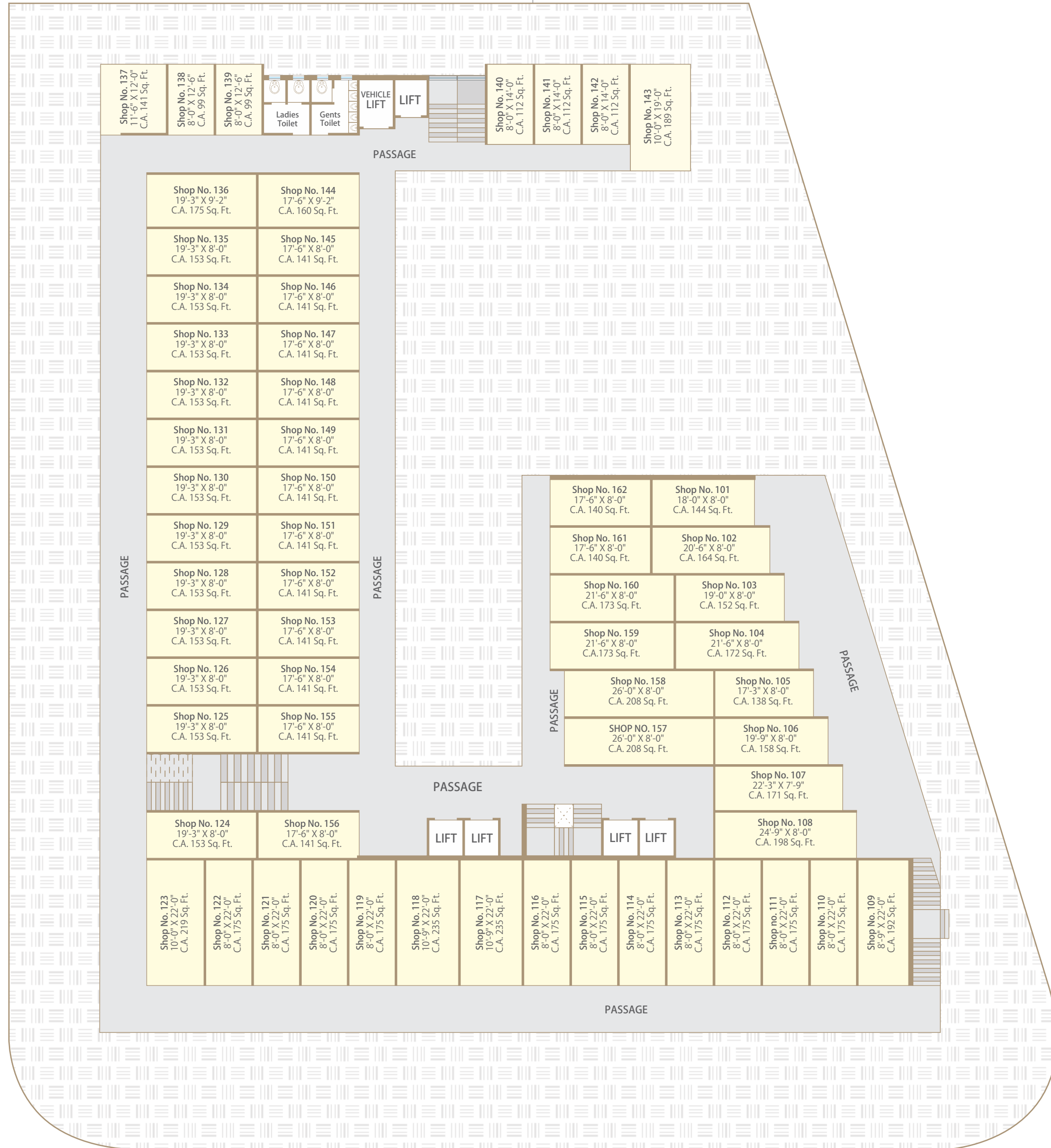

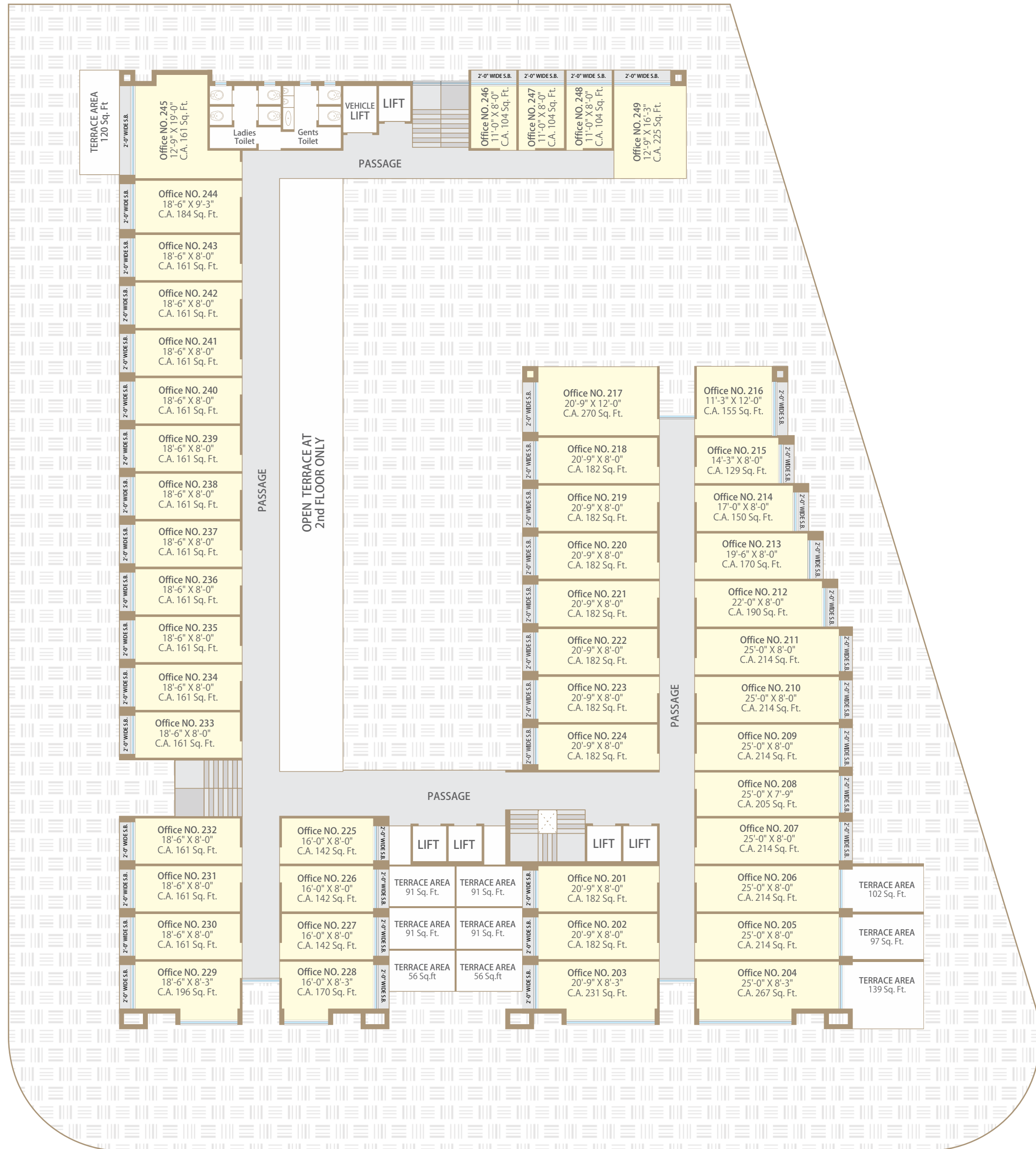

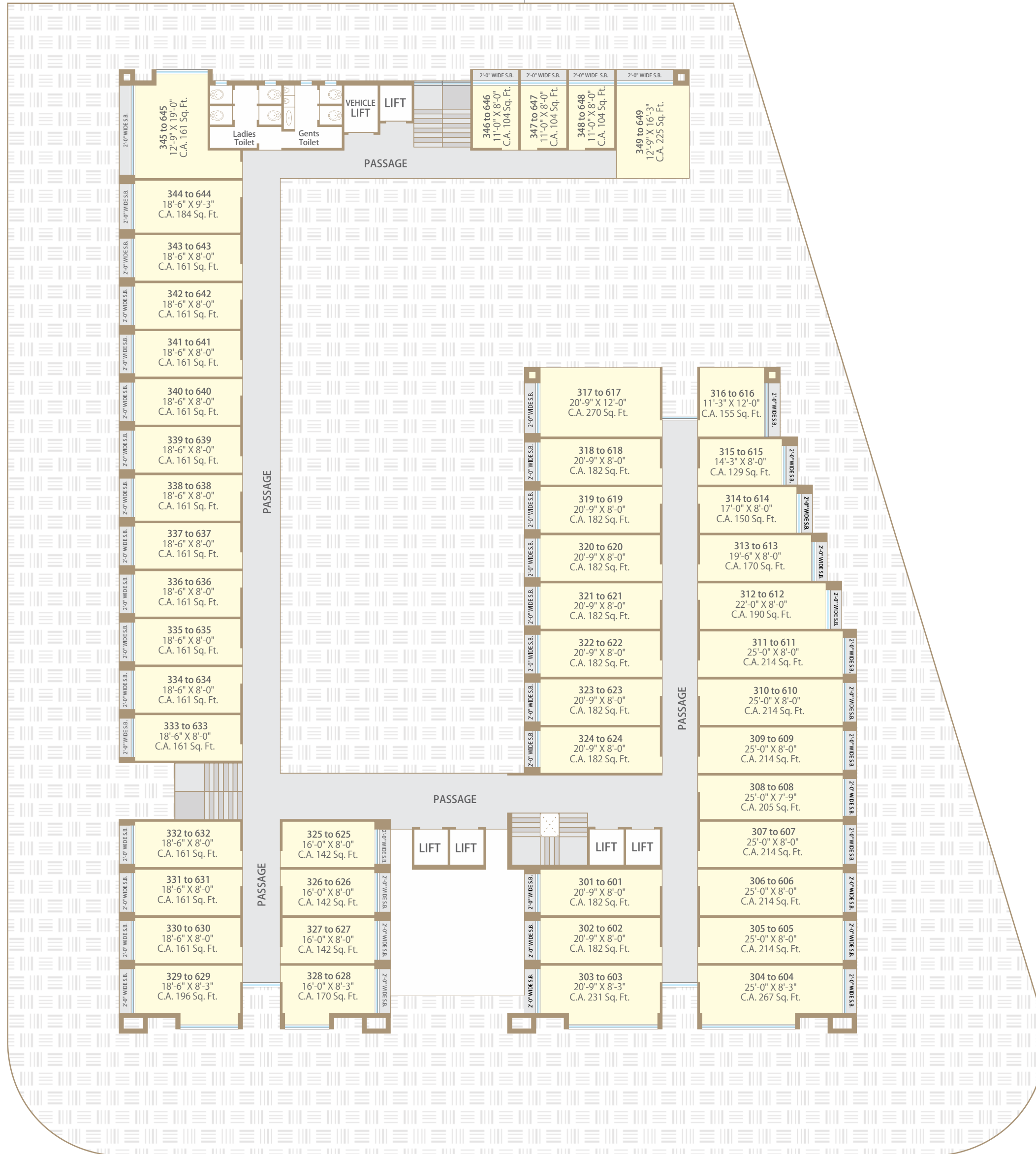

TYPICAL
3rd to 6th FLOOR PLAN

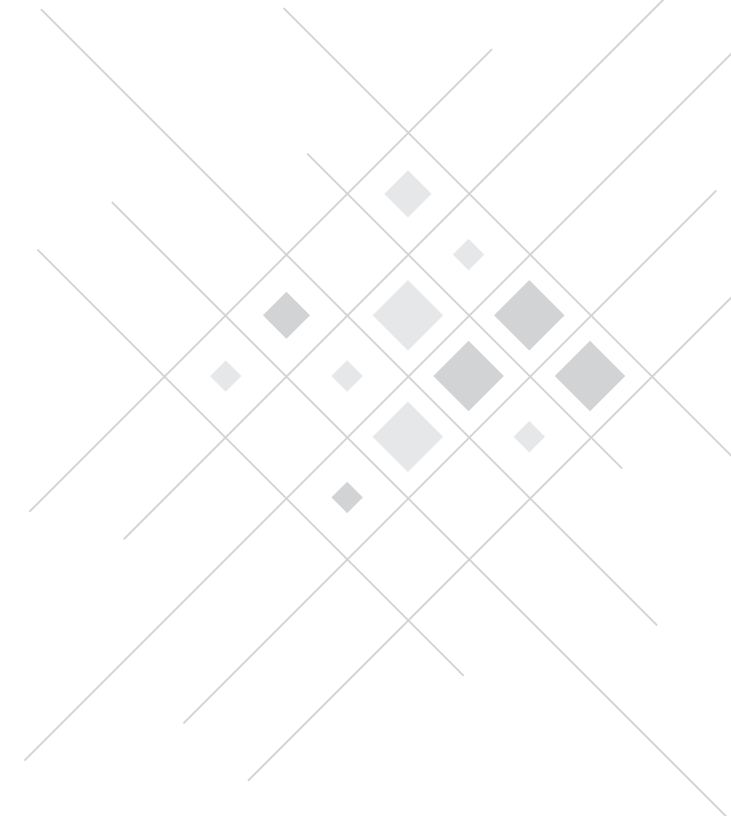
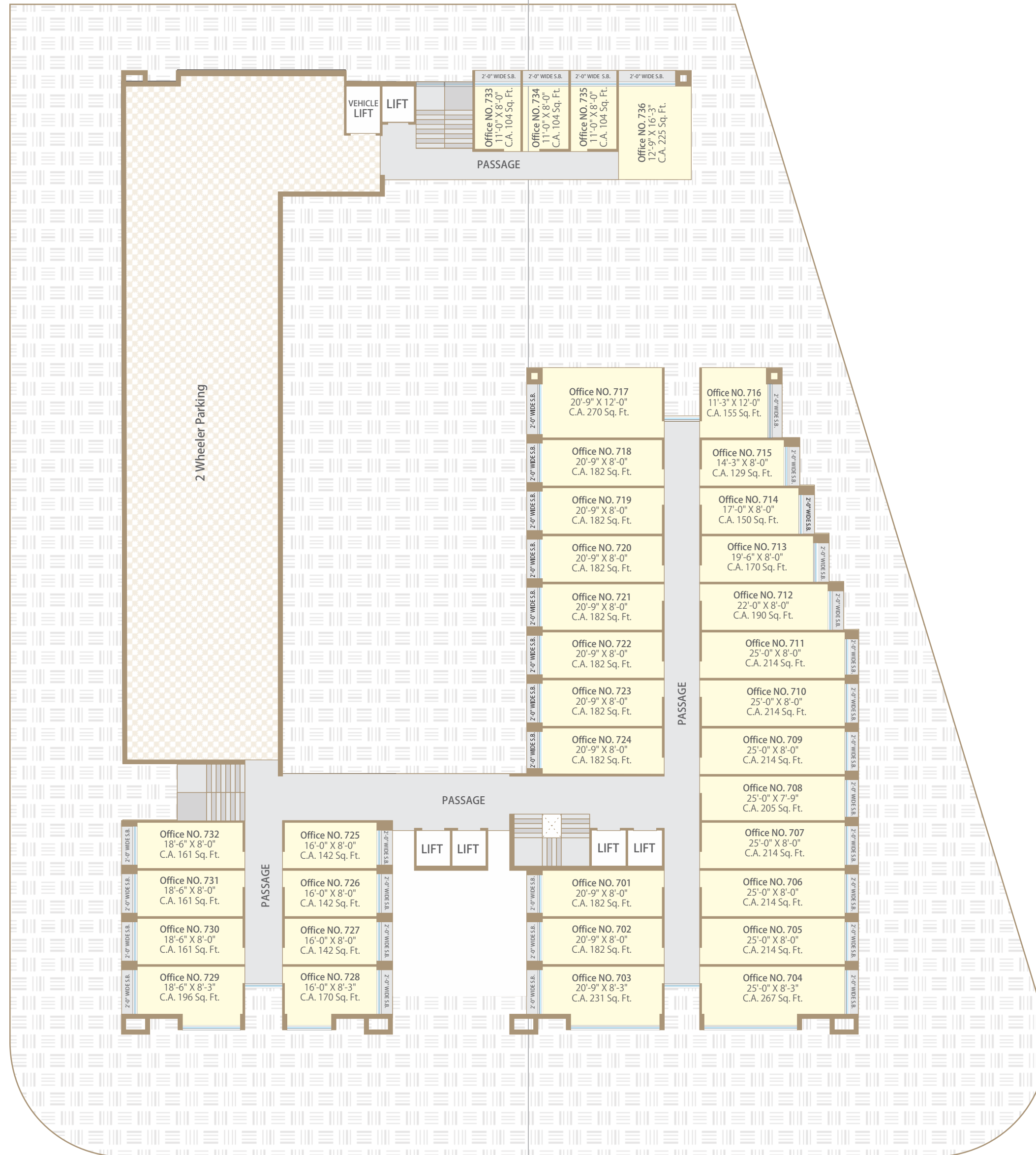



SHOP

SHOP

SHOP SHOP SHOP SHOP
SHOP SHOP SHOP

A NEW SPACE FOR A NEW TIME

For there to be growth, there has to be the special ingredient of the right environment. Ikon 2 is the perfect environment to kick start your business or take it to another level at a rapid rate. The placement of our structure in the developing area of the city will help boost your presence and persona as a business.

Making connections



A space to grow



AND THE REST IS HISTORY

As you take the first step towards the rest of your life, we assure you that new opportunities are right around the corner. Time to rise to the occasion and catch every opportunity that comes your way with confidence.

A step towards the future



Your key to new horizons





SECURITY
24x7 Security • CCTV camera



GENERATOR
For lift & common light



STRUCTURE
Earthquake resistance R.C.C. frame structure design as per I.S. code



LIFT
Standard 2 auto door lift

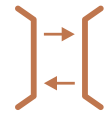

LOBBY
Magnificent entrance and lobby



AIR CONDITIONER
Provision of drainage pipe for A.C. & special provision for outdoor unit



FLOORING
Standard vitrified flooring



ELECTRIFICATION
Concealed electrification with sufficient point with modular switches



SOLAR ROOF
Solar roof for common lights



PARKING
Surface + two level basement parking



LOCATION MAP

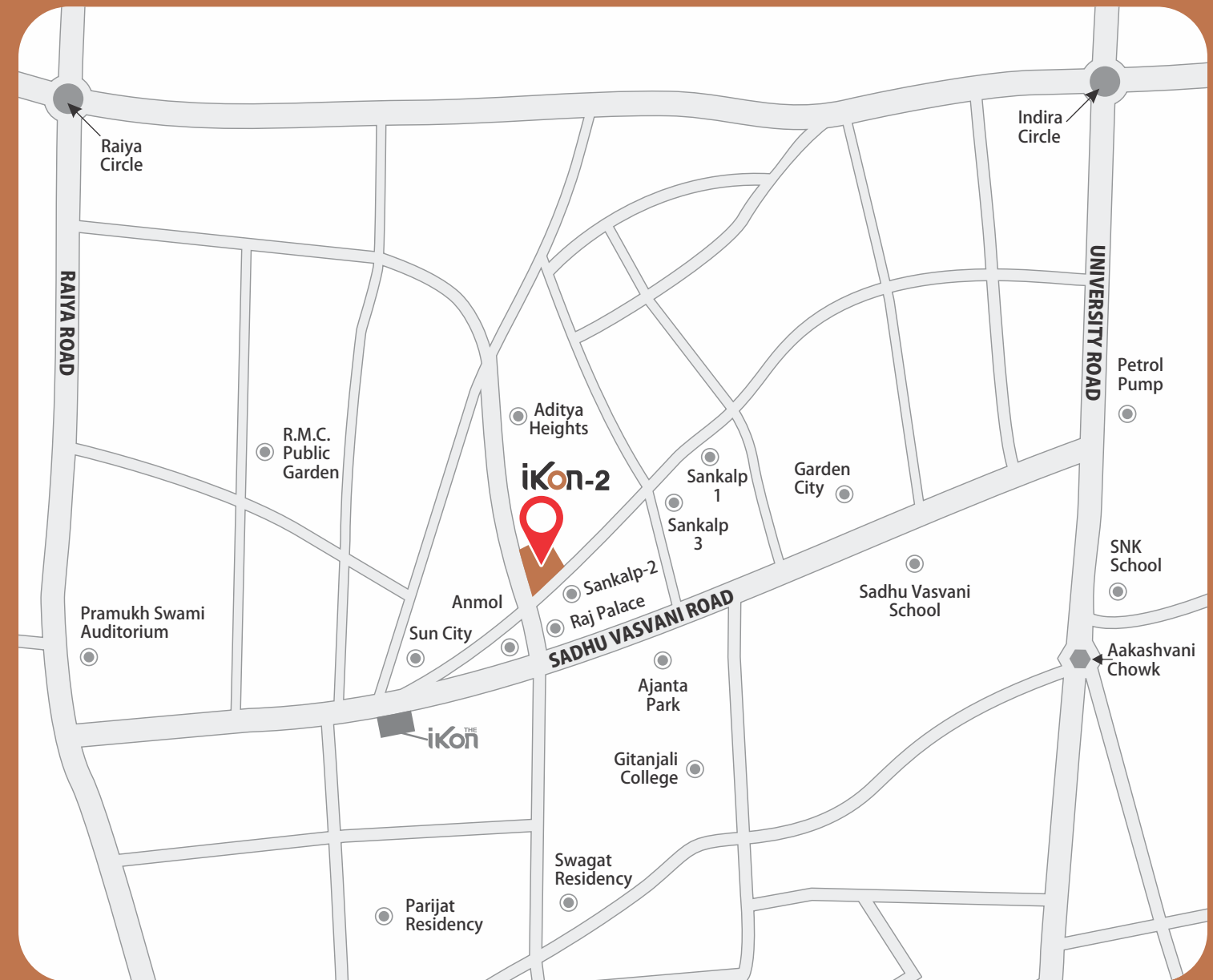

SITE ADDRESS : IKON-2, B/h. Raj Palace, Sadhu Vasvani Road, Rajkot.

PROFESSIONAL TEAM :

PROJECT :
Saptak Developers

ARCHITECT :
Vipul Patel

BOOKING CONTACT :
Piyush Raninga +91 98987 33377
Rahil Vadodariya +91 99796 99299
Krishna Dhakan +91 98985 53553

LEGAL ADVISOR :
Pramey Sonecha

STRUCTURE ENGINEER :
Ashwin Lodhiya



DISCLAIMER :

- Stamp duty & registration charges would be charged extra.
- GST and other additional taxes would be charged extra.
- Maintenance deposit, PGVCL and solar roof top charges would be charged extra.
- External changes would not be permitted.
- All shops, show rooms, office holder will have to be member of AOP compulsory.
- Subject to rajkot jurisdiction

NOTE :

- This brochure is for information purpose only.
- This drawings and document thereof are only for reference and shall not be considered a part of the legal agreement.
- Pictures of furniture, landscaping, amenities etc. are the creative imagination or architect's impression and actual may vary.
- Project registered under RERA (Real Estate Regulation Act)