







Pearl | 78

Pearl|78



Amenities

-  GOOD QUALITY LIFT
-  DECORATIVE FOYER
-  SENIOR CITIZEN SITTINGS
-  FIRE SAFETY
-  INTERNAL PAVED AREA
-  SECURITY



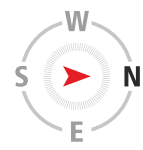

A
BLOCK



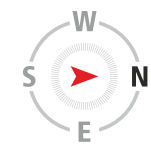
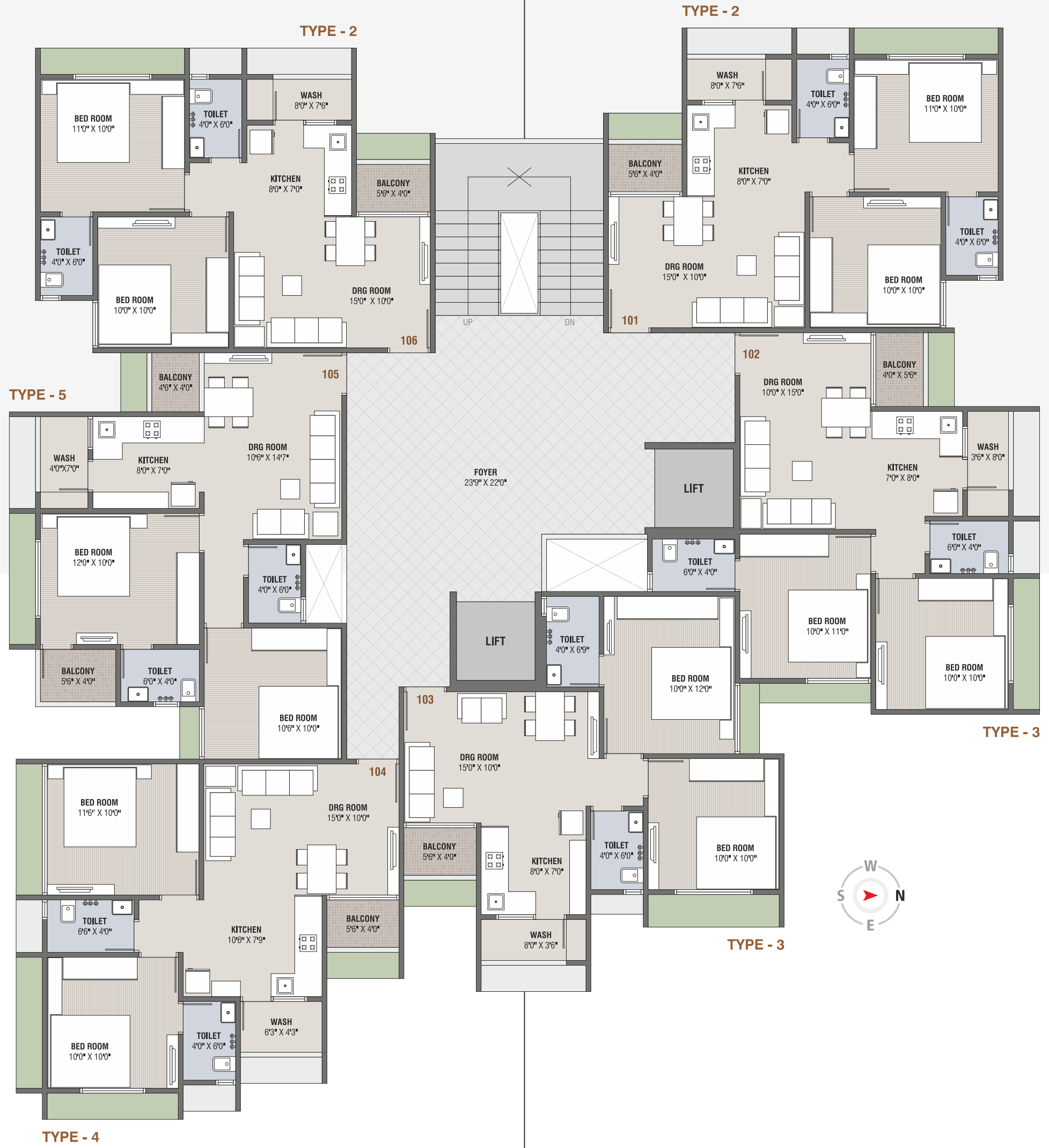

B
BLOCK

Specification

Structure

Earth quake resistance AAC sand base block & Masonry wall.

Wall finish

Internal single coat plaster with white putty & External double coat plaster with Texture and acrylic paint.

Kitchen

Granite top platform with S.S. sink & designer tiles dado up to lintel level.

Flooring

Good quality tiles in entire flat.
China mosaic in terrace for heat reflection.

Electrification

Single phase Concealed copper wiring with modular switches & MCB with sufficient electric points.

Doors & Windows

Decorative main door with wooden frame, all other doors are flush doors.
Powder coated aluminium section sliding windows with plain glass & stone sill.

Toilet & Plumbing

Glazed tiles on flooring & dado up to lintel level. Concealed plumbing with good quality sanitary ware & C.P. fittings.



NOTES ■ All rights are reserved to Developer for any changes in plan & specification. ■ Irregular payment shall cause cancellation of booking. ■ GEB, AUDA, Stamp duty, Legal charges, GST, Other Tax, Labourcess & Initial maintenance contribution will be levied extra. ■ Any additional liabilities due to change in the by laws, Stamp duty, Govt. Laws, shall be borne by member. ■ Change in external elevation shall not be permitted. Internal changes shall be done only with prior permission & shall be charged extra in advance. ■ Details & dimensions in brochure are indicative & for the tentative representation only which should not be treated as legal documents. ■ Possession of the unit shall be given only after full payment.



Pearl | 78

DEVELOPER

PANNA & SONS

BOOKING CONTACT

MO : + 91 97378 55527

MO : + 91 97378 55524

DESIGN BY

RAJESH DARJI

STRUCTURAL ENGINEER

KANHAI ENGINEERS

SITE ADDRESS

PEARL 78

BH. ASHRAY PLATINA, SATATYA AVENUE ROAD,
NEW RANIP, AHMEDABAD.

RERA - PROJECT REGISTRATION NUMBER :

PR / GJ / AHMEDABAD / AHMEDABAD CITY / AUDA / RAA10346 / 220622

Website : www.gujrera.gujarat.gov.in

