



A PROJECT BY



Redefining Your Living Supremely  
ISO 14001:2015 | ISO 9001:2015 | OHSAS 18001:2007

# SHIV SAMARTH-II

3 BHK LUXURIOUS LIFE STYLE

The Destination of  
**ENCHANTMENT...**



# OUR PROJECTS (Completed and Ongoing projects)







## MODERN ARCHITECTURAL

Enjoy the togetherness  
in a natural environment  
made just for you

\* This brochure is only for presentation and easy understanding purposes it cannot make part of any legal agreement from developer.





C

B

D

A

CANAL



# BEST LOCATION

An ideal location, just a few steps and you are in the midst of greenery

\* This brochure is only for presentation and easy understanding purposes it cannot make part of any legal agreement from developer.



A perfect blend of activities and facilities...







\* This brochure is only for presentation and easy understanding purposes it cannot make part of any legal agreement from developer.





CLUB HOUSE

GARDEN

Beautifully designed landscape...  
It's the ideal place outside your house to hang around.

To live a luxurious life in the lap of nature.

\* This brochure is only for presentation and easy understanding purposes it cannot make part of any legal agreement from developer.



# CLUB HOUSE

## CLUB HOUSE

Enhance your life, Lift your spirits up.  
Live a lifestyle you have always dreamt of.

This brochure is only for presentation and easy understanding purposes it cannot make part of any legal agreement from developer.





SPORTS SHOP | JIJAS | KATRA | LEYS | BERRYAN | GARMENT SHOP | RAS TRO

CAFE COFFEE | D & B | CROWN | FASHION | ROLEX | BAK MANU | Rivera | LUNCH | TANISHO | ARCHIVE | NHT WATCH | MUFTKI | HONEY | DREAM | BAKERY | RASTRO

\* This brochure is only for presentation and easy understanding purposes it cannot make part of any legal agreement from developer.





It's time to relish a change-over in your style of living.

\* This brochure is only for presentation and easy understanding purposes it cannot make part of any legal agreement from developer.





# 'D' TOWER

\* This brochure is only for presentation and easy understanding purposes it cannot make part of any legal agreement from developer.





WELL DESIGN ENTRANCE GATE

\* This brochure is only for presentation and easy understanding purposes it cannot make part of any legal agreement from developer.





# KIDS PLAY AREA

\* This brochure is only for presentation and easy understanding purposes it cannot make part of any legal agreement from developer.





\* This brochure is only for presentation and easy understanding purposes it cannot make part of any legal agreement from developer.

ENTRANCE FOYER



## AMENITIES

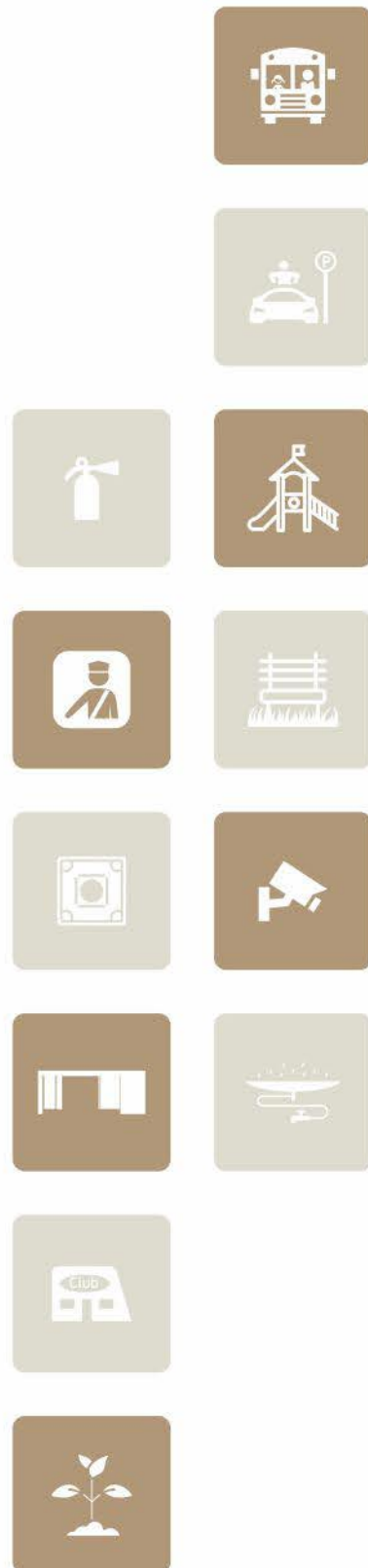

## CAMPUS FEATURES

- GRAND ENTRANCE GATE WITH MODERN DESIGN COMPOUND WALL.
- 24 X 7 GATED SECURITY WITH SECURITY CABIN.
- 1 CAR ALLOTTED PARKING FOR EACH FLAT.
- WELL DESIGNED LANDSCAPE GARDEN.
- DJ SOUND SYSTEM FOR FESTIVAL IN CAMPUS.
- CHILDREN PLAY AREA WITH LATEST EQUIPMENT.
- SENIOR CITIZEN SITTING.
- DROP OUT & PICK UP ZONE.
- PERCOLATING BORE WELL FOR RAIN WATER HARVESTING.
- TREE PLANTATION IN CAMPUS.
- WELL DESIGN LIGHT FITTING FOR COMMON PASSAGE, CAMPUS, GARDEN AND CAR PARKING.

## CLUB HOUSE

- RECEPTION AREA.
- INDOOR GAME.



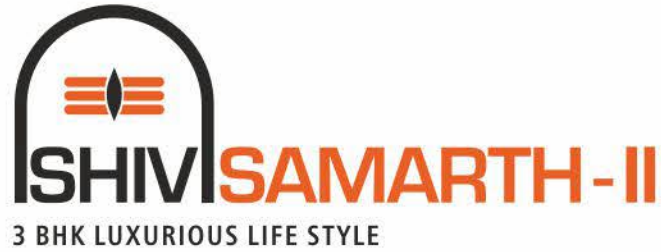

## SPECIFICATION



### BUILDING EXTERNAL SPECIFICATION

- EARTHQUAKE RESISTANT RCC FRAME STRUCTURE DESIGN AS PER NORMS.
- DOUBLE COAT SAND PLASTER ON EXTERNAL WALL.
- TEXTURE ON EXTERNAL WALL WITH PAINT.
- FIRE FIGHTING SYSTEM PROVIDED AS PER NORMS.
- SILENT GENERATOR OF ADEQUATE CAPACITY FOR ELEVATORS, WATER PUMP AND COMMON FACILITIES AND 2 AMP BACK UP IN EACH FLAT.
- CCTV CAMERA COVERAGE IN RECEPTION, CAMPUS AND BASEMENT AREA.
- INTERCOM FACILITY WITH CONNECTIVITY POINT INCLUDING ENTRANCE FOYER TO EACH FLAT, LIFT AND SECURITY CABIN (INSTRUMENT NOT PROVIDE).
- WELL DESIGNED ENTRANCE FOYER AND ELEGANTLY LOBBY AT ALL THE FLOOR.
- WELL DESIGN STAIRCASE & LIFT LOBBY.
- STANDARD QUALITY FULLY AUTOMATIC 2 ELEVATORS PROVIDED TO EACH BUILDINGS.
- S.M.C WATER WITH UNDERGROUND & OVERHEAD WATER TANK WITH ADEQUATE CAPACITY.
- SEPARATE BORE WELL FOR EACH BUILDING.
- DOUBLE COAT WATER PROOFING & CHINA MOSAIC FLOORING FOR HEAT REDUCTION ON TERRACE.
- WELL DESIGNED NAME PLATE AND NOTICE BOARD.
- MS / GI RAILING IN EACH FLATS.

### BUILDING INTERNAL SPECIFICATION

#### FLOORING

- 24" X 48" STANDARD VITRIFIED FLOORING IN LIVING, KITCHEN AND DINING AREA, AND 24" X 24" VITRIFIED FLOORING IN ALL BEDROOM.
- DECK WITH DESIGNER RUSTIC TILES FLOOR.

#### KITCHEN & WASH

- GRANITE (ARTIFICIAL OR NATURAL) PLATFORM WITH STANDARD QUALITY SINK.
- DECORATIVE WALL TILES ON KITCHEN PLATFORM UP TO LINTEL LEVEL.
- KOTA FLOORING AND WALL TILES DADO WITH GRANITE (ARTIFICIAL OR NATURAL) SILL TIP IN WASH AREA.
- ADEQUATE ELECTRICAL, PLUMBING AND RO POINTS PROVISION IN WASH AND KITCHEN AREA.
- PROVIDE GAS CONNECTION (1 POINT IN KITCHEN & 1 POINT FOR GEYSER).

#### TOILET & PLUMBING

- ANTI-SKID TILES FLOORING AND DECORATIVE WALL TILES UP TO LINTEL LEVEL.
- SINGLE LEVER CONCEALED DIVERTER / MIXER WITH SHOWER.
- STANDARD QUALITY SANITARY FITTING.
- STANDARD QUALITY MIXTURE / DIVERTER AND COCK FITTING.
- EUROPEAN WALL HUNG WC IN ALL TOILET.
- CPVC / UPVC PIPING FOR PLUMBING.
- CENTRALLY GEYSER POINT PROVISION IN WASH AREA.

#### ELECTRIFICATION

- STANDARD QUALITY CONCEALED COPPER WIRING WITH SUFFICIENT POINT.
- CONVENIENT PROVISION OF AC, T.V & TELEPHONE POINT IN EACH FLAT.
- PROVIDE MODULAR SWITCHES.

#### DOORS & WINDOWS

- WELL DESIGNED MAIN DOOR WITH WOODEN / G.I / WPC FRAME PROVIDED WITH PREMIUM FITTINGS.
- INTERNAL FLUSH DOOR OR WPC DOOR WITH GRANITE (ARTIFICIAL OR NATURAL) / G.I / WPC / WOODEN FRAME.
- STANDARD HARDWARE FITTING.
- ANODIZED COATED SLIDING ALUMINUM SECTION WINDOWS.
- STANDARD SINGLE VISION REFLECTIVE GLASS FOR HEAT REDUCTION.

#### INTERNAL WALL

- SINGLE COAT PLASTER WALL WITH PUTTY OR GYPSUM FINISHED.



45.00 MT. WIDE ROAD

12.00 MT. WIDE ROAD











**SHIV SAMARTH-II** BUILDING B | C (3rd to 14th floor)  
 3 BHK LUXURIOUS LIFE STYLE

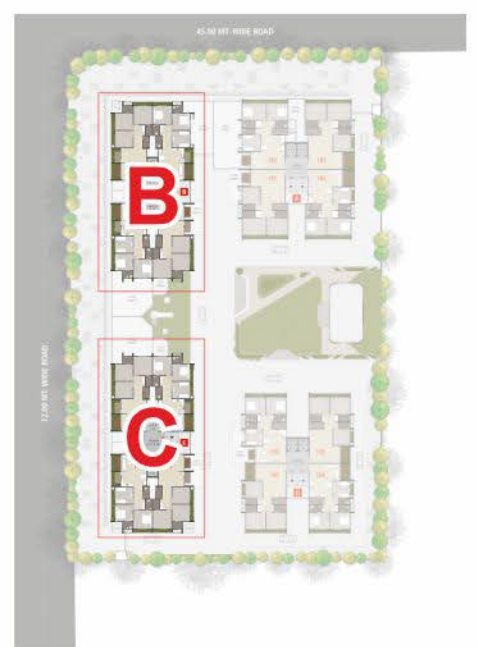

\* This brochure is only for presentation and easy understanding purposes it cannot make part of any legal agreement from developer.







# LOCATION MAP



\* This brochure is only for presentation and easy understanding purposes it cannot make part of any legal agreement from developer.



A PROJECT BY

ॐ

शिव नरं एतन्



SHIV

Someshwar<sup>®</sup>  
Group

Redefining Your Living Supremely

ISO 14001:2015 | ISO 9001:2015 | OHSAS 18001:2007

Project By: DIGJA INFRASTRUCTURE LLP

SITE ADDRESS: Shiv Samarth-2, Near Shiv Digja, B/H SMC Garden, Gaurav Path Road, Pal - T.P. 10, F.P. 11, Surat - 395009

Contact: +91 70464 33000

website: [www.shivsomeshwargroup.com](http://www.shivsomeshwargroup.com) | E-mail: [someshwarinfra@yahoo.in](mailto:someshwarinfra@yahoo.in) | Follow Us:   

Rera Reg. No.: PR/GJ/SURAT/SURAT CITY/SUDA/MAA09765/010222

\* This brochure is only for presentation and easy understanding purposes it cannot make part of any legal agreement from developer.