



Site Address :
UPAVAN SKYLINE
Nr. Sidhi Eligant, Khajuri Hanuman Road,
Lambha, Ahmedabad - 382405

Contact us : +91 90238 11800



Freedom
to live the
life
of your
dreams



**Upvan
Skyline**

2 & 3 BHK LUXURIOUS HOMES

Welcome to a
new lifestyle
that Redefines homes
& retails spaces

2 & 3 BHK Luxurious Homes.
Ultra Super Amenities and more...





Upvan
Skyline



BASEMENT PLAN

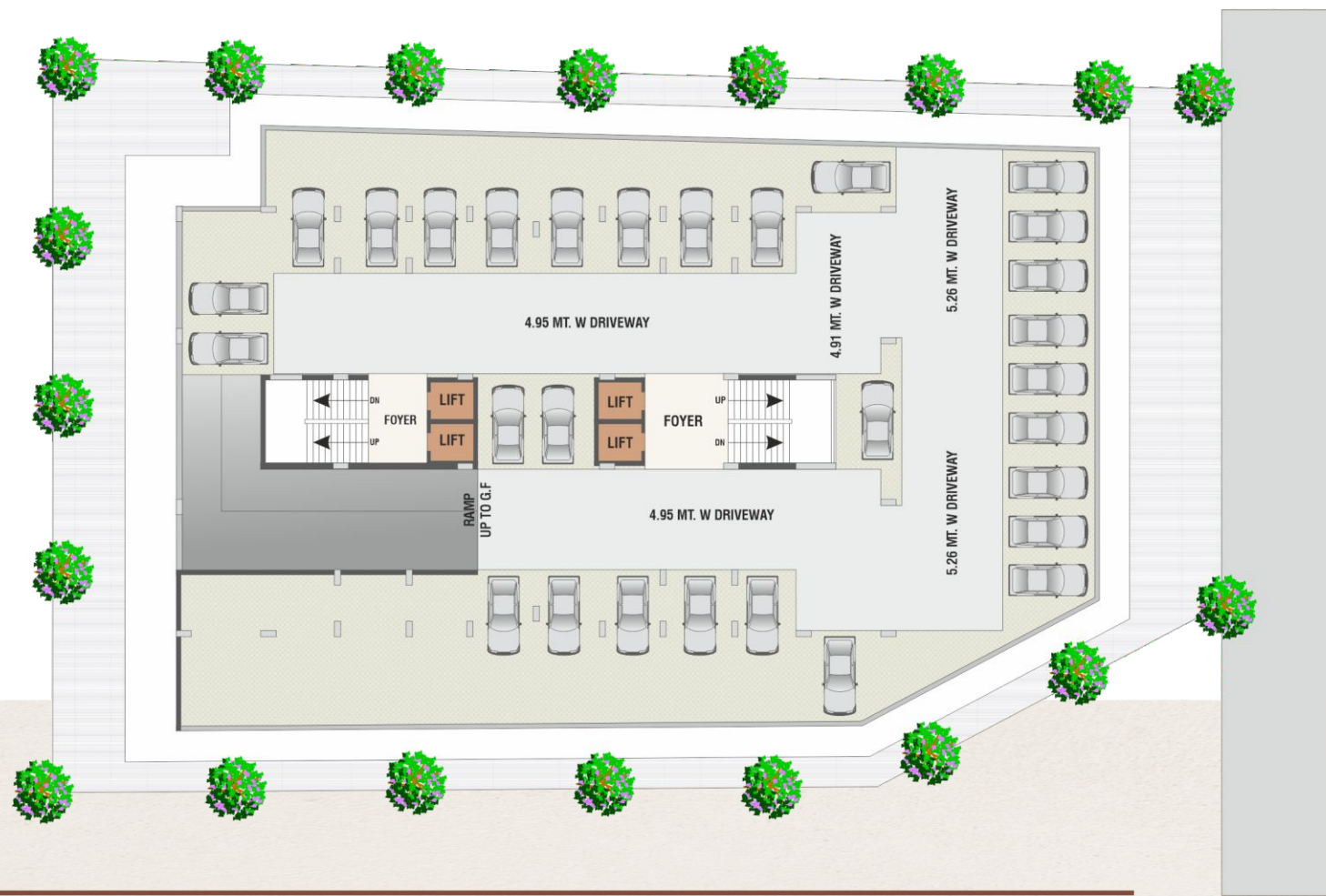

GROUND FLOR PLAN



Freedom to cherish what you've desired

PROJECT FEATURES

Storyed residential tower with 104 units Thoughtfully planned residences

Located at VASTRAL





**Upvan
Skyline**

typical floor plan



3 BHK Unit Plan

A1



101



2 BHK A2

Unit Plan





EXCEPTIONAL

A HOME THAT BEARS
THE MARK OF
PERFECTION



Entrance Gate



Security Cabin



CCTV Camera



Attractive Elevation



RCC Road



Senior Citizen Sitting



24x7 Water



Children Play Area



School Dropup



PNG Gas-Pipeline



Solar Panel



Fire Safety



2 Elevator per block
& Large foyer



Basement Parking



Ample Natural Light
& Ventilation

specifications

- Earthquake resistant R.C.C frame structure.
- Uninterrupted & Adequate 24 hours water supply by AMC & society borewell.
- Auto door lift of premium company.
- Anti terminate treatment at parking level.
- Water proofing treatment with china mosaic on terrace.
- Renowned, standard & tested raw material for all works.
- Maximum natural light & cross ventilation.

FLOORING

- Standard quality vitrified tiles in entire flats.

KITCHEN

- Granite platform with s.s.sink.
- Marble shelves with Ceramic tiles in store room.
- Exhaust Fan in kitchen.
- Cloth Drying Tricks in wash-yard.
- Gas Connection Line (Adani) at kitchen platform level.

BATHROOM FITTINGS

- Non slippery type flooring & tiles up to lintel level.
- Standard quality Bathroom fittings and sanitary ware.
- Corrosion free & leak proof CPVC/UPVC pipes & fittings with Brass ends.

ELECTRICAL WORK

- Concealed copper wiring.
- Adequate number of Electrical points with modular accessories.
- All adequate points like Chimney, Aqua guard, Refrigerator, Cable TV.
- A.C, Telephone points etc.

DOORS & WINDOWS

- Wooden framed decorative main entrance door with quality lock set.
- All bedroom doors will be wooden framed & bathrooms will be granite framed with flush doors laminated on both sides.
- Aluminium section windows with sliding shutter.

WALL FINISH

- Internal mala plaster with Acrylic wall putty finish.
- External double coat sand face plaster with 100% water & weather proof silicon based acrylic paint.

SECURITY PROVISION

- Round the clock security by professional agency.
- 24x7 C.C.T.V Surveillance at Main Entrance Gate, Foyer & Garden area.

BRAND WE USE

ELEVATOR



CEMENT



INSIDE PUTTY



PLUMBING



BATHROOM FIXTURE



ELECTRIC WIRE



MODULAR SWITCHES



PAINT



PNG GAS



Everything near to you!



LOCATION

Site Address : **UPAVAN SKYLINE**,
Nr. Sidhi Eligant, Khajuri Hanuman Road,
Lambha, Ahmedabad - 382405

LOCATION QR CODE



Structure Engineering

ACHAL PARIKH
CONSULTING ENGINEER

A Project By.



Architect.

