

# LOCATION MAP

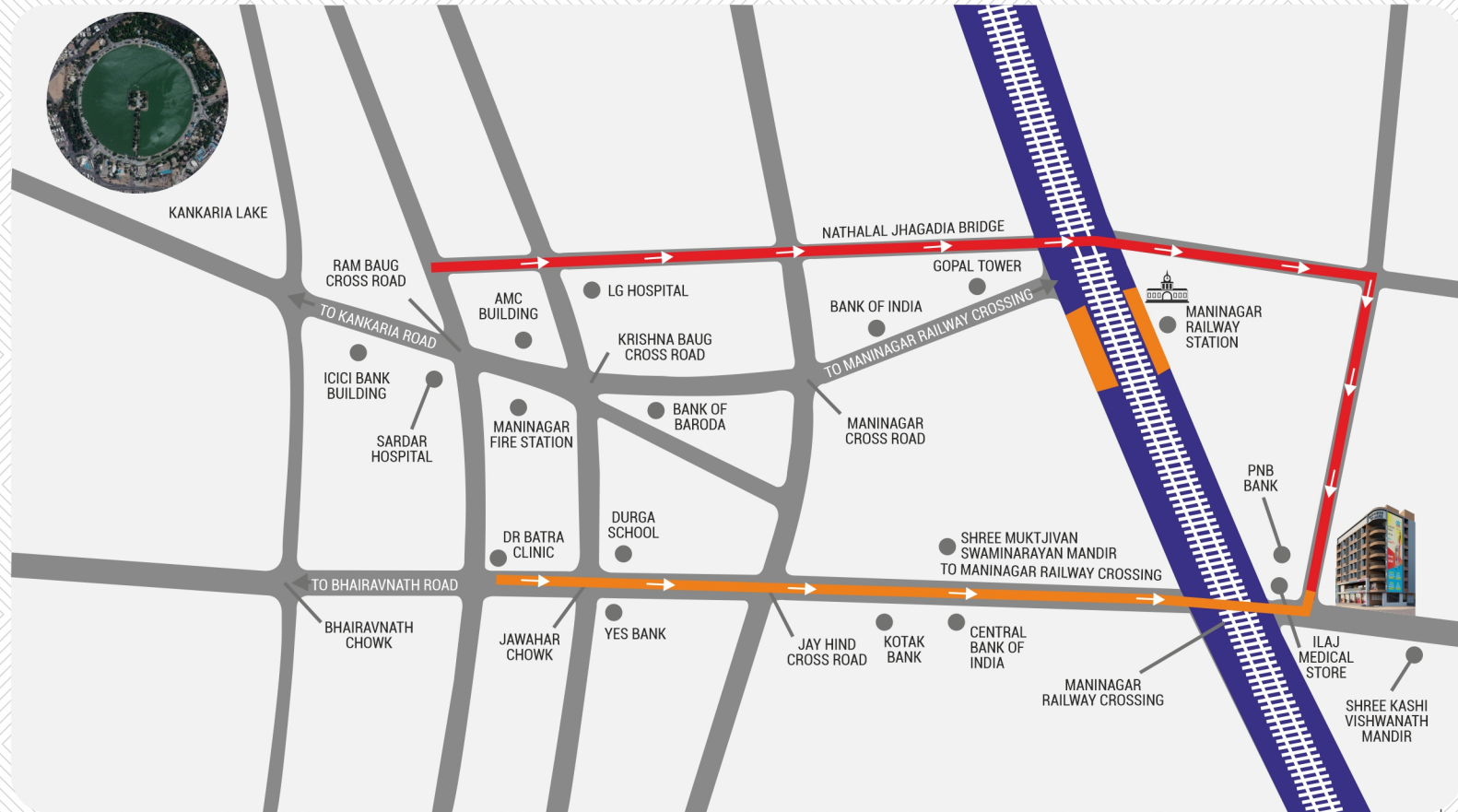

Find a new place

Address : Business Square  
Opp. Maninagar Railway Crossing, Nr. ILAJ Medical, Maninagar, Ahmedabad-380008.  
**CALL FOR BOOKING : 786 19 19 131**

RERA NO :- PR/GJ/AHMEDABAD/AHMEDABAD CITY/AUDA/CAA08859/310721 | [www.gujrera.gujarat.gov.in](http://www.gujrera.gujarat.gov.in)



# THE FUTURE OF WORK SPACE





# A VISION OF SUCCESS

Vision Exchange is a contemporary commercial development at the heart of Business Square. Located at Venture Avenue, the 7-storey development comprises offices, medical suites for businesses of tomorrow.



# SHOPS OFFICES SHOWROOMS

suitable for business



**SUPER  
MARKET**



**CORPORATE  
OFFICE**



**JEWELLERY  
SHOWROOMS**



**CLINIC &  
HOSPITAL**



**APPAREL  
SHOP**



**GYM**



**BANK  
ATM**

Pharmacy | Electronics Shop | Imaging Centre | Automobile | Mobile Shop  
Corporate Offices | Showrooms & Many More



# BASEMENT PLAN

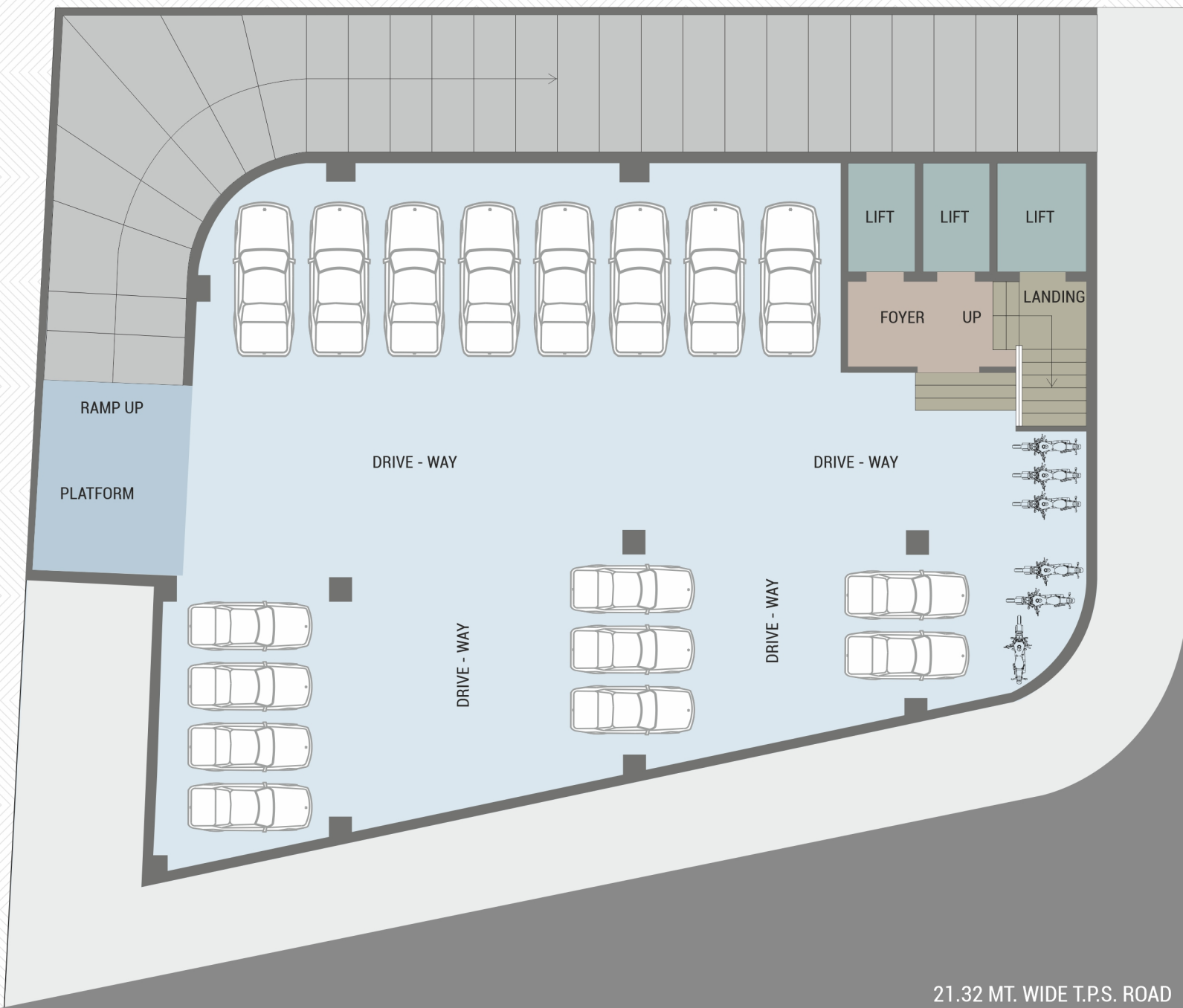

21.32 MT. WIDE T.P.S. ROAD

# GROUND FLOOR PLAN

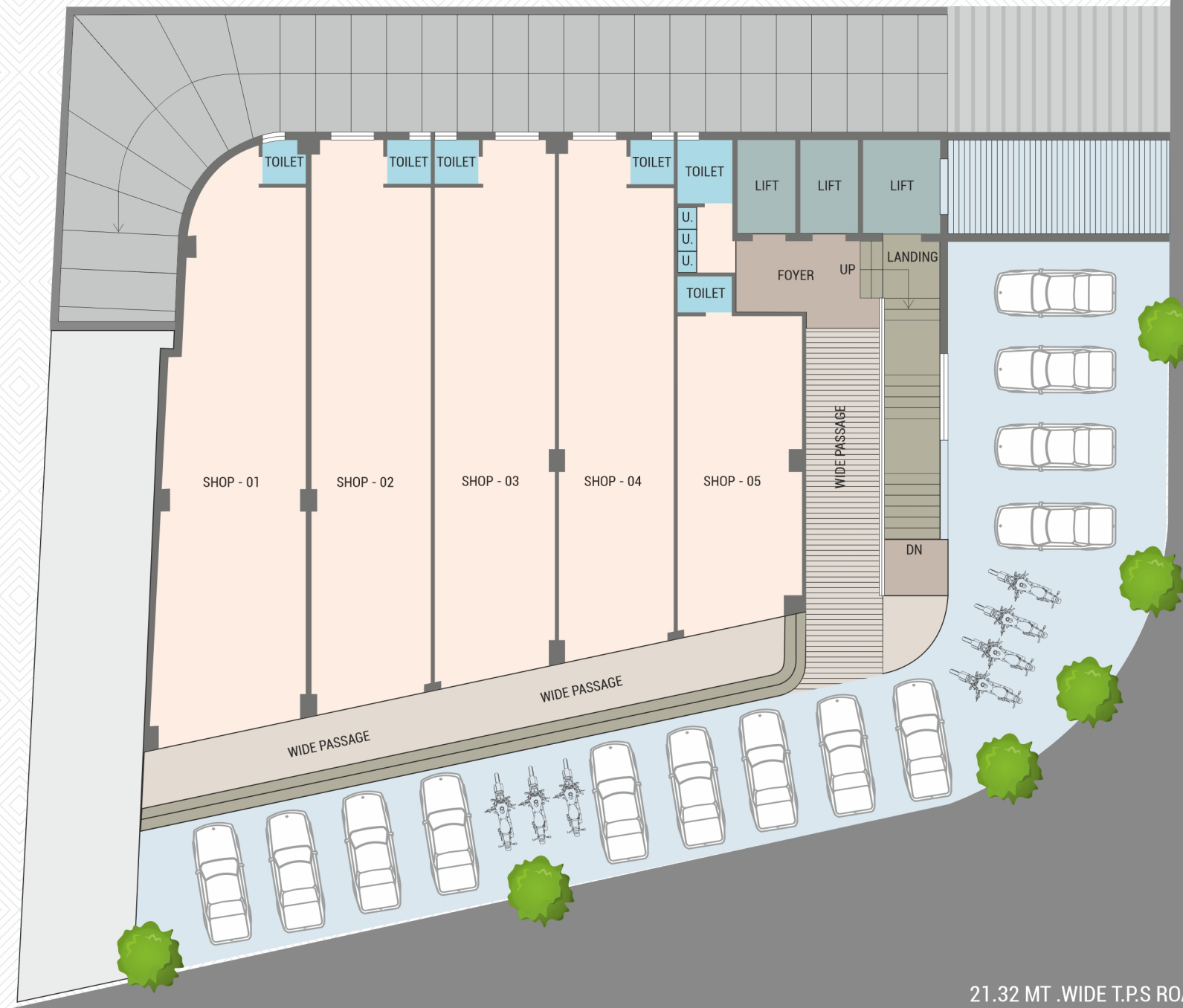

21.32 MT. WIDE T.P.S. ROAD

# FIRST FLOOR PLAN



# 2ND TO 5TH FLOOR PLAN



# 6TH FLOOR PLAN



## AMENITIES

### External Elevation

Elegant external elevation and ventilation to each unit.

### Flooring

Vitrified tiles in all Shops, Showrooms and Offices. Marble/Granite in Stairs and Foyer.

### Parking

Ample parking space and a facility in the basement.

### Floor Heights

Ground Floor Height 12'  
 First Floor Height 11'  
 Typical Floor Height 10'

### Elevator / Lift

Standard quality passenger lift

### Security

CCTV Camera for passage and parking area.

### Fire Safety

Fire safety provisions as per AMC guidelines. Water Supply 24 X 7 water supply

Notes : • This Brochure is not a legal part of the document and is only used for easy and better understanding. • Stamp duty, Registration charges, Legal documentation charges, AEC, Service Tax, GST, VAT any additional charges, Taxes cess or duties levied by the government / local authorities prior, during after the completion of the scheme shall be borne by the purchaser. Irregular payments stand cancellation of booking. • All rights are reserved by developers to make any changes in plan, scheme elevation, dimension and other details in to comply with statutory regulation shall be binding to all the members. • Subject to Ahmedabad Jurisdiction. • Payments in favour of YOGI CORPORATION.

