



# Julee Flat

3 BHK EXCLUSIVE APARTMENTS

## SPECIFICATIONS

### Structure

Quality controlled RCC frame structure with best material components.

### Walls

Internal chant mala plaster with double coat putty & External walls with Mala/Sand faced plaster with Acrylic paint.

### Floors

Premium quality vitrified tiles in entire apartment.

### Doors & Windows

Veneer finish main door with Brass/S.S. fittings & all other doors are flush door. Powder coated/Anodized aluminum sliding windows.

### Bathroom

Premium glazed wall tiles up to lintel level. Good quality CP fittings, Sanitary ware & Accessories. Provision for Gyser.

### Kitchen

Granite platform with S.S. sink. Designer tiles up to lintel level. Stone rack in store. Provision of Water purifier, Gas line, Microwave oven, Refrigerator points.

### Plumbing

Corrosion free and leak proof CPVC/UPVC pipes and fittings. PVC pipes for drainage and rain water.

### Water Proofing

China mosaic/Ceramic tiles in terrace for water proofing & heat resistance.

### Electrification

3 Phase concealed copper wiring with modular fittings & ELCB/MCB. Adequate points in all rooms.

### Water Supply

500 feet Bore well for 24 hrs. water supply. Rechargeable Bore well.

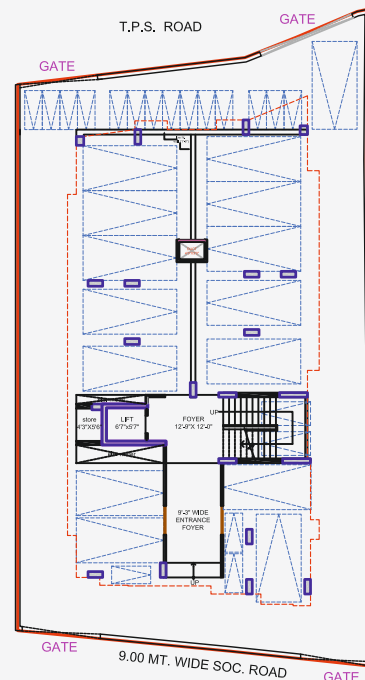

DEVELOPER



**SWASTIK  
HOMES JULEE**

MO : 99090 20205

MO : 98250 34030

swastikbusinesshub@gmail.com

### SITE :

Opp. Jain Supper Bazar,  
Shantivan, Paldi,  
Ahmedabad.

ARCHITECT

**AAPL**

STRUCTURE ENGINEER

**ACHAL PARIKH**



