



**massiMo**  
A BUSINESS BENCH

always one step ahead





# White Wings Group

Our prestige with every project has grown by leaps and bounds. We are today, a specialized multi disciplinary organization focused on Construction, Development and Real Estate. Each project has made a mark for itself. Over the past years, we have collectively fostered a number of fast track projects, most of which are today considered as benchmarks. With a philosophy of challenging our own limits, we are incubating a wide range of new ventures and projects. Luxurious Apartments, Upscale towers, Business bench and Multi-utility Commercial Buildings are projects on hand.

## ASPIRE FOR INSPIRING BUSINESS

Right place at the right time can bring you right success in turn. Definitely it can be the right track to opt for. Thoughts will make your powerful presence if fed by the burning desires. MassiMo, is the absolute answer to your successful business.



# architectural

Architect



Sanjay Josshi

THE MAGNIFICENCE OF STRUCTURE AND THE SPIRIT OF CRAFTSMANSHIP.

THE ATTENTION TO DETAIL IS SIMPLY AMAZING.  
THIS IS AN APT INTRODUCTION OF WHITE WINGS GROUP.

I AM PROUD TO INTRODUCE THIS PROJECT IN THE CAPACITY OF AN ARCHITECT AND CONSTRUCTION.

IT HAS BEEN A GOOD EXPERIENCE WORKING WITH WHITE WINGS GROUP AND I WISH

LOTS OF SUCCESS FOR THEIR FUTURE ENDEAVORS TOO.

SANJAY JOSSHI





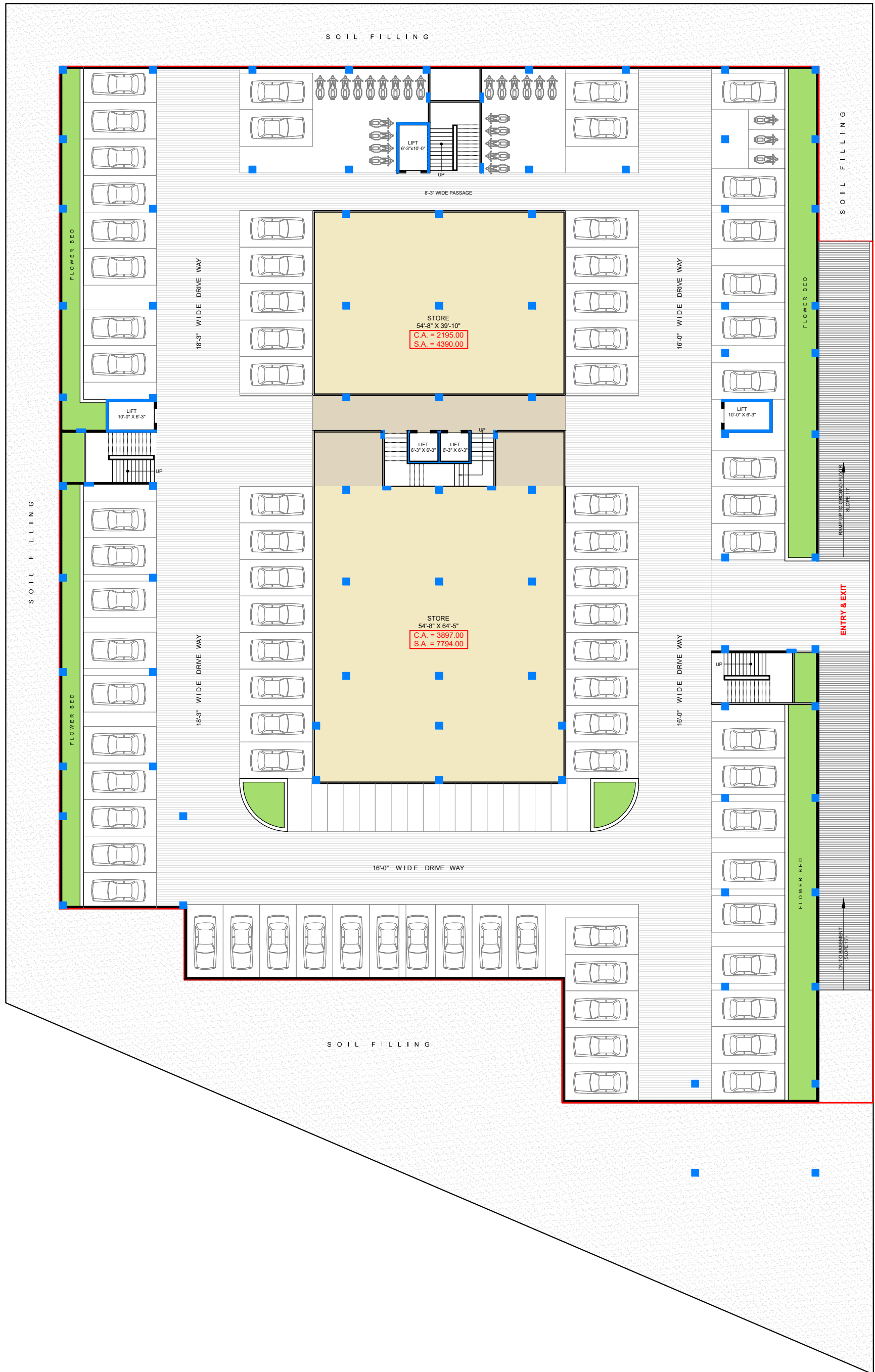



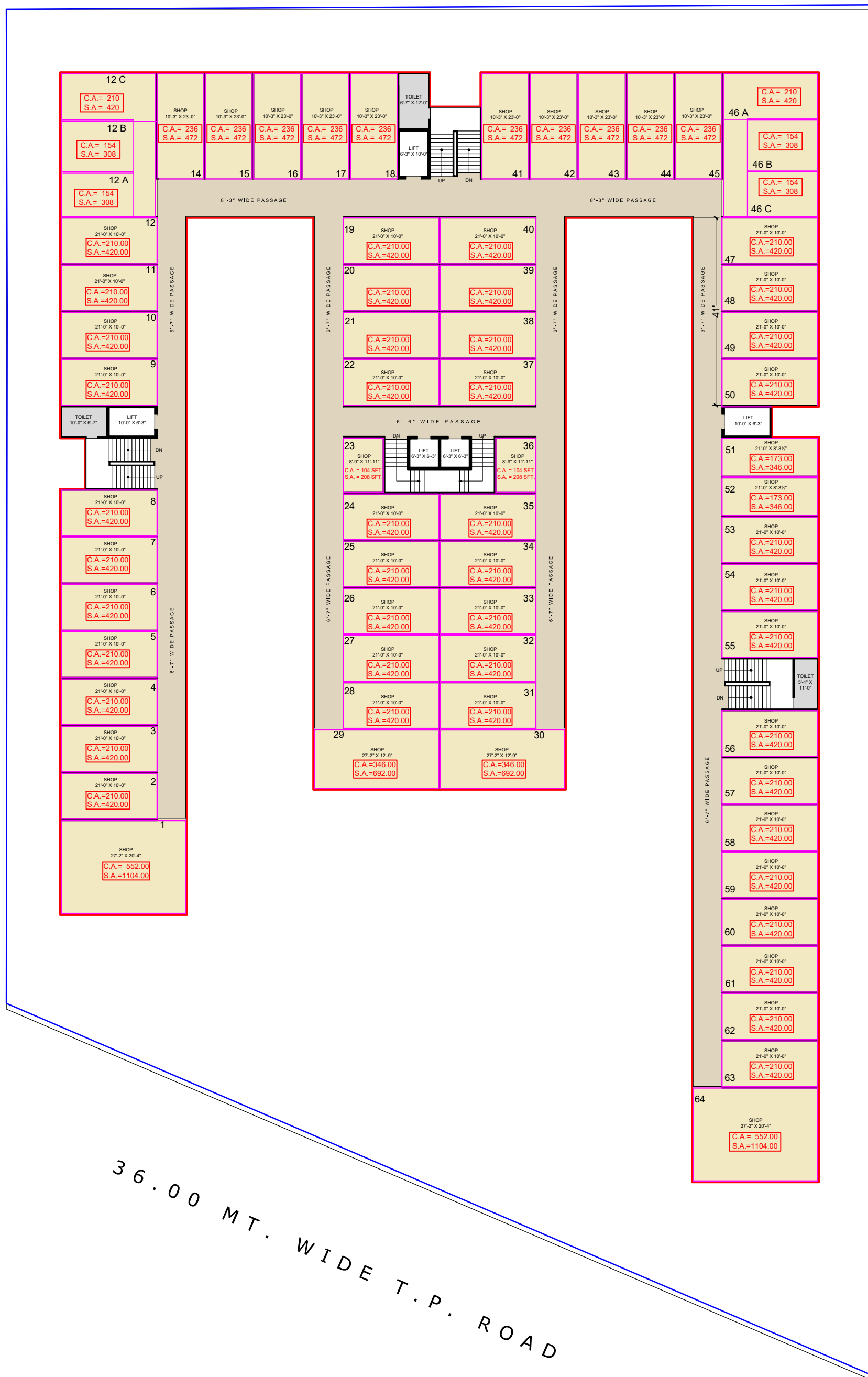

36.00 MT. WIDE T.P. ROAD

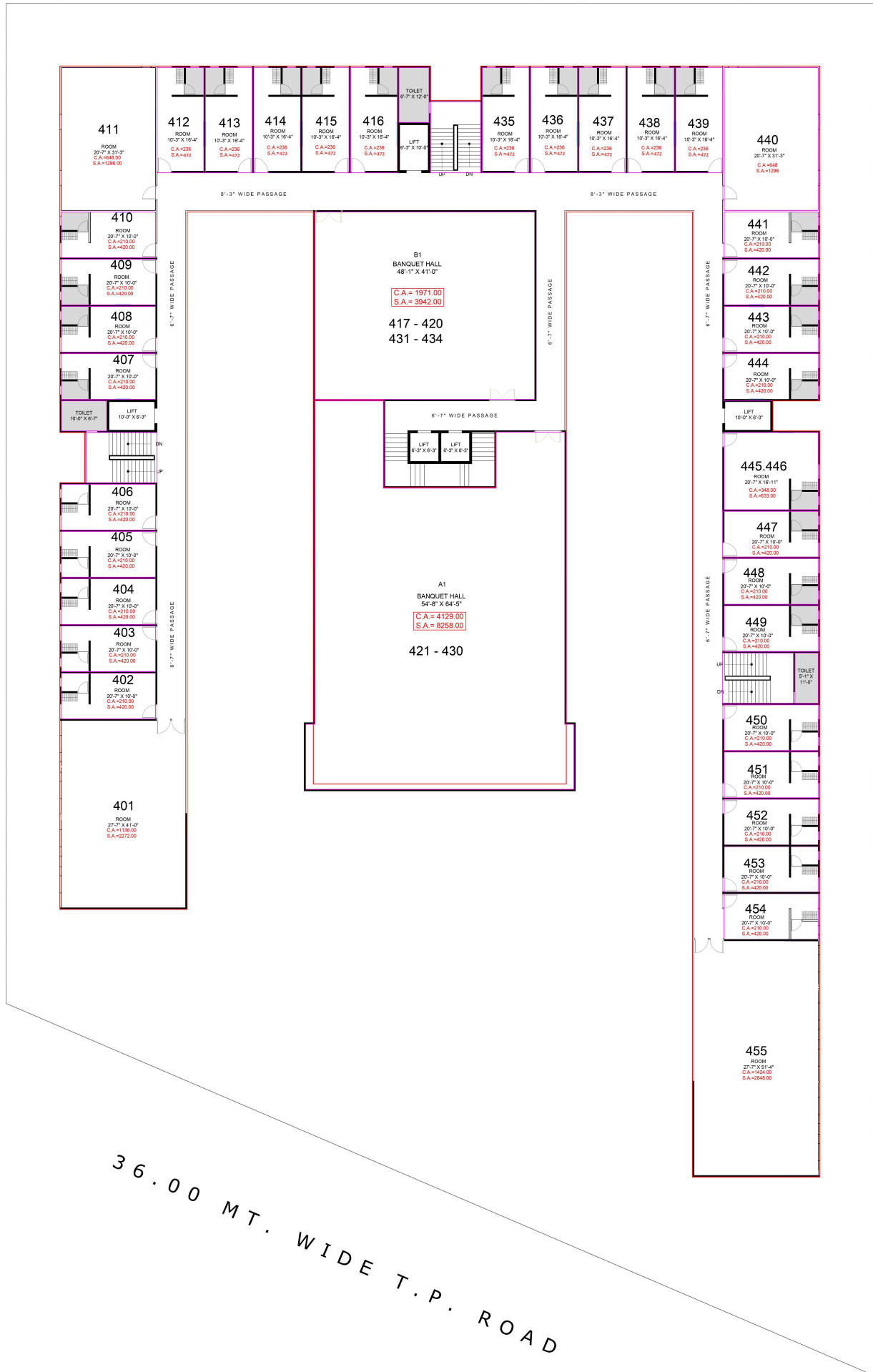

36.00 MT. WIDE T.P. ROAD



# WHITE WINGS GROUP USP

1. OUR ARCHITECT - SANJAY JOSHI OF BLACK INK.
2. OUR VASTU CONSULTANT – GURUDUTT SHINYOY.
3. OUR STRUCTURES ARE DESIGNED BY SHANGHVI & ASSOCIATES & JALIL SHAIKH WHO HAVE EXPERIENCE OF DESIGNING 3000 + PROJECTS IN INDIA AND WORLDWIDE.
4. SYCONE, TRIMITY & POWERCAFE ARE OUR MEP(MECHANICAL, ELECTRIC & PLUMBING) CONSULTANT, THERE IS NO SUCH LOCAL PRACTICE.
5. S'SACT IS OUR PROJECT MANAGEMENT CONSULTANT WHO ARE WELL KNOWN FOR HIGH QUALITY CONSTRUCTION IN TIMELINES.
6. WE ARE USING HIGHER CONCRETE GRADES OF M:25 FOR HIGHER COMPRESSIVE STRENGTH OF STRUCTURAL MEMBER COMPARED TO M:20 OF LOCAL PRACTICE.
7. WE ARE USING POLAD HIGHER-GRADE STEEL OF FE-500/ FE-500 D FOR HIGHER DUCTILITY OF STRUCTURAL MEMBERS AGAINST EARTHQUAKE COMPARED TO FE-415 NORMAL PRACTICE.
8. STEP DESIGNING OF FOOTING FOR PROPER COMPACTION OF CONCRETE.
9. TOP-BOTTOM DOUBLE MESH OF STEEL IN FOOTING FOR HIGHER STABILITY OF BUILDING AGAINST SETTLING.
10. HUGE RAFT TYPE FOOTING AT THE CENTER FOR CENTRALIZING ALL LOADS THOSE ARE COMING ON THE BUILDING.
11. RING BUILDING IN COLUMNS FOR TIGHT GRIPS TO THE MAIN STEEL.
12. WE ARE USING GI BINDING WIRE FOR STEEL BINDING FOR AVOIDING CORRISION & LONG LIFE OF STEEL.
13. COMPULSORY MINIMUM 9” BEAM WIDTH AS PER IS STANDARDS FOR GOOD QUALITY OF CONCRETE.
14. FLAT SLAB DESIGN IN LIVING, DINING & KITCHEN AREA TO AVOID COLUMN BEAM OFFSETS & TO GET MAXIMUM USABLE AREA & CLEAR HEIGHT.
15. 1” EXCESS CONCRETE COVER TO THE COLUMN STEEL TO SAVE FROM RUSTING UNDER THE SOIL.
16. DOUBLE COAT WATER PROOFING INSIDE AND OUTSIDE OF UNDERGROUND WATER TANK TO SAVE WATER FROM GETTING CONTAMINATED.
17. BLACK PLASTIC SHEET ON SOIL BEFORE CONCRETE TO PROTECT CONCRETE CONTAMINATION.
18. PTSI TECHNOLOGY USED WHEREVER REQUIRED TO REDUCE THE BEAM SIZE AND AVOID COLUMNS.



Developer



Member of



## ON GOING PROJECTS



## UPCOMING PROJECTS

## COMPLETED PROJECTS



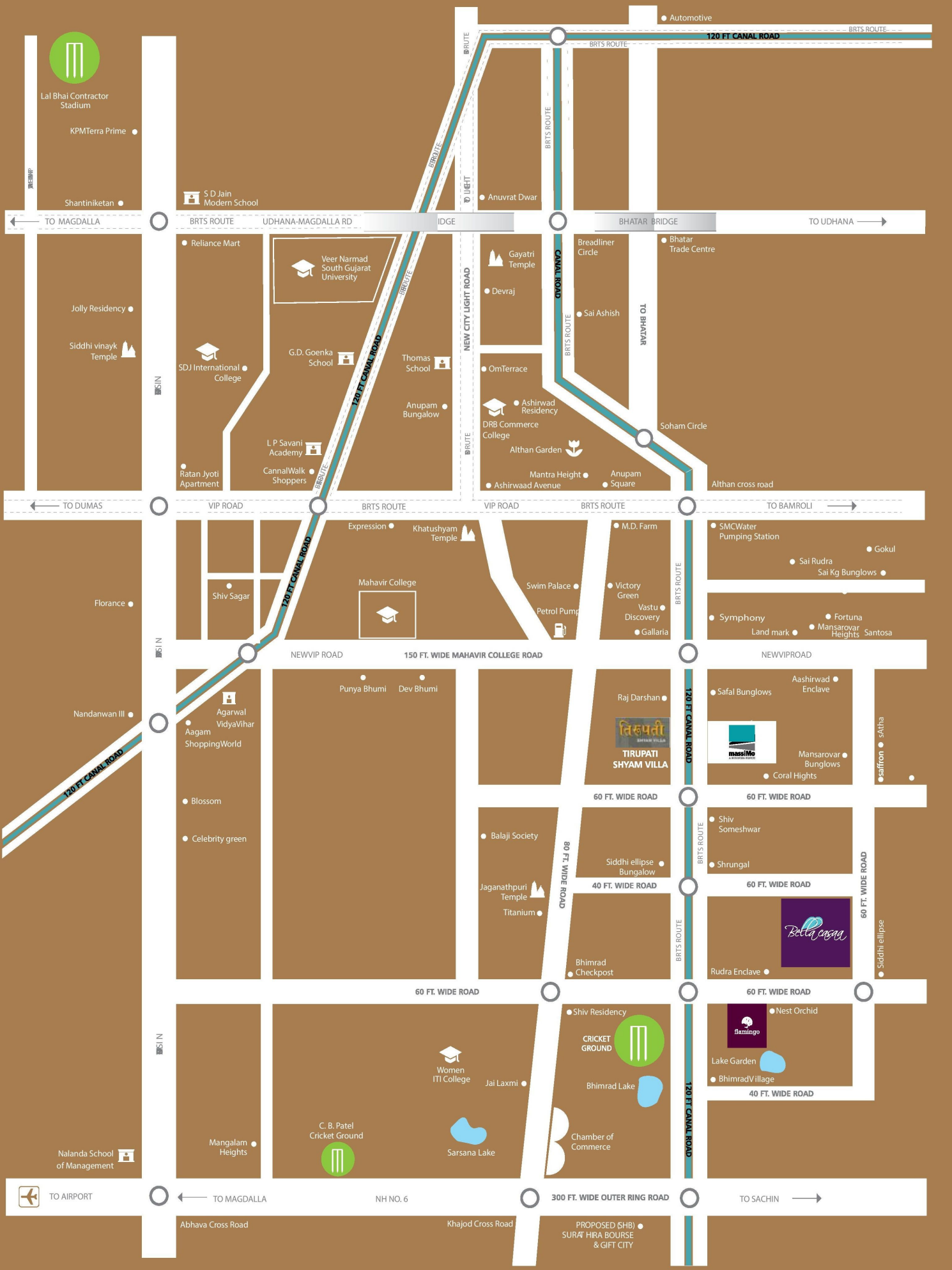

Automotive



Lal Bhai Contractor Stadium

KPM Terra Prime

Shantiniketan

S D Jain Modern School

Reliance Mart



Veer Narmad South Gujarat University

Jolly Residency

Siddhi Vinayak Temple



SDJ International College

G.D. Goenka School

Thomas School

Anupam Bungalow

L P Savani Academy

Cannal Walk Shoppers

Ratan Jyoti Apartment

Anuvrat Dwar

Gayatri Temple

Devraj

Om Terrace

Ashirwad Residency

DRB Commerce College

Althan Garden

Ashirwad Avenue

Breadliner Circle

Bhatar Trade Centre

Sai Ashish

Soham Circle

Althan cross road

Expression

Khatushyam Temple

M.D. Farm

SMC Water Pumping Station

Sai Rudra

Sai Kg Bunglows

Florance

Shiv Sagar

Mahavir College

Swim Palace

Petrol Pump

Victory Green

Vastu Discovery

Gallaria

Symphony

Land mark

Fortuna

Mansarovar Heights

Santosa

Nandanwan III

Agarwal VidyaVihar

Aagam ShoppingWorld

Blossom

Celebrity green

Punya Bhumi

Dev Bhumi

Raj Darshan



TIRUPATI SHYAM VILLA

Aashirwad Enclave

Safal Bunglows

Mansarovar Bunglows

Coral Heights

60 FT. WIDE ROAD

Shiv Someshwar

Shrungal

40 FT. WIDE ROAD

Siddhi ellipse Bungalow

Balaji Society

Jaganathpuri Temple

Titanium

80 FT. WIDE ROAD

Bhimrad Checkpost

60 FT. WIDE ROAD

Shiv Someshwar

Shrungal

60 FT. WIDE ROAD

Rudra Enclave

60 FT. WIDE ROAD

Rudra Enclave

60 FT. WIDE ROAD

Nest Orchid

Lake Garden

Bhimrad Village

40 FT. WIDE ROAD

Nalanda School of Management

Mangalam Heights

C. B. Patel Cricket Ground



Women IIT College

Jai Laxmi

Shiv Residency

CRICKET GROUND

Bhimrad Lake

Chamber of Commerce

Sarsana Lake

TO AIRPORT

TO MAGDALLA

NH NO. 6

300 FT. WIDE OUTER RING ROAD

TO SACHIN

Abhava Cross Road

Khajod Cross Road

PROPOSED (EHB) SURAT HIRA BOURSE & GIFT CITY



we transform space

Corporate Office : TORRANCE, Opp. J9 Commercial Complex, G. D. Goenka Canal Road, Vesu, Surat

Site Address : MASSIMO, F.P.No.12, T.P.No.43, Opp. Tirupati Shyam Villa, 120 ft Canal Road, Althan Bhimrad Road, Surat

Call : 96247 38900 | 98240 99444

E-mail : [mkt@whitewingsgroup.in](mailto:mkt@whitewingsgroup.in) Website : [www.whitewingsgroup.in](http://www.whitewingsgroup.in)

ARCHITECT  
SANJAY JOSHI & ASSOCIATES

STRUCTURAL ENG.  
SANGHVI & ASSOCIATES

EP - CONSULTANT  
SYCONE

VASTU CONSULTANT  
R. GU RUDUTT SHENOY



# DISCLAIMER

---

In the interest of continual developments in design and quality of construction, the developer reserve all rights to make any changes in the technical specifications, designs, planning, layout, and all purchasers shall have to abide by the changes.

This presentation is intended only for easy display and information of the projects and does not form part of legal documents.

Any dispute shall be subject to jurisdiction of honorable RERA court.

## **RERA Disclaimer for website/ walkthrough/ pdf/ brochures/ audio-video/ hoardings, etc.**

Thank you for visiting our website/ walkthrough/ pdf/ brochures/ audio-video/ hoardings, etc, please note that we are in the process of updating our website/ walkthrough/ pdf/ brochures/ audio-video/ hoardings, etc according to the RERA compliance.

In the interim, by accessing this website/ walkthrough/ pdf/ brochures/ audio-video/ hoardings, etc; the viewer confirms that the information including brochures, artistic impressions, and other materials on this website/ walkthrough/ pdf/ brochures/ audio-video/ hoardings, etc and our other website/ walkthrough/ pdf/ brochures/ audio-video/ hoardings, etc are solely for information purposes only, and not an invitation, advertisement, sale, offer, etc by the Company or it's representatives, for booking/ purchase any of our products whatsoever.

The Company is not liable for any consequences of any action taken by the viewers relying on such material/ information on this or any other website/ walkthrough/ pdf/ brochures/ audio-video/ hoardings, etc, nor for any expense, loss, or damage including, without limitation, indirect or consequential loss or damage, or any expense, loss or damage whatsoever arising from use, or loss of use of data, arising out of or in connection with the use of this website/ walkthrough/ pdf/ brochures/ audio-video/ hoardings, etc.

Please note, that we will not be accepting any bookings or allotments based on the images, materials, material, stock photography, projections, details, descriptions that are currently available and/ or displayed on the website/ walkthrough/ pdf/ brochures/ audio-video/ hoardings, etc. Any person who is interested in purchasing property in the said project is advised to personally visit the office of project and physically verify before purchasing the property. Any claims based on the any advertising materials available on the website will not be entertained.

We thank you for your patience and understanding.

## **TERMS AND CONDITIONS**

- Stamp duty, Resgistration charges, Legal charges, GST, etc shall be borne by purchaser.
- Out station cheques shall not be accepted.
- Any new taxes announced by the Governmant/SMC/Any Authority will be borne by the purchaser during or after the project.
- Irregular payment may lead to cancellation of booking.
- Purchasers are strictly NOT PERMITTED to make any changes/alteration in elevation, external colour scheme or any other change affecting the overall design concept & outlook of the building.
- The website/ walkthrough/ pdf/ brochures/ audio-video/ hoardings, etc, are only for easy display & information of the project & does not form part of the legal document.
- The developer reserves all rights to make any changes in the project including technical specification, designs, layout plan & all the purchasers shall abide by such changes.