

A PROJECT BY



98 83 83 83 10
95 86 52 91 09

RHYTHM PLAZA
Opp. Shreedhar Flora, Amar Jawan Circle,
Nikol, Ahmedabad-382350.



LEAP AHEAD IN **SUCCESS WITH**
EXCLUSIVE SHOWROOMS & OFFICES

CONNECTS BUSINESS PROMOTES SUCCESS

In the world of business, location gives you an edge over your competitors. It is the most crucial factor to be considered while selecting your place of business. As Rhytham Plaza is positioned at one of the most prominent and connected location of Ahmedabad.



NEVER LIMIT YOUR VISION BASED ON YOUR CURRENT RESOURCES



- Insurance Office
- Apparel Shop
- Gift Shop
- Accessories Shop
- Corporate Office
- Bank
- Hospital
- IT Office
- Hotels
- Clinics





GROUND FLOOR TYPICAL PLAN

G



FIRST & SECOND FLOOR PLAN

1/2

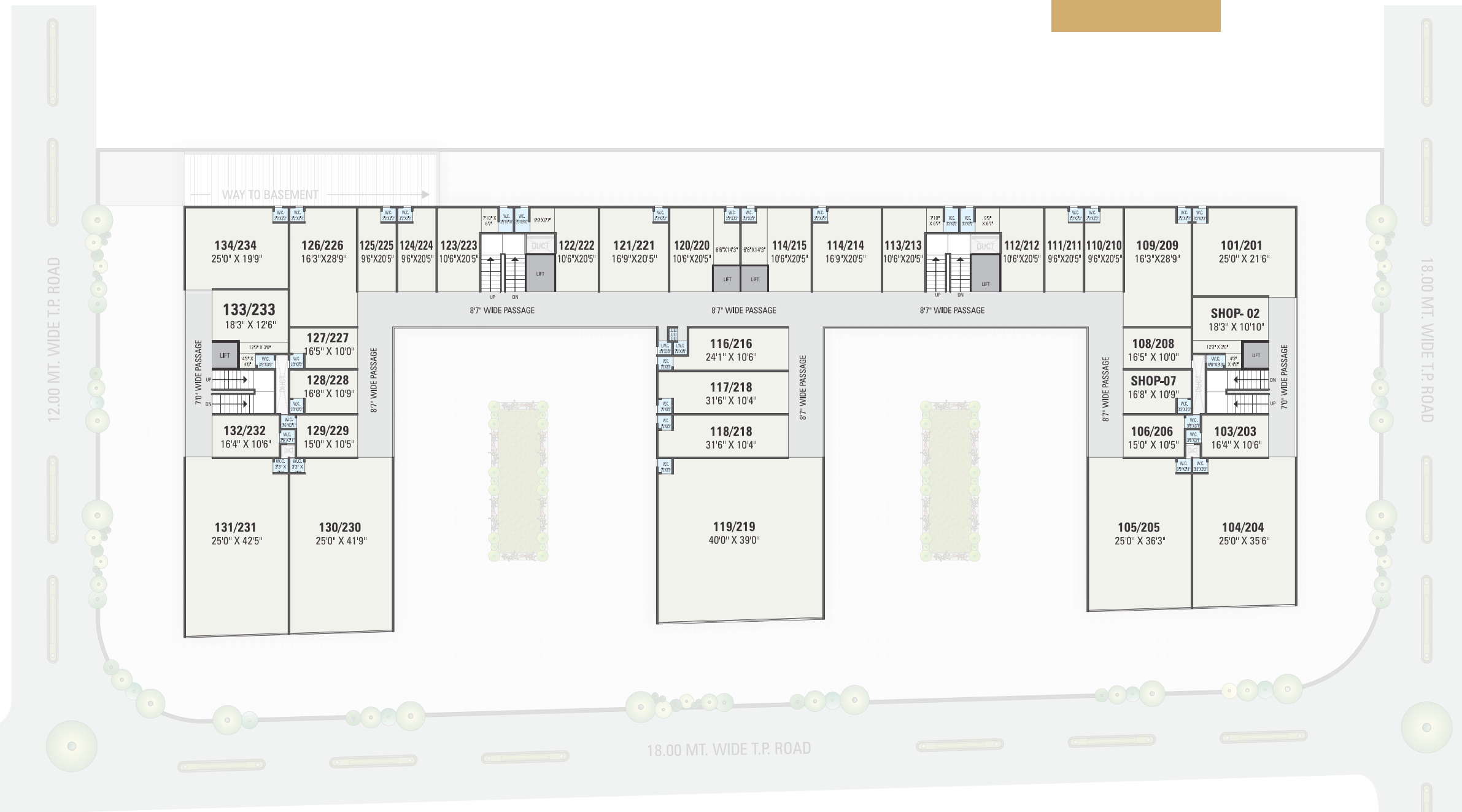

THIRD & FOURTH FLOOR PLAN

3/4



FIFTH FLOOR PLAN

5



SIXTH FLOOR PLAN

6



BASEMENT FLOOR PLAN

6



A VENUE FOR OFFICE SEGMENTS THAT COMMUNICATES
A SENSE OF OWNERSHIP & INSPIRES GROWTH



SALIENT FEATURES

- Located Near Ring Road. The Most Developed Road of Ahmedabad.
- Surrounded by huge Retail Hubs
- Earthquake Resistant Structural Design
- Elegant Entrance Foyer
- Sufficient Parking Space At Ground Floor & 2 Level Basement
- Stretcher - Size Automatic Elevators
- Individual Water Closet in every units
- 24 Hours Water Supply By Borewell



PROJECT SPECIFICATION

PLASTER:

Double Coat Of Sand Faced Plaster Outside, Single Coat of Mala Plaster Inside

PAINTS

Inside Putty Finish, 100% Acrylic Paint for Exterior

FLOORING

Premium Quality Vitrified Tiles.

WINDOW

Powder coated Aluminum sliding windows with glass finishing with stone jamb.

WASHROOM

Premium Tiles Up To Lintel Level & Quality Sanitary Ware

ELECTRIFICATION

Concealed Copper Wiring As Per ISI Standard, A.C. & T.V. Point In All Unit.

PLUMBING

Concealed Center Point Plumbing With Adequate Points & Good Quality C.P. Fittings.

NOTES : • This brochure is not a legal part of the document and is only used for easy and better understanding. • Irregular payments stand cancellation of booking. • All rights are reserved by developers to make any changes in plan, scheme elevation, dimension and other details there in to comply with statutory regulation shall be binding to all the members • Subject to Ahmedabad Jurisdiction • Payments in favour of "PANTHI BUILDCON".

