





Where your **Dreams**  
Come **True.** 🌙



**WELCOME AN ALL NEW LIVING EXPERIENCE CALLED  
SAI RAM RESIDENCY !**

AN EXPERIENCE BROUGHT ALIVE BY A COMBINATION  
OF NATURE AND IN-VOGUE DESIGN CONCEPTS.





**Basement Floor Plan**

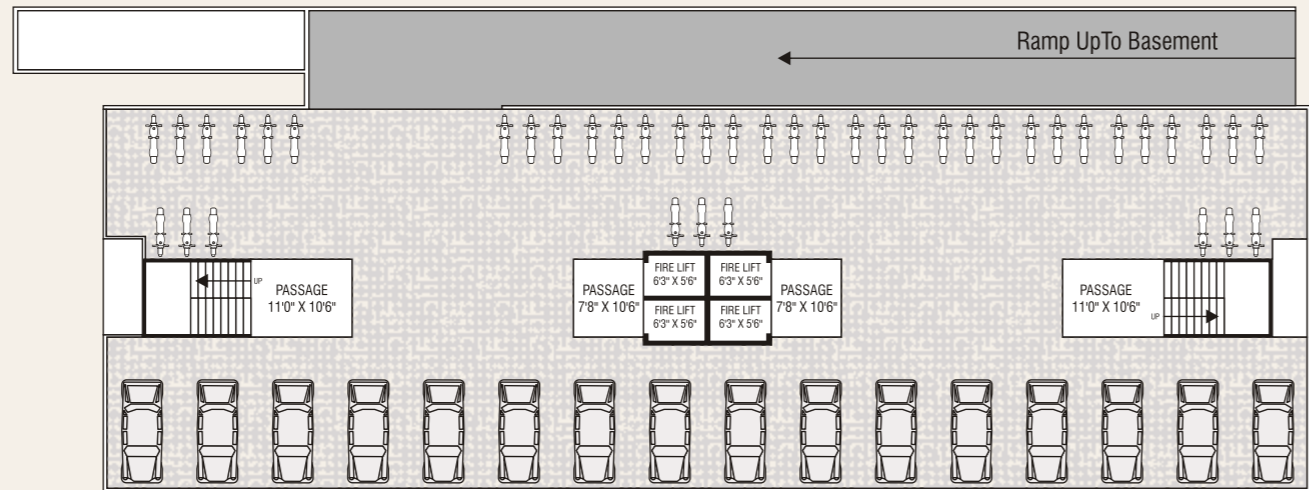

**Ground Floor Plan**

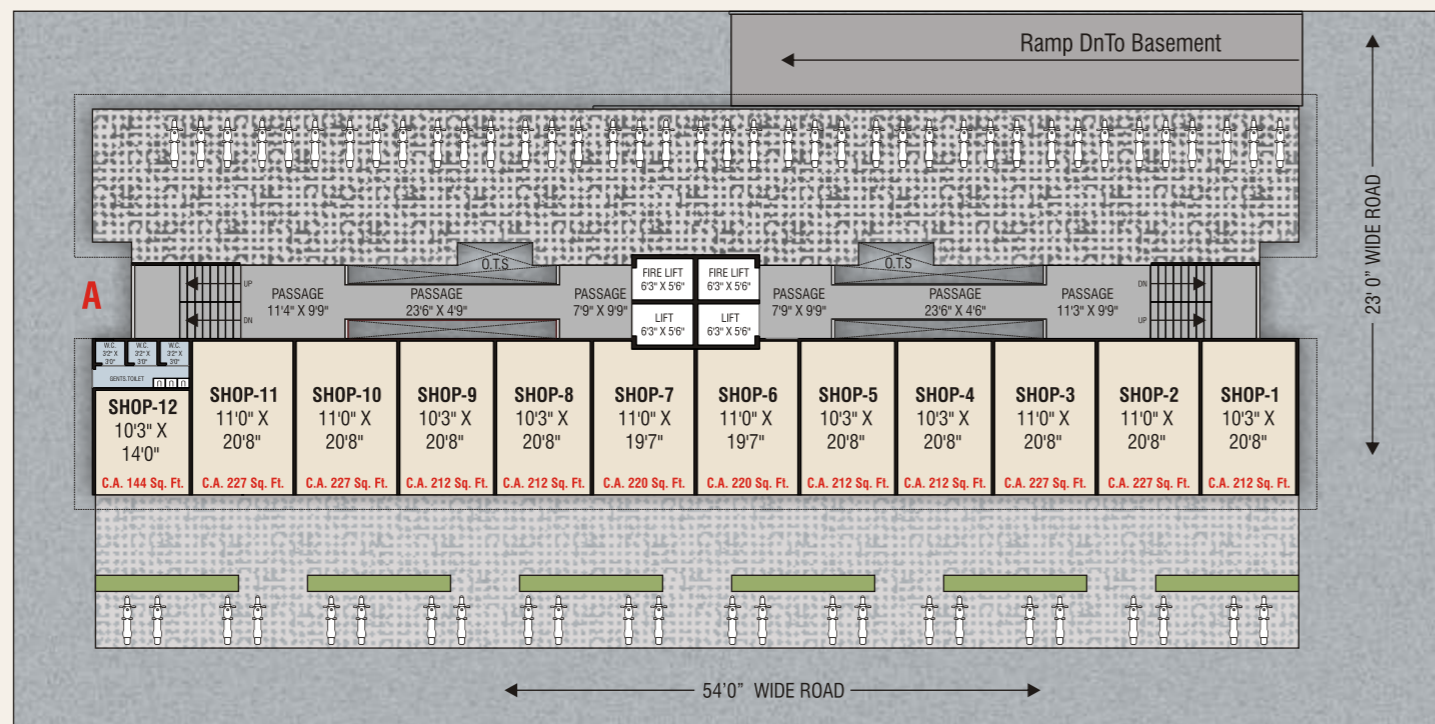



**Typical Floor Plan**  
(1st to 7th floor)

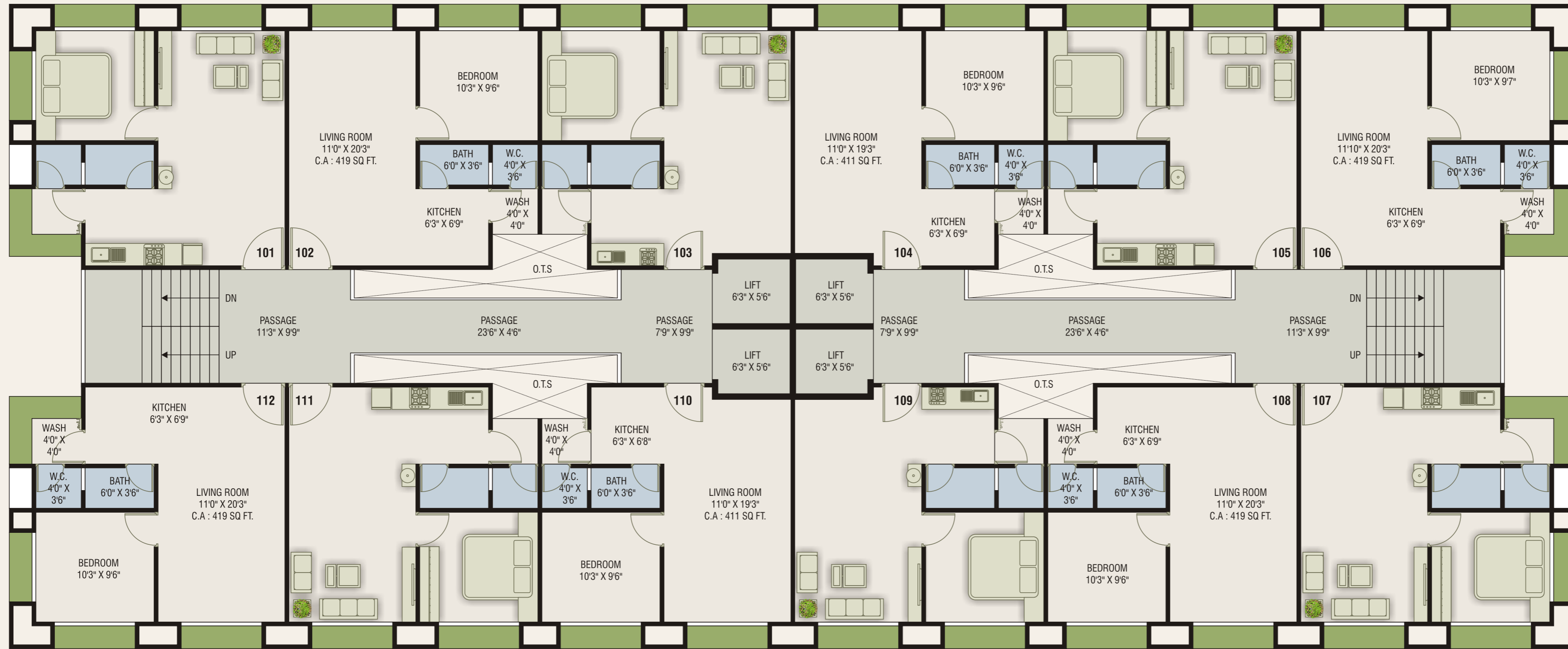

**SPECIFICATION**

- Flooring**  
Vitrified tiles (2'x 2') flooring in shops and common passages.  
Granit stone flooring and for stair case and lift area.  
Vitrified flooring and dado for toilet block.  
Granite stone flooring for entrance foyer and stair.
- Electrification**  
Cable wiring & Modular Switches with I.S.I Standard Fitting of Good Quality.  
Concealed Electrificationpoints.  
T.V., \ point in each unit.
- Plumbing & Sanitation Fixtures**  
Water supply and Drainage point for every Unit ,upvc pipe for water supply with fittings of standard company cera or equivalent brand.
- Water Tank**  
Under ground and over head water tank of sufficient capacity
- Elevators**  
High standard lift with optimum capacity
- Rolling shutter**  
Good quality manually operated rolling shutter
- Doors & Windows**  
Decorative flush door with s.s fittings and good quality aluminium section windows
- Staircase**  
Granite stone finish staircase
- Wall finish**  
White putty in interior surface
- Plaster**  
Double coat roller finish plaster on exterior on exterior walls
- Terrace**  
Water proofing on terrace
- Building Structure**  
Earthquake resistance R.C.C. Structure.