





Development By:

Sankalp Organisers Pvt. Ltd.

CIN No: U45201GJ2008PTC054733

 www.sankalprealty.com

 Thaltej - Shilaj Road,
Shilaj, Ahmedabad

 +91 99257 67000

+91 76220 67000

+91 99783 50000

 sankalpgrace3@gmail.com
info.sankalprealty@gmail.com

Architect

ADSTM
architect pvt. ltd.

Plumbing and Fire Fighting

Aashir Engineering Pvt. Ltd.

Structure

Bhoomi Consultants

MEP Consultants

Transenergy Pvt. Ltd.

PMC

Shree Ideas Consultants

RERA No.: PR/GJ/AHMEDABAD/AHMEDABAD CITY/AUDA/RAA07132/120620 / www.gujrera.gujarat.gov.in

Sankalp Grace 3

Glory with Luxury

AN EXCEPTIONAL
PROSPECT TO ADD
GRANDEUR & GLAMOUR
TO YOUR GRACEFUL LIFE,
IN THE OPULENT
AREA OF TOWN



Sankalp
Grace 3
Glory with Luxury

4 BHK
LUXURY LIVING

G+12
STOREY TOWER

96
UNITS

20+
AMENITIES



Sankalp
Grace 3
Glory with Luxury



HOME THEATER



INDOOR SWIMMING POOL



AMPLE PARKING



COVERED PICKUP /
DROP AREA



DESIGN ENTRANCE FOYER



PLAY STATION AREA



LIBRARY



EMERGENCY STAIRS



YOGA ROOM



FURNISHED
GUEST ROOMS



INDOOR BADMINTON /
VOLLEYBALL COURT



SENIOR CITIZEN
OPEN LOUNGE



GYMNASIUM AREA



INDOOR GAMES



24 x 7 SECURITY



GROUND FLOOR



Sankalp
Grace 3



18'0" MTR. WIDE ROAD



TYPICAL FLOOR
1ST TO 11TH FLOOR



Sankalp
Grace 3



18'0" MTR. WIDE ROAD

ENTRY/EXIT



TYPICAL BLOCK-B
1ST TO 11TH FLOOR

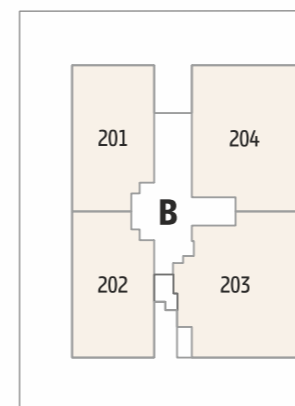

TYPICAL BLOCK-A
1ST TO 11TH FLOOR

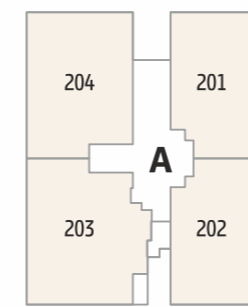

ROAD



TYPICAL BLOCK-A
1ST TO 11TH FLOOR



PENTHOUSE BLOCK-A

12TH FLOOR LOWER LEVEL

12TH FLOOR UPPER LEVEL

N





PENTHOUSE
BLOCK-B

12TH FLOOR UPPER LEVEL

12TH FLOOR LOWER LEVEL





SPECIFICATION

FLOORING

- Italian Marble/Premium Vitrified in Vestibule, Drawing, Dining, and Passage area.
- Vitrified tiles in other areas.
- Premium Wooden Flooring/Vitrified in bedrooms.
- Vitrified / Granite flooring in Verandah.

KITCHEN

- Granite platform with sink as per design.
- Vitrified tiles dado up to Lintel level.

TOILETS

- Vitrified tiles dado in toilets up to Lintel level.
- Shower cubical in Master Bedroom toilet.
- Branded CP fittings and Sanitary ware in all toilets.

WASH AREA

- Kota stone flooring and Vitrified tiles dado.
- Provision of Washing machine by electrical and plumbing points.

DOORS AND WINDOWS

- Main entrance door — Flush door with both side veneer finish.
- All other doors— Flush door with both side laminate finish.
- Granite window jambs.
- Aluminium section windows with DGU glass.

ELECTRICAL

- 3-phase concealed fire resistant copper wiring with adequate points in all areas.
- Branded modular switches.
- Provision of TV, cable, telephone points.
- Provision of Video Door Phone security system.

PLUMBING WORK

- Hydro pneumatic pressurized water supply system.
- Central water softening plant.
- Percolation well as per the norms.
- Good quality plumbing and drainage system using PVC pipes.

HVAC WORK

- Provision of central AC VRF/VRV/HVAC system by providing only concealed piping from outdoor unit duct to proposed indoor locations.

EXTERNAL AND INTERNAL FINISHES

- Double coat mala plaster with texture paint on external surfaces.
- Internal walls finished with Gyproc punning plaster and primer coat.
- Ceilings in exposed concrete without plaster/punning.

Sankalp
Grace 3
Glory with Luxury



Scan for location



SPECIAL NOTES :

The developers reserve the rights to change or revise or make any modifications, additions, omissions or alterations in the scheme as a whole or any part thereof or any details therein, at their sole discretion without any prior notice. Such changes would be binding to all the members.

All the architectural and interior views in brochure are computer graphic simulated interpretation of the actual property.

All the dimensions given are approximate & from unfinished surfaces.

This brochure is just for an easy presentation of the project and should not be treated as a legal document.