

a perfect blend of  
**LUXURY &**  
**SERENITY**



# SHIVAM HEIGHTS

**1 BHK  
PREMIUM  
FLATS**



## GROUND FLOOR PLAN

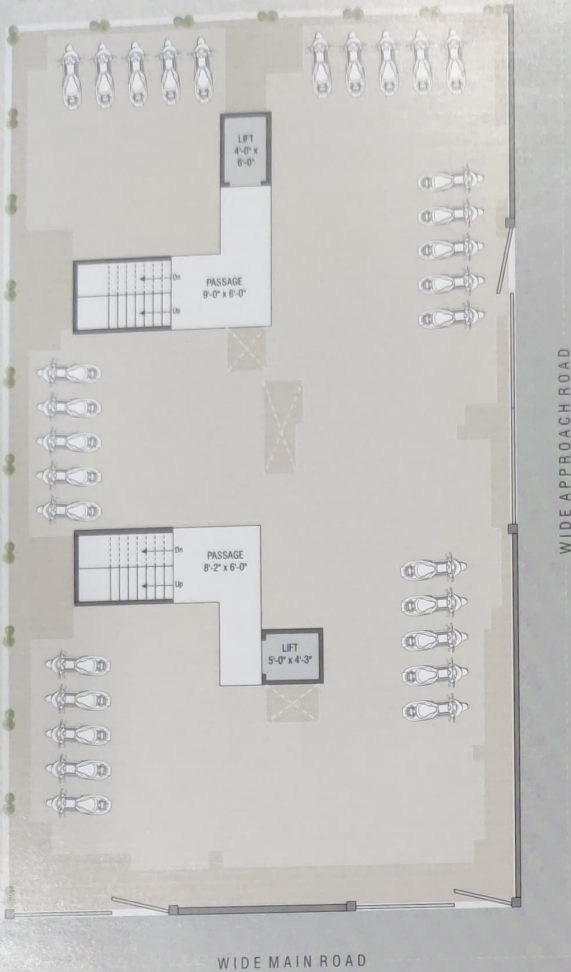

## SPECIFICATION

### STRUCTURE

Earthquake resistance RCC framed structure as per structure design.

### FLOORING

2' x 2' Vitrified tiles flooring in all rooms.

### FINISHING

Internal smooth plaster with primer and External double coat plaster with Apex ultima paint & texture paint for elegant elevation.

### DOORS

Elegant entrance door & Internal flush door with both side laminate.

### WINDOWS

Aluminum powder coated Sliding windows.

### KITCHEN

Platform with SS sink & premium branded wall tiles dedo upto lintel level.

### BATHROOM

Designer tiles upto lintel level with standard quality fittings.

### PLUMBING

Standard concealed U-PVC plumbing

### ELECTRIFICATION :

Concealed ISI mark copper wiring, TV Point in Living Room, Geyser point Bathroom, Good quality modular switches, Separate MCB for each flat.

### TERRACE :

China Moasic finish with water proofing treatment.

## SMART AMENITIES

- Attractive Main Gate
- Surrounding Boundary wall
- Borewell and corporation water
- Separate RO Point in kitchen for each flat
- Separate Washing Machine Point in wash area for each flat
- Under ground tank & upper tank
- CCTV in parking area & in each floor passage covering
- Anti termite treatment on ground level
- Separate electrical meter room
- Paver block at parking area
- Lift of standard company
- Name plate and letterbox on ground floor to maintain uniformity of the building
- Spacious parking area at ground level
- Decorative lights to maintain uniformity of building
- Fire Safety Systems



# TYPICAL FLOOR PLAN





Project By :-



Site :- Shivam Heights, Bh. Geeta Mandir, Idgah Road, Vadodara.

Booking Contact :  
+91 75728 14505