

A Project By

ESSKAAY
CORPORATION

KRISHNA
HERITAGE

Redefine your lifestyle



Eskaay Corporation, the domicile of imaginary dreams and regal lifestyle, has emanated a new Phase with experience of luxury, Elegance and Leisure. Exhibiting this trophy of an excellence, which is a whole new and one-of-its own kind invention at **Dindoli** will add a superclass of living charm in vicinity of surat.



2 & 3 BHK LUXURIOUS LIFESTYLE



ENTRANCE GATE



SECURITY CABIN



CCTV CAMERA



WATER FOUNTAIN



LIFESTYLE OF EXPERIENCING THE FASCINATION



A Life Full Of Luxury Awaits You

Shree Krishna Heritage is a splendid blend of superlative architecture, modern recreational activities and natural beauty-there's something to please the senses and make life flawless.



A STATUESQUE GIFT
FOR THE ENTIRE FAMILY...



With a lean poise and structure, the edifice houses
spectacular abodes that help you lead a sensational lifestyle



EXPERIENCE
the lifestyle of ultimate living

The highly distinguished status will be born for your ultimate lifestyle at
Shree Krishna Heritage to attain its sole trademark and call it as your own.





EXPERIENCE THE LIFESTYLE SPLENDOUR !

The smiles will travel like a pleasant virus in the ambience of your designer mansion for establishing to your dearest guests.





GROUND FLOOR PLAN



Legends

- | | | | | | |
|--|-----------------------------|--|---|--|-------------------------------------|
| | 01) Entrance Gate | | 08) Jogging Track | | 15) Volleyball & Badminton Court |
| | 02) Security Cabin | | 09) Party lawn | | 16) Entrance Foyer / Waiting Lounge |
| | 03) Pickup & Drop Off Zone | | 10) Senior Citizen Garden | | 17) Basement Ramp |
| | 04) Radhakrishna Temple | | 11) Community Hall | | 18) Parking Area |
| | 05) Sculpture with Fountain | | 12) Indoor Games
(table tennis, chess, carrom) | | Seating Area |
| | 06) Garden Gazebo | | 13) Utility Area | | Terrace Gazebo |
| | 07) Children Play Area | | 14) Basketball Court | | Fire Safety |





2 BHK

1st to 13th Floor
TYPE | B-C-D-F-G-H



BEDROOM - 2

TOILET / SHOWER - 2



3 BHK

TYPE : A & I | 3rd to 13th Floor
TYPE : E | 1st to 13th floor



BEDROOM - 3

TOILET / SHOWER - 3



FIRST FLOOR
TYPE : A

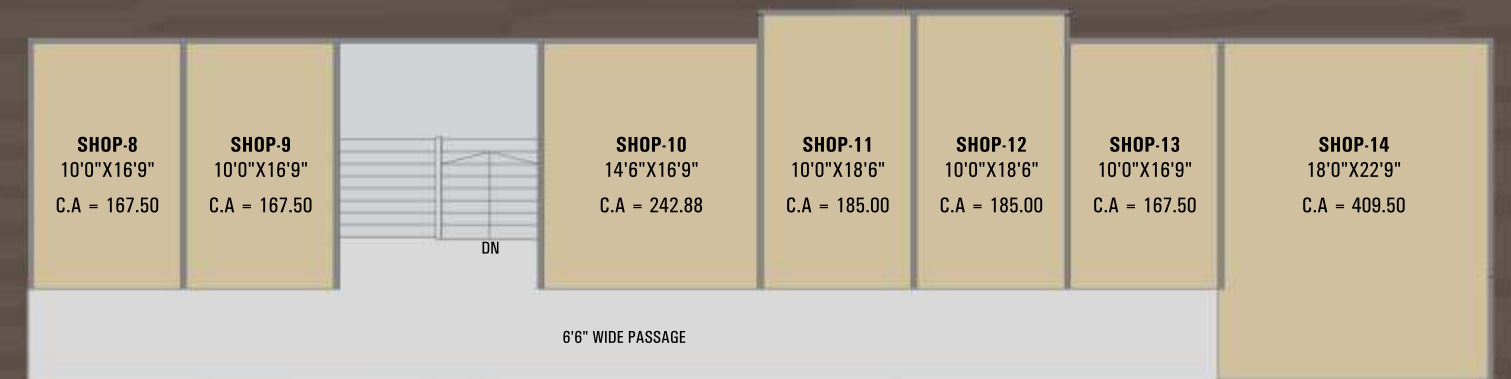

FIRST FLOOR
TYPE : I



GROUND FLOOR
TYPE : A



GROUND FLOOR
TYPE : I



EXPERIENCE LIFESTYLE OF SPIRITUALITY !

The hands of purity, prosperity and enshrinement will be the eternal part of your lives forever with presence of deity with you and your hamlet



External Facilities



CONSTRUCTION :
Enhanced structured safety against earthquake for relevant zone



TERRACE :
Double Coat Water proofing in terrace with decorative china mosaic flooring.



COLOUR :
All building finished with standard quality paint



ELEVATORS CONFIGURATION :
Premium quality lift with safety devise in case of emergency



WATER SUPPLY :
Supply of municipal water or auxiliary source of boring



SECURITY SYSTEM :
Campus will be protected by compound wall from the boundaries Highly secured campus with security cabin at entry-exit & CCTV at main gate, lift & building foyer. 24 hours security in campus.



LANDSCAPE :
Professionally designed & executed landscaping



PLASTER :
Double coat mala finished plaster as per design.



ENTRANCE FOYER :
Fully furnished foyer with reception table & waiting lounge CCTC camera & LCD display & name board



PARKING
Ground and basement level car parking



GENERATOR :
Auto generator for sufficient power backup for common area of building, basement and lift.

Internal Facilities



FLOORING :
• Living room/dinning, kitchen and all bedrooms (24"X24") vitrified granamite tiles.
• Kota stone flooring in wash and glazed tiles dado up to parapet lvl.
• Toilet tiles upto beam bottom lvl



ELECTRIFICATION :
• Concealed circuit wiring of standard (ISI MARK) company with modular switches and MCB
• TV point in all bedrooms and AC point in master bedroom



KITCHEN :
• Kitchen platform will be made of granite stone with SS sink
• Kitchen dado tiles upto beam bottom lvl



PLUMBING :
Concealed plumbing with standard sanitary ware & C.P. fitting UPVC pipes for water supply, PVC pipes for drainage



DOORS :
• Main door will be decorative and other doors are flush door with sal wood frame



STAIRCASE :
Staircase finished with granite / vitrified tile



WINDOWS :
• All windows of anodized aluminium sections and window framing in granite



AIR CONDITION :
All master bedroom concealed A.C. piping fitting

NOTE :

- Stamp, registration, GST, Govt. duty, maintenance etc charges shall be borne by purchaser.
- Developers reserve their rights to make any changes to the scheme for any part or any detail.
- If any changes in rules & regulations/act of any government authority, it will bound to all members.
- External Changes shall not be allowed.
- This brochure is only for advertisement & shall not be considered as a part of legal document.



SHREE KRISHNA HERITAGE, an incomparable lifestyle...

The song of happiness will fill the air life will reverberate with joy, gaiety & laughter !



Architect :

Rachaita

Ar. Ashvin Dobaria
Surat.

Structure Design :

TECHNOCRAT CONSULTANT
CIVIL & STRUCTURAL ENGINEERS

Hemant Shukla

Site Address :

F.P. 99, T.P. 69, Dindoli Lake Garden,
Nr. Ambika Row-House, Beside SMC Com. Hall,
Dindoli, Surat.

Cell _ 99749 64096, 97734 42471

Email_esskaaycorp@gmail.com