

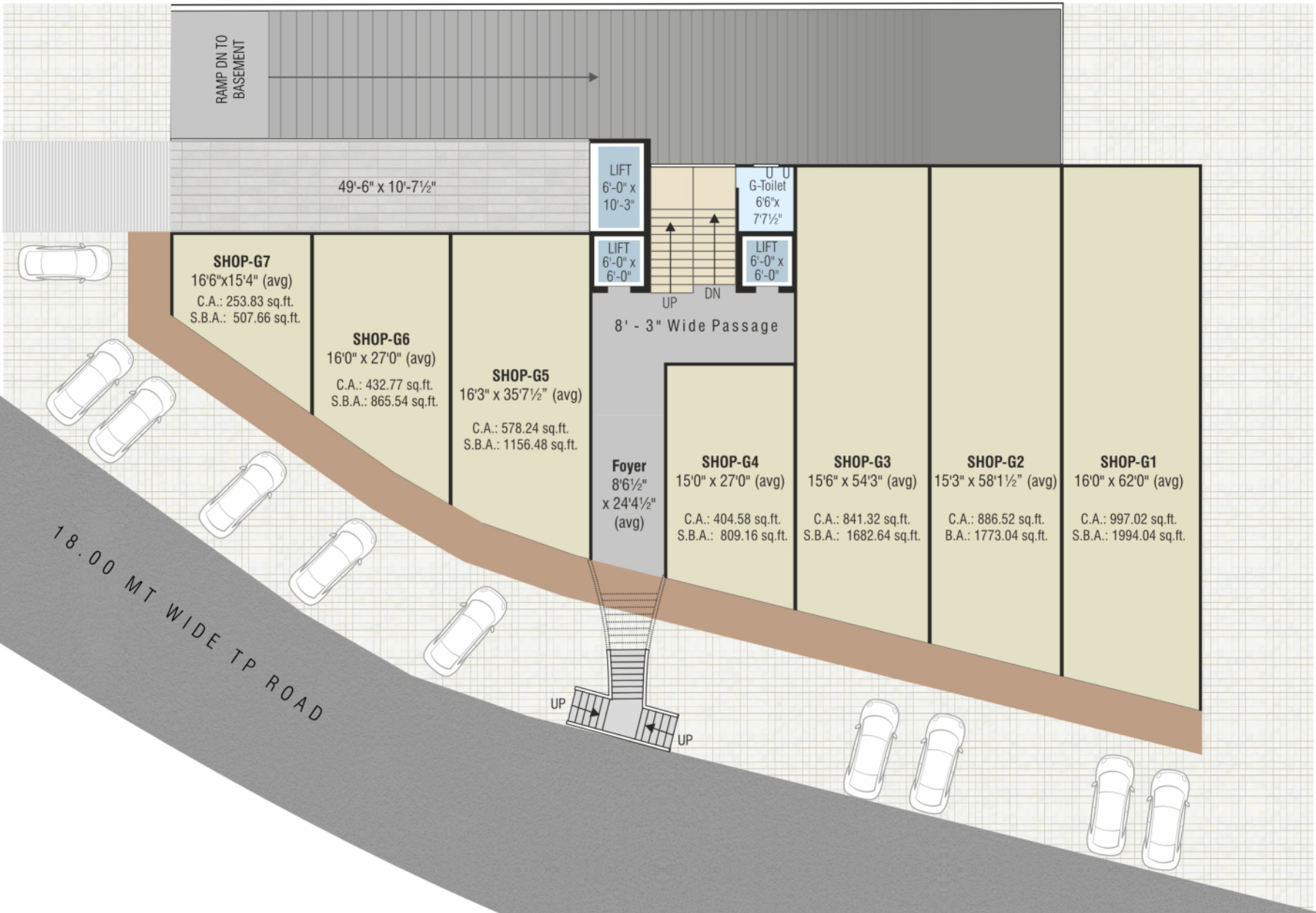

SILICON  
PLAZA



## GROUND FLOOR PLAN





# 1<sup>ST</sup> FLOOR PLAN

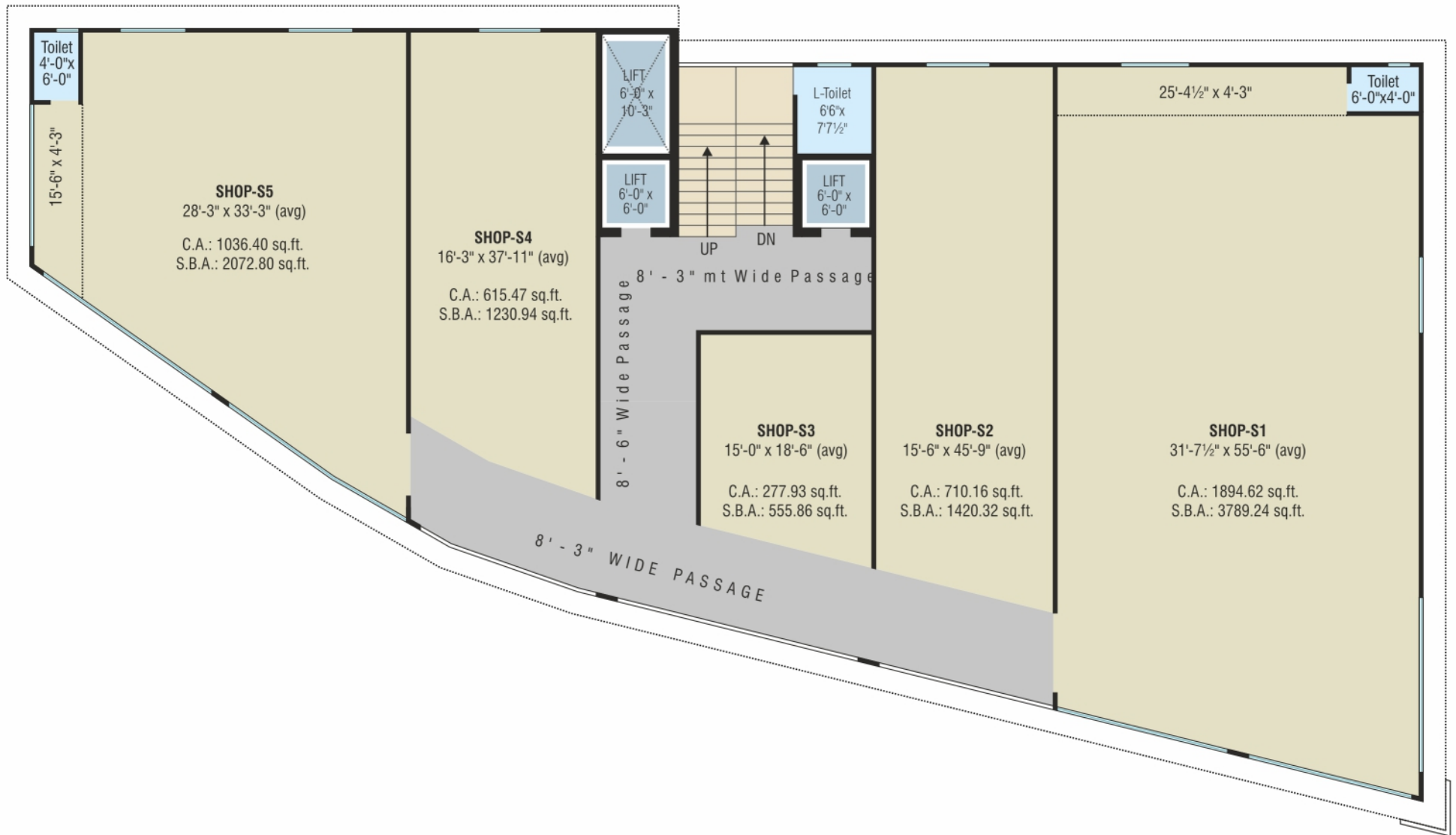

## 2<sup>ND</sup> FLOOR PLAN

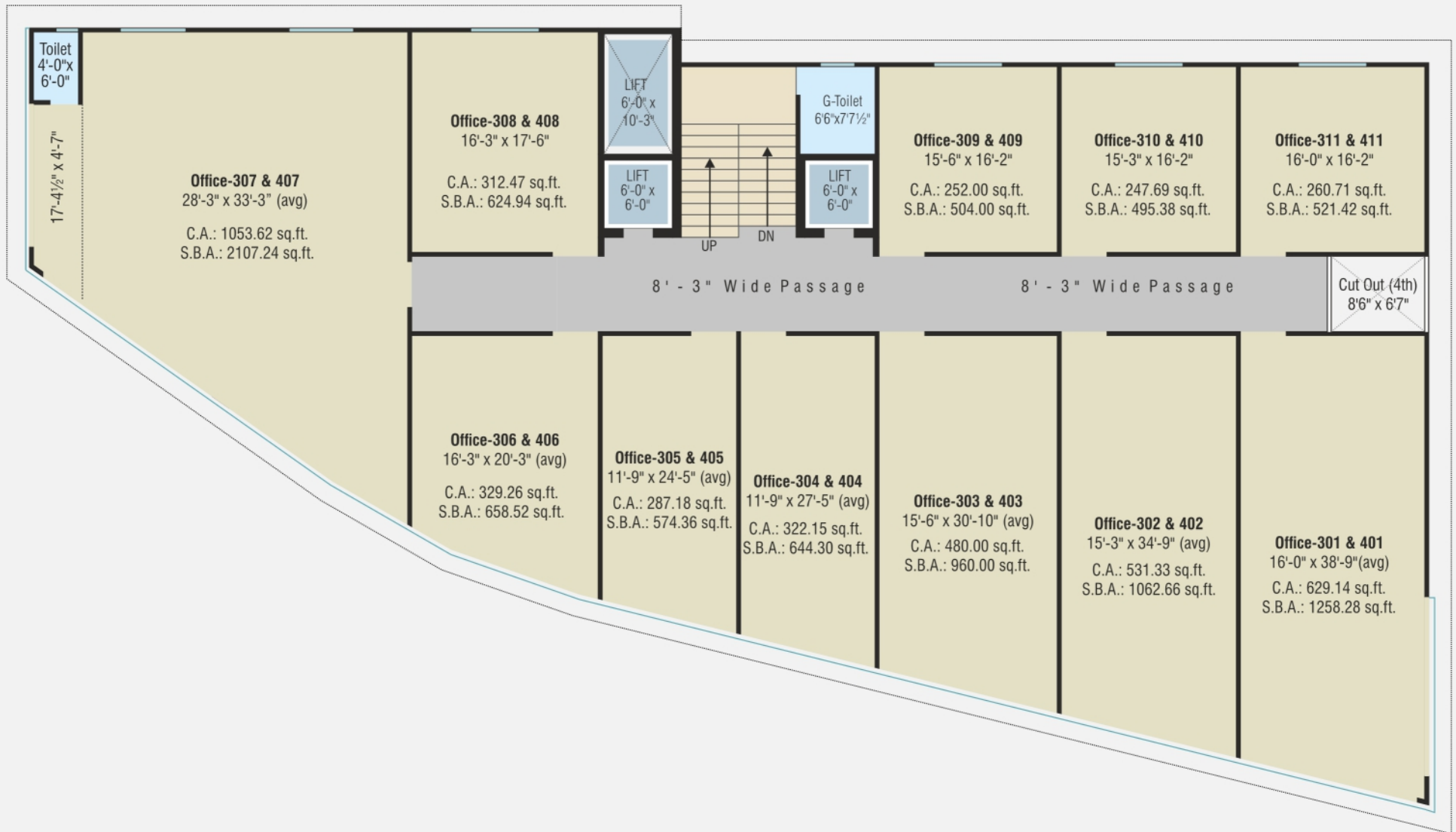

## 3<sup>RD</sup> & 4<sup>TH</sup> FLOOR PLAN

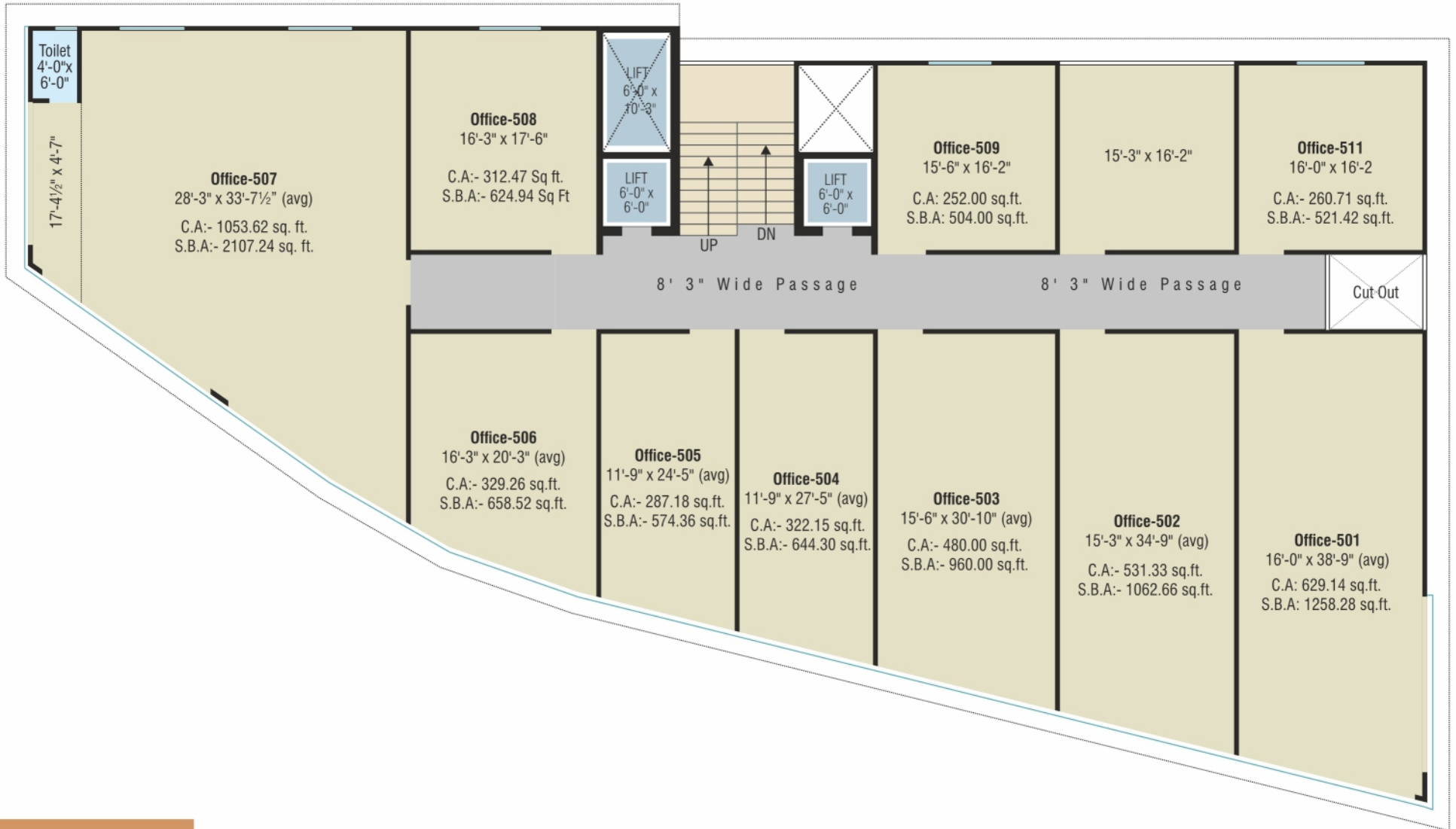

## 5<sup>TH</sup> FLOOR PLAN

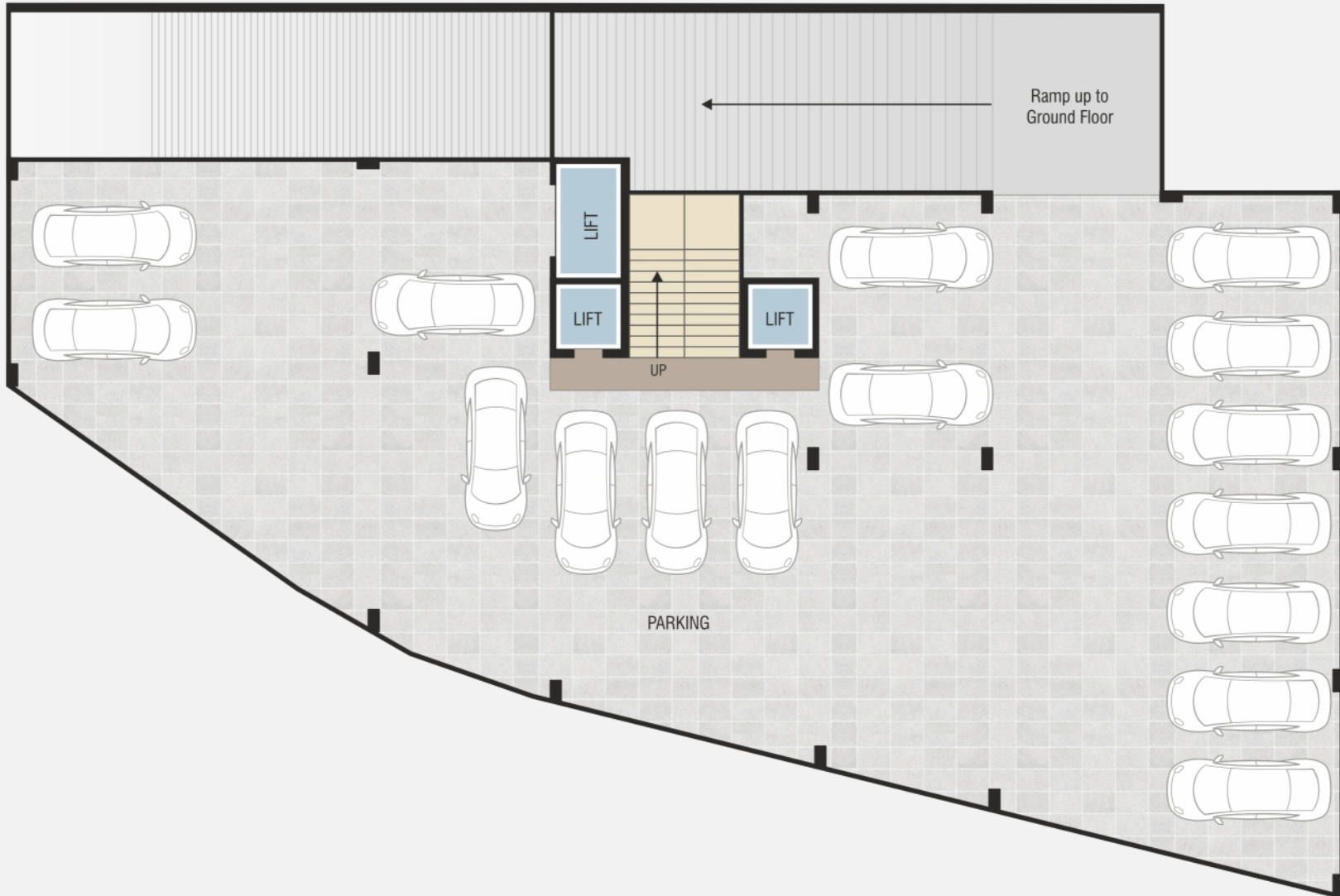

## BASEMENT FLOOR PLAN





## SPECIFICATIONS

- Parking at basement, terrace floor & partly at ground floor.
- Architectural designed glazing.
- High quality elevators of standard company.
- 24X7 Security with CCTV Surveillance.
- Fire Safety.
- Earth-quake resistant RCC design.
- Vitrified Flooring in all offices & shops.
- 24 Hours water Supply.

### Notes:

- All rights reserved to developer and architect for any changes in plans, elevation & specifications.
- Irregular payment will be the cause of booking cancellation.
- Stamp duty, registration charges, legal charges, AMC charges and AEC charges including substation and cable charges will be charged extra.
- Service Tax, GST, VAT, or any such additional taxes will be applicable extra.
- Maintenance deposit will be charged extra.
- External changes shall not be allowed only internal changes shall be done with prior permission and shall be charged extra in advance.

Note: This brochure is for information purpose only. It does not form a part of the agreement or any legal document.

DEVELOPER

**SHREE**  
DEVELOPER

ARCHITECT & STRUCTURE

**SHILANYAS**  
Sanjay Patel

SITE ADDRESS

**SILICON PLAZA**  
Opp. Devkinandan School, Old  
Bamroli Road, Pandesara, Surat

CONTACT

**851132 6000**  
**98250 48154**

RERA Registration No. :- PR/GJ/SURAT/SURAT CITY/SUDA/CAA11709/030523