

# LOCATION PLAN

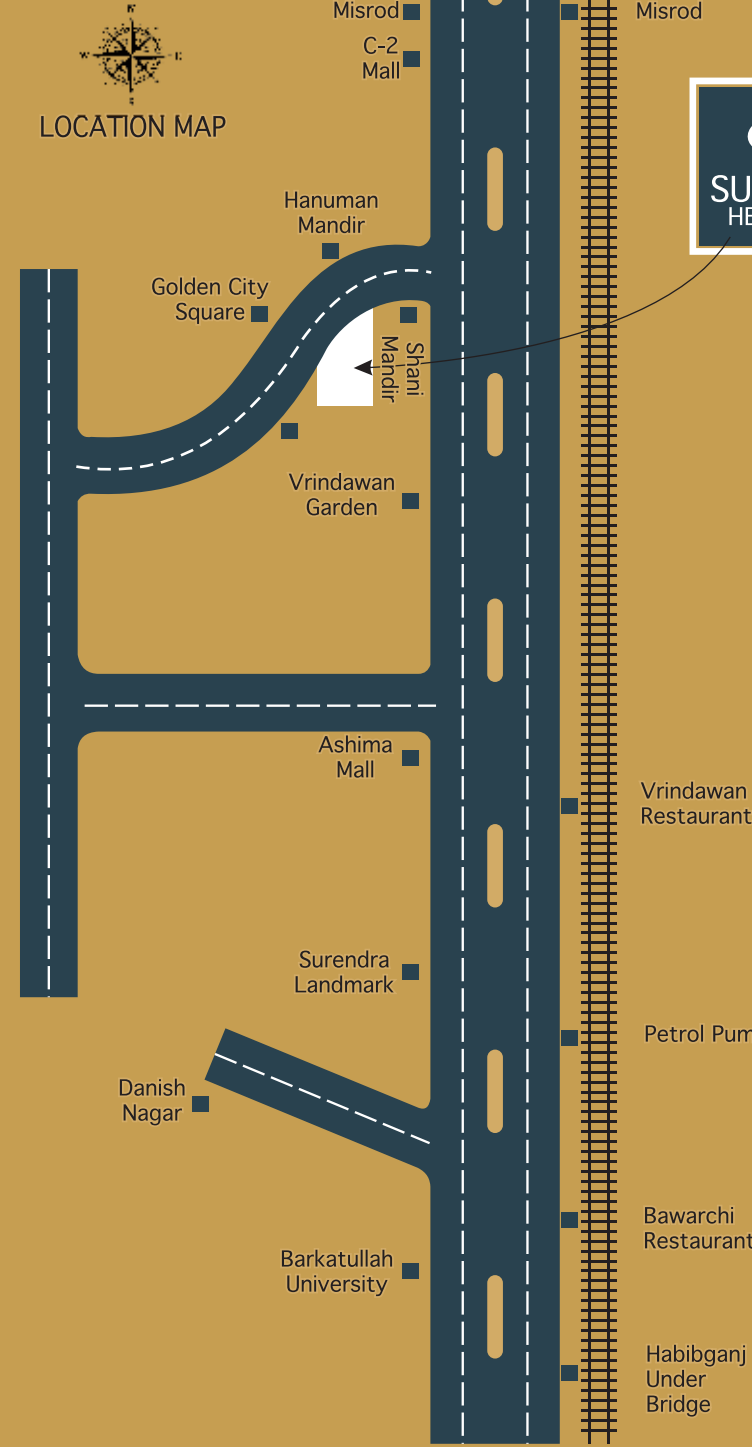

2/3/4 BHK LUXURIOUS FLATS  
@ HOSHANGABAD ROAD, BHOPAL



CORPORATE OFFICE : S-9, SANCHI COMPLEX, OPP. BOARD OFFICE, SHIVAJI NAGAR, BHOPAL

**CALL : 0755-257 2019**

Disclaimer: This e-mail is intended for the named recipient(s) only and may contain confidential or legally privileged information. If you are not an addressee you may not disclose, use or forward any part of this message. If it has been received in error, kindly delete it and notify us, either by email-reply, or by telephone on 0755-2493240. Thank you.



EXPERIENCE THE SPLENDOR  
THAT CAN'T BE PUT INTO WORDS

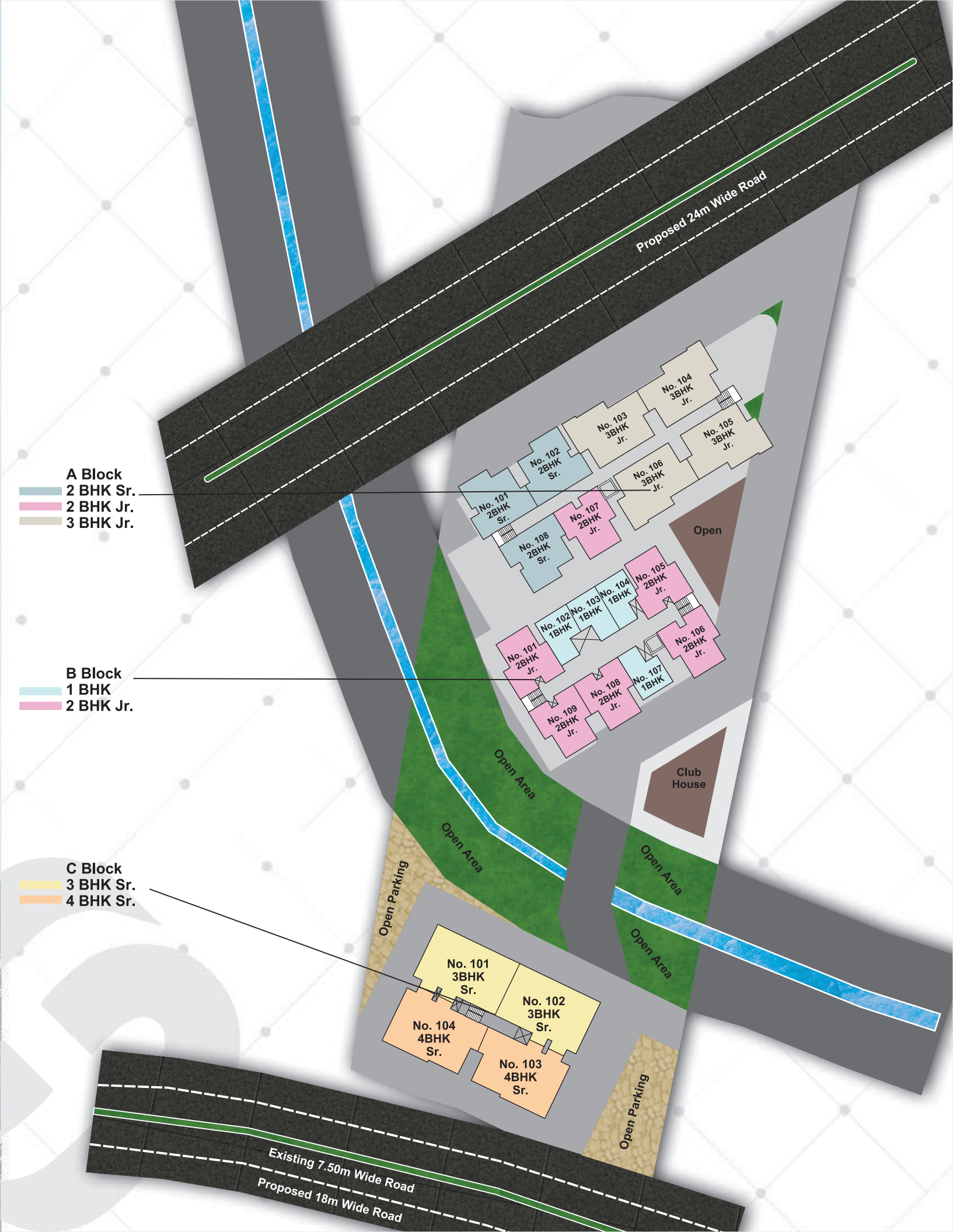



2-BHK - JUNIOR (FLAT)

SUPER BUILT-UP AREA  
900 Sq. Ft.

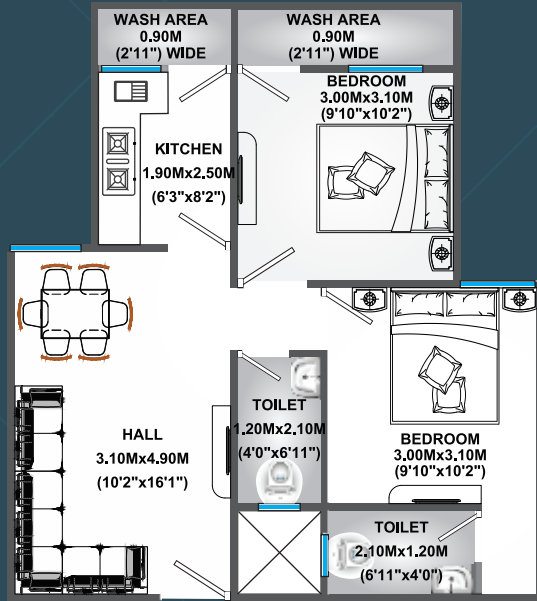

1-BHK (FLAT)

SUPER BUILT-UP AREA  
550 Sq.Ft.

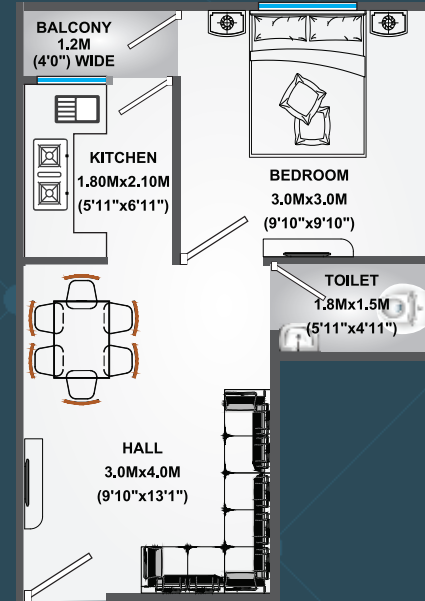

3-BHK (FLAT)

SUPER BUILT-UP AREA  
1750 Sq.Ft.

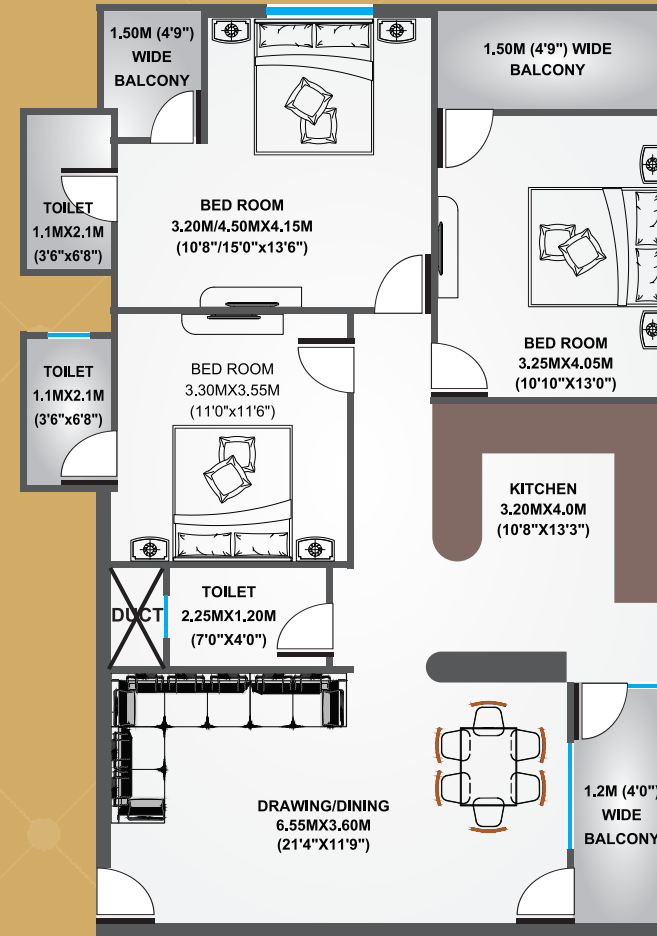

4-BHK (FLAT)

SUPER BUILT-UP AREA  
1800 Sq.Ft.

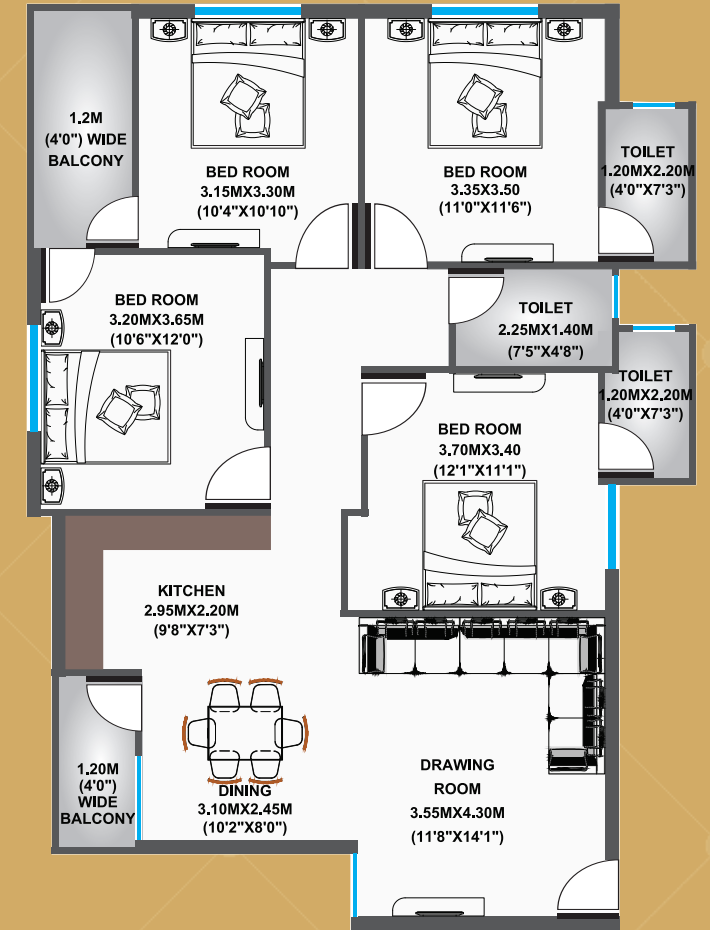

3-BHK JUNIOR (FLAT)

SUPER BUILT-UP AREA  
1300 Sq.Ft.

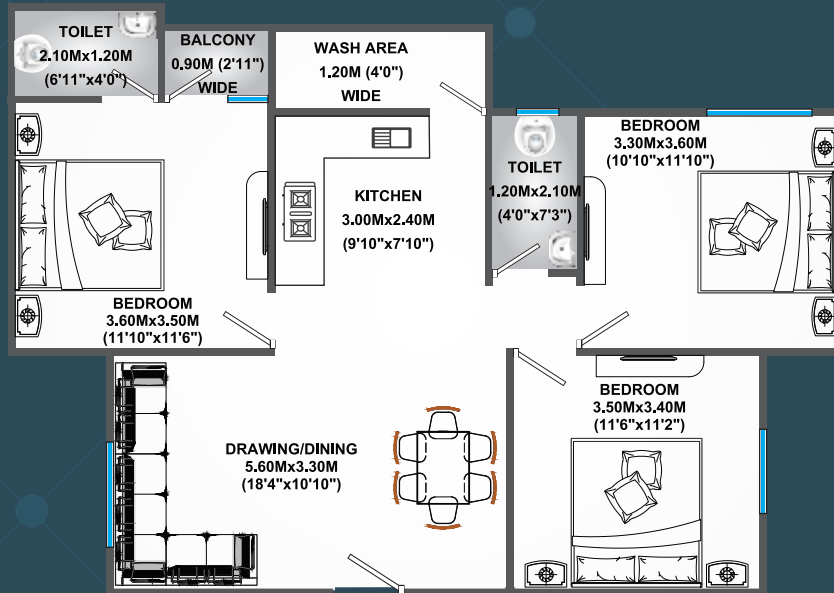

2-BHK SENIOR (FLAT)

SUPER BUILT-UP AREA  
1100 Sq.Ft.

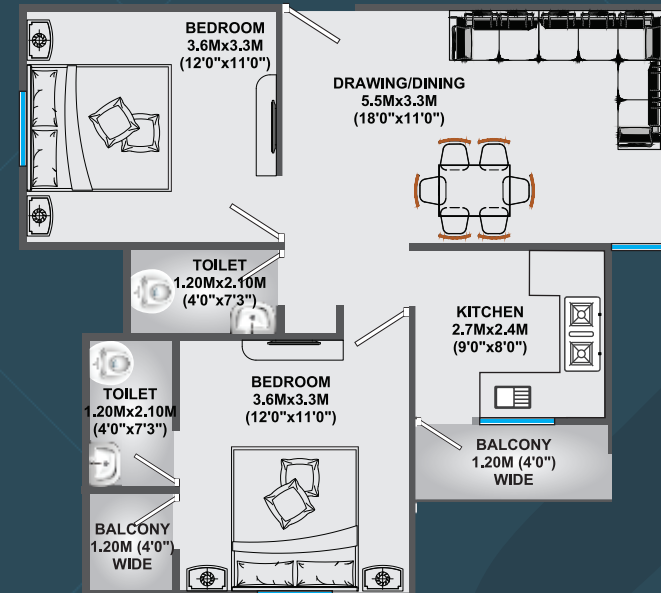



# SPECIFICATIONS...



## Structure

Earthquake resistant, Safe & Sound R.C.C Framed Structure with best material components.



## Painting

Plastic paint of pleasing shades on internal walls and water Proof paint on external wall, oil paint on steel members.

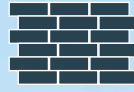

## Walls

A class flyash bricks/AAC block work with double coat plaster on external walls & single coat plaster on internal walls.



## Electrification

Concealed copper wiring with ISI marked modular electrical fitting.

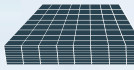

## Floorings

Vitrified tile flooring having greater strength in entire area.



## Water proofing

Water proofing in all toilets & terrace areas to prevent seepage.

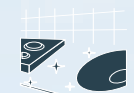

## Kitchen

Granite Platform with stainless steel sinks and glazed tiles up to 2' height dado.



## Lift

Top quality & stylish design with automatic rescue, 6 Passenger Lift.



## Toilet

Glazed tile dado up to Door height in pleasing colors with superior quality sanitary.



## Podium Parking

High class podium parking & open parking available.

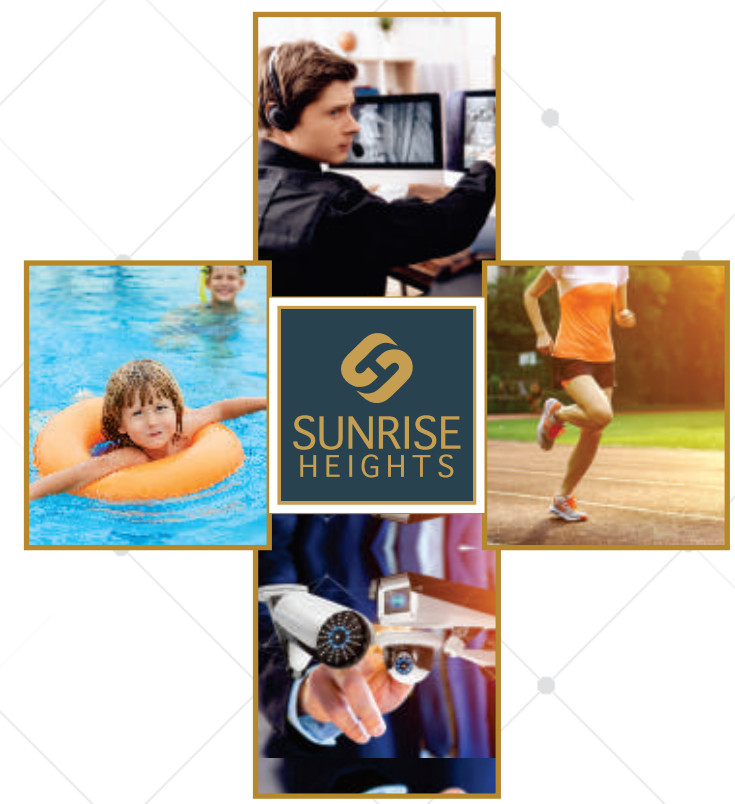

## CAMPUS AMENITIES

- Lift.
- Secured Campus with mega entrance gate.
- Lush green garden.
- Security Guard with security check point.
- Adequate water supply.
- Ample parking space.
- Children play area.
- Rain water harvesting.
- Sewage treatment plant.
- Fire safety treatment.