

es
re
ag
d i
ect
hou
am

Grandeur *Heights*

Premium apartments for premium people

Welcome to a
luxurious lifestyle at

Grandeur Heights

A speck of a dream, stars in your eyes and a zest for fine living, together they weave your gilded dreams into tangible reality. An integral part of acres of group housing, **Grandeur Heights** is situated at a prime location in E-8 Extension, Near Danapani Restaurant, Bhopal. With options of 2 & 3 BHK, **Grandeur Heights** gives you a life set in luxury with its well planned infrastructure along with aesthetic outdoor landscaping. To own an apartment in **Grandeur Heights** is indeed an opportunity of a lifetime for you and your loved ones.

Grandeur Heights

Exquisitely designed with well-planned spaces, state-of-the-art designs, and the most contemporary and innovative lifestyle facilities, this urban oasis promises a life you've always dreamt of.

Grandeur Heights is an iconic tower of managed private residences that offer a lifestyle unparalleled in luxury and uncompromising in living. With architectural brilliance and a quiet elegance, the tower houses opulent, lavish apartments with the finest amenities.



Fun and Frolic for all generations to enjoy

Great care has gone into creating everything at Coral Casa. Whether it's recreational zones or lounging areas, facilities at this project have been designed to help people come together.

- Landscaped Gardens
- Table Tennis • Water Bodies
- Swimming Pool • Card Room
- Carom • Pool Table • Shaded Sitting
- Kids Play Zone • Tot-lots

Grandeur Heights

The use of imagination engineering and unique design principles ensures that no apartment overlooks another thereby offering refreshing cross-ventilation and large ribbons of pure, natural sunlight.



Fun and Frolic for all generations to enjoy

Great care has gone into creating everything at Coral Casa. Whether it's recreational zones or lounging areas, facilities at this project have been designed to help people come together.

- Landscaped Gardens
- Table Tennis • Water Bodies
- Swimming Pool • Card Room
- Carom • Pool Table • Shaded Sitting
- Kids Play Zone • Tot-lots

TYPE A

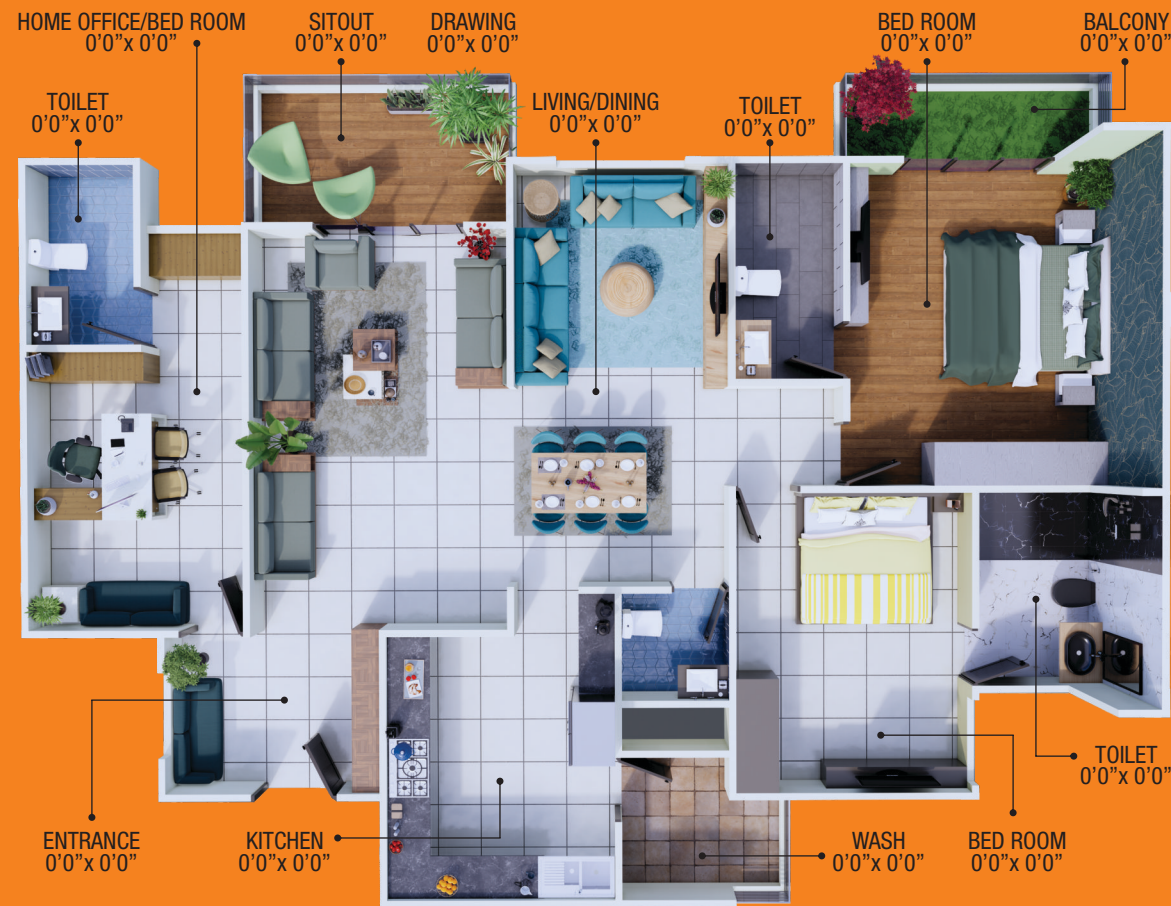

AREA 1500 SQFT.

TYPE B



AREA 1500 SQFT.

Amenities For Comfort Living

- Fully enclosed campus secured with high-tech systems.
- Beautifully landscaped Open Spaces.
- Grand Entrance Plaza and Campus Gateway.
- Dedicated children's play area.
- Wide Cement Concrete & Paved Roads throughout the township.
- Stylish Street Lamps in entire campus.
- Underground Cabling for Electrification & Telecommunication.
- Separate parking for visitors.
- Water Harvesting system.
- Centralized Water Supply.
- Convenience Shopping for Daily needs .
- Refined Neighborhood through Class Uniformity.
- Multi game courts.
- Jogging / Cycling tracks.
- Reflexology & Meditation centres.
- Approved by Town and Country Planning Department.
- Loan Facility by leading Banks.

Specification

STRUCTURE

- Safe and sound - Quality controlled RCC frame structure with column, beams.

WALLS

- "A" class brick masonry.

WALL & CEILING FINISH

- Interior - Putty finish with oil bound distemper.
- Exterior - Sand fast plaster with weather proof paint.

FLOORING

- Parking area - Tiles.
- Courtyard, balcony, step out varandah - Tiles.
- Drawing room, dining room, bedrooms, kitchen - Vitrifide tiles 2'x2'.
- Staircase - Marble flooring with SS railing.
- Toilets floor - Matt finish anti skid ceramic tiles.

KITCHEN

- Dado of ceramic tiles, upto a hight of 2 feet from the platform.
- Kitchen platform with granite top.
- Stainless steel sink.

TOILET

- Dado of ceramic tiles, upto 6 feet high.
- Reputed brands of high quality ceramic ware and CP fittings.
- Provision for geyser.

DOOR

- Entrance door - Pressed steel (Dewas) section with panelled door shutters.
- Internal doors - Pressed steel (Dewas) section/ flush door shutter.

WINDOWS

- Powder coated aluminum window with pin heads glass secured with M.S. grills.

ELECTRIFICATION

- Concealed cooper wiring with ISI mark electrical fittings.

WATER SUPPLY

- Water supply by tubewell / sumpwell.

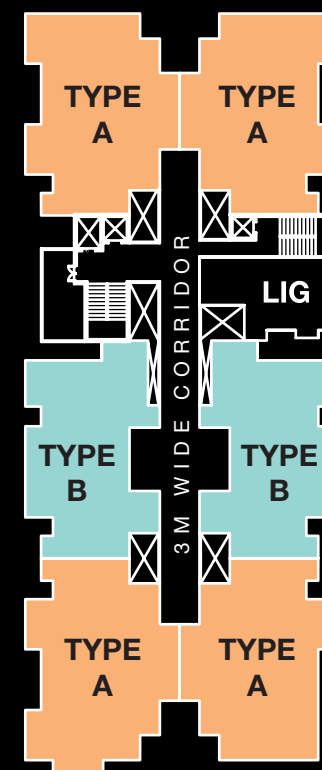

Fun and Frolic for all generations to enjoy

Great care has gone into creating everything at Coral Casa. Whether it's recreational zones or lounging areas, facilities at this project have been designed to help people come together.

- Landscaped Gardens
- Table Tennis • Water Bodies
- Swimming Pool • Card Room
- Carom • Pool Table • Shaded Sitting
- Kids Play Zone • Tot-lots

LOCATION

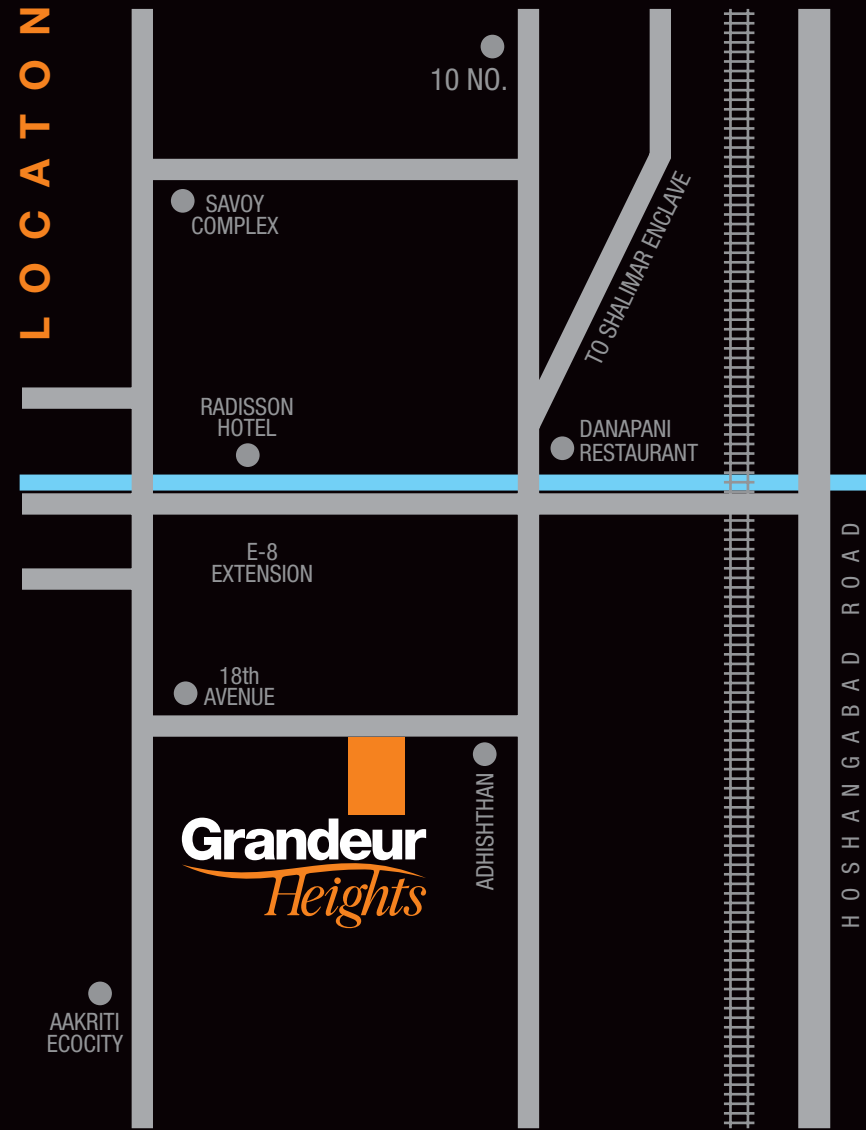

Builders & Developers



E-7/821, Arera Colony
Near Basant Kunj, Bhopal 462016
Mo: 9425006797, 8939570237
builderschetanya@gmail.com

Site: E-8 Extension,
Near Danapani Restaurant,
Bhopal, M.P. 462042
Tele.: 0755000000