

THE KEY TO YOUR DREAM ABODE

Developed By : Green Pearl Infra



# RIVERA HEIGHTS



### **Redefining Luxury, Redefining Happiness**

Welcome to this masterfully crafted architectural wonder that offers the perfect balance of sophistication and comfort with state-of-the-art amenities and facilities. This epitome of refined living connects you to the tranquility of quality life. The project boasts an array of top-tier amenities, including a fully equipped gymnasium, clubhouse, and landscaped gardens, ensuring that every aspect of your lifestyle is catered for.

We believe that every detail matters, and thus every aspect of the project has been carefully planned and executed to provide an unparalleled living experience and create a community that truly stands out. The meticulously designed 2 & 3 BHK apartments spread over 4 high-rise towers create an ambiance of elegance and luxury, offering a unique and uniform living experience to every occupant in every tower.

Discover the ultimate in modern living at Rivera Heights, where comfort and luxury come together to create the perfect home.

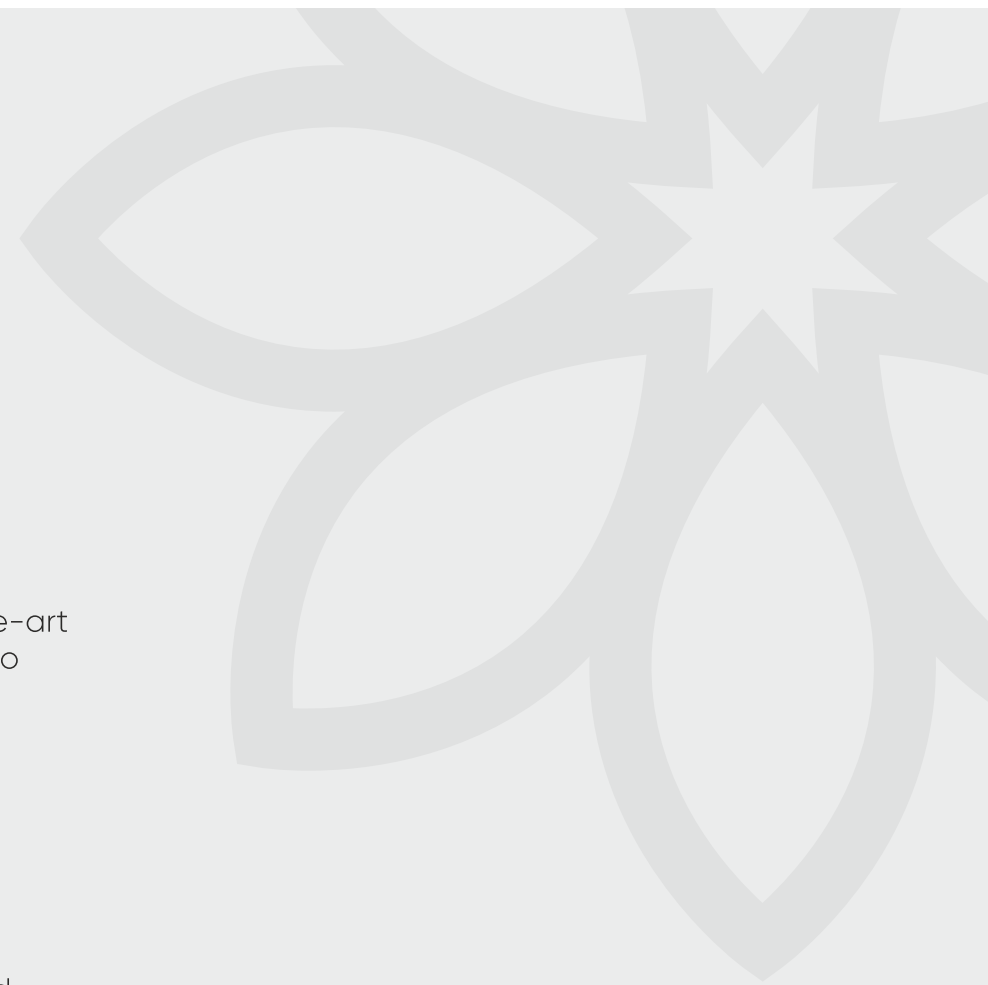





“ A new standard of urban living that helps you capture the beautiful moments of life with spacious & well-planned residences ”





## AMENITIES

1. CENTRAL PARK
2. CLUBHOUSE HALL/  
INDOOR GAMES
3. CHILDREN PLAY AREA
4. SENIOR CITIZEN SIT-OUT
5. SEMI COVERED SIT-OUT
6. SECURITY CABIN

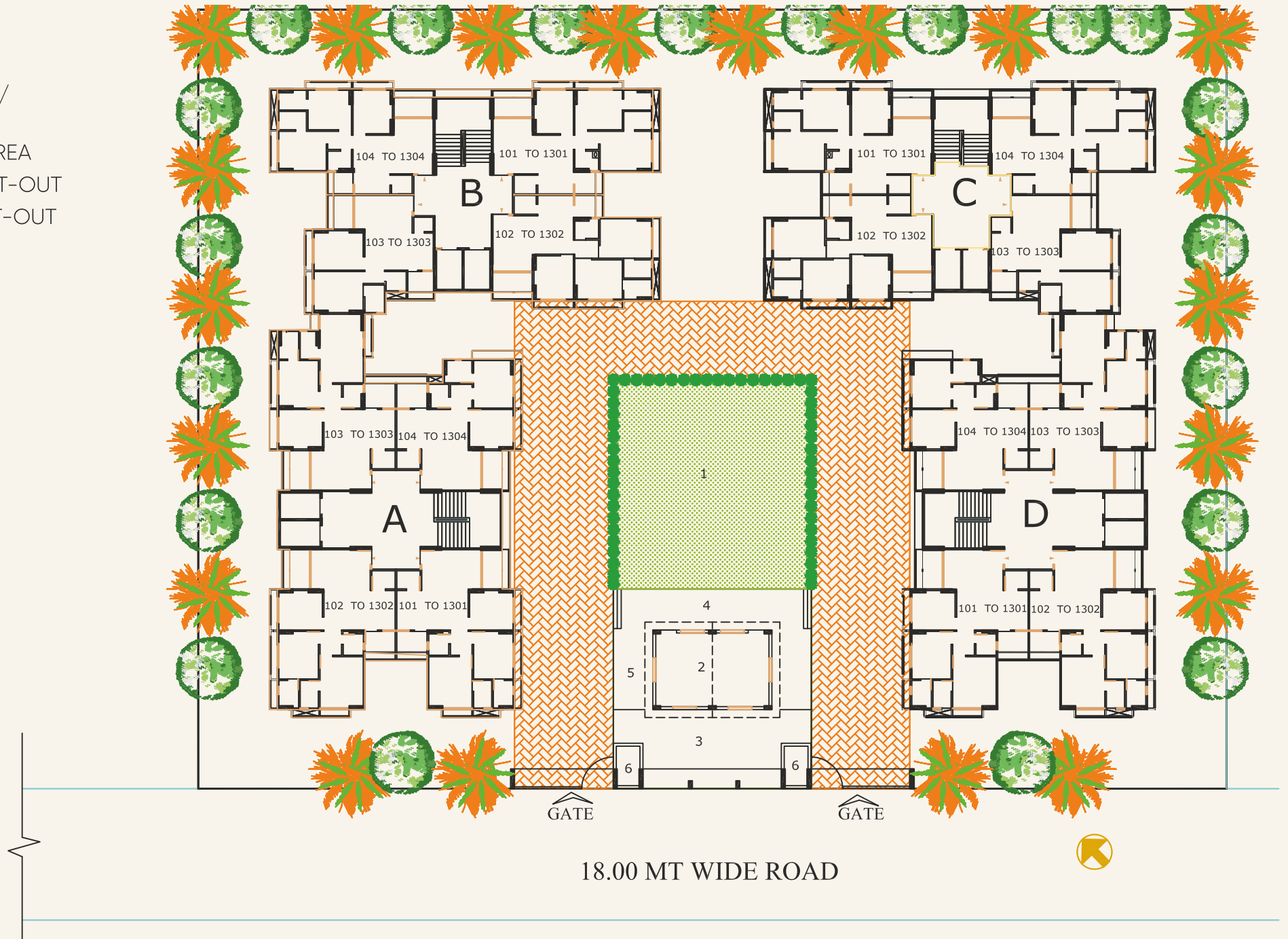



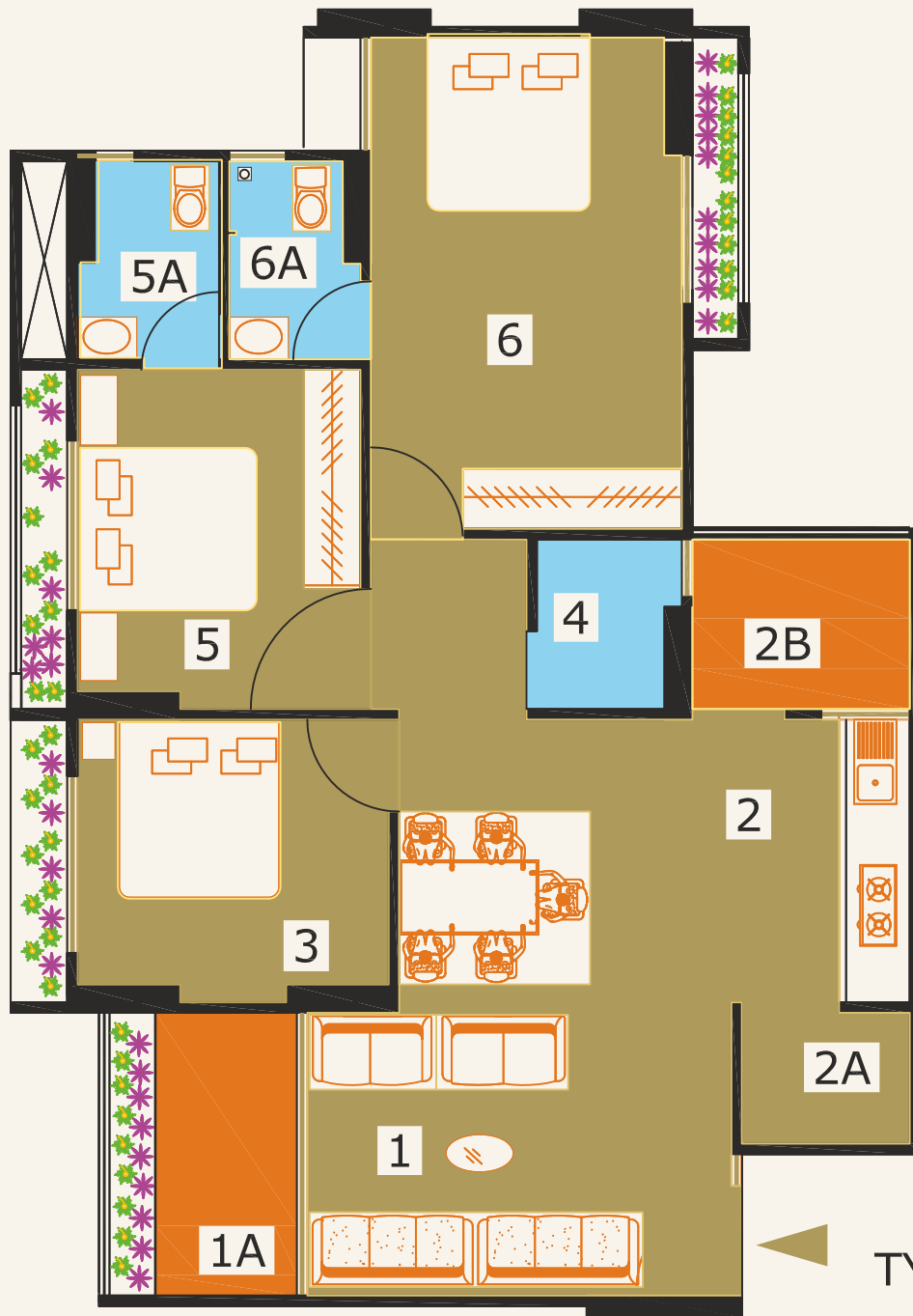

TYPE-1

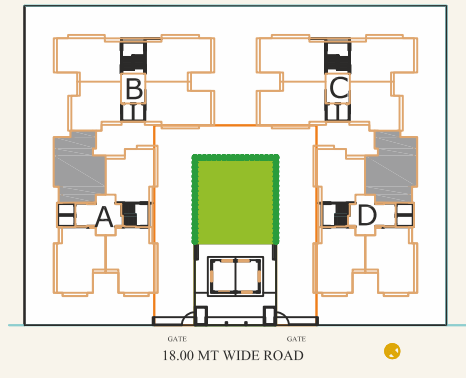

### LEGEND

A 103 TO 1303  
D 103 TO 1303

NO	SPACES	AREA
1	LIVING/DINN. ROOM	15'0"X20'6"
1A	BALCONY	10'0"X5'0"
2	KITCHEN	8'0"X10'0"
2A	STORE	6'0"X4'7"
2B	WASH	7'9"X5'4"
3	BED ROOM	11'0"X10'0"
4	G.TOILET	5'0"X6'0"
5	BED ROOM	10'0"X12'0"
5A	TOILET	5'0"X7'0"
6	BED ROOM	11'0"X17'4"
6A	TOILET	5'0"X7'0"

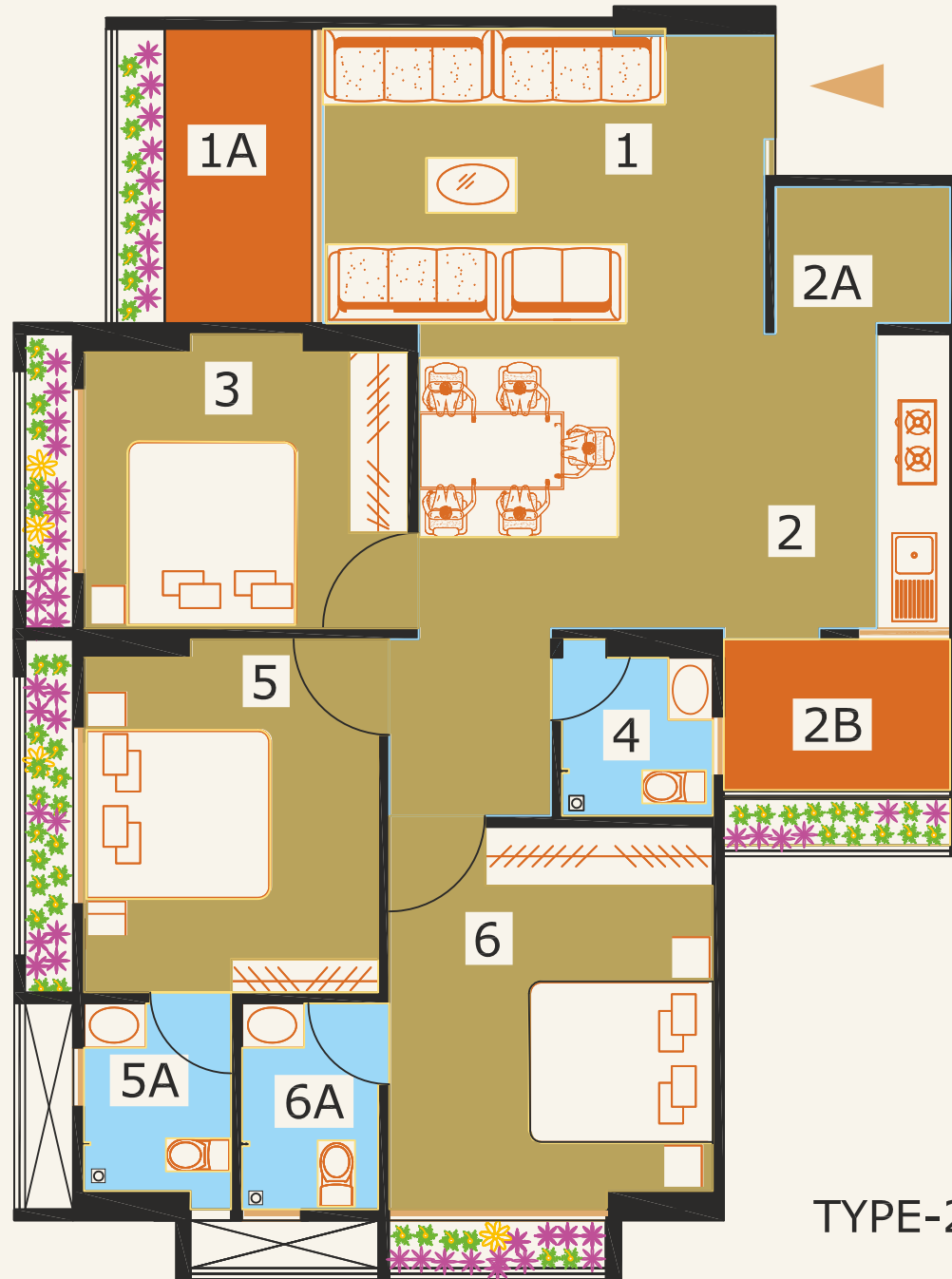

TYPE-2

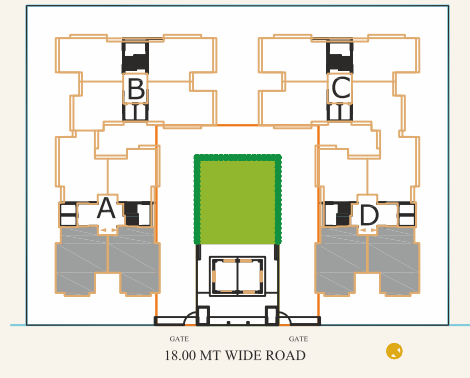

**LEGEND**

- A 101 TO 1301
- A 102 TO 1302
- D 101 TO 1301
- D 102 TO 1302

NO	SPACES	AREA
1	LIVING/DINN. ROOM	15'0"X20'4"
1A	BALCONY	10'0"X5'0"
2	KITCHEN	8'0"X10'0"
2A	STORE	6'0"X4'7"
2B	WASH	7'9"X5'4"
3	BED ROOM	11'0"X10'0"
4	G.TOILET	5'0"X6'0"
5	BED ROOM	10'0"X12'0"
5A	TOILET	5'0"X7'0"
6	BED ROOM	11'0"X13'0"
6A	TOILET	5'0"X7'0"



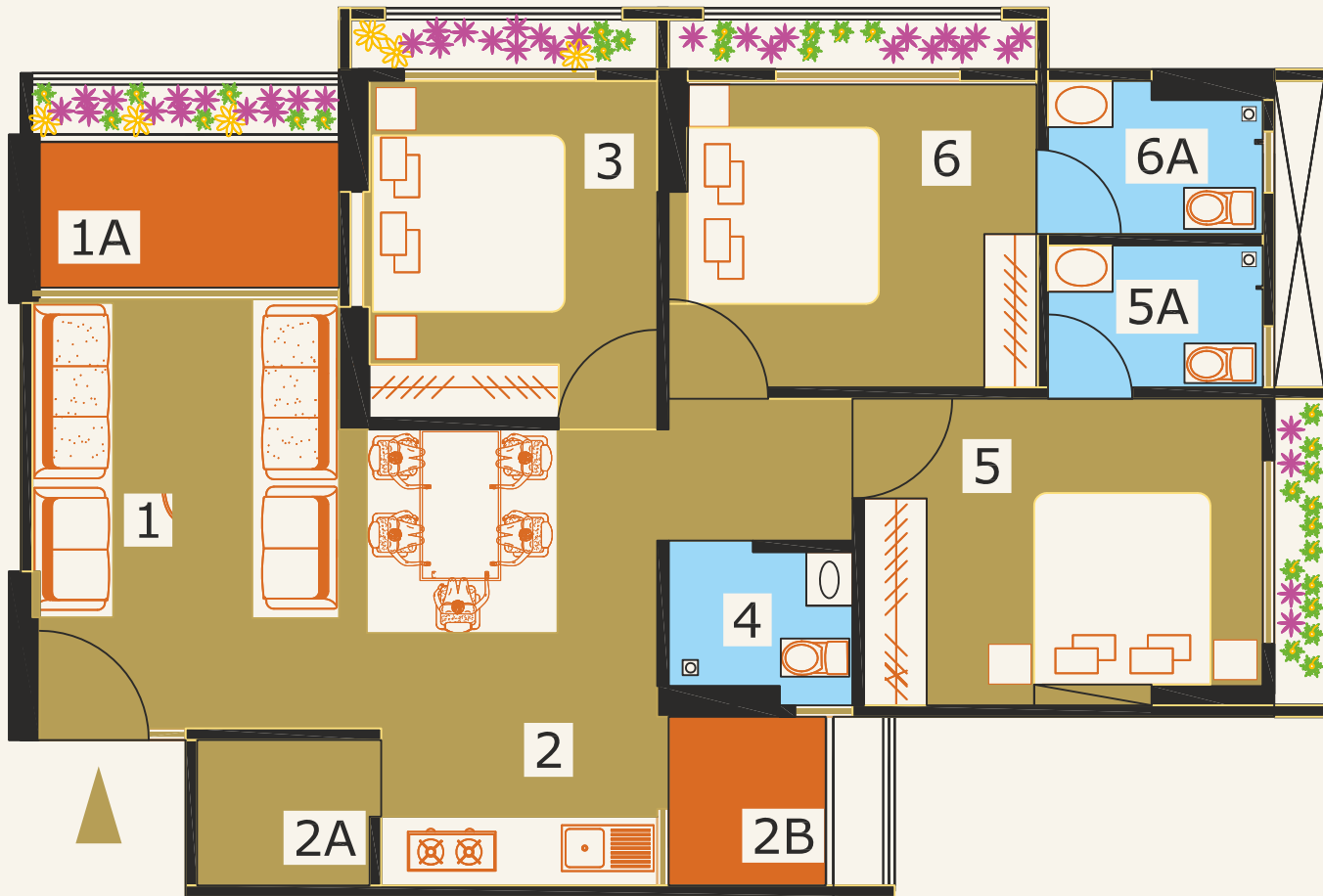

TYPE-3

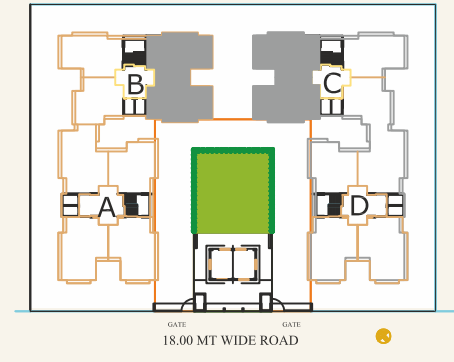

**LEGEND**

- B 101 TO 1301
- B 102 TO 1302
- C 101 TO 1301
- C 102 TO 1302

NO	SPACES	AREA
1	LIVING/DINN. ROOM	20'4"X14'0"
1A	BALCONY	10'0"X5'0"
2	KITCHEN	9'0"X7'0"
2A	STORE	5'7"XX4'9"
2B	WASH	5'4"XX5'6"
3	BED ROOM	10'0"x11'0"
4	G.TOILET	6'0"X5'0"
5	BED ROOM	10'0"X13'0"
5A	TOILET	7'0"X5'0"
6	BED ROOM	12'0"X10'0"
6A	TOILET	7'0"X5'0"

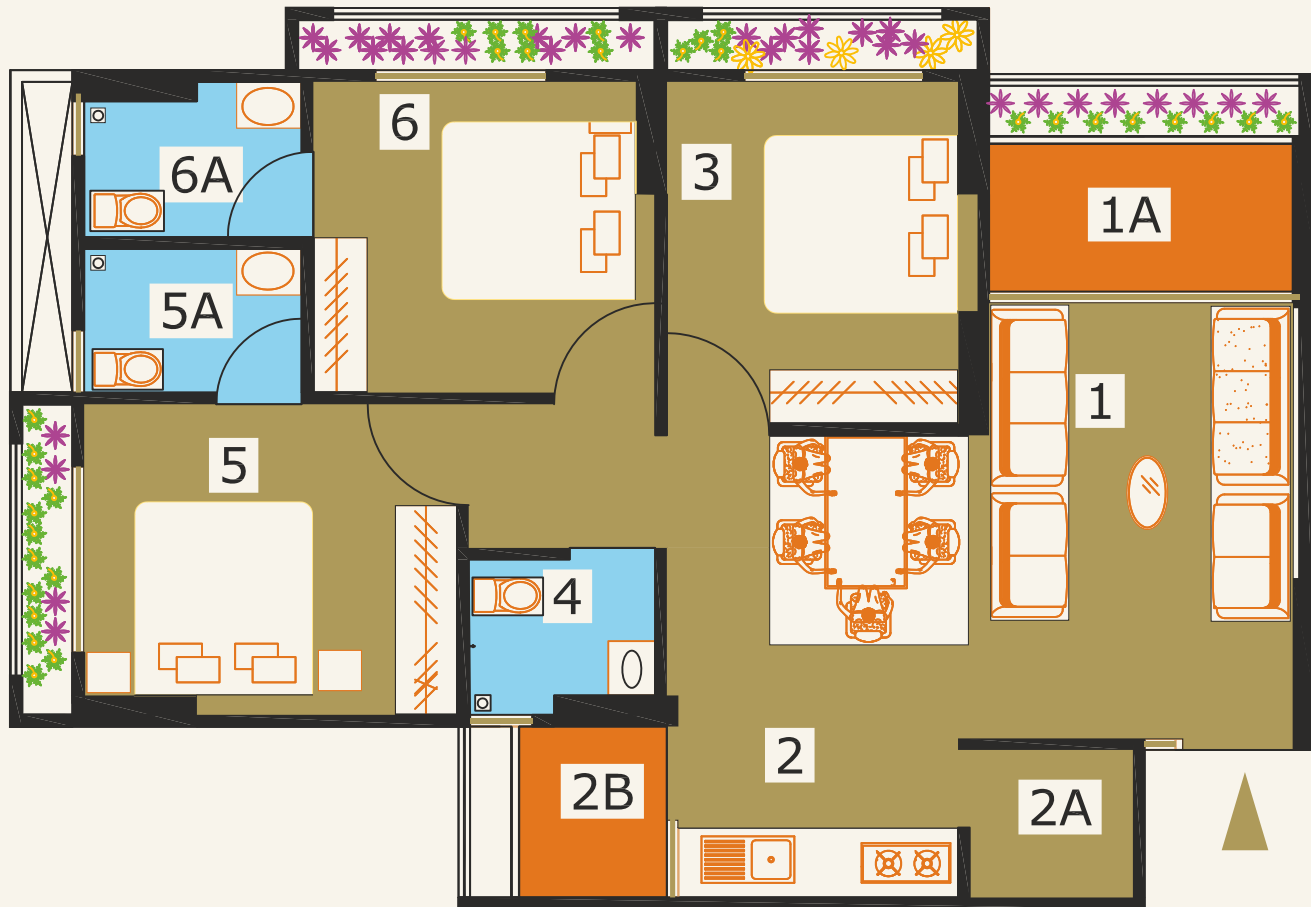

TYPE-4

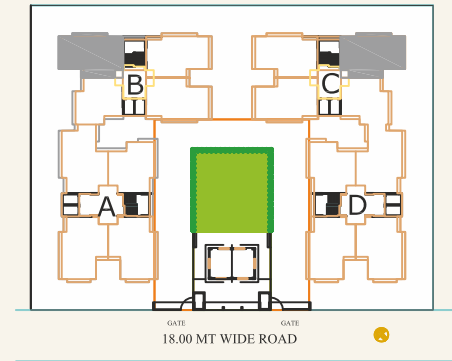

**LEGEND**

B 104 TO 1304  
C 104 TO 1304

NO	SPACES	AREA
1	LIVING/DINN. ROOM	20'4"X14'0"
1A	BALCONY	10'0"X5'0"
2	KITCHEN	9'0"X7'0"
2A	STORE	5'7"XX4'9"
2B	WASH	5'4"XX5'6"
3	BED ROOM	11'0"X10'0"
4	G.TOILET	6'0"X5'0"
5	BED ROOM	12'0"X10'0"
5A	TOILET	7'0"X5'0"
6	BED ROOM	11'0"X10'0"
6A	TOILET	7'0"X5'0"



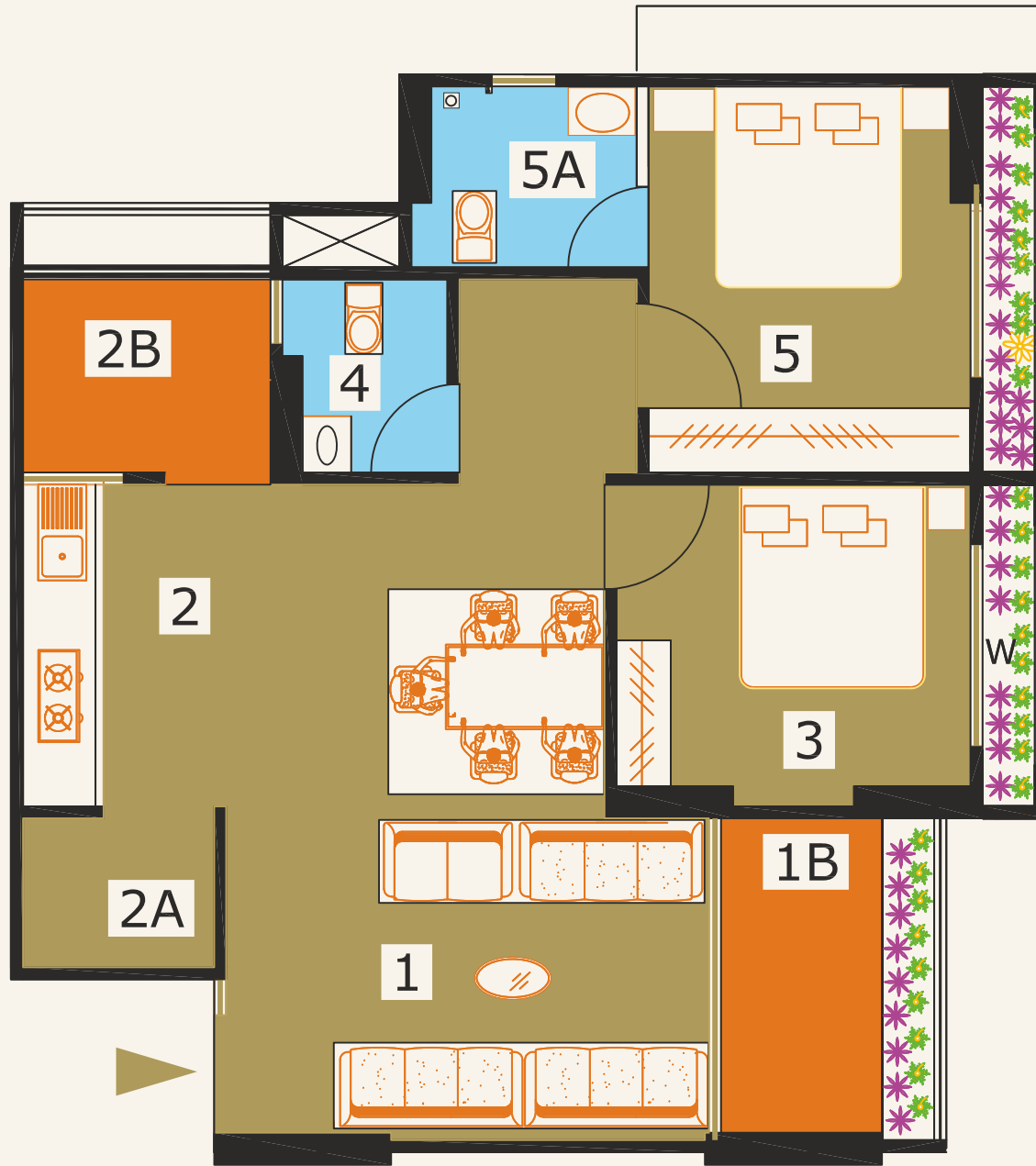

TYPE-5

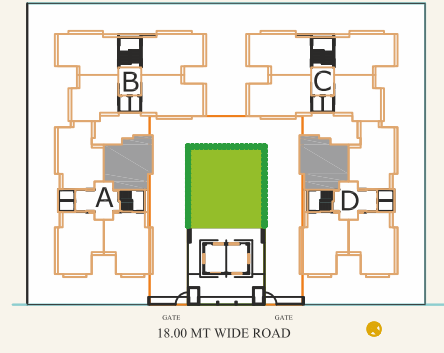

### LEGEND

A 104 TO 1304  
D 104 TO 1304

NO	SPACES	AREA
1	LIVING/DINN. ROOM	15'0"X20'6"
1A	BALCONY	10'0"X5'0"
2	KITCHEN	8'0"X10'0"
2A	STORE	6'0"X4'7"
2B	WASH	7'9"X5'4"
3	BED ROOM	11'0"X10'0"
4	G.TOILET	5'0"X6'0"
5	BED ROOM	10'0"X12'0"
5A	TOILET	7'0"X5'6"

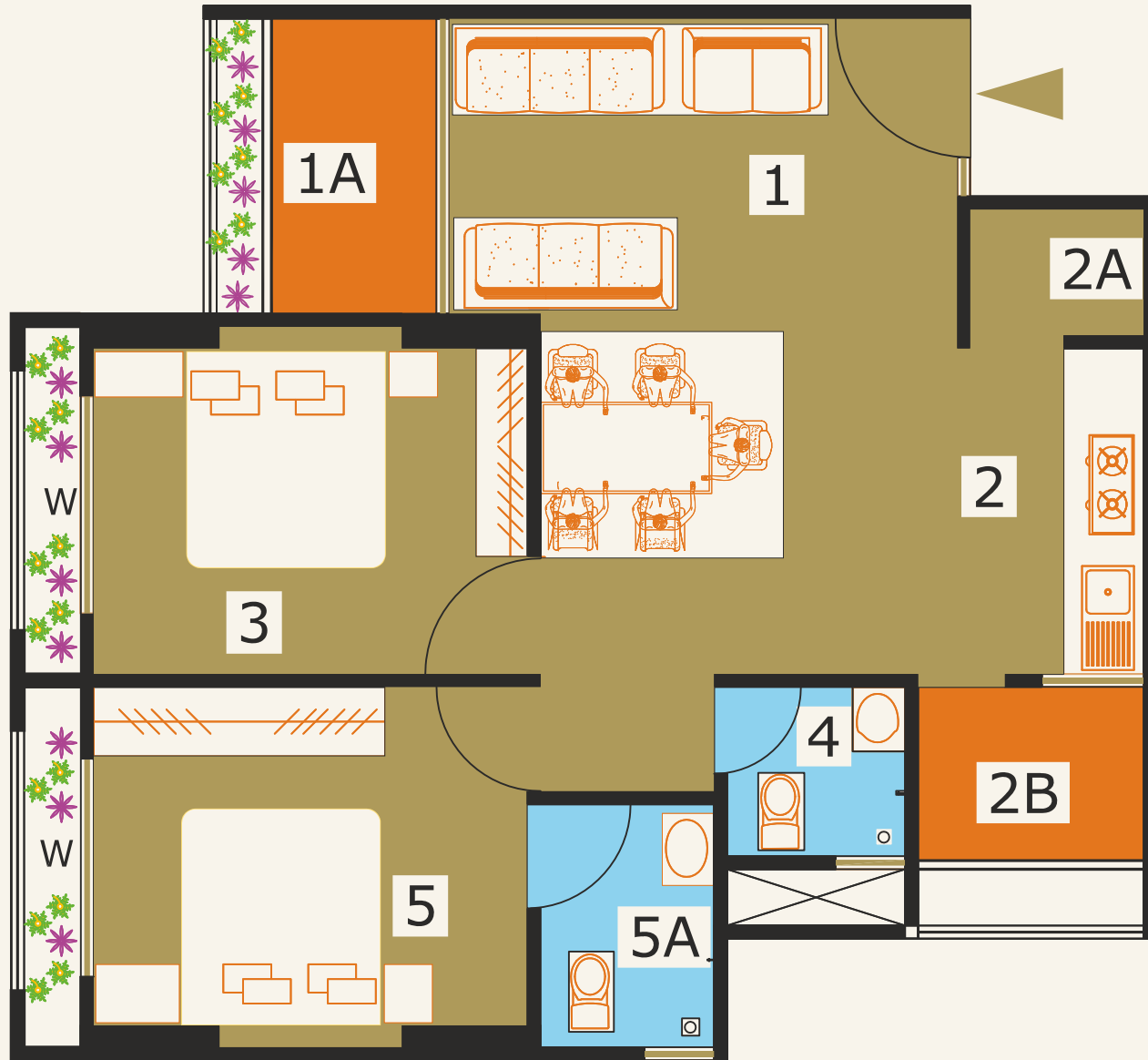

TYPE-6

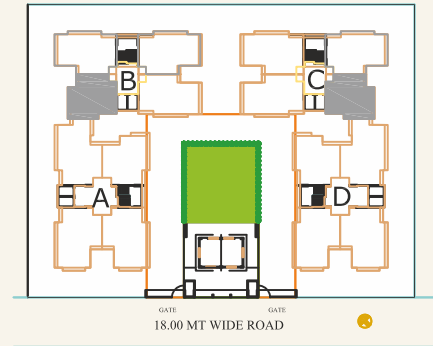

**LEGEND**

B 103 TO 1303  
C 103 TO 1303

NO	SPACES	AREA
1	LIVING/DINN. ROOM	14'7"X18'10"
1A	BALCONY	10'0"X5'0"
2	KITCHEN	9'0"X8'0"
2A	STORE	5'0"X5'0"
2B	WASH	6'6"X5'3"
3	BED ROOM	12'6"X10'0"
4	G.TOILET	5'0"X4'9"
5	BED ROOM	12'6"X10'4"
5A	TOILET	5'0"X7'0"







# Specifications



## **Kitchen**

- Granite top platform with S.S. sink & designer tiles dado up to beam bottom



## **Doors**

- Decorative main door with wooden frame, all internal doors are flush door with oil paint color & accessories.



## **Windows**

- Aluminum section sliding domal section windows with plain glass & all 4 side stone.



## **Toilet & Plumbing**

- Matt tiles on floor, designer glazed tiles up to lintel level, concealed plumbing and premium quality sanitary ware and Bath fittings equivalent to Jaguar, Cera or Hindware.



## **Structure**

- Earthquake resistance R.C.C. frame structure with Brick masonry wall



## **Wall finish**

- Internal single coat plaster with white putty & external textured plaster with acrylic paint.



## **Flooring**

- Good quality Vitrified tiles in entire apartment.
- China mosaic in terrace for heat reflection & water proofing.



## **Electrification**

- Three phase ISI Concealed copper wiring with Least electrical safety features, modular switches & MCB with sufficient electric points.





# A Lifestyle of Unmatched Luxury

Breathe in the beauty of life as you reside in proximity to lush landscapes, enjoying the natural splendor of your surroundings. Our project boasts a range of luxurious amenities that cater to your every need, from a state-of-the-art fitness center to a special space to rejuvenate. Experience the ultimate in opulent living, where every moment is an indulgence.



Entrance Plaza



Security Cabin



Visitor's Parking



RCC/ Stone/ Paved Road



24X7 CCTV Camera



Party Lawn with Sit-Outs



Indoor Gymnasium



Senior Citizen Seating Area



Children's Play Area with Seating



Entry Lounge



Power Backup for Elevator and Common Area



Fire Safety



Multi Lift Tower including Stretcher Lift



Basement and Hollow Plinth Parking Facility







**NEAR BY LOCATION**

The Leela Hotel	6.2 km
Mahatma Mandir	3.9 km
Sachivalay	2.6 km
Randheja	9.4 km
Gandhinagar Railway Station	5.5 km







FP no. 979, 2/3 Sector 26, Pethapur-Randheja Road,  
Nr. Railway Crossing, Gandhinagar, Gujarat-382026  
+91 74330 37000 | +91 74330 38000 | rivera@gmail.com

Developed By:  
Green Pearl Infra

Architect:  
Himanshu Thakker

**सक्षम्** | **SAKSHAM**  
**CONSULTANTS**  
Structural Engineers  
& Project Management Consultants

