

KALASAGAR  
SKYLINE



4 BHK ULTRA LUXURIOUS ABODES  
@ SHAHIBAUG





KALA



# BASEMENT PLAN

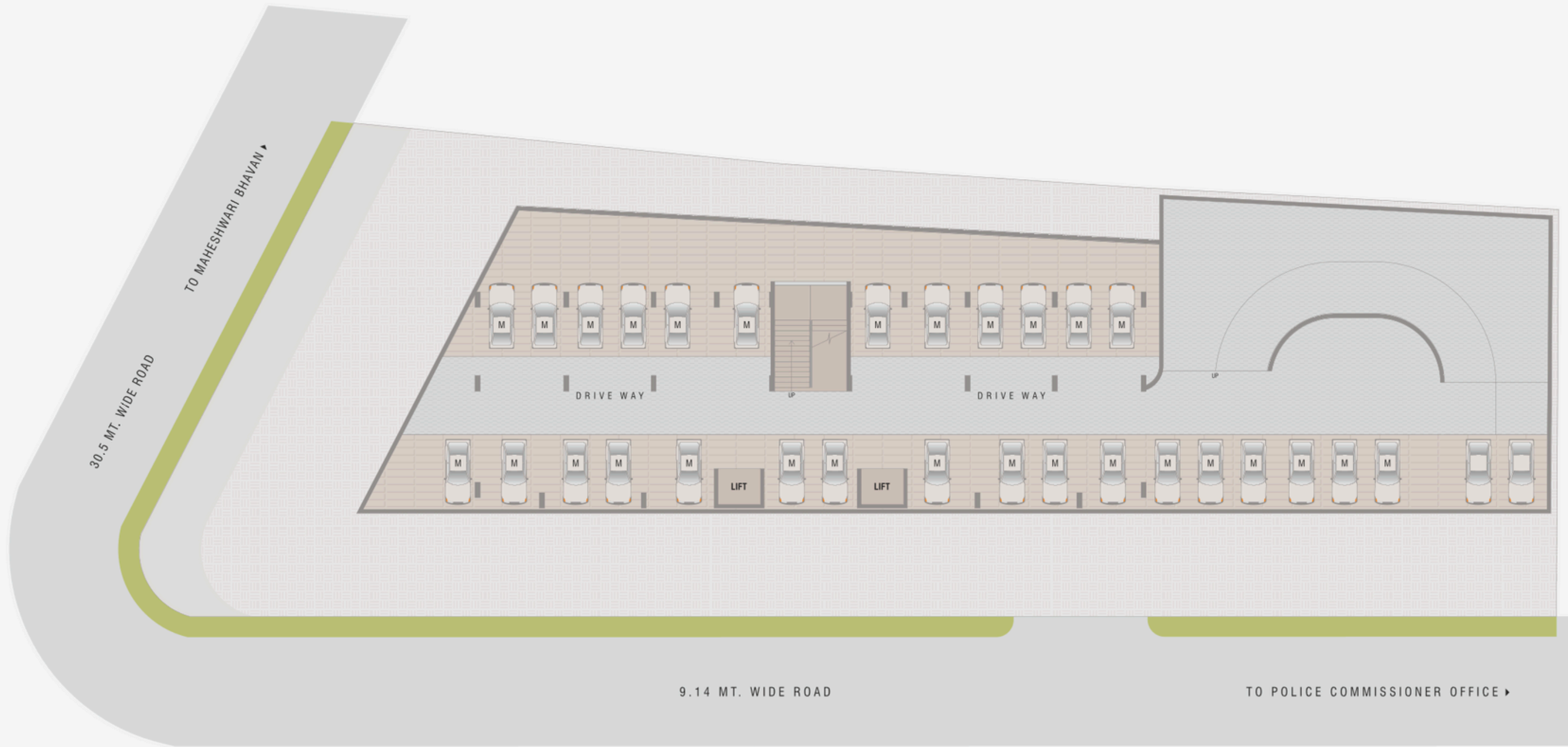

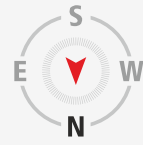

# GROUND FLOOR PLAN

## AMENITIES

- |                            |                                |                                   |
|----------------------------|--------------------------------|-----------------------------------|
| ● ATTRACTIVE ENTRANCE GATE | ● SENIOR CITIZEN SITOUT        | ● DROP OFF ZONE                   |
| ● LANDSCAPE GARDEN         | ● CC TV. SURVEILLANCE          | ● SECURITY CABIN                  |
| ● CLUB HOUSE               | ● AUTOMATIC BRANDED LIFT       | ● ALLOTTED PARKING                |
| ● INDOOR GAMES             | ● ATTRACTIVE ENTRANCE FOYER    | ● BASEMENT PARKING                |
| ● GAZEBO                   | ● INTERNAL PAVED / TRIMIX ROAD | ● DG POWER BACKUP FOR COMMON AREA |
| ● CHILDREN PLAY AREA       | ● PRIVATE FOYER                | ● SOLAR POWER FOR COMMON AREA     |





# 1ST TO 14TH FLOOR PLAN



# TYPICAL UNIT PLAN



## AREAS IN METERS

01. Vestibule	- 1.83 x 1.99
02. Bedroom 1	- 3.19 x 3.97
03. Toilet 1	- 2.04 x 1.50
04. Bedroom -2	- 3.38 x 4.97
05. Toilet 2	- 1.53 x 2.45
06. Pooja Room	- 1.53 x 1.10
07. Kitchen	- 3.35 x 4.05
08. Store	- 1.53 x 1.83
09. Washyard	- 3.35 x 1.53
10. Drawing Room	- 3.95 x 6.10
11. Living / Dining	- 6.13 x 4.58
12. Balcony	- 6.03 x 2.03
13. Bedroom 3	- 3.65 x 6.10
14. Toilet 3	- 1.82 x 2.74
15. Bedroom 4	- 3.35 x 5.58
16. Toilet 4	- 1.82 x 2.74

**STRUCTURE**

- Earthquake resistant RCC Frame Structure.
- Basement and hollow plinth for ample parking.
- Professionally water-proofed terrace with china mosaic for thermal insulation.

**WALL FINISH**

- Internal Plaster (with Birla/J.K. Putty).
- External Walls with a Mala/Sand Face Plaster with Acrylic Paint.

**FLOORING**

- Good quality Vitrified Tiles (800 X 1200mm) Flooring in Drawing Room, Bedroom, Kitchen & Dining Area.
- Wooden print Vitrified tile in Balcony & Varandah.
- Good quality Designer Glaze Wall Tiles (48" X 24") up to Lintel Level in Bathrooms.

**DOORS & WINDOW**

- Decorative main door with Laminate Finish.
- Laminated internal wooden flush doors with imported wooden frame & SS hardware.
- High quality powder coated/Anodized Aluminium Sliding windows with clear glass 5mm.

**ELECTRICAL & POWER SUPPLY**

- 3 Phase (15 KW) concealed electrical copper wires (ISI) with ample electrical points (Polycab/RR Cable or similar make).
- Premium quality modular Switches ISI.
- Provision for Land Line Internet and DTH connections.
- Geyser points in all bathrooms.
- Power from Torrent power.
- Generator for common area (D.G.).

**PLUMBING AND SANITATION**

- Premium quality sanitary ware (ROCA/CERA/JAGUAR) and CP fittings in all bathrooms (Jaguar/Plumber/Roca or similar make).
- High quality UPVC/CPVC plumbing line (Supreme / Astral / Prince).

**KITCHEN**

- Premium quality Vitrified kitchen platform with SS Sink.
- Premium quality glazed tiles upto lintel level.
- Provision for Electrical, Water points & convenient water Purifier Installation, Chimney Refrigerator Points.



RERA - PROJECT REGISTRATION NUMBER :

PR/GJ/AHMEDABAD/AHMEDABAD CITY/AUDA/RAA13290/090424/300428

Website : www.gujrera.gujarat.gov.in

DEVELOPER

**KALA** GROUP
**V-3 CONSTRUCTION COMPANY**

Kala Group of Companies  
17, Times Corporate Park, Behind Sindhu  
Bhawan Road, Thaltej, Ahmedabad

PHONE : + 91 - 79 - 2692 3423

MOBILE : + 91 - 94260 01681, 79843 74586

E-MAIL : kala\_projects@yahoo.co.in

WEBSITE : www.kalagroup.co.in

**mansi shah**  
ARCHITECTS

STRUCTURE ENGINEER

**ACHAL PARIKH**

www.achalparikh.in

LEGAL ADVISOR

**R.J.DAVE**

(ADVOCATE HIGH COURT)

SITE ADDRESS

**KALASAGAR SKYLINE**

14/15/16, PATEL SOCIETY, SHAHIBAUG BRIDGE, LANE TO  
OPP. MADHUPURA MARKET, SHAHIBAUG, AHMEDABAD - 380004.