



Develop By



Design Architect



Liasoning & Structure

SANJAY B. UMRIGAR

Brochure Design



Notes

- All rights for Alteration / Modification and development in design or specifications by architects and / or development shall be binding to all the members.
- BUC (Building Use Certificate) as per SMC rules, clear title for loan purpose.
- This brochure is for private circulation only. By no means, it will form part of any legal contract.

E-BROCHURE



3 BHK LUXURIOUS LIVING

SHIVANI PARK APARTMENT





DESIGNED TO THE HIGHEST STANDARDS.

Shivani Apartment is situated in a prime location in adajan, providing easy access to various landmarks.

This premium residential project offers high-end amenities and facilities that allow residents to experience life to the fullest. The project comprises 3 bedroom apartments that provides an epitome of luxury, enabling you to lead a lavish lifestyle.

SHIVANI
PARK APARTMENT

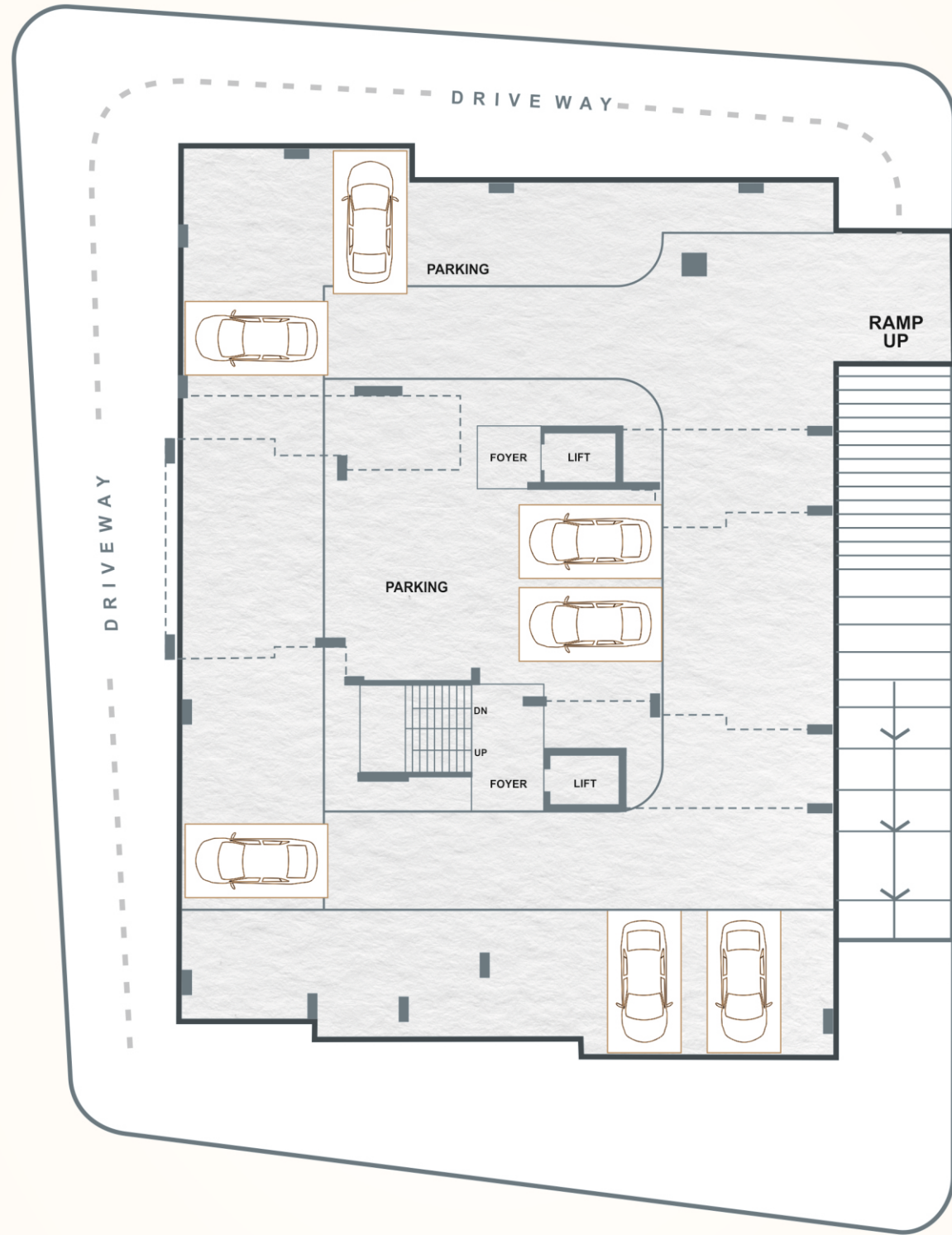

BASEMENT
FLOOR PLAN



GROUND
FLOOR PLAN



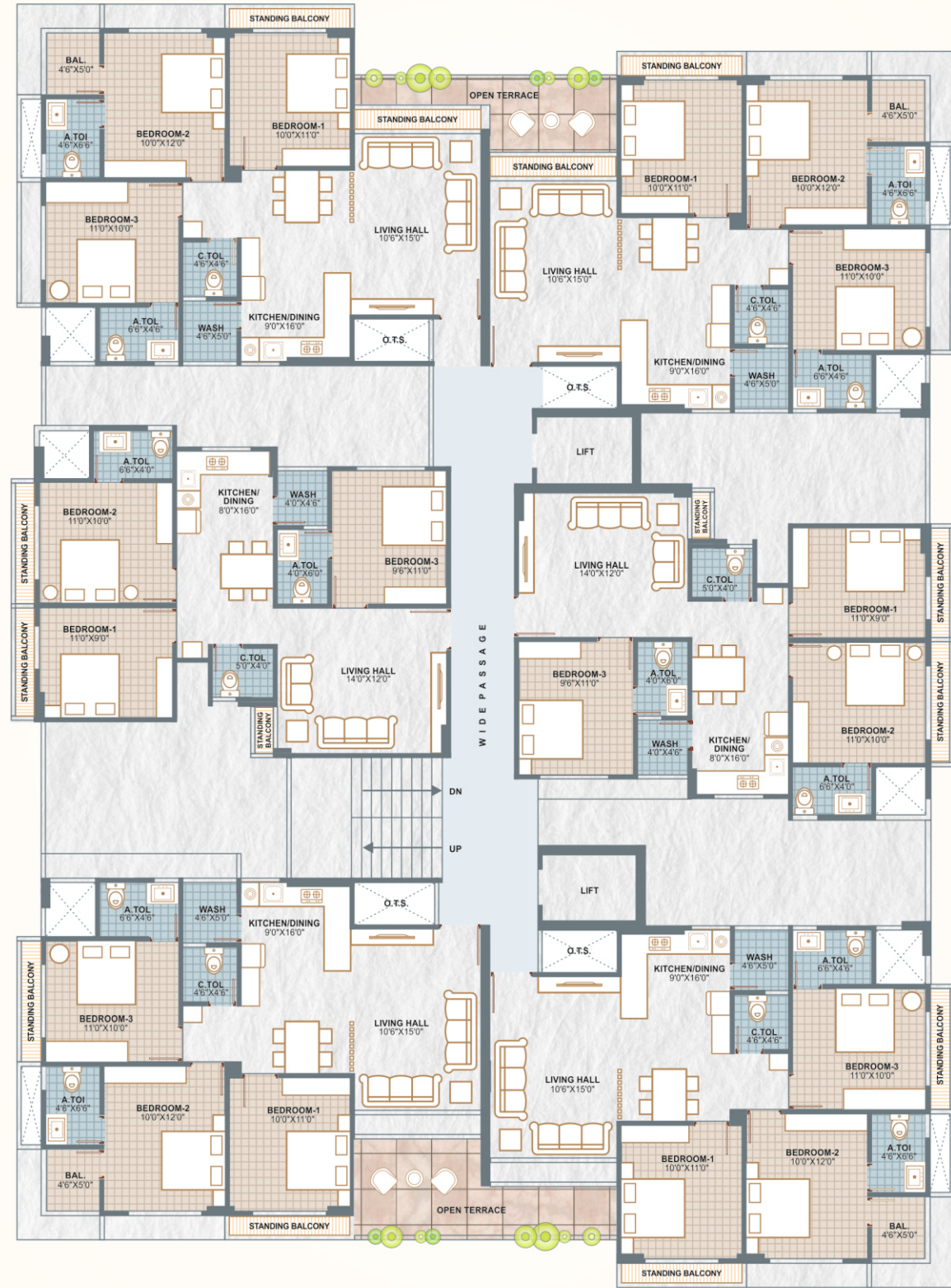

3BHK 1st FLOOR PLAN

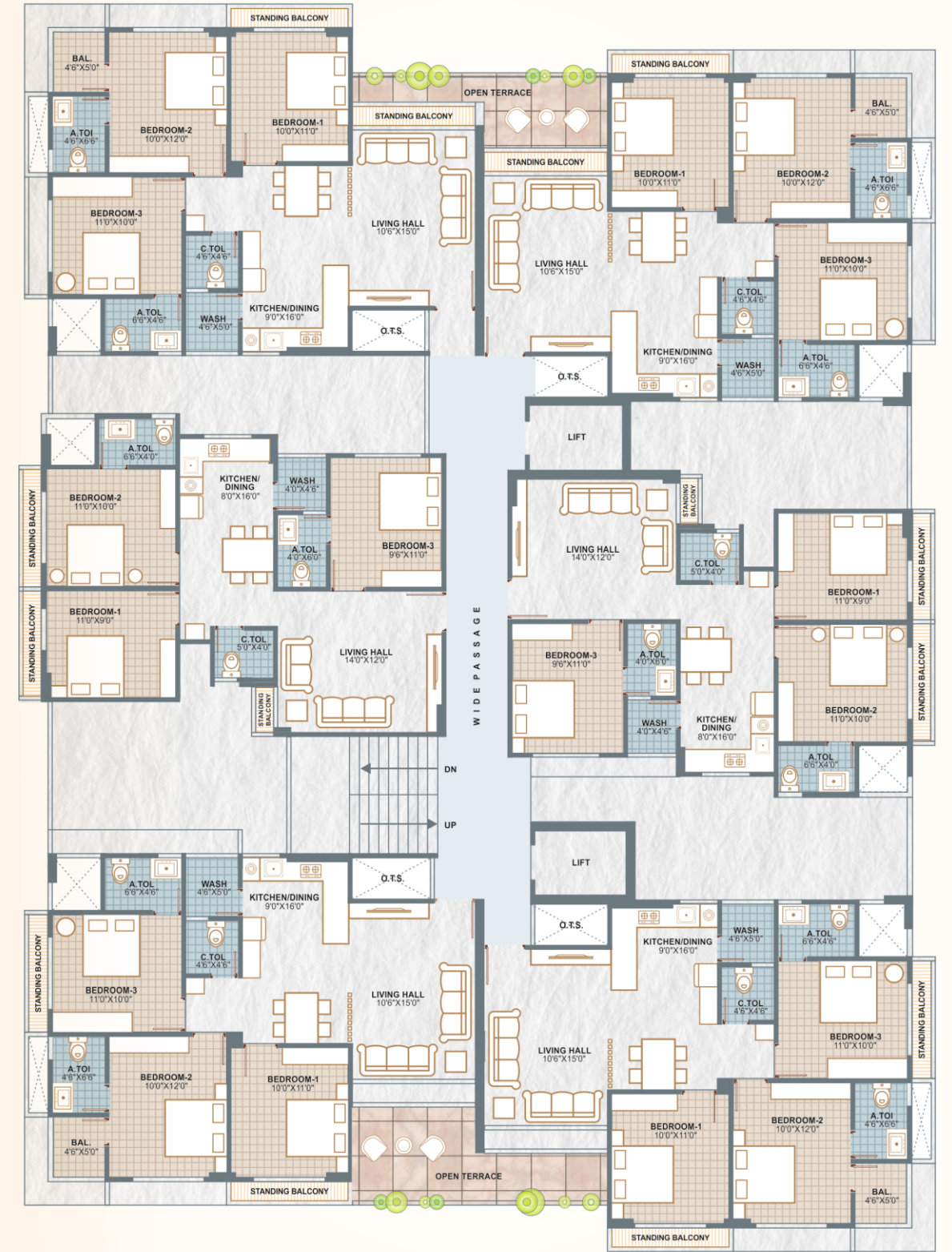

3BHK 2nd & 6th FLOOR PLAN

STYLISH AND
SURPRISINGLY
AFFORDABLE!



3BHK 7th FLOOR PLAN

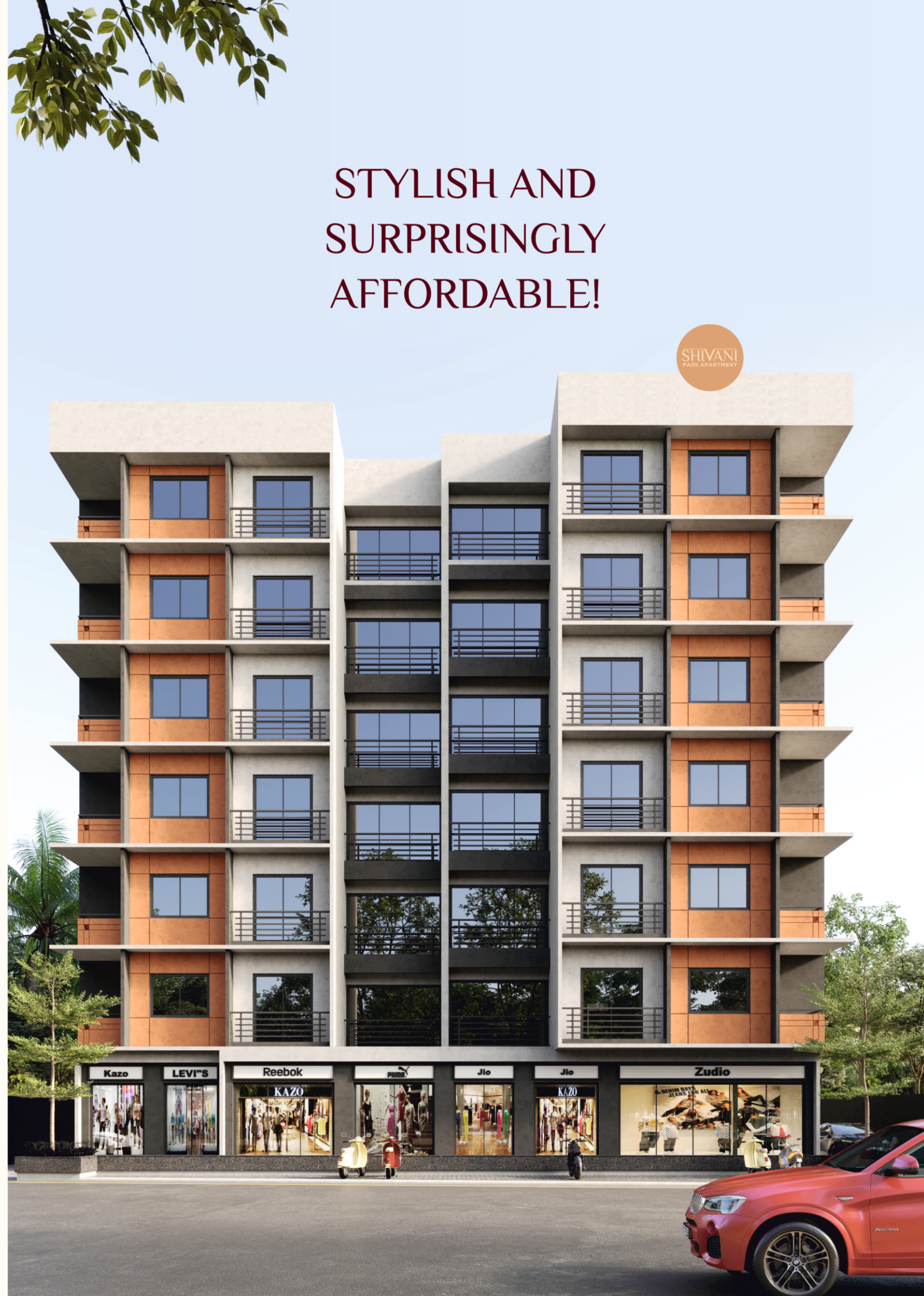

CLASSY
ENCLAVE!



COMMUNITY AMENITIES

This outstanding community offers an array of communal activities and amenities that will engage you. Create friendships and a sense of home.

Shivani Park is a
modern residential
Apartment in adajan.



Main Gate with
Security Cabin



CCTV
Provision



Reception and
Lobby area



Bore well for
society



Flat holder
name plate



Underground
water tank



Fire fighting
system



Car
Parking

LUXURY FINISHES

Elevate your quality of life when you live at Shivani Park Apartment. We provide top-of-the-line amenities for a luxurious living experience.

01 RCC Structure

- Earthquake resistance RCC design.
- Structure design as per ISO code.

02 Parking

- Sufficient car parking.

03 Flooring

- 24" x 48" vitrified flooring of standard company all area.

04 Toilet & Plumbing

- Anti-skid tiles flooring and designer wall tiles of standard company up to lintel level.
- Faucet fitting of standard company in all bathroom and toilet.
- Sanitary fitting of standard company in all bathroom and toilet.
- CPVC/UPVC of standard company pipes for plumbing.

05 Electrification

- Concealed copper wiring with sufficient point of standard company.
- Convenient provision of AC & TV Point in each flats.
- Modular switches of standard company for each flat.

06 Kitchen & Wash

- Vitrified slab platform and sink of standard company.
- Designer wall tiles of the standard company on Dado up to lintel level.
- Adequate electrical plumbing, and RO point provision in wash and Kitchen area.

07 Door & Windows

- Well-designed main door with wooden frame and premium fitting.
- Laminated flush door with standard hardware fitting.
- Anodized / powder-coated sliding aluminum section window.
- Standard one-way vision reflective glass for heat reduction for windows.

08 Internal Wall

- Single coat plaster with putty finish.

09 Paint Work

- Weather proof paint of standard company on exterior wall.

<p>ELECTRICAL CABLE</p> 	<p>SWITCHES</p> 	<p>SANITARY WARE & FAUCET</p> 
<p>PLUMBING</p> 	<p>PAINT</p> 	<p>LIFT</p> 

*Above mentioned brands or equivalent will be used.

EXAMPLE OF MODERN LIVING

build to uncompromising standard of design the iconic is an example of modern living at its finest.



Legal Disclaimer

- All furniture / objects shown in the plan or pictorial image are for presentation & understanding purpose only. By no means, it will from a part of final deliverable product.
- All the elements, objects, treatments, materials, equipments & colour scheme shown are artistic impression and purely for presentation purpose.
- Dimensions mentioned in building /unit plan, wall-to -wall dimensions & it does not include finishing detail the plaster, putty & dado tiles.
- The dimensions shown in brochure are appointment and may change slightly without causing any adverse effect to the purchaser.
- All the architectural and interior images shown in the brochure are merely simulated interpretation using computer graphics to enhance the customer understanding and are not actual images.
- The colour and general appearance of the flooring and wall tiles, sanitary ware and fittings, walls, ceiling, windows, doors, internal roads, trees, shrubbery etc. shown in the simulated computer graphic images are taken from the available object libraries for the purpose of presentation.
- The prospective purchasers of the property are advised to refer to the construction specifications mentioned in the brochure.
- Additional amenities and / or utilities may be required as per the law, though its not mentioned of shown in the brochure.
- Demolition will not be done after completion of work.

Extra Charges

- Extra Internal work / alteration work.
- All government expenses & advocate fees.
- Sale Deed.
- Water & infrastructure charges.
- G.S.T. as per government rules.
- Deposit maintenance Charges.