

A Township of 600  
Premium Duplex, Singlex  
& Apartments  
(Approved by Town & country planning)



LOTUS-A



LOTUS-B



TULIP



LILY

25 ACRES TOWNSHIP WITH ALL MODERN AMENITIES  
3 & 4 BHK DUPLEX AND 2 BHK SINGLEX



## 11th Mile Garden City

11th Mile Garden City is an exquisite group housing project of more than 500 Premium Duplex, Singlex and Apartments which connotes ultimate comfort and luxury. It is crafted to match your contemporary lifestyle! Be it the design, architecture or specifications, this city of gardens delights you all the way! Conveniently located on Misrod- Bhojpur Road at a distance of approx 1.5 kms from 11th Mile Trisection, it is the finest gated community offering ultra modern villas, duplex, singlex and apartments with all the amenities. This 25 acres lush green township in municipal corporation limits are idyllic homes and have been designed to fulfil the needs of residents in the most luxurious fashion.

### BUNGALOW SPECIFICATION:-

<b>Flooring:-</b>	Vitrified tiles(2'x2') in rooms.Designer anti skid tiles in toilets. Exterior grade ceramic tiles in porch.
<b>Walls:-</b>	Good quality brick masonry.
<b>kitchen:-</b>	Granite platform with sink & ceramic tiles dado up to 2' height above platform.
<b>Window:-</b>	Three track aluminium coated windows with toughened glass.
<b>Doors:-</b>	Factory made flush door.
<b>Door Frame:-</b>	Pressed steel Dewas sections heavy gauge frames.
<b>Stairs:-</b>	Marble/vitrified tiles with moulded nosing.
<b>Toilet:-</b>	Concealed CP Fittings & sanitary ware of standard make and ISI mark.
<b>Electrical:-</b>	ISI mark concealed copper wiring. modular switches,circuit security through MCB.
<b>Stairs Railing:-</b>	Stainless steel decorative railings.
<b>Painting:-</b>	Putty and emulsion for interior. Oil paint for grills, railing and Main Gate. Weather shield paint finish for exterior.
<b>Water Supply System:-</b>	Through concealed CPVC pipe lines with independent over head water tank.

### PROJECT HIGHLIGHTS:-

- Wide concrete roads,large open landscapes with developed gardens
- Underground electrification and street light poles
- Drinking water supply from sump wells
- Secured campus and patrolling by security guards
- CCTV surveillance
- Space for Pre- primary school
- Clubhouse
- Tennis court
- Kids play area & sand pits
- Rainwater harvesting
- Convenient shopping complex

Possession started many happy and satisfied families staying in the campus



GRAND ENTRANCE



MULTISTOREY APARTMENTS



SHOPPING COMPLEX



CLUB HOUSE





**LOTUS  
BUNGALOW  
TYPE A**

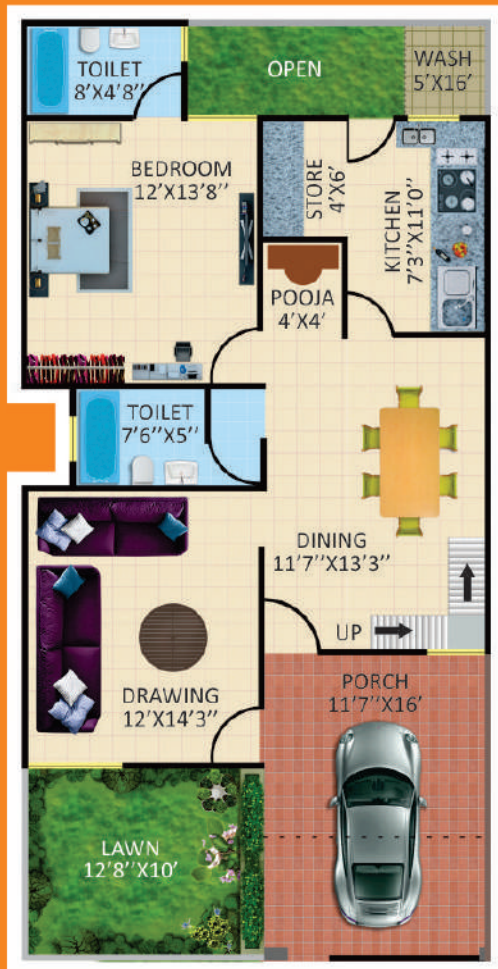

**GROUND FLOOR PLAN**

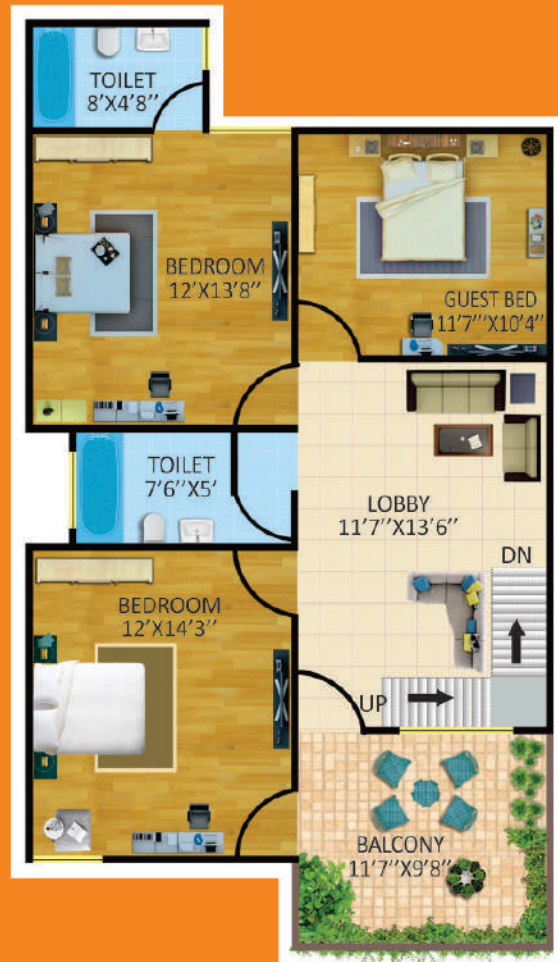

**FIRST FLOOR PLAN**

Plot Area - 1210 Sq ft.  
S.B. Area - 2064 Sq ft.

**LOTUS FLOOR PLAN**





**LOTUS  
BUNGALOW  
TYPE-B**



**GROUND FLOOR PLAN**



**FIRST FLOOR PLAN**

Plot Area - 1210 Sq ft.  
S.B Area - 2024 Sq ft.

**LOTUS FLOOR PLAN**





**TULIP BUNGALOW**



**GROUND FLOOR PLAN**

**FIRST FLOOR PLAN**

Plot Area - 1130 Sq ft.

S.B Area - 1655 Sq ft.

**TULIP FLOOR PLAN**



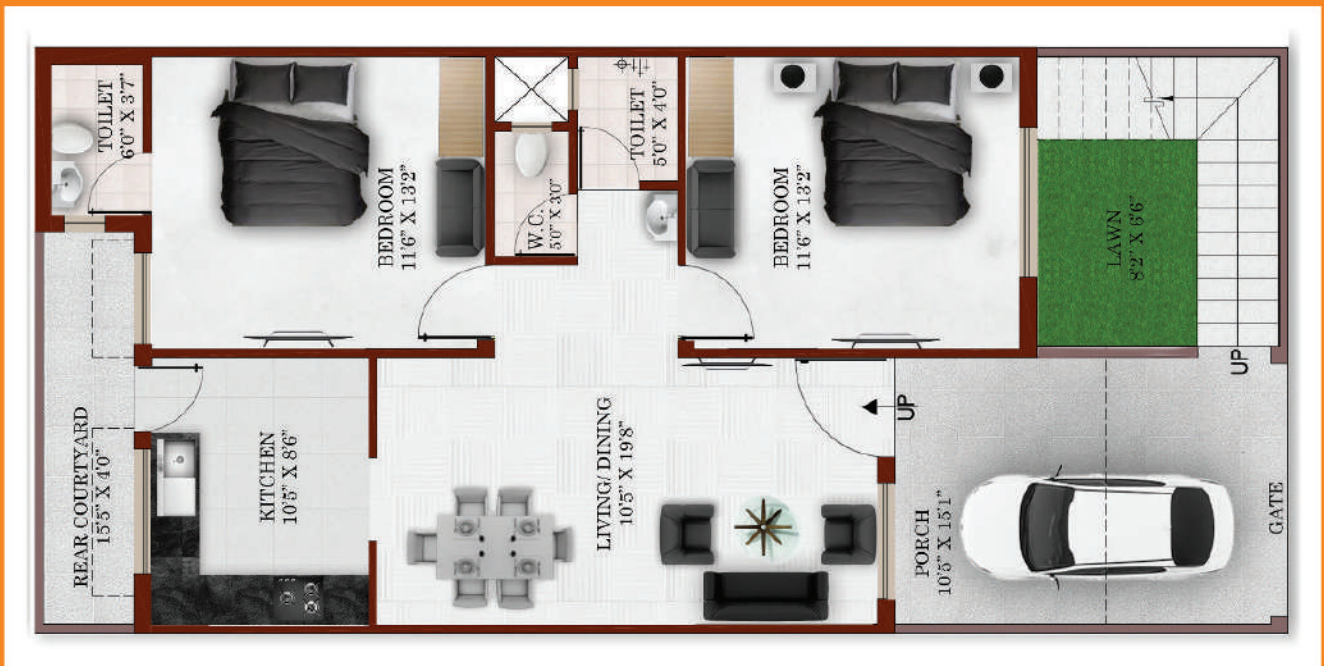

Plot Area - 1130 Sq ft.  
S.B. Area - 840 Sq ft.

**LILY FLOOR PLAN**







## LOCATION ADVANTAGES

- 1.5 kms approx from NH-12, Bhopal -Nagpur highway
- Located on Bhojpur road the most developing area of South Bhopal.
- 15 min drive from railway station.
- Leading management / engineering institutes, schools, malls and townships in close vicinity.
- Public transport facility available
- Within city municipal corporation limits

**CONCEPT**  
ARCHITECTS  
PLANNERS  
DESIGNERS  
shuyay@gmail.com

31B Zone II M.P. Nagar Bhopal 11  
Tel: 2557198, 9826057186

*Possession started many happy and satisfied families staying in the campus*

## LOCATION PLAN

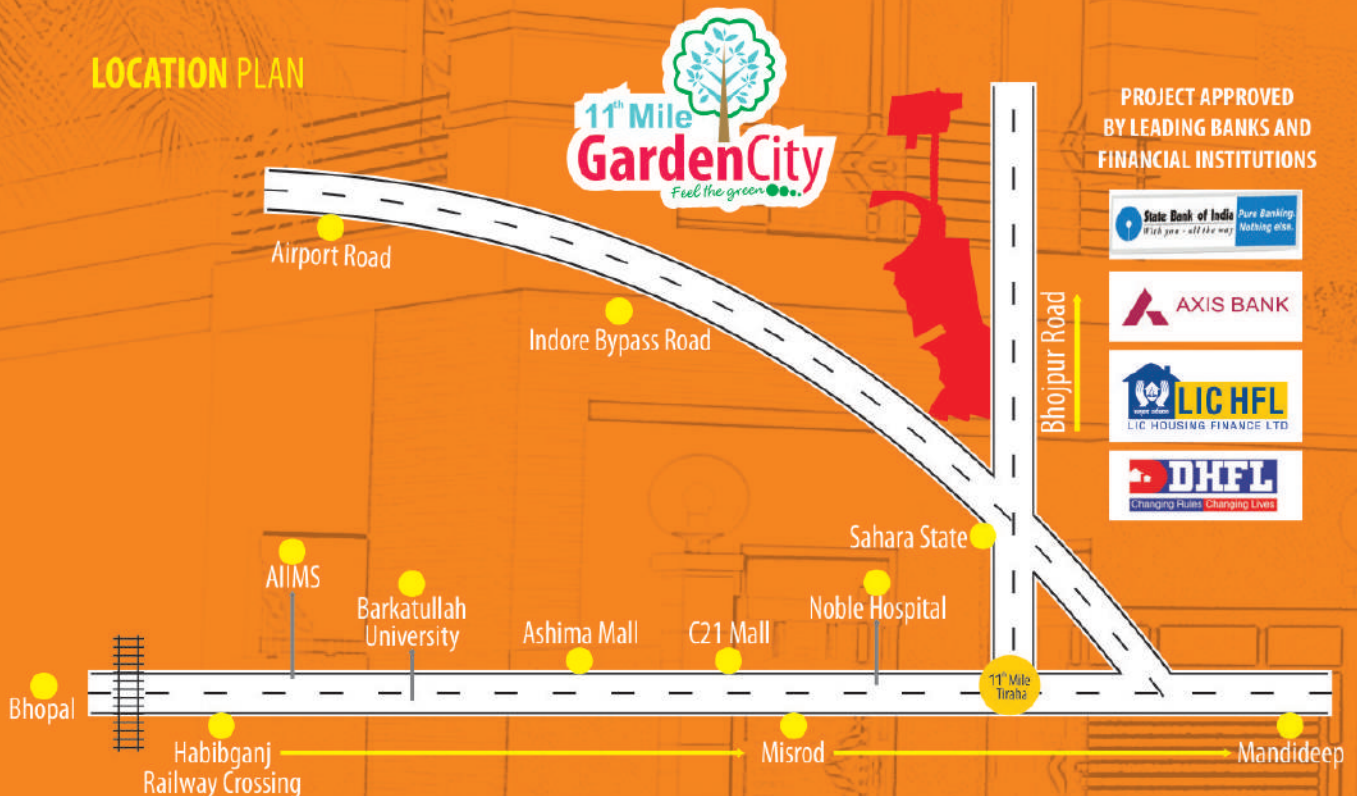

PROJECT APPROVED  
BY LEADING BANKS AND  
FINANCIAL INSTITUTIONS



Developers

# Ritu Constructions

Phone: 0755 2980520, 9826087363, 9827042341, 9425007520

Contact Address: 11th Mile Garden City, Chhan Ward no. 85 Nagar Nigam Bhojpur Road Bhopal 462047

Website: [www.rituconstructions.com](http://www.rituconstructions.com), Email: [sales@rituconstructions.com](mailto:sales@rituconstructions.com)

Disclaimer : All visuals/ photographs used in this brochure are artistic impressions & not a legal offering. All specifications, sizes & layout etc. are tentative & subject to variations.