



About



KEYSTONE

— AVENUE —

Keystone Avenue Isn't Just A Commercial Real Estate Project; It's A Vision For The Future. A Place Where Businesses And Healthcare Seamlessly Come Together To Create A Dynamic And Thriving Community. Join Us On This Transformative Journey, Where Innovation Knows No Bounds And Your Future Begins At Keystone Avenue.









We believe that true luxury is in the details. Every square inch of this development is designed to provide you with a living experience that is second to none. From the carefully curated interiors to the premium amenities, we've left no stone unturned in ensuring that your home exudes elegance and comfort.



Ground Floor

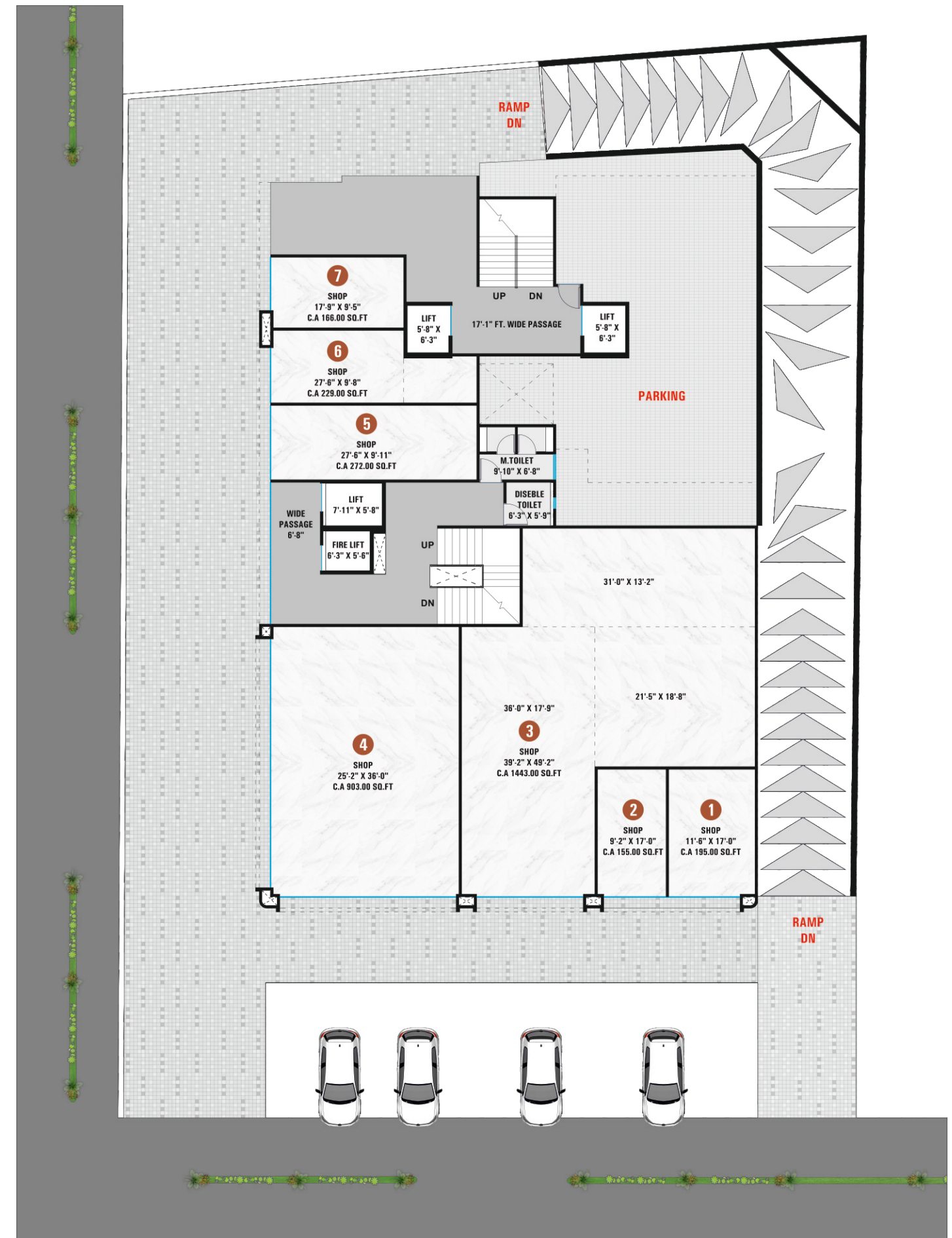

Keystone Avenue offers more than just space: it offers the potential to become the hub of your community, where life, work, and connections come together.

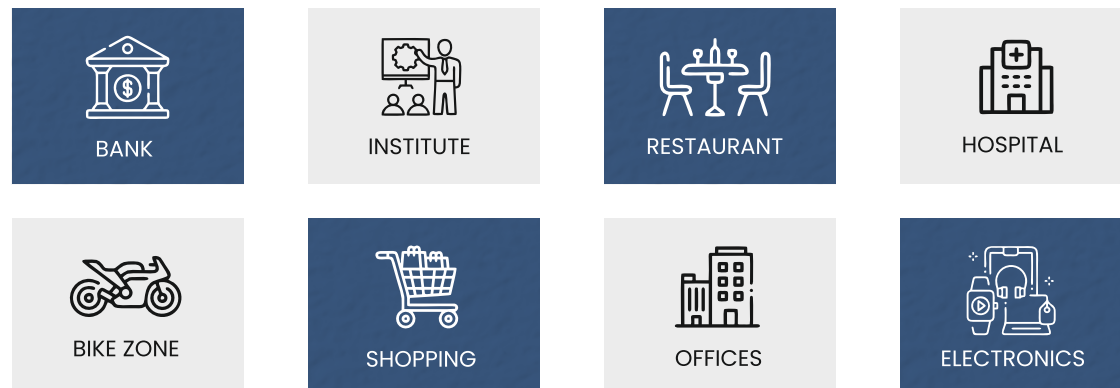

1st Floor Plan



3rd To 4th Floor Plan



2nd Floor Plan



5th Floor Plan



6th Floor Plan



7th Floor Plan



CAMPUS AMENITIES

List of Amenities and Facilities

- Well-designed entrance and lift lobby,
- Standard Lift/Elevators, (ISI Brand)
- CCTV in the compound,
- Common Ladies and Gents Toilets (For Commercial Complex)
- Well-designed entrance gate of appropriate size will be provided,
- Compound Lighting with Waster proof fixtures shall be provided,
- Elegant Elevation
- Parking space on ground floor and basement floor
- Fire Safety as per government norms.
- SMC Water Supply.

Specifications: Building External

- Earthquake-resistant RCC Frame structure
- Double coat sand-faced plaster with texture
- Weather shield color – Standard Company Paint for long life and shine
- Separate water connection and storage tank for the building/complex.
- All attractive outer lighting (ISI brand)

FOR RESIDENTIAL

SPECIFICATIONS: BUILDING INTERNAL

FLOORING

- Vitrified tiles flooring 24"x24" In hall, kitchen and in all bedrooms. Dedo tiles in Bath and Wash area upto lintel level (ISI Brand)

INTERNAL WALL

- All Internal walls finished with putty (ISI Brand)

KITCHEN & STORAGE

- Granite kitchen platform with standard company sink and decorative glazed tiles on wall up to ceiling level.
- Common wash basin,
- kota flooring and glazed tiles dado with granite sill tip in wash area.
- 1 gas line point for the kitchen

SANITARY AND PLUMBING

- Anti-skid tiles flooring and well-designed wall tiles up to lintel level.
- Standard quality sanitary fitting (ISI Brand)
- CPVC/UPVC piping for plumbing (ISI Brand)

DOOR & WINDOWS

- Attractive main door with sal wood frame.
- Internal flush door with granite or marble frame.
- Standard anodized aluminum section windows.

ELECTRIFICATION

- Standard concealed wiring with sufficient points all rooms. washing Machine and T.V. point. Standard make modular switches & accessories (ISI Brand)

FOR COMMERCIAL

Internal Unit Specifications: Building Internal

- 24 X 24 Vitrifird Flooring (ISI Brand)
- Modular Switches (ISI Brand)
- Copper Wiring (ISI Brand)
- Electric Point (ISI Brand)
- All Internal walls are finished with putty (ISI Brand)
- Standard quality sanitary fittings. (ISI Brand)
- CPVC/UPVC piping for plumbing (ISI Brand)
- Galvanized Shutter for Shop (ISI Brand)
- Attractive main door for offices (ISI Brand)

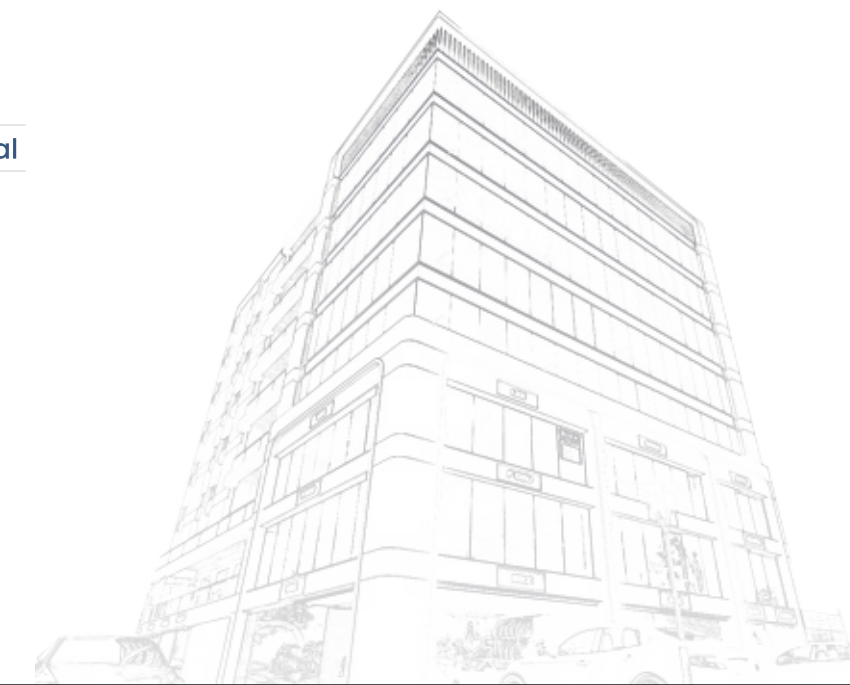

Location Map



DEVELOPER



ARCHITECT



STRUCTURER

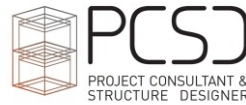

AUTHORITY APPROVAL
CONSULTANT



For Booking Contact :
+91 98252 53843

SITE ADDRESS :
**Keystone Avenue, Near Safari Complex,
Udhana Main Road, Bhestan, Surat.**

RERA NO : PR/GJ/SURAT/SURAT CITY/Surat Municipal Corporation/MAA14342/281024/311226 website : gujra.gujarat.gov.in

DISCLAIMER :

- All expenses of legal documents like Stamp duty, Registration fees, GST, Advocate fees, Incidental charges (drainage, water supply, IC, etc.) and every other charges like Society maintenance, Safety grill, SMC taxes, Gas connection charges, Electrical connection charges (GEB charges, cabling, etc.) including material & labour Cost are to be borne by members.
- External & internal changes shall not be allowed.
- Before possession, execution of sale deed is compulsory.
- Members are bound to pay instalments regularly & irregularity in payment may cause cancellation of booking.
- Developers reserves right of making any changes in the scheme & it shall be bound to all members.
- This booklet is only for private circulation and for general information to all the members & shall not form a part of any agreement. It can be changed without prior notice.
- The interior design/ furniture work/ lighting/ plantation/ architectural presentation/ tagline & literature/ measurement etc. shown in the brochure is just for the purpose of presentation/explanation to the members. It is not the part of the standard specification of the project, as unit is sold without furniture.