



ASHTAVINAYAK
RESIDENCY

1 B.H.K Flats



FLOOR PLAN 5 FLOOR

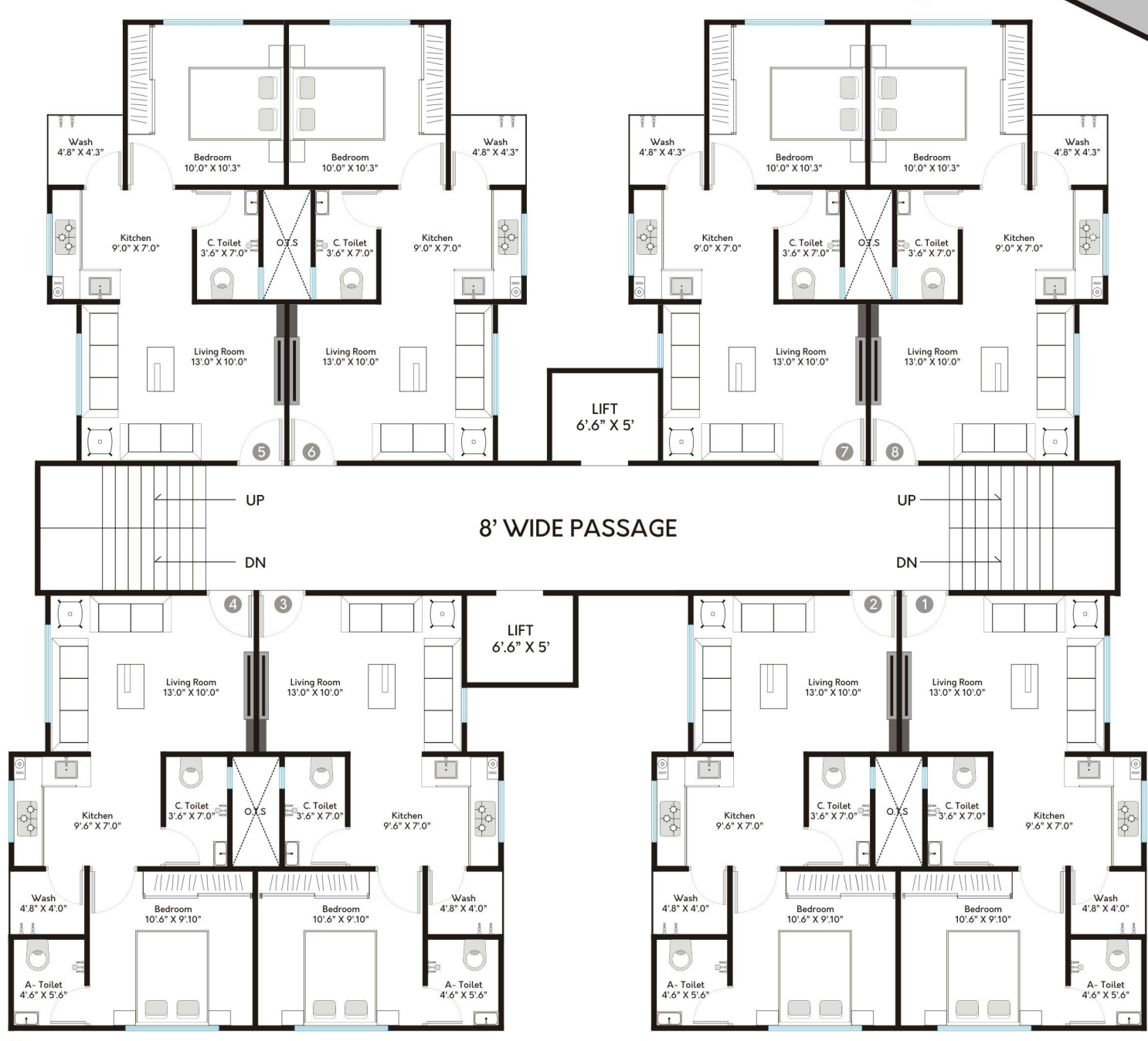

TYPICAL FLOOR PLAN 1 - 4 FLOOR



SPECIFICATION

C.C.T.V
Campus Entrance To Be Covered With Camera

ENTRANCE
Decorative Entrance Foyer

ELEVATOR & D.G. SET
Good Quality Lifts with Diesel Generator For Backup

LOAN
Up to 80% Loanable From Majority Of All Leading Banks

WINDOWS
Granite Window Sill With Anodized Aluminum Section

DOORS
Main Gate In Flush Door In Sal Wood Frame & P.V.C Door for bathroom

WATER
6" Dir Borwell With Separate Overhead & Underground Tanks

FLOORING
Vitrified Tiles Flooring In All Rooms & Full Glazed Tiles in Bathroom

WALL FINISHES
Internal Walls Mala Plaster & Putty Finish, External Walls Double Coat Plaster with Texture and Exterior Weather Proof Paint

ELECTRIFICATION
Concealed Wiring & Modular Switches

PLUMBING
Concealed Plumbing With Good Sanitary Ware & C.P Fittings.

KITCHEN
Granite Platform with S.S. Sink & 4' Glaze Tiles Dado In Kitchen

LOCATION PLAN



ASHTAVINAYAK
RESIDENCY

Parsi Mohallo,
Bus Stop no 2 Road,
Ichhapore, Surat.
98985 77899

ORGANIZER

HIRPAL CORPORATION PROPRIETOR
MEHUL L. LAKHANI

ARCHITECT / ENGINEER
SMIT THAKKAR

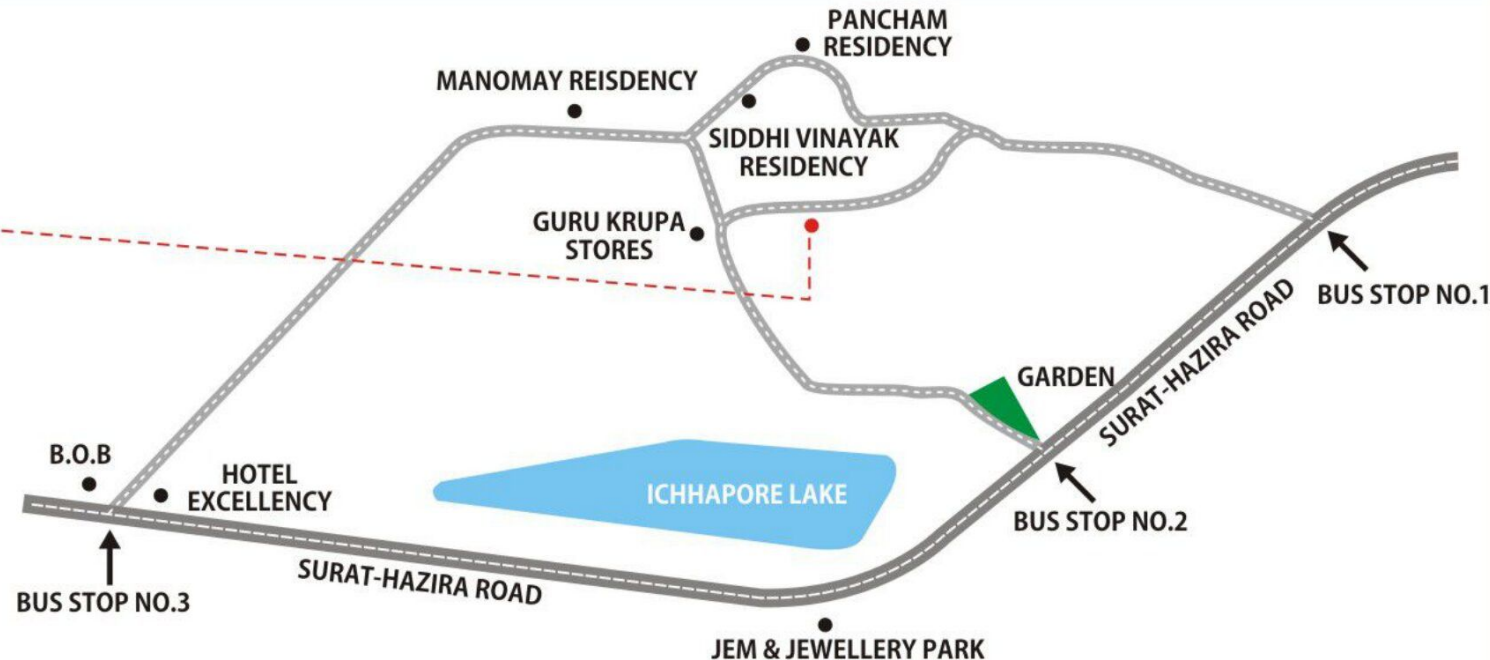

Legal, G.E.B, Water / Drainage / Taxes(G.S.T as Applicable) & Building Maintenance Extra. Internal & External Changes Will Not Be Allowed & Is Subjected To Change As Per The Developers Rights. All Details In This Booklet Are For Easy Information Purpose Only & Cannot Be A Form Part Of Any Agreement. Monitory & legal Matters Are Subjected To Surat Jurisdiction.