



PROJECT BY:
**HRISHIKESH
VENTURES LLP**

13, DARSHAN SOCIETY,
NAVRANGPURA, AHMEDABAD-380009

BOOKING CONTACT : +91 90999 26343

RERA NO. : | www.gujrera.gujarat.gov.in



LAYOUT PLAN

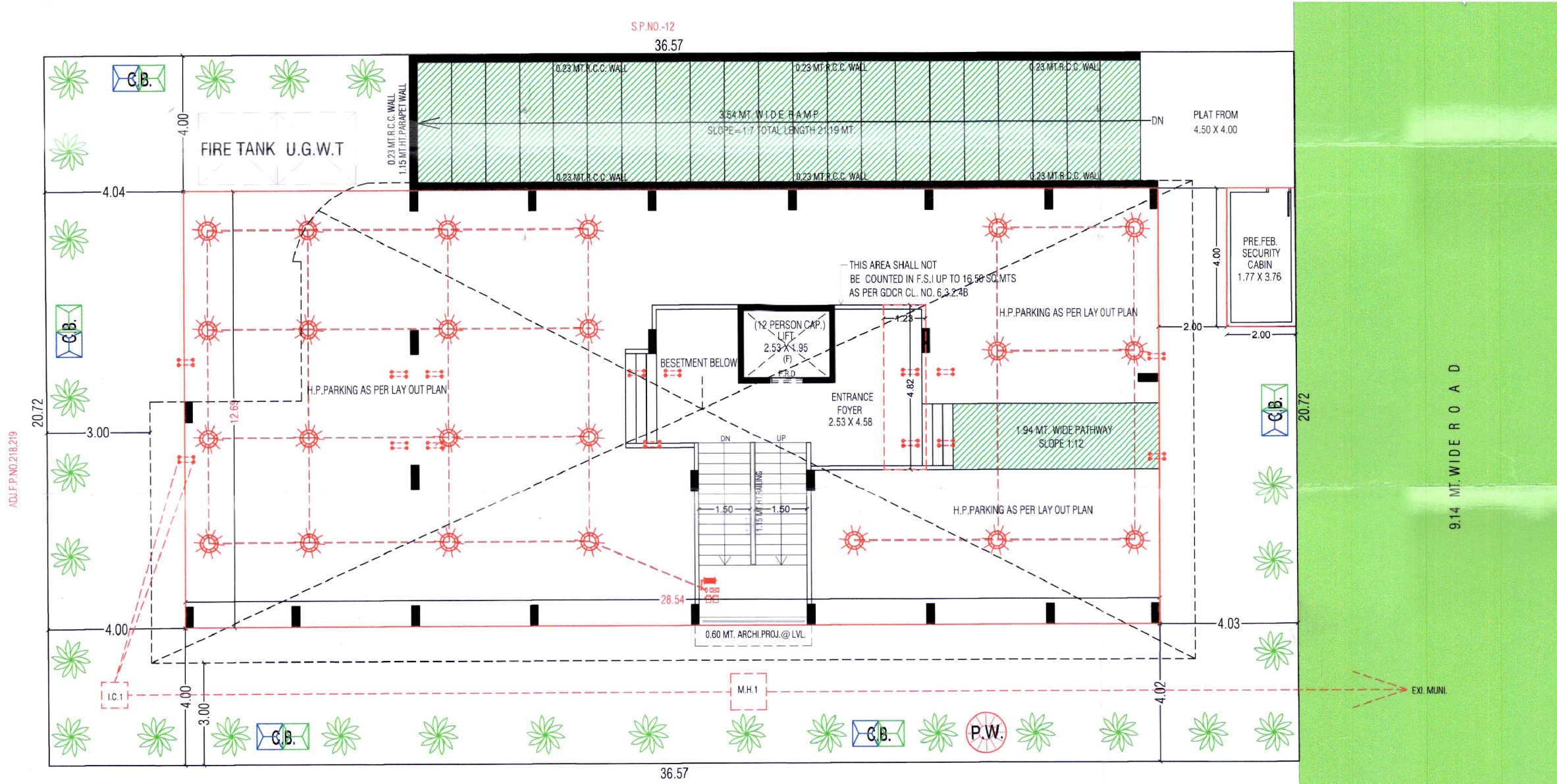

1ST TO 5TH FLOOR PLAN

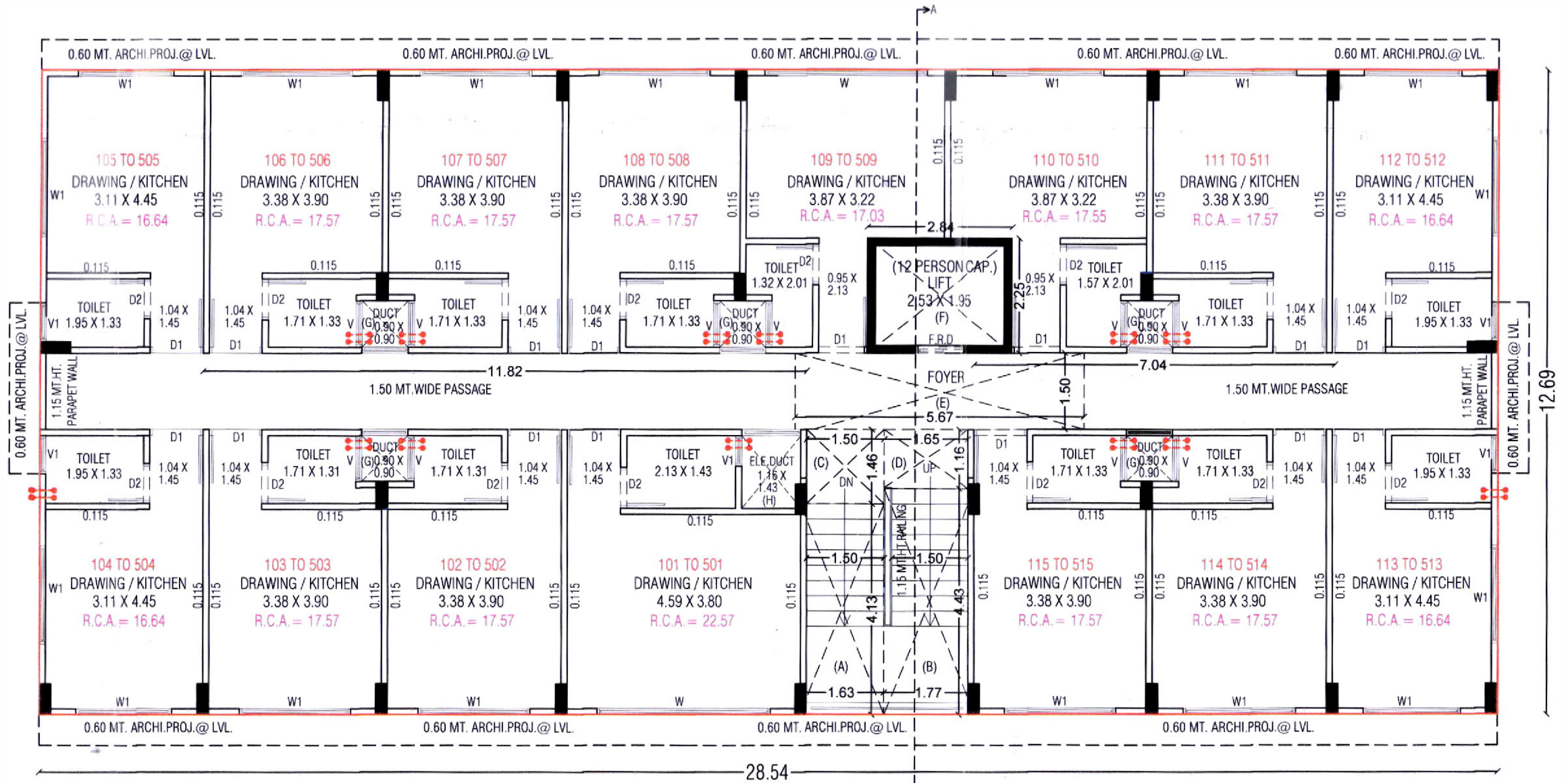

BASEMENT PLAN



ADJ.FP.NO.218.219

20.72

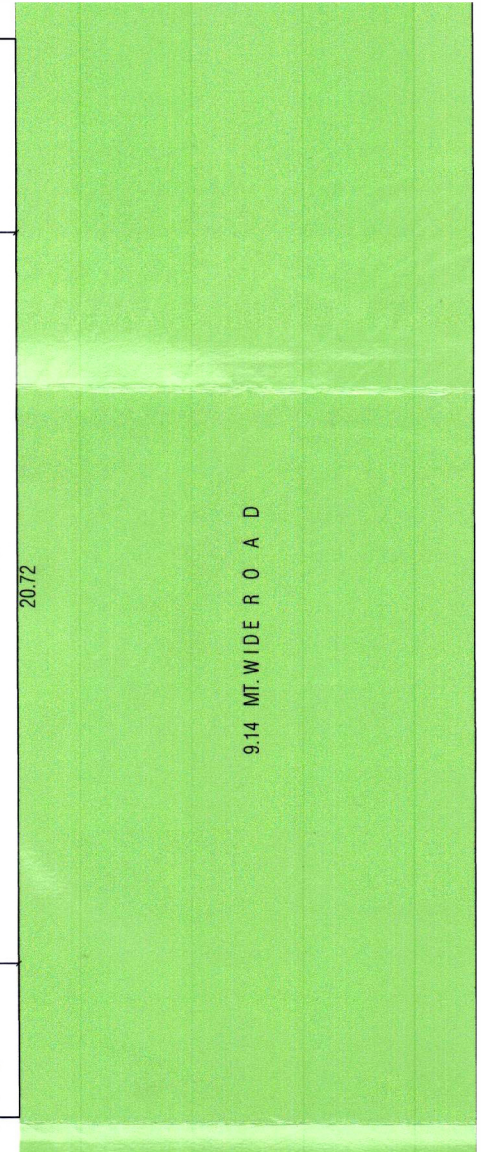
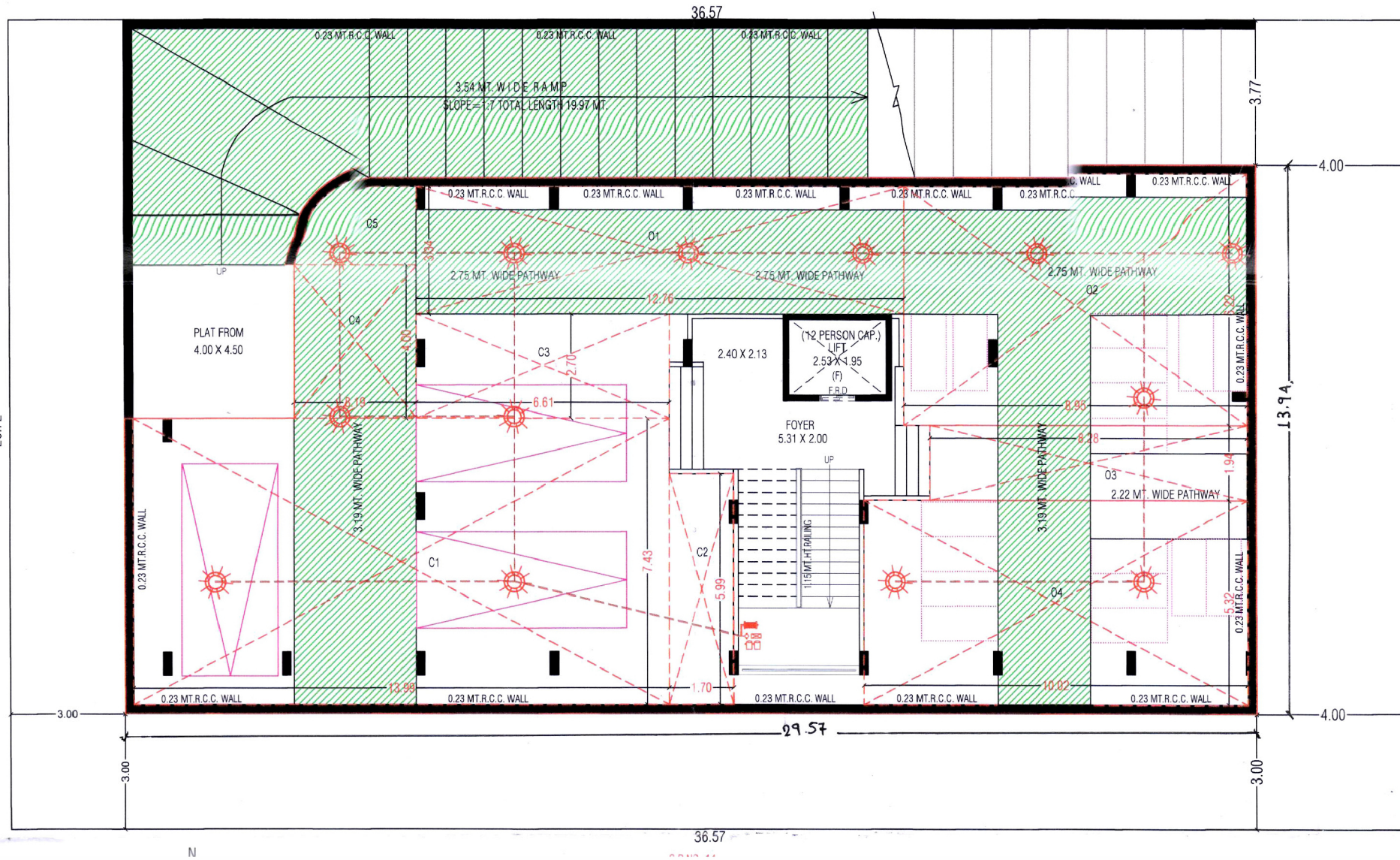

N

36.57



SPECIFICATIONS :

FLOORING :	<ul style="list-style-type: none"> • Vitrified tiles flooring .
TOILETS :	<ul style="list-style-type: none"> • Designer vitrified tile dado up to beam bottom level • Anti skid tile flooring in toilet
DOORS & WINDOWS :	<ul style="list-style-type: none"> • Main entrance door – 32mm thick flush door with both side polished veneer • Window sill – polished granite • Windows – alluminium anodized sections
ELECTRICAL :	<ul style="list-style-type: none"> • 3-phase concealed copper wiring with adequate number of points in all rooms • Branded modular switches • Provision of TV / cable / telephone / AC ETC. Points
PLUMBING WORK :	<ul style="list-style-type: none"> • C.P.V.C. / G.I. Water supply pipes and UPVC pipes for soil waste and drainage systems • Plubing fittings – cera / hindware / equivalent • Sanitary ware – hindware / cera or equivalent
EXTERNAL & INTERNAL FINISHES :	<ul style="list-style-type: none"> • External double coat mala plaster with texture paint (apex paint) • Internal single coat mala plaster with putty finish



PROJECT BY:
HRISHIKESH
VENTURES LLP

SITE ADDRESS :

H6 13, DARSHAN SOCIETY,
NAVRANGPURA,
AHMEDABAD-380009

BOOKING CONTACT : +91 90999 26343

NOTES : stamp duty, registration charges, legal documentation charges, GST tax, maintenance deposits and Narmada water charges, gas pipeline charges shall be borne by the member separately. | Any Additional charges or duties levied by the Govt. / local authorities during or after the completion of the scheme will be borne by the member. | The project consultant / developer reserve all then rights to make changes to design or specifications of the project. | This brochure is not to be treated as a part of legal documents. It is meant for easy display and general information. | Any modification effecting elevation won't be allowed to be done by members of the society.