

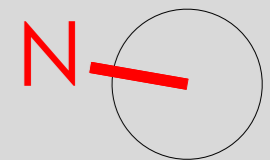

Developer Name- SHIV REALTY

RERA Registration No. _____ <https://gujrera.gujarat.gov.in>

GROUND FLOOR PLAN



12.00M WIDE T.P.S. ROAD

12.00M WIDE T.P.S. ROAD

15.00M WIDE T.P.S. ROAD

15.00M WIDE T.P.S. ROAD

6.00M WIDE APPROACH ROAD

9.00M WIDE APPROACH ROAD

9.00M WIDE APPROACH ROAD

6.00M WIDE APPROACH ROAD

9.00M WIDE APPROACH ROAD

18.00M WIDE T.P.S. ROAD

42.00M WIDE T.P.S. ROAD

18.00M WIDE T.P.S. ROAD

SOCIETY COMMON AMENITY

COMMON PLOT-3

BLOCK-D

BLOCK-C

BLOCK-B

BLOCK-A

COMMON PLOT-2

COMMON PLOT-1

ELE. SUB. STATION

ELE. SUB. STATION

RAJ. ST.

REINFORCED CONCRETE

BELOW

PLATFORM CANOPY

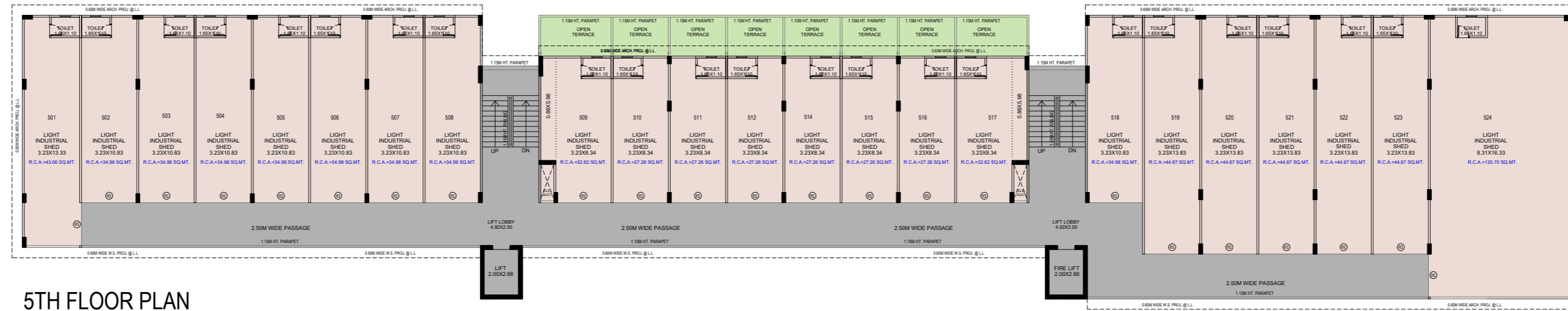

5TH FLOOR PLAN

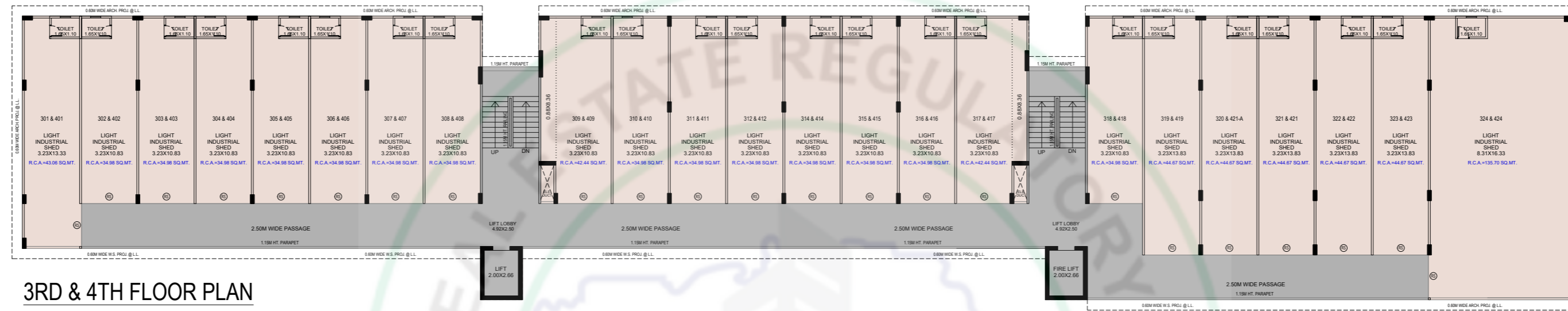

3RD & 4TH FLOOR PLAN

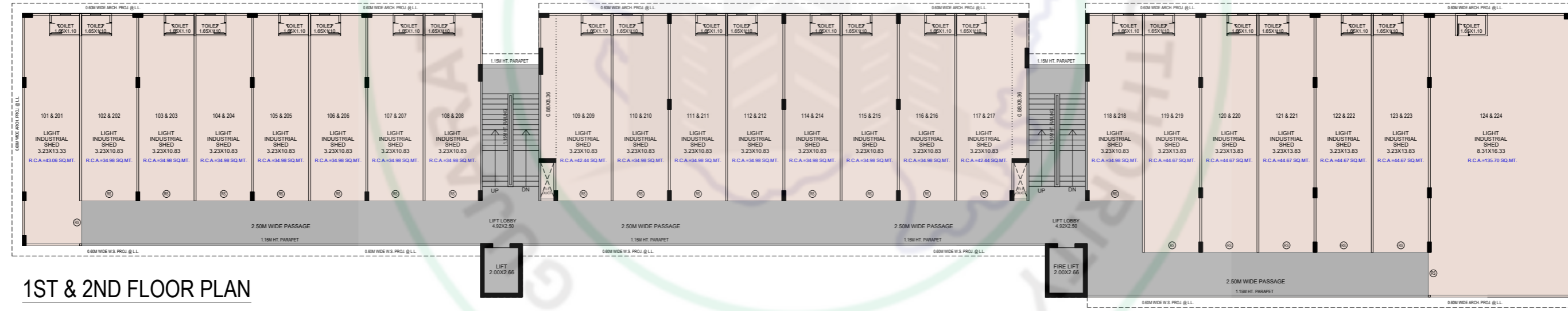

1ST & 2ND FLOOR PLAN

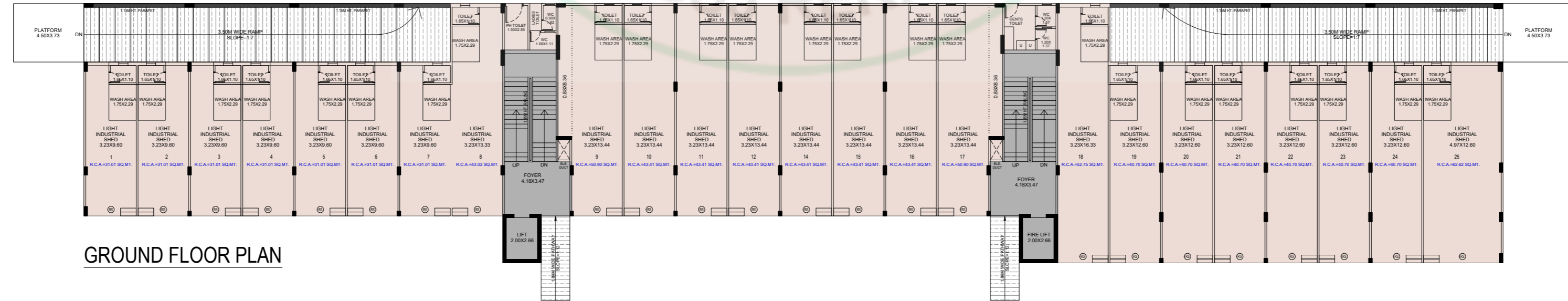

GROUND FLOOR PLAN

FLOOR PLAN (BLOCK - A)

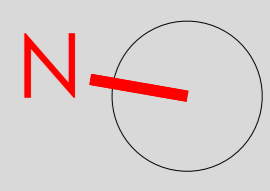

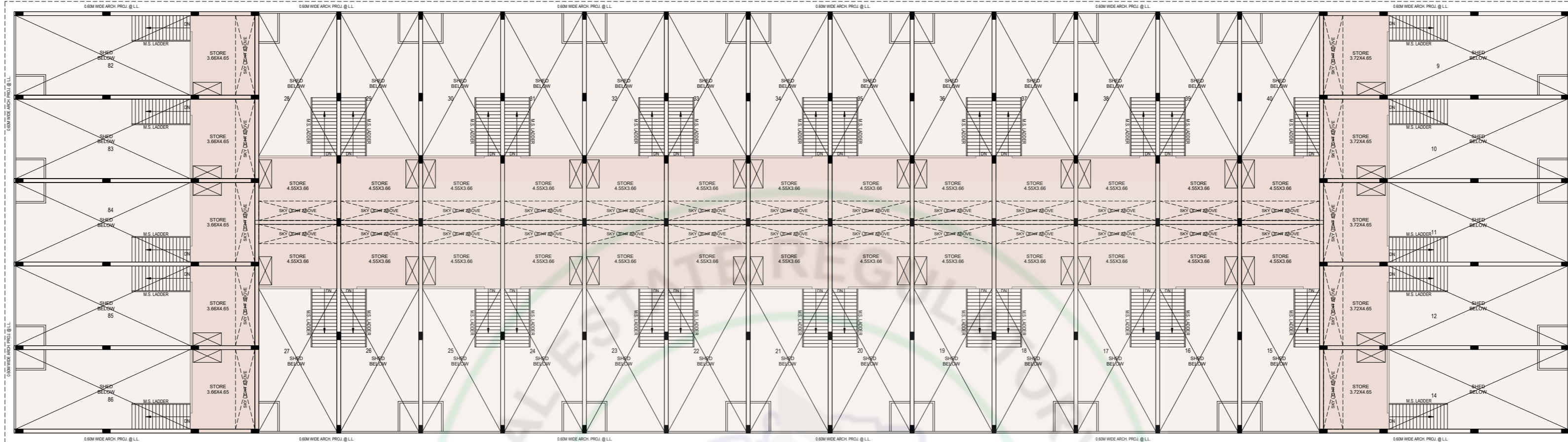

MAZZANINE FLOOR PLAN

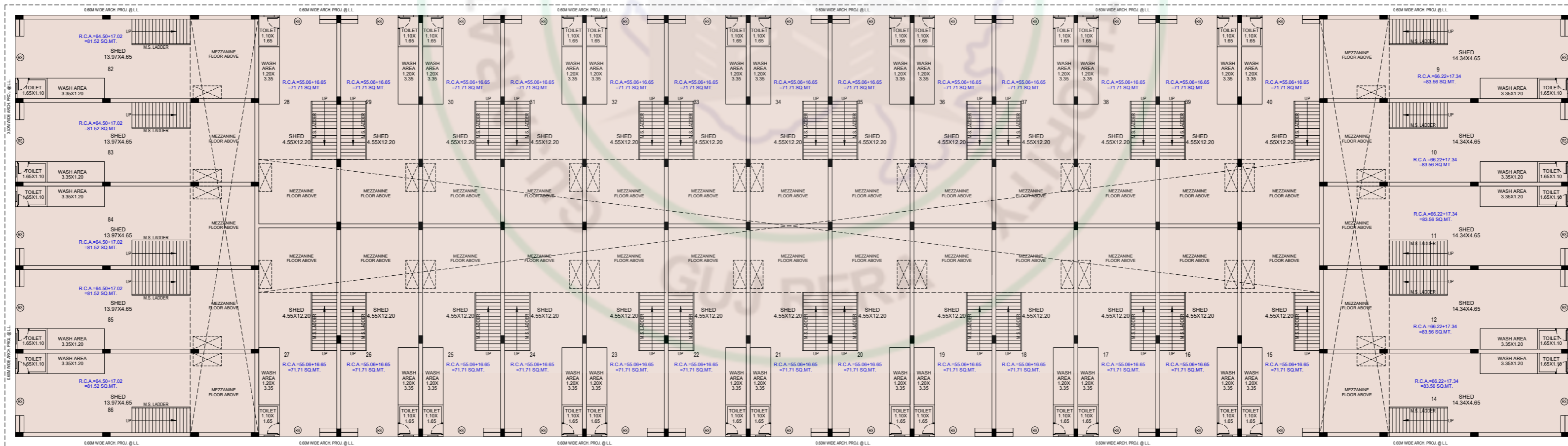

GROUND FLOOR PLAN

FLOOR PLAN (BLOCK - B)

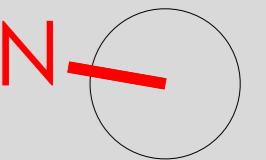

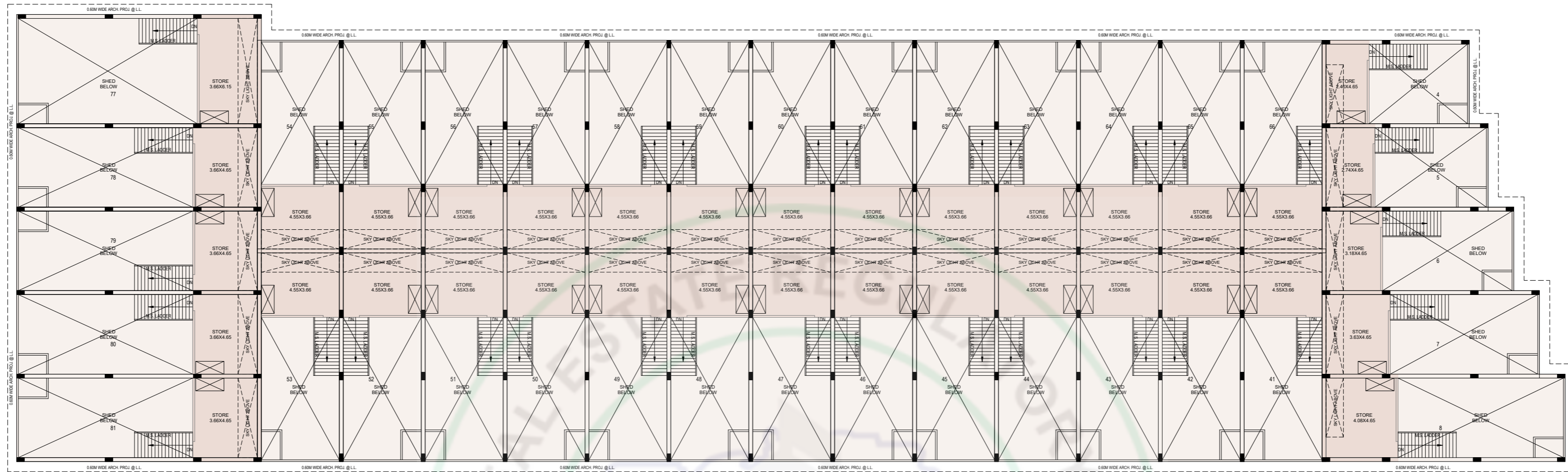

MAZZANINE FLOOR PLAN

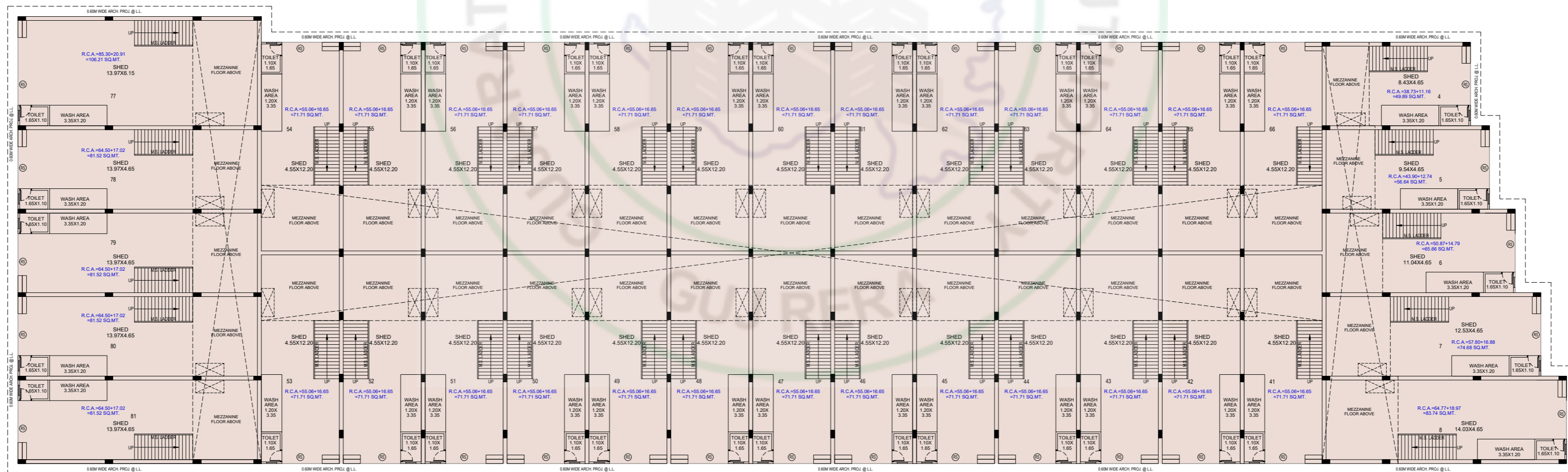

GROUND FLOOR PLAN

FLOOR PLAN (BLOCK - C)

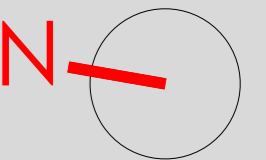

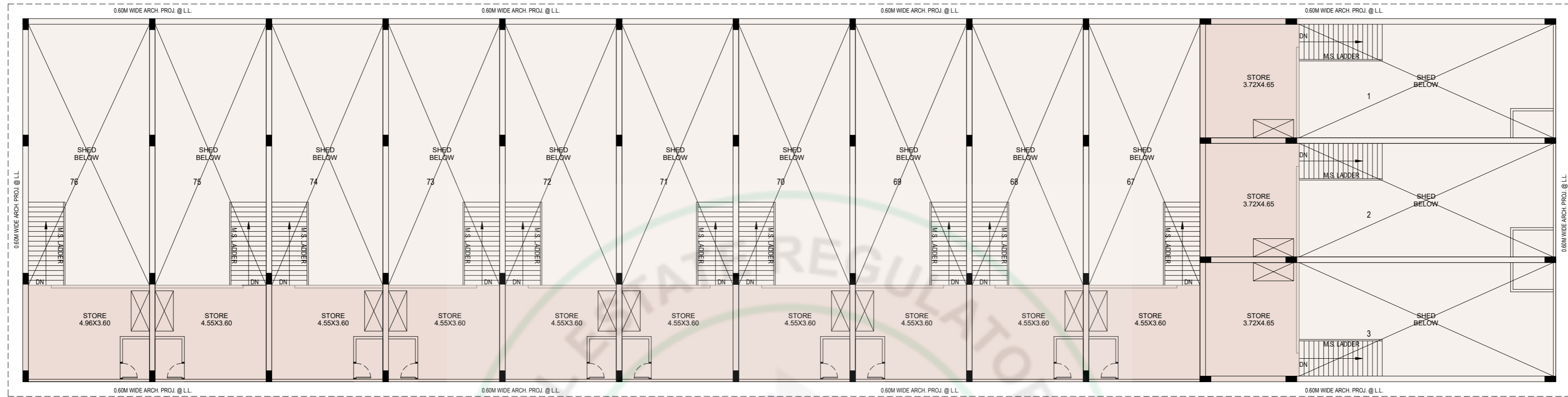

MAZZANINE FLOOR PLAN

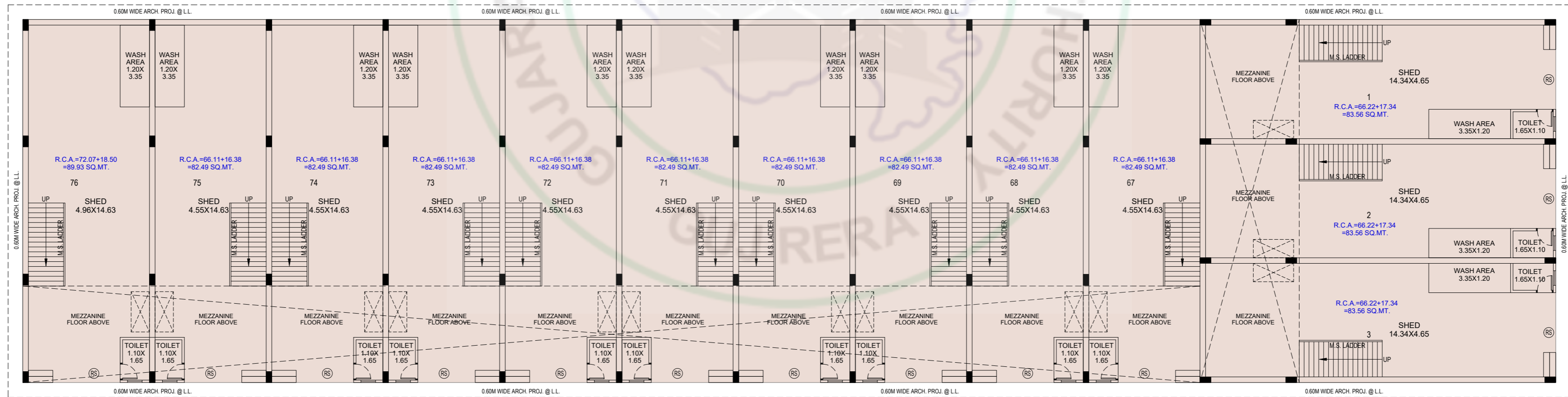

GROUND FLOOR PLAN

FLOOR PLAN (BLOCK - D)

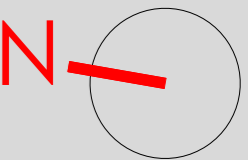

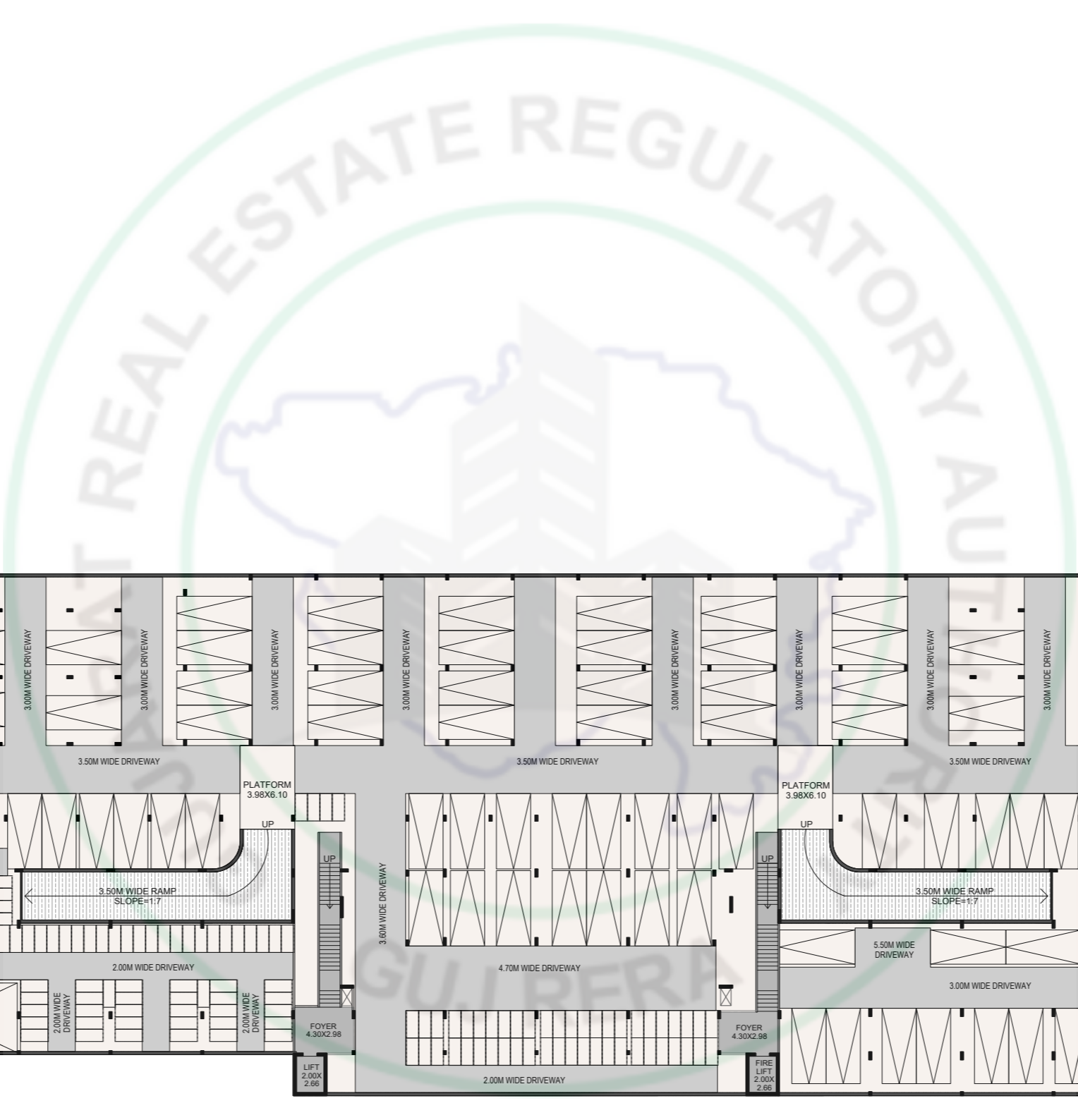

12.00M WIDE T.P.S. ROAD

12.00M WIDE T.P.S. ROAD

15.00M WIDE T.P.S. ROAD

15.00M WIDE T.P.S. ROAD

18.00M WIDE T.P.S. ROAD

42.00M WIDE T.P.S. ROAD

18.00M WIDE T.P.S. ROAD

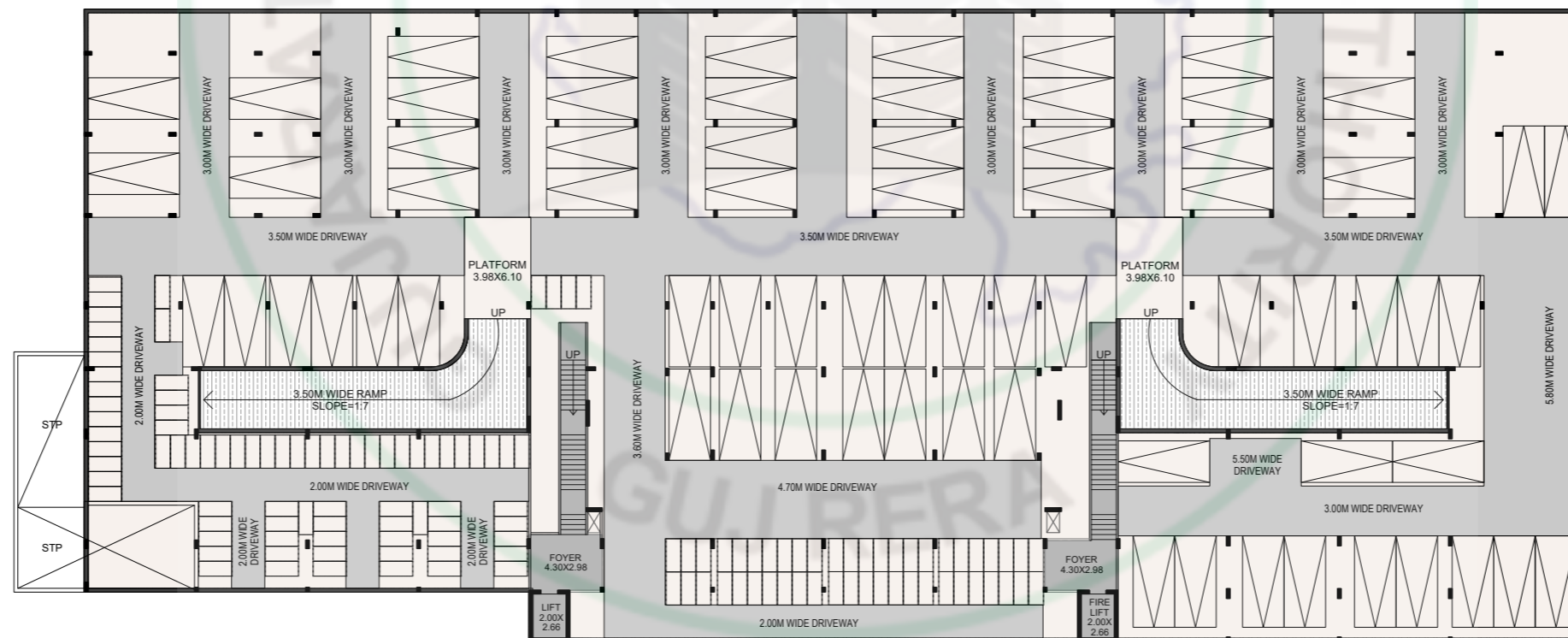

BASEMENT PLAN

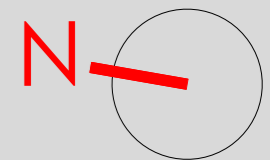



VIEW - 1



VIEW - 2



SPECIFICATIONS

WALL FINISH

- INTERNAL: SMOOTH FINISH MALA PLASTER WITH PUTTY.
- EXTERNAL: DOUBLE COAT SAND FACED PLASTER OR TEXTURE FINISH.

FLOORING

- VITRIFIED TILES FLOORING OR TRIMIX FLOORING.

DOORS

- GLASS DOOR OR ROLLING SHUTTERS

PAINT

- EXTERIOR ACRYLIC EMULSION PAINT OR TEXTURE FINISH.
- INTERNAL WALLS PUTTY FINISH.

WINDOWS

- ALUMINIUM SECTION SLIDING WINDOWS WITH GLASS & STONE JAMS.

TOILET

- CERAMIC TILES FLOORING IN ALL TOILETS.

PLUMBING

- CONCEALED PLUMBING OF UPVC & CPVC PIPES, C.P. FITTINGS & SANITARY WARE

ELECTRIFICATION

- CONCEALED ISI COPPER WIRING & MODULAR SWITCHES WITH ELCB/MCB

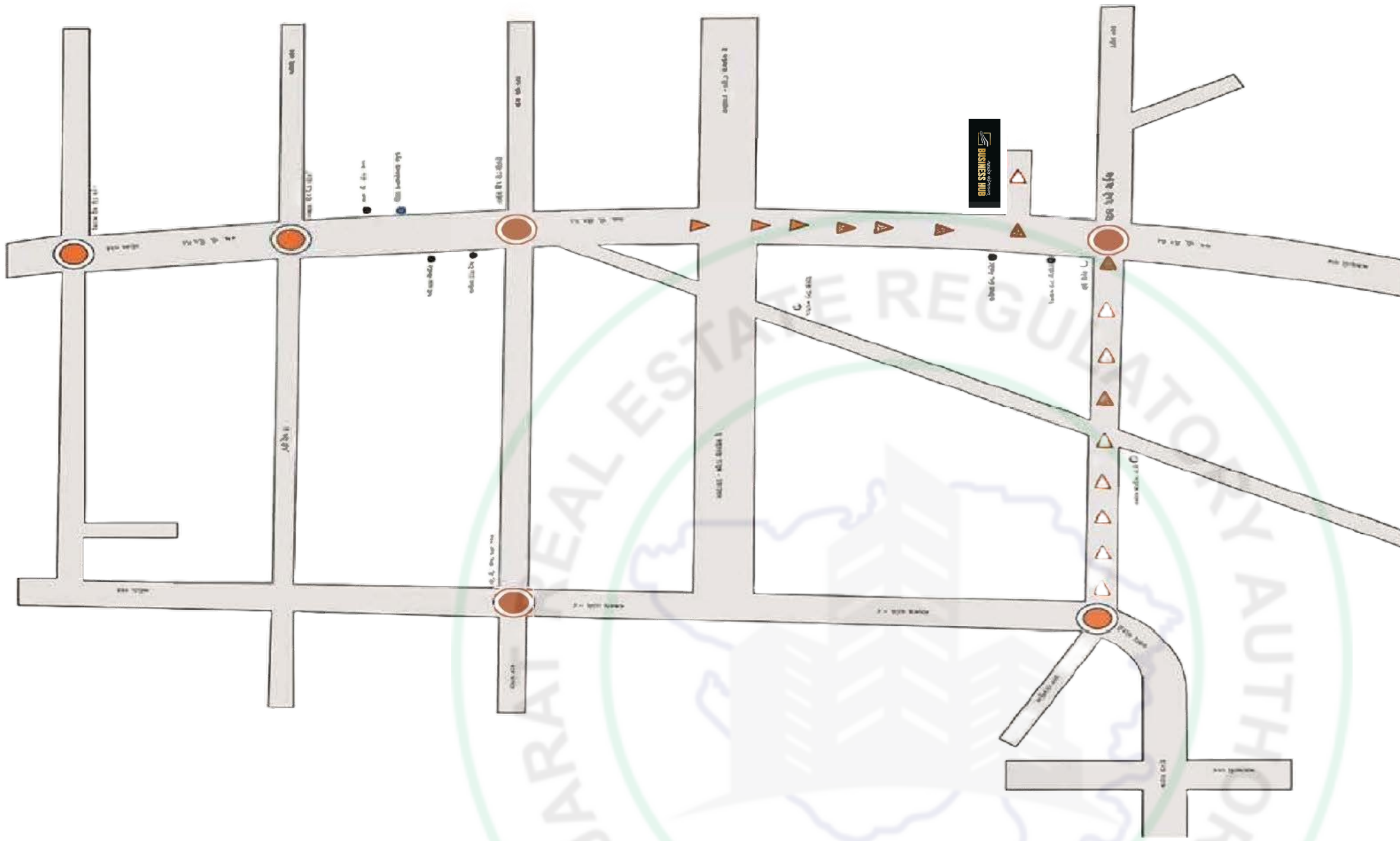

ARCHITECT



STRUCTURE
CONSULTANT



SITE ADDRESS : Mahadev Vandematram Business Hub, Plot No. 86, 90 & 91, Sardar Patel Ring Road, Near Hathijan Circle, Hathijan, next to TATA motors, Ahmedabad, Gujarat 382445,
• For inquiries: 9978989018 • EMAIL:info@vyaptigroup.com