







Green Heaven is a paradise on earth....

**Along with a serene environments
it caters all the wishes as a beautiful host.**

**A space of your own which will rejuvenate your
mind, body & soul.**

**A verdant panorama of Comfort, & amenities; a
midst the soothing lifestyles & peaceful
environs. Step into a picturesque world where
your dream will come true.**

**A residential apartments formed by the
coalition of 100 contemporarily designed
spacious houses for budget home seekers, in
the close proximity to the developing belt of
Atladra-Padra main Road, Vadodara.**

**Green Heaven is truly a perfect combination of
the contemporary style and futuristic trends
modern forever. They are named by the flowers
as the gifts of nature namely Aster, Tulip, Tares,
Ivy, Iris, Lupin, Larch & Brunia.**

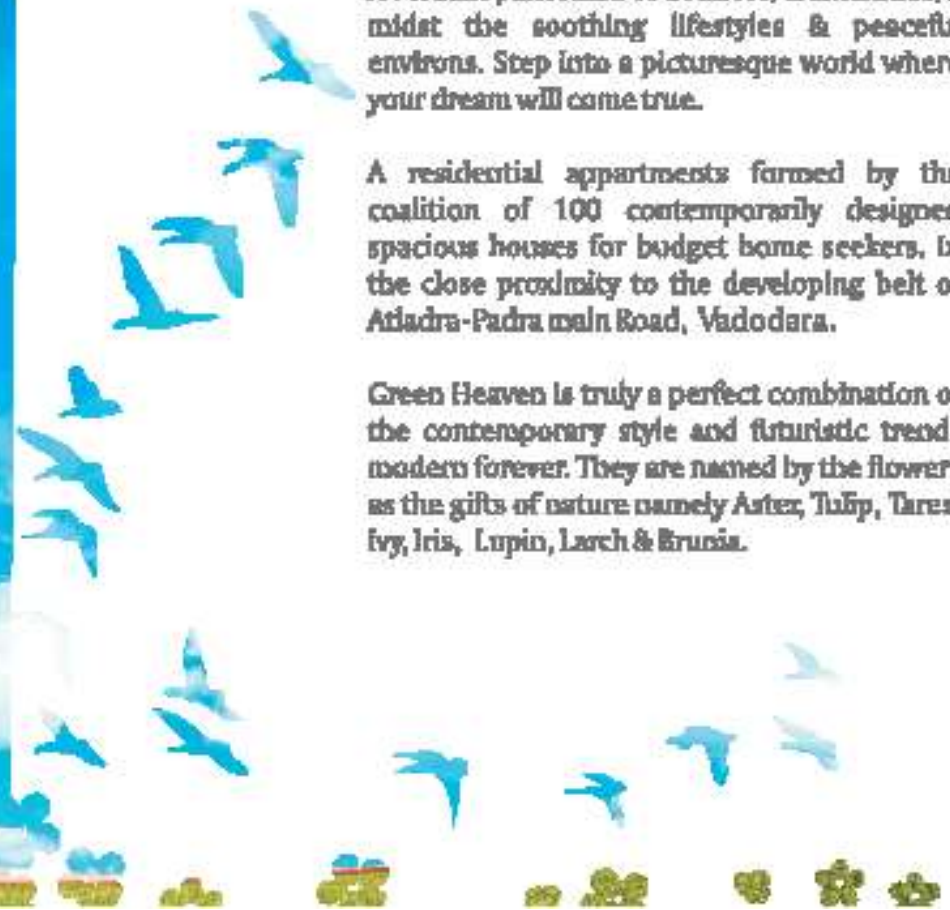



Typical Floor Plan





The most striking feature about this setup is its thematic nomenclature & vibrant color scheme.

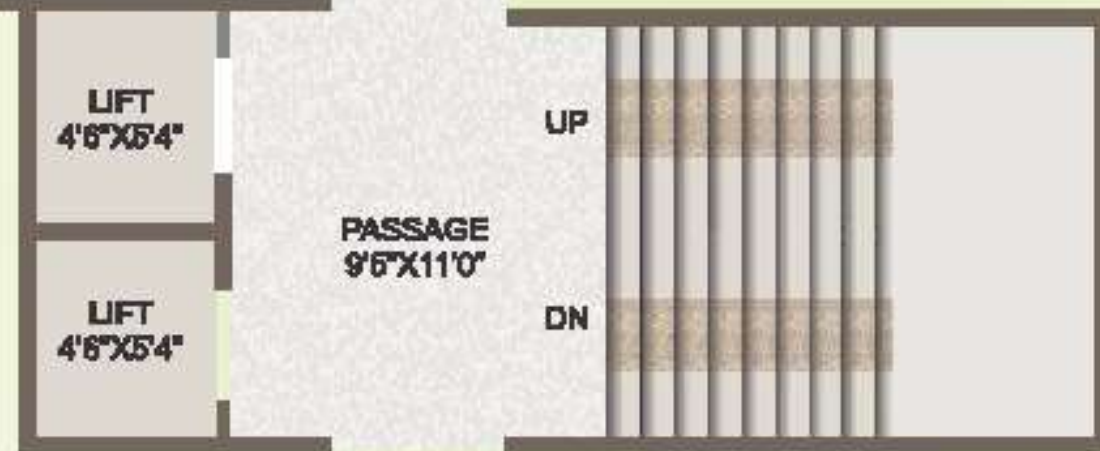



Meticulously worked out floor plan & spacious well designed rooms assures absolute comfort on a tranquil & eco-friendly set up.





SPECIFICATIONS

- **Well designed R.C.C. Frame Structure with brick masonry work as per structural and architect design.**
- **Smooth finished plaster in the Interior walls and ceilings with putty finished and acrylic paints to exterior walls.**
- **24" x 24" Vitrified tiles flooring in all rooms & ceramic tiles flooring in all toilets.**
- **Granite platform with s.s sink and glazed tiles dado upto lintel level above platform.**
- **7' height glazed tiles in all toilets.**
- **Attractive main doors with brass fittings. All other good quality flush door with oil paint.**
- **Aluminum section window with mosquito grill.**
- **M.S. safety grills on all windows with oil paint.**
- **Concealed plumbing with standard fittings.**
- **Concealed electrification with modular switches. A.C. point in all master bed room, TV point & Telephone point & provision of internet connection.**



AMENITIES

- Well elevated Main Entrance gate with security cabin.
- 24 hours security with intercom facility.
- Periphery compound wall for gated community.
- Landscaped garden for common plot.
- Concrete roads & pavers for dust free environment.
- Underground cabling for power supply.
- Yoga deck.
- Children Park.
- Jogging track.
- Party/Event lawn.
- Senior citizen sitting.
- Generator facility for common passage & Lift.
- 24 Hour water supply with auto control mechanism.

CLUB HOUSE

- Air-conditioned Gym.
- Luxury lounge.
- Indoor game room.
- Multi purpose hall.

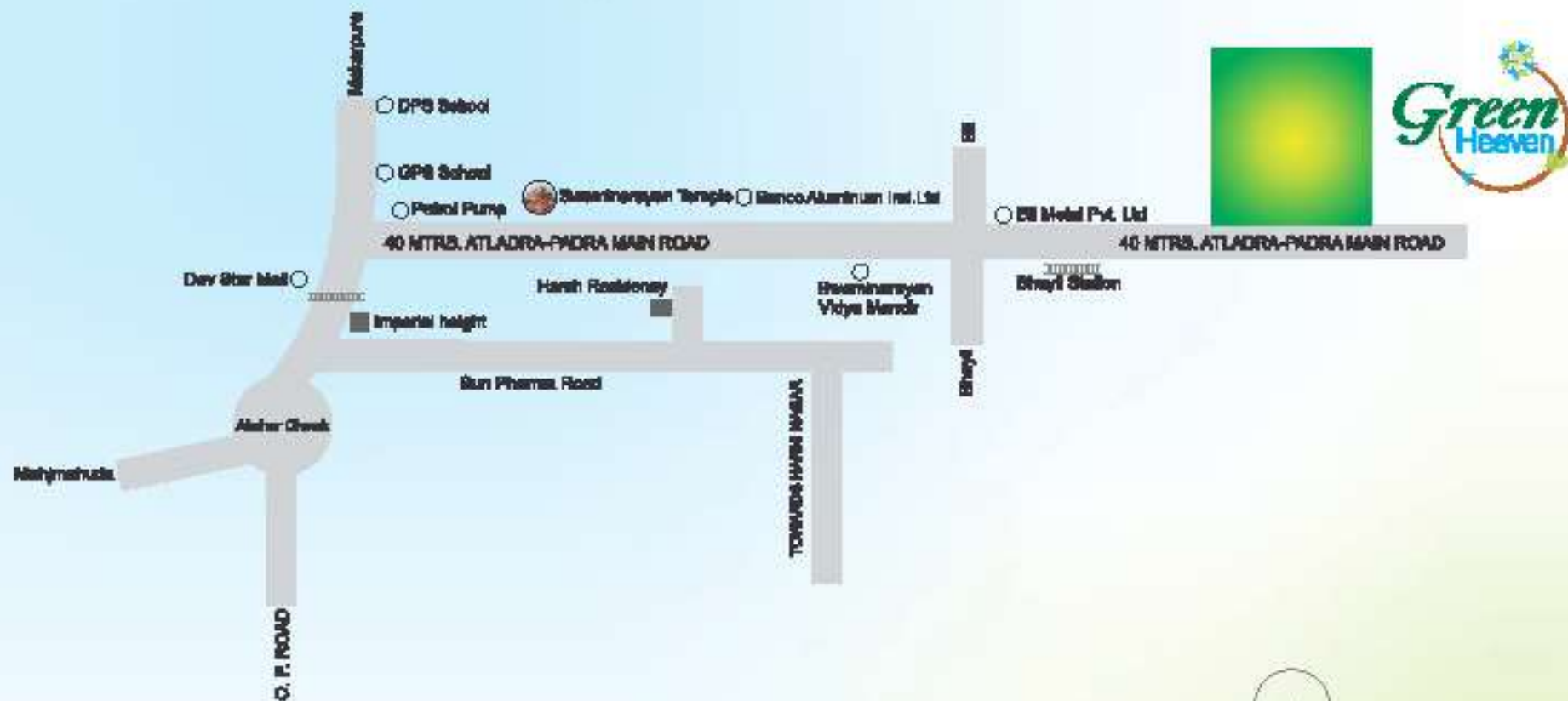

Developers: Heaven Associate

Atladra-Padra main Road, Nr. Bhayali Station,
Nr. Banco Products Ltd., Vadodara.
M: +91 99252 25570, +91 96246 88550

W heaven2011.web.com
E greenheaven2011@yahoo.com

Architect: Ruchir Sheth
Structure Design: Shreeji Structural

We Request : • Document charges, maintenance deposit & all government taxes (if applicable) are extra. • Possession of sold flats shall be given after 30 days of full payments & maintenance deposit. • The developer reserve their rights to make any additions, alterations in elevation, plans, F.S.I. Association shall be formed between all the members of the flats & member shall be bound by rules and regulations of the association. • Any specification or information in this brochure cannot form part of an offer, contract or agreement.

