

## SITE PLAN

## AMENITIES

### PROJECT SPECIFICATION :- SUMATI SANIDHYA

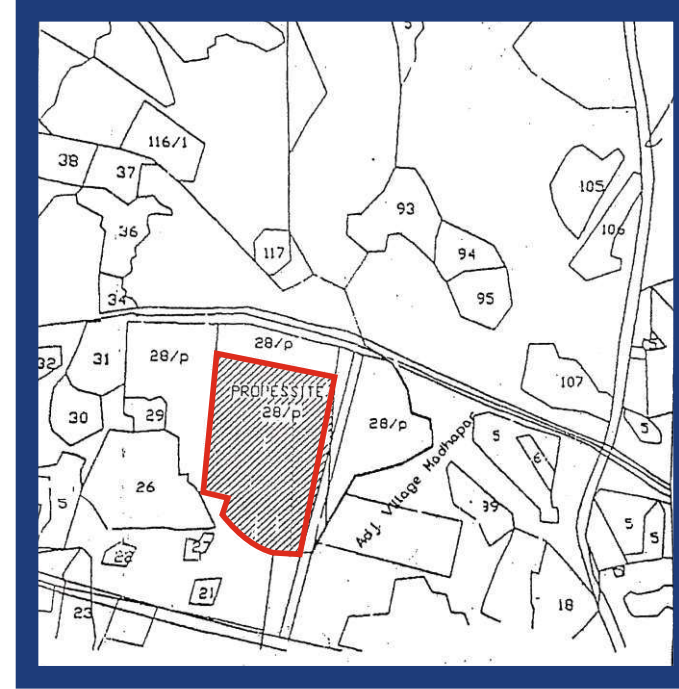

1. **Structure** :- Earthquake Resistance RCC frame structure design.
2. **Door** :- Attractive Main Door (water proof flush door) (Laminate sheet only in main door), Room and Bathroom normal door with water proof ply. Main door with Europe locks fittings. Main door and room door with ply frame / marble and bathroom door with marble / cotastone frame.
3. **Window** :- Aluminum section sliding window of stander company.
4. **Flooring** :- 600MM x 600MM vitrified tiles.
5. **Kitchen** :- Granite Plat form with SS Sink and Decorative Glazed Tiles up to lintel level.
6. **Bathroom** :- Elegant Tiles with sanitary fitting, Tiles up to lintel level, Stander Company Bath fittings and one Solar water heater point for hot water.
7. **Electrification:-** Concealed Electrification with copper wiring, Modular switch with TV cable point.
8. **Plumbing** :- CPVC / UPVC or PVC pipe for water supply.
9. **Washing Area:-** Lintel level glaze tiles and washing point.
10. **Elevators** :- Two Automatic elevators with Generator.
11. **Security** :- Parking CCTV Camera.
12. Elevation with Acrylic paint, Common area with normal paint, internal wall with putty finish.
13. Light Connection, GAS connection, Standard Drainage System, Water bore well.

**Project Developed By.**

**Shital Enterprise**

**Parag Bhai - 98252 30990**

**Jignesh Bhai - 98251 55273**

**Rakesh Bhai - 82002 48216**

**Consulting Engineer :**

**Bhavesh Patel : 9898241673**

**Architect :**

**Chetan Pancholi : 9825218448**

**Structural Consultant :**

**Sanjay Unjia : 9727755884**

**Address :**

**Ghanteshwar, Revenue Survey No. 28P, Final Plot No. 78/79**

# SUMATI SANIDHYA



# GROUND FLOOR PLAN

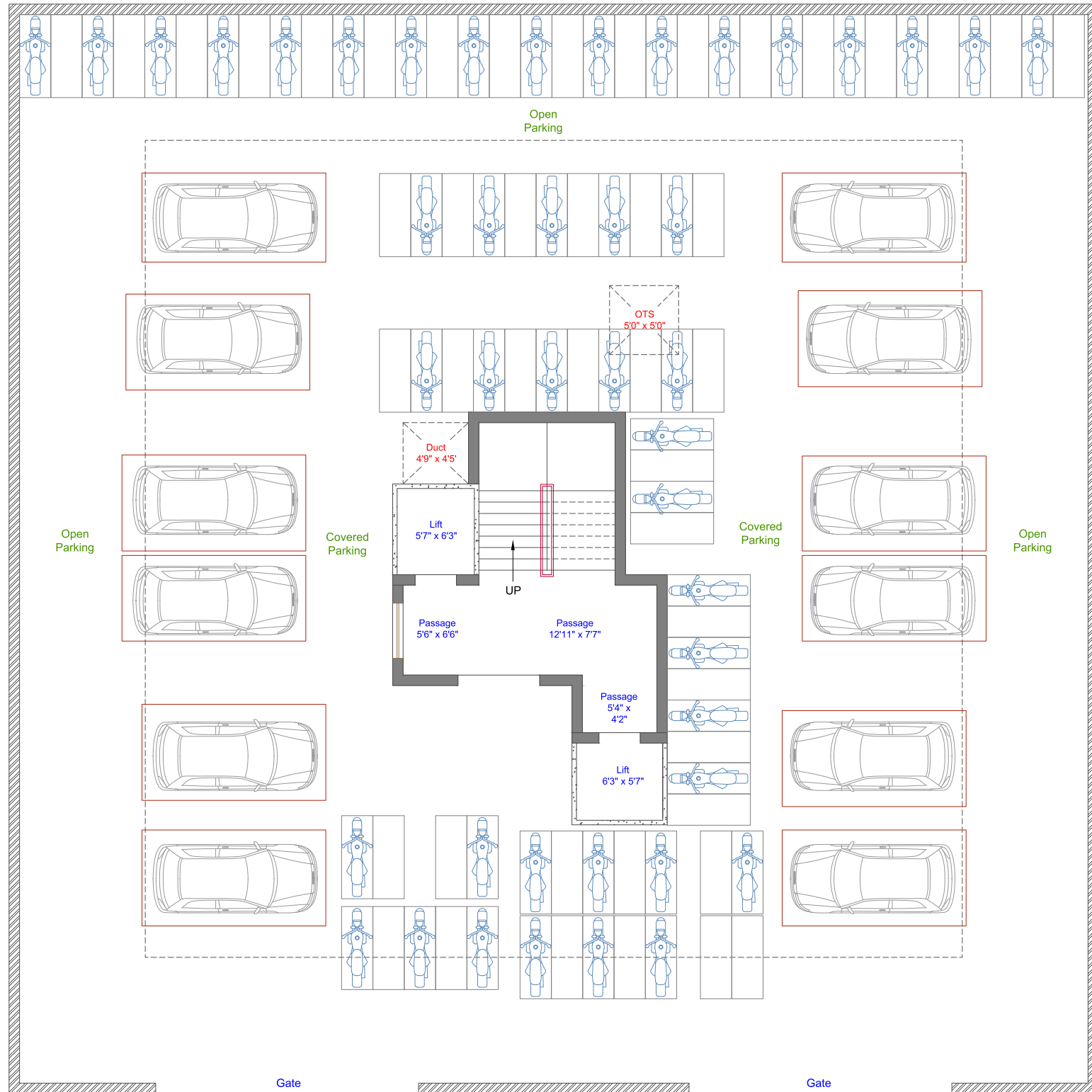

# TYPICAL FLOOR PLAN 1st To 5th Floor

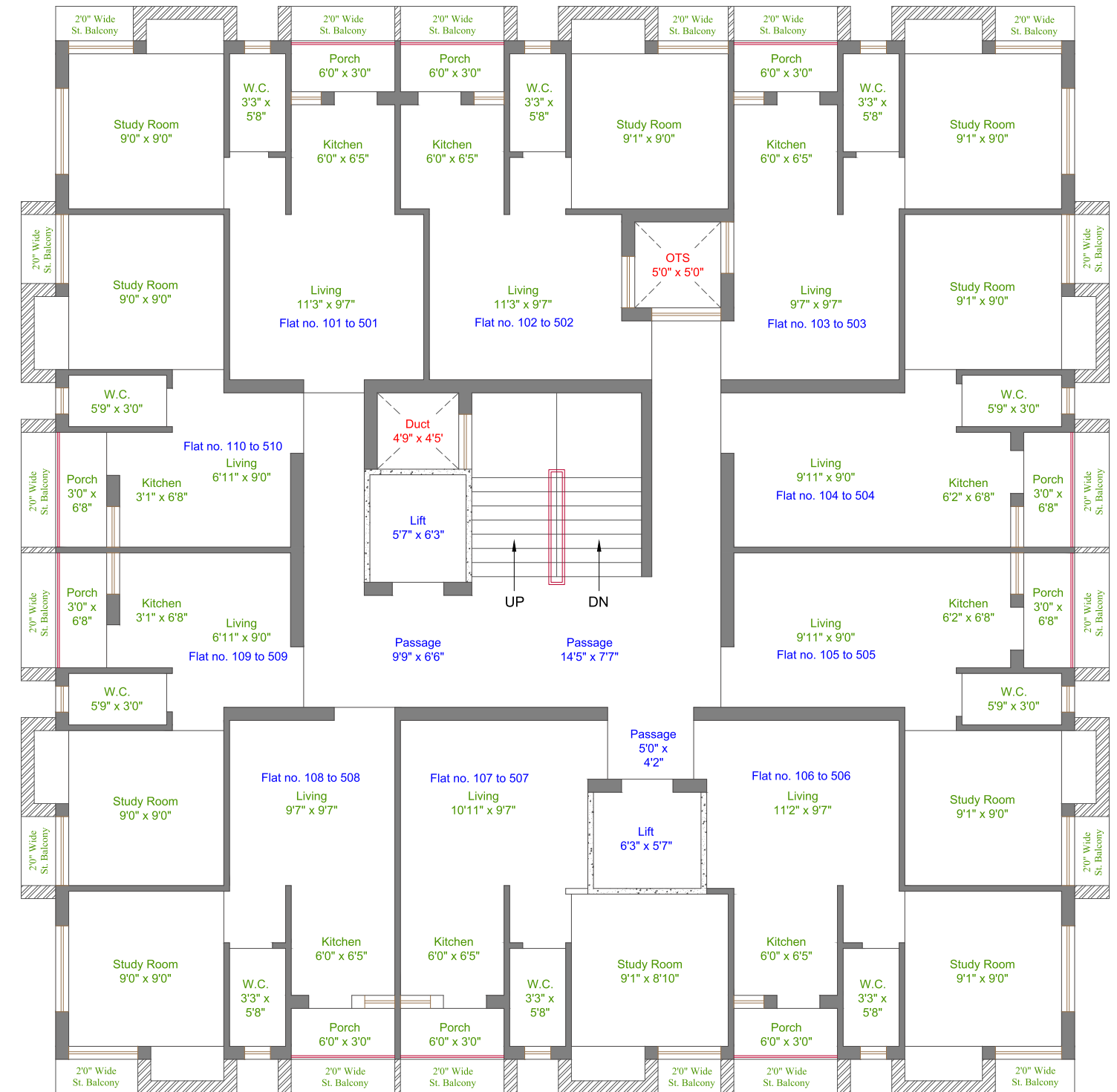

← 9.00 Mt Wide Road →

