

Developers :-

AVANEESH INFRA

**Site Address :- Avaneesh Heights, Bs. Podar World School,
Nr. Vundalay Heights, Sama-Chhani Canal Road, Chhani, Vadodara.**

Booking Contact :-

910 433 7275

avaneeshheights200@gmail.com

Architect :-

Asquare
Architect & Interior Designer

Structural Eng. :-

ASHOK SHAH &
ASSOCIATES

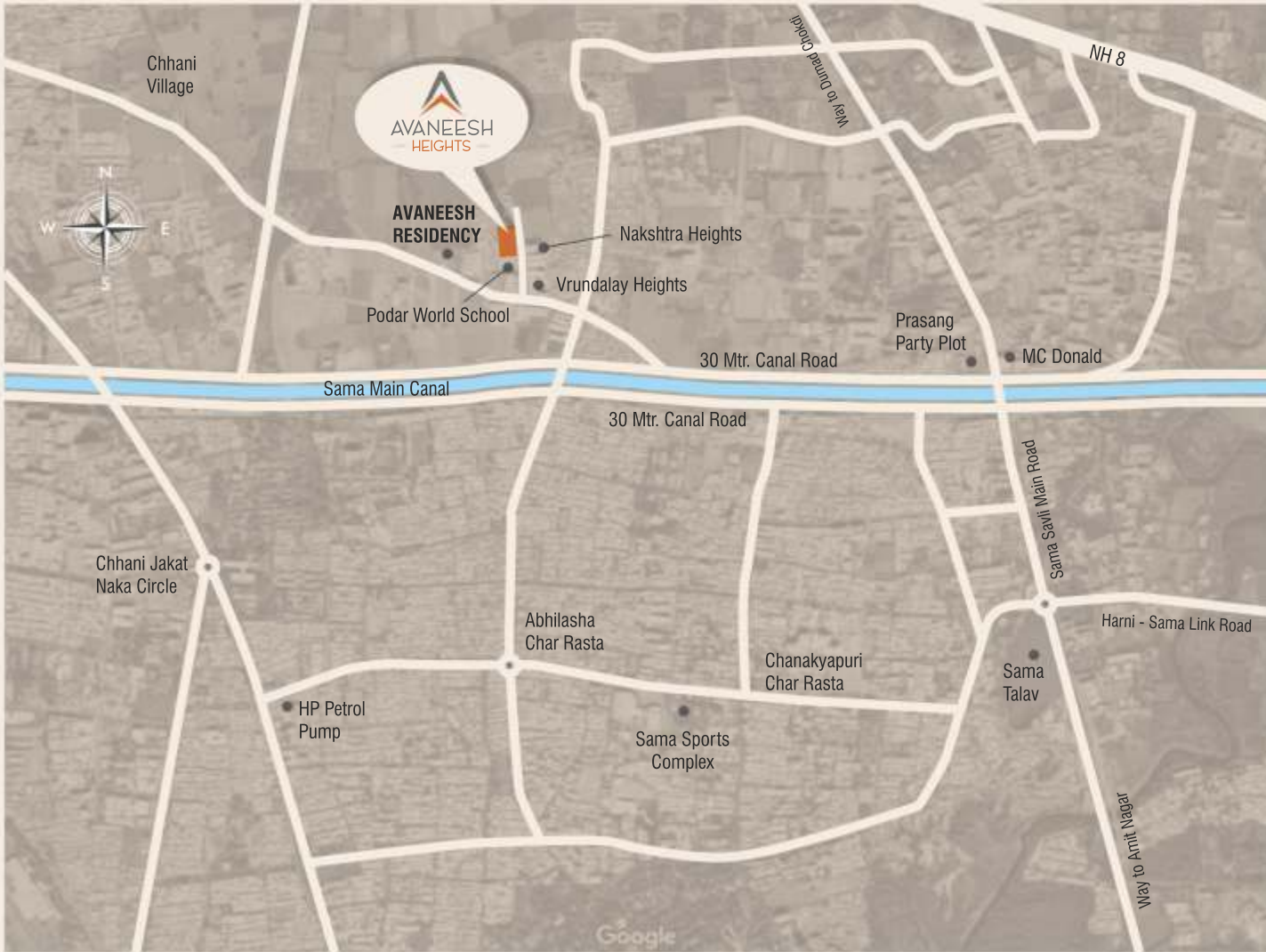

Rera Reg. No. :

PR/GJ/VADODARA/VADODARA/Others/ /

Website:- www.gujrera.gujarat.gov.in

PAYMENT MODE

10% Booking	10% 10th Slab
20% Agreement to sell	05% Masonry Work
10% 2nd Slab	05% Flooring Work
10% 4th Slab	05% Finishing Work
10% 6th Slab	05% Before possession
10% 8th Slab	

Notes :- (1) Possession Will Be Given After one Month of Settlement of all Accounts (2) Stamp duty, Registration charges, MGCL Meter Charges, GST or any new central govt, state govt, VUDA / VMSS taxes if applicable shall have to borne by the client (3) Extra work shall be executed only after making full advance Payment as per developers estimate, however change in elevation or Plan will not be allowed (4) Any delay in payment as per payment schedule shall be attract interest at the rate of 18 % P.A on outstanding amount and continuous default in payment shall lead to cancellation of booking (5) Developers reserve Full right to change alter or raise the scheme related measurement, design, drawing or any details herein and such change will be binding to all unconditionally. (6) In case of cancellation of Booking, Refund will be made only after New Booking (7) Any Plan, specifications or information in the brochure is subject to change and this brochure does not form part of an offer, agreement, contract or legal document (8) All dimensions are indicative and actual dimensions in each room might vary (9) Plot area shown in list is per site condition and may vary (10) All member shall have to essentially be the part of the society formed by the association members and shall have to agree by the society by laws. (11) After virtual completion of the work all repair and the maintenance like drainage, watchman salary, electricity bill etc. shall be borne by society members. (12) In Case of Delay in water Supply, Electricity Connection and Drainage work by authority, Developer will not be Responsible. (13) Timing of possession may be delayed due to unforeseen situation.

AVANEESH HEIGHTS

2 BHK & 3 BHK ELEGANT FLATS



LIVING THE GOOD LIFE IN A SPACIOUS HOME

Welcome to a place where smart planning and strategic choice of location encapsulates your home in a cocoon of harmony. Where you can evolve and energise in tranquil surroundings and gain peace of mind with the finest quality of life.

The exclusive design has redefined the realty space and extended the reach of the best of luxurious facilities and detailing to those looking for home in a pocket friendly range. Its cost-to-return ration, along with its desirable location and amenities it boasts of make it an ideal investment promising a ver elite quality of life.

Avaneesh Heights is an offering from a well experienced and committed team of real estate developers. Timely completion of the project and providing you best value for your investment will always be our endeavor.

SPECIFICATIONS

STRUCTURE : RCC frame structure with good quality material as per structural Engineer's design specifications.

FLOORING : Vitrified tiles flooring with skirting in entire apartment.

WALL : Internal walls with putty and primer finished, exterior walls with acrylic paint.

DOOR : Elegant entrance door and internal flushed door with both side laminated.

WINDOWS : Aluminum windows with powder coating.

BATHROOMS : Glazed tiles full height dedo with standard quality C.P. fittings & Concealed PVC pipe fitting.

ELECTRIFICATION : Concealed & ISI copper wiring with standard modular fittings along with A.C. Point in all bedrooms & geyser point in all bathrooms

WATER SUPPLY : Underground and overhead tank for 24 hours water supply with auto control system.

KITCHEN : Granite platform with SS Sink & designer tiles dado upto lintel level.

Basement LAYOUT PLAN

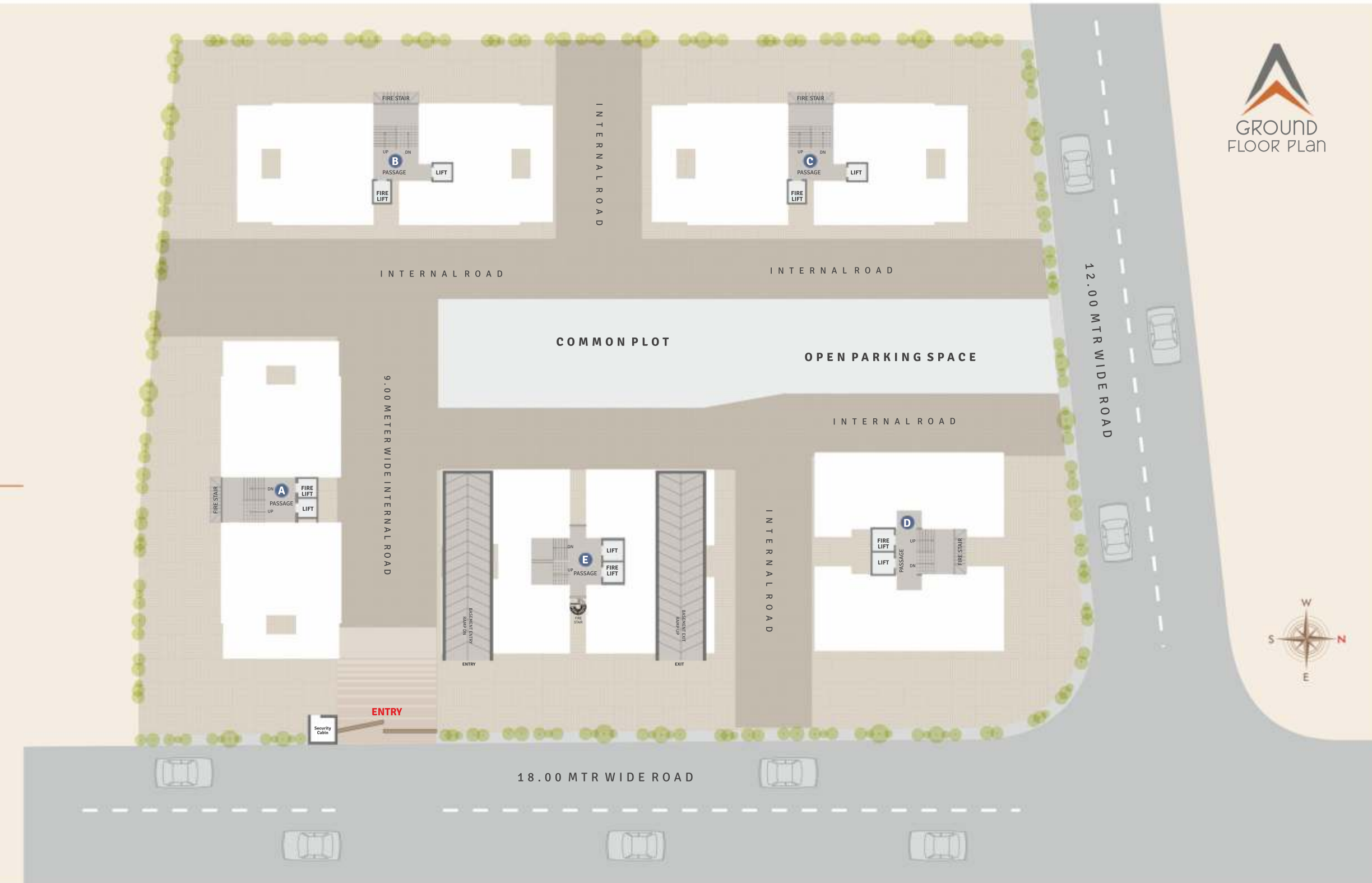
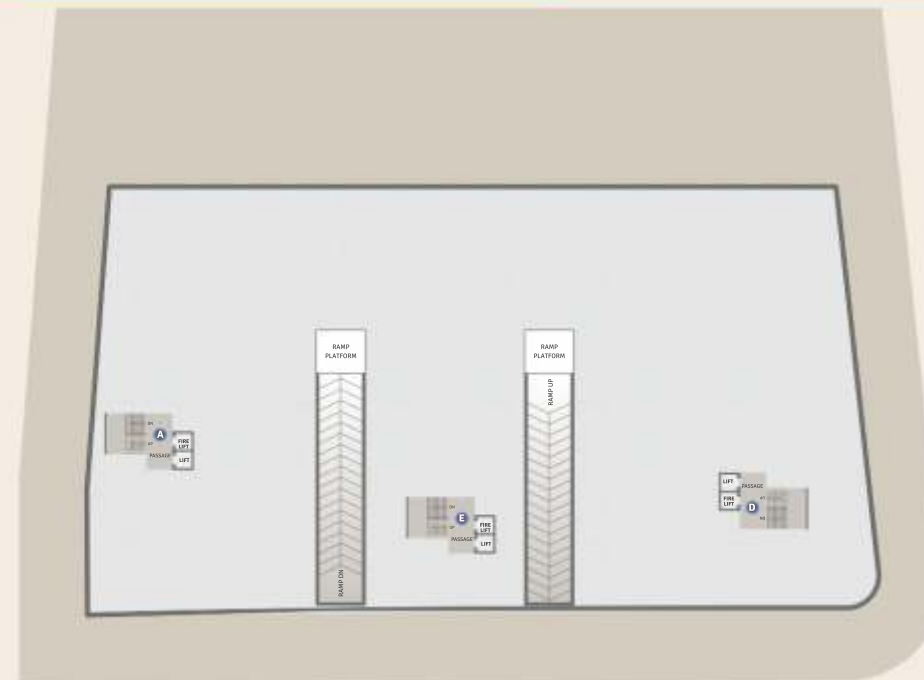

2 BHK
TYPICAL FLOOR PLAN



TOWER B



2 BHK
TYPICAL FLOOR PLAN



TOWER C



TOWER D

2 BHK
TYPICAL FLOOR PLAN



TOWER E

3 BHK
TYPICAL FLOOR PLAN

