

LOCATION



DEVELOPERS:

**Shree Girirajji
Developers**

SITE:

Site: 30 Mtr. Harni-Sama Link Road,
Bh. Siddheshwar Paradise,
Near Akshar Heritage,
Nr. Gada Circle, Harni, Vadodara-22.

ENQUIRIES :

+91 63551 12488
Email:
aksharpriva@gmail.com

ARCHITECT:



STRUCTURE:



PAYMENT TERMS : • Up to 10% at the Time of Booking • Up to 30% after agreement to sell • Up to 45% at the time of completion of Plinth • Up to 70% at the time of completion of slab • Up to 75% at the time of completion of Internal Plastering, Internal Walls, Floorings, Doors & Windows • Up to 80% at the time of completion of Sanitary Fittings Entrance Lobby, Staircase • Up to 85% at the time of completion of External Plastering, External Plumbing, Water Proofing, Elevation • Up to 95% at the time of completion Electrical Fittings, Paving etc. • 100% at the time of handing over of possession

DISCLAIMER : The following will be charged extra in advance / as per Government norms - (a) Stamp duty and registration charges, (b) GST (actual) or any such additional taxes if applicable in future. • If any new taxes applicable by Central or State Government in future it will be borne by the customer. • Premium quality materials or equivalent branded products shall be used for all construction work. • Right of any changes in dimensions, design & specifications will be reserved with the developer, which shall be binding for all members. • External changes are strictly not allowed. • Mgvcl meter deposit should be levied separate. • Each member needs to pay maintenance deposits separately. • In case of booking cancellation, amount will be Refunded from the booking of same premises and minimum of rupees 50,000/- will be deducted from the booking amount • Possession will be given after one month of all settlement of account. • Extra work at the cost of client with prior estimate needs to be given in advance but no change in elevation and plan will be done. • The developer reserve the full right to make any changes. • This brochure does not form a part of agreement or any legal document, It is easy display of project only. • Right of any changes in dimensions, design and Layout, specifications, elevation will be reserved with the developers.

HONEST CR_98243 85808



**AkshaR
PRIVA**



LAYOUT PLAN

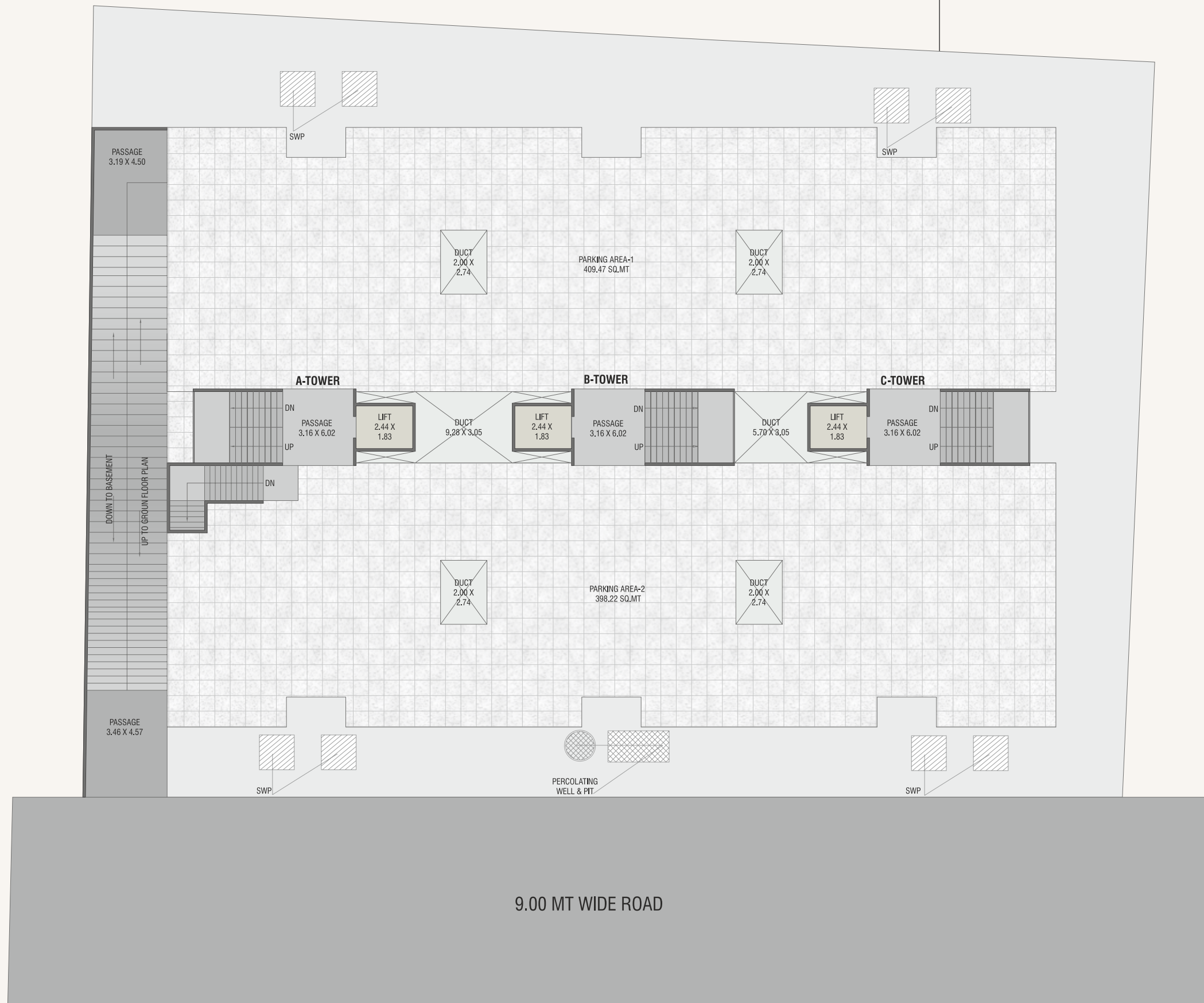

SPECIFICATION

FLOORING

- Superior quality Vitrified flooring
- Elegant flooring in parking area

KITCHEN

- Granite top platform with S.S. sink
- Decorative Glazed tiles dedo

DOOR - WINDOWS

- Attractive main door in wooden frame or equivalent
- Good quality flush door in all bedrooms with laminates on both side
- Aluminum powder coating window
- Safety grill in all windows

COLOUR

- Exterior paint to exterior surface wall and White putty finish with paint for internal wall surface.

ELECTRIFICATION

- Concealed wiring of standard quality with modular switches
- T.V. point in living room & two bedrooms
- A.C. point in all bedrooms
- General lighting in common areas
- Well designed light pole in common area

TOILET / PLUMBING

- Standard quality sanitary ware & branded quality plumbing fittings
- Decorative glazed tiles dedo with modern concept
- Ceramic tiles in flooring





VALUABLE AMENITIES

- Elegant entrance gate with security cabin
- Video door security system in each flat
- POP ceiling in living room & all bed room
- R.O. system for each flat
- Electric Geyser in all bathrooms
- Chimney provided in each flat
- Power back-up for Lift, Passage & Parking light
- Standard quality lift
- Brickbat water proofing treatment
- RCC trimix road with street light poles
- Campus with CCTV camera

TOWER - A,B&C

Basement Floor Plan

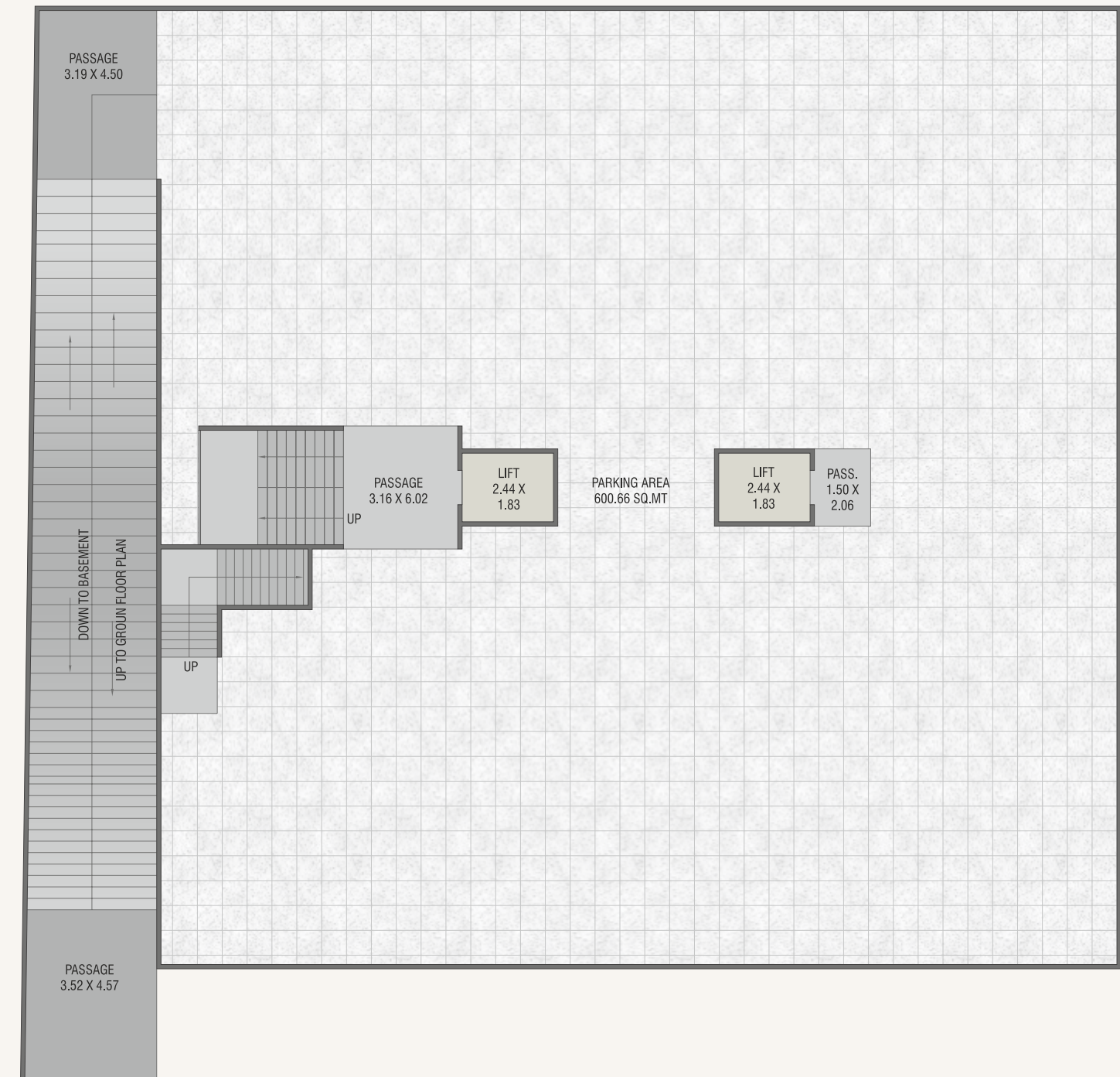

TOWER - A,B&C

Ground Floor Plan

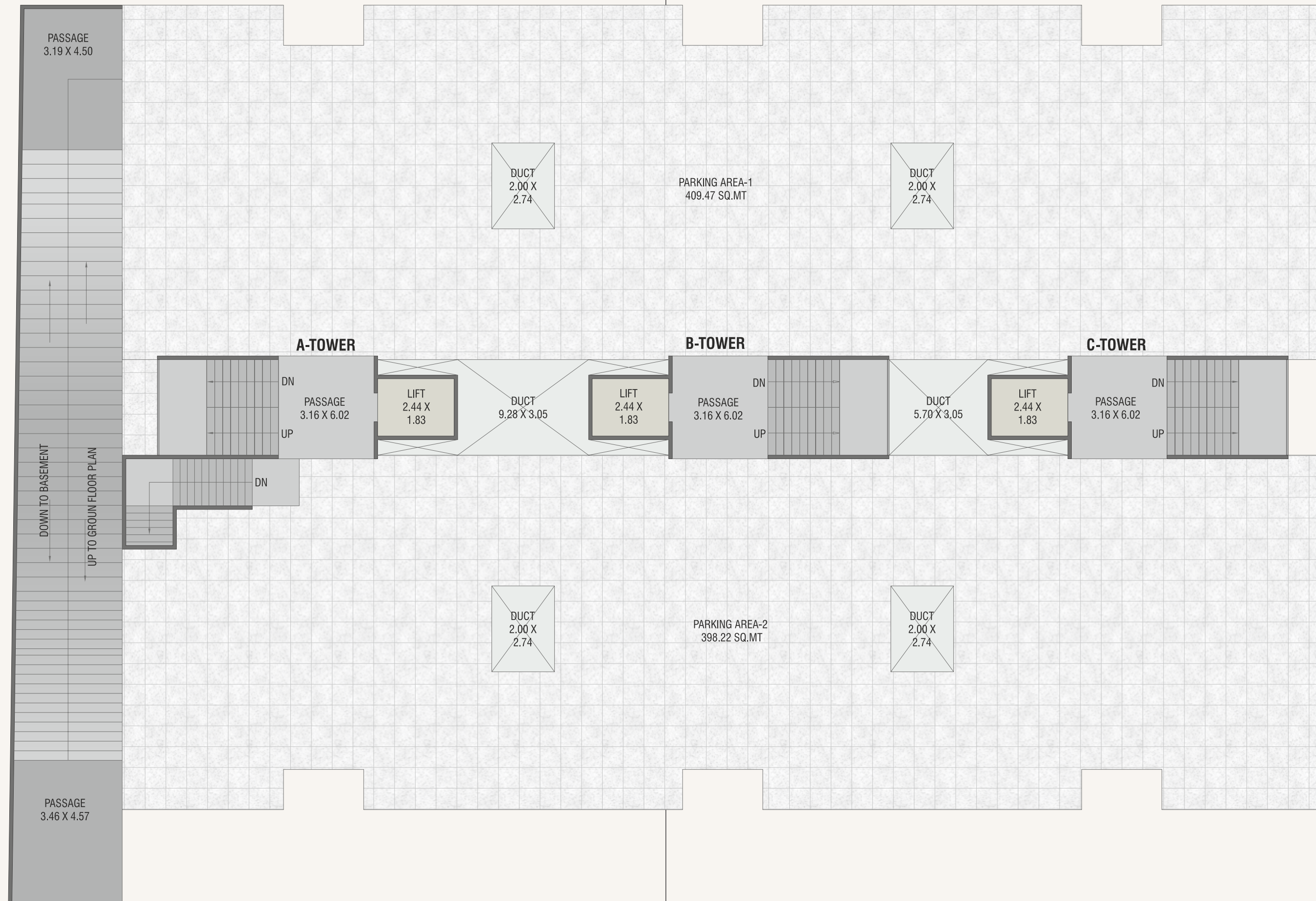

TOWER - A,B&C

Typical Floor Plan (1st to 5th)

