



2 BHK

TYPICAL

TOI
4/3
7/1

2 BHK

TYPICAL FLOOR PLAN...



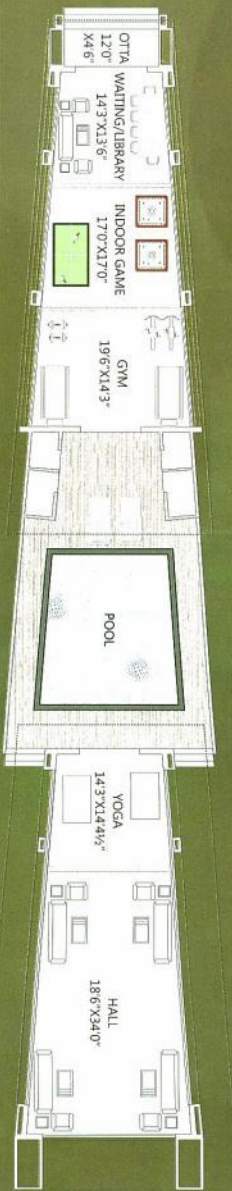

LAYOUT OVER VIEW OF PROJECT...

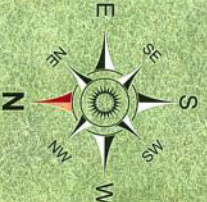

LAYOUT OVER VIEW OF PROJECT...

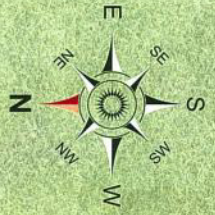

ENTRY

GROUND FLOOR PLAN

FIRST FLOOR PLAN





SPECIFICATION

STYLE YOU NEVER EXPERIENCED...

Structure : Earthquake resistant RCC frame structure & Brick masonry work as per architects design. Compound wall around entire campus.

Flooring : Vitrified tiles flooring in all rooms. Black Granite kitchen platform with SS Sink & Glazed tile up to lintel level.

Electrification : Concealed copper wiring of approved quality with TV, Refrigerator & A.C. Point.

Plumbing : Hot and Cold Plumbing with Shower and Geyser Point in Bathrooms.

Doors : Decorative main door and all other flush doors with Green Marble frames.

Windows : Fully glazed powder coated Aluminum windows.

Finishing : Inside : Smooth plaster with white cement putty finish. Outside : Sand face plaster with Exterior paints.

Water : 24 hour uninterrupted water supply through Under ground and over head water tank with individual bore well to each tower.



AMENITIES

INVITATION TO LIVE A FULLER LIFE...

Designer entrance gate with sound of water & it's unique water body.

You & your family will be safe & secure through the 24 hour security & video door phone security system to each unit.

Parkwoods' bus pickup point for easy access to all other areas of the city.

RCC internal roads, paved sides, sitting benches, street lights & distinctive name of each tower speaks about whole campus beauty.

Huge landscaped gardens to add touch of green to your every day.

Tree plantation creates feel of nature & pleasant atmosphere for you.

Senior citizen park, always blissful to your elder, to keep their evening enjoyable.

Children play area with stylish toy gallery to boost entertainment of your kids.

Modern club house will always be proved unique address due to it's amenities.

Health is always priority to everyone's life which will be maintained in it's well equipped gym.

A splash pool to add water fun to your children's routine.

Library space helps to fulfill reader thirst & positivity creates in mind at yoga & meditation space.

Jogging track gives you energetic morning as well as evening.

Ample parking at ground floor for rest of your vehicle.

Good quality elevator gives you easy access to your home.

RO water purifier system to each unit for pure water.

LOCATION

Stay in the heart of the city on one hand. Plug into the world on the other. Easy access to any part of the city.

Jalandhar Township
Namarda Canal



JIFE...

Modern club house will always be proved
unique address due to it's amenities.

Health is always priority to everyone's life
which will be maintained in it's well
equipped gym.

A splash pool to add water fun to your
children's routine.

Library space helps to fulfill reader thirst
& positivity creates in mind at yoga &
meditation space.

jogging track gives you energetic morning
as well as evening.

Ample parking at ground floor for rest of
your vehicle.

Good quality elevator gives you easy
access to your home.

RO water purifier system to each unit for
pure water.

LOCATION

A LOCATION THAT'S UNRIVALLED...

Stay in the heart of civilisation. Life demands that you be at the Core, at the hub of all activities on one hand. On the other hand, life wants you to rest in the lap of nature. Parkwoods makes this impossible duality possible.

Plug into the whole network. Railway Station is just 4 kilometers & Airport is 9 kilometers away. Easy access of local transport to Parkwood's own bus pick up point makes easy to reach any part of Vadodara within 20 minutes.

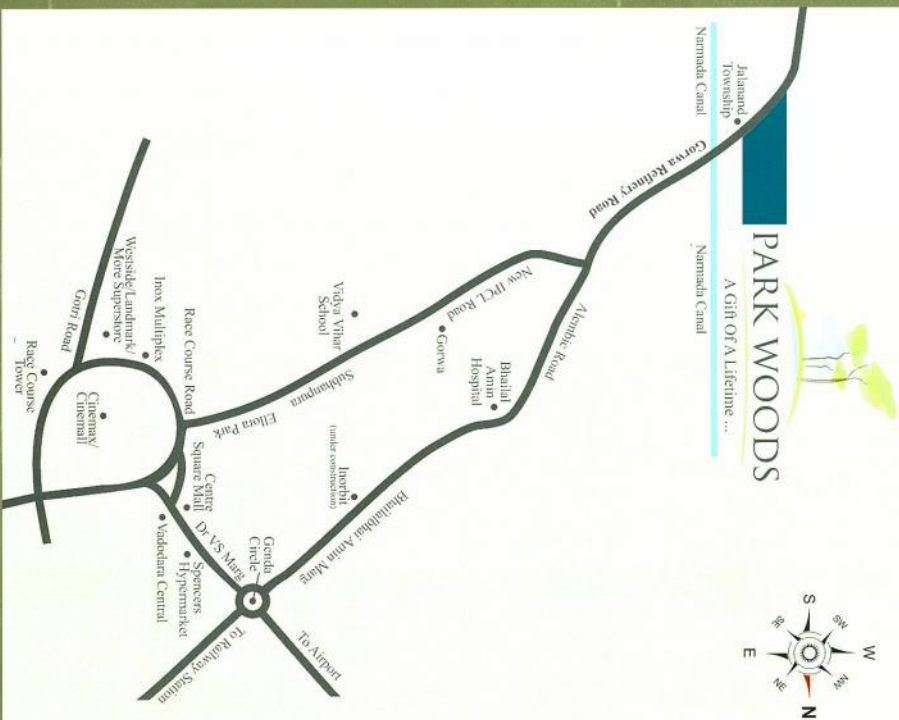

Notes : 1) Possession will be given after one month of settlement of all accounts.
2) Documentation charges, stamp duty, service tax & common maintenance charges will be extra. 3) Any new Central or State Government Taxes, if applicable shall have to be borne by the clients. 4) Extra work shall be executed after making full payment. 5) Continuous default payments leads to cancellation. 6) Developers shall have the right to change the plan, elevation, specification or any details, will be binding to all. 7) In case of delay in water supply, light connection, drainage work by authority, developers will not be responsible. 8) Refund in case of cancellation will be made within 30 days from the date of booking of same unit by a new client. Administrative charges of 25,000/- & the amount of extra work (if any) will be deducted from refund amount. 9) Terrace rights & Future FSI rights will exclusively be of the developers only. 10) Any plans, specifications or information in this brochure can not form part of an offer, contract or agreement.

Mode of Payment :

- | | | | |
|--------|--------------------|--------|----------------------|
| ■ 25 % | At the Booking. | ■ 10 % | Fourth Floor slab. |
| ■ 10 % | First Floor slab. | ■ 10 % | Fifth Floor slab. |
| ■ 10 % | Second Floor slab. | ■ 10 % | Sixth Floor slab. |
| ■ 10 % | Third Floor slab | ■ 10 % | Plaster Level. |
| | | ■ 05 % | Flooring & Finishing |