

3 BHK LUXURIOUS APARTMENTS



Developers:  
**SHARNAM ASSOCIATES**

Site: Nr. Earth Icon 2, Nr. Venice Villa,  
Bh. Earth Icon, Khodiyar Nagar Cross  
Road, Vadodara.

Contact: +91 98250 44208  
E-Mail:  
sharnamicon@gmail.com

Architect:  
**ASQUARE**  
ESTAN PATEL

Structure:  
**ZARNA ASSOCIATES**

SCAN QR  
For Location:



Note: (1) Premium quality materials or equivalent braided products shall be used for all construction work as per Structure Engineer design (2) External changes are strictly not allowed (3) Development charges, stamp duty documentation charges, and all Government or municipal taxes, GST, MGCL meter deposit should be levied separate (4) in case of booking cancellation, amount will be refunded from the booking of same premise after deducting 10% of booking amount (5) Possession will be given after one month of all settlement of account (6) Extra work at the cost of client with prior estimate needs to be given in advance but no change in elevation and plan will be done while every reasonable care has been taken in preparing this brochure. (7) The promoter can not be held responsible for any inaccuracy in this contents. (8) All plans, information and specification are subject to changes may be required by the promoters and can not form part of an offer, contract or agreement.





Greenery wants to *Rejuvenate*  
Water wants to *Flow*  
Earth wants to *Bind*  
you will find all three elements at

  
**Sharnam**  
RESIDENCY

Pamper you with splendour and sophistication reserved  
for those who believe life must be lived to the fullest.  
In this haven of style and comfort, you will find that  
rare factor that best defines luxury the sheer abundance of space

Welcome  
into the gates of  
*Luxury Living*

Rising to fulfill the expectations in luxury living,  
a home at SHARNAM RESIDENCY forces you to  
reconsider the very notion of what an ideal  
residence should be like.



# Ground Floor LAYOUT

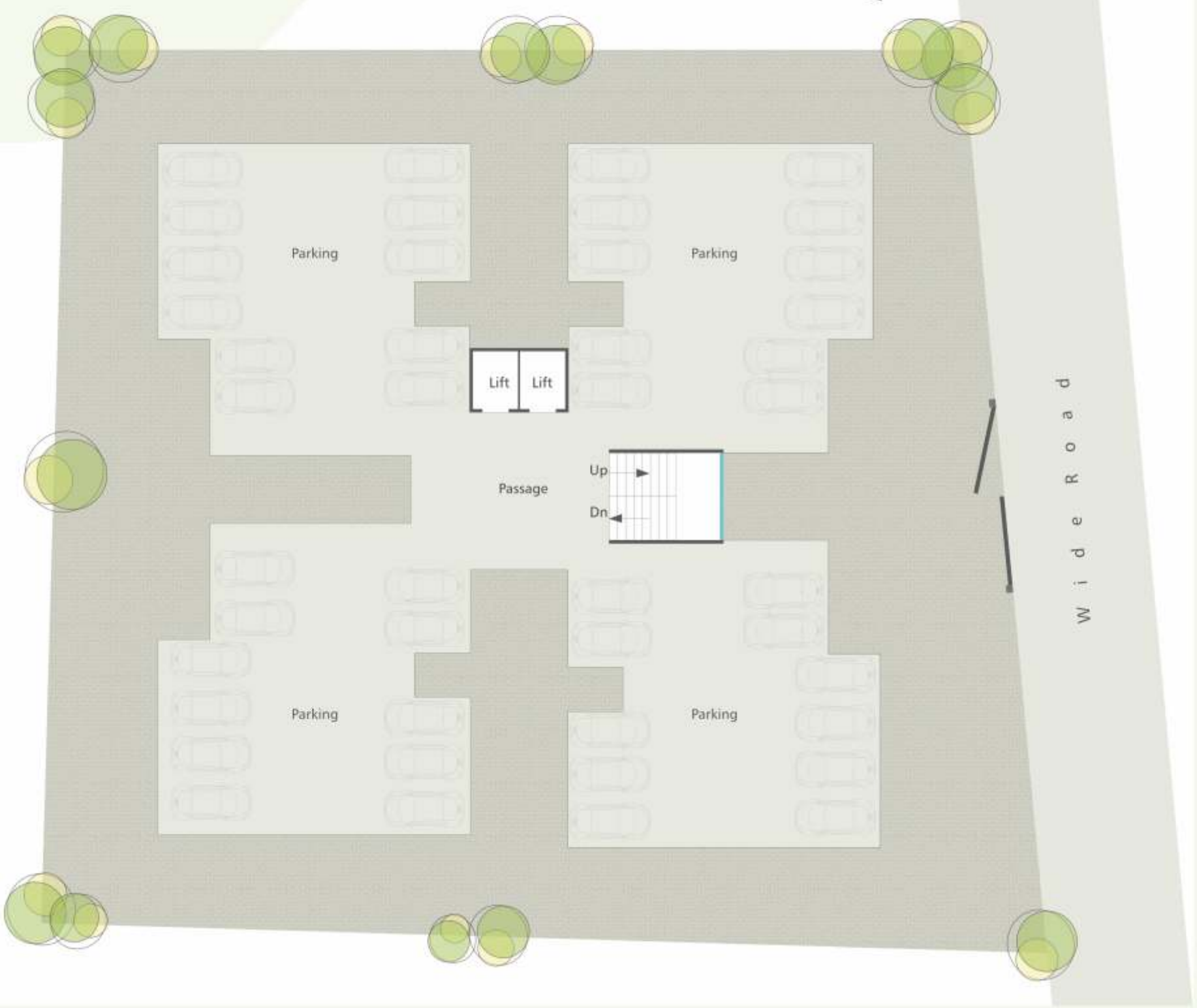

# Typical Floor LAYOUT



  
**3 BHK**  
 TYPICAL FLOOR PLAN



  
*Specifications*

**Structure**

Earthquake resistant RCC frame structure & Brick masonry work as per architects design.

Compound wall around entire campus.

**Flooring**

Vitrified tiles flooring in all rooms. Granite kitchen platform with SS Sink & Glazed tile up to lintel level.

**Electrification**

Concealed copper wiring of approved quality with TV., Refrigerator & Split A.C. Point. in Master Bedroom.

**Plumbing**

Hot and Cold Plumbing with Shower and Geyser Point in Bathrooms. Designer tiles up to lintel level & standard quality C.P. fittings.

**Doors**

Decorative main door and all other flush doors.

**Windows**

Fully glazed anodized Aluminum windows.

**Finishing**

Inside : Smooth plaster with white cement putty finish.

Outside : Sand face plaster with whether shield paints.

**Water Supply**

Underground and overhead water tank with sensor.



## Amenities



Standard quality elevator  
with ARD system



Attractive name plate  
& elegant Letter boxes



Allotted Ground  
Floor Car Parking



Gymnasium



Underground & Overhead  
water tank , 24 Hours water  
supply



Water proofing treatment  
and china mosaic on terrace



Provision for  
Cable TV point



C.C.T.V. Camera in  
common Area