

Developers :-

**SHREE HARI**

Site Address :-

**Shree Hari Residency,**  
Opp. Podar School, B/h Siemens Co.,  
Maneja, Vadodara - 390 013.

Booking Contact :-

**+91 98986 29563 | +91 78740 31910**

Architect :-

**Infinity Design**

Structure :-

**Zarna associate**

Payment Mode :-

10% - On Booking  
30% - Plinth  
30% - G.F. Slab

15% - Plaster

10% - Flooring

05% - Final Finishing



Rera Reg. No. : PR/GJ/VADODARA/VADODARA/Others/

Website:- [www.gujrera.gujarat.gov.in](http://www.gujrera.gujarat.gov.in)

**NOTES :-** (1) Possession Will Be Given After one Month of Settlement of all Accounts or Scheduled Possession date, Whichever is later (2) Documentation Charges, Stamp duty, Development Charges, Government tax (GST), All municipal taxes, MGVL inter deposit, Common Maintenance charges and any Additional tax / Registration charges / levies resulting from any change in the law / Policies of Government / semi Government / Local bodies shall be borne by the customer (3) Extra work shall be executed only after making full advance Payment as per developers estimate, however change in elevation or Plan will not be allowed (4) Any delay in payment as per payment schedule shall be attract interest at the rate of 18 % P.A on outstanding amount and continuous default in payment shall lead to cancellation of booking (5) Developers reserve Full right to change alter or raise the scheme related measurement, design, drawing or any details herein and such change will be binding to all unconditionally. (6) In case of cancellation of Booking, Refund will be made only after New Booking of the unit after deducting Administrative Expense of Rs:- 25,000/- and extra work charges (without interest) (7) Any Plan, specifications or information in the brochure is subject to change and this brochure does not form part of an offer, agreement, contract or legal document (8) In Case of Delay in water Supply, Electricity Connection and Drainage work by authority, Developer will not be Responsible. (9) Timing of possession may be delayed due to unforeseen situation.



*Home For Gracious Living*



**SHREE HARI**  
**RESIDENCY**

**2 BHK RAW HOUSE DUPLEX**



## Amenities

- A contemporary modern planing with attractive elevation
- Main gate with security cabin
- Decorative compound wall society
- Children play area
- Senior citizen siting area
- Street light facility
- Secured well designed project campus with natural light & ventilation
- RCC trimix road with paved side
- Landscaped garden to full the nature surrounding
- Underground & overhead tanks water supply



# SHREE HARI RESIDENCY

2 BHK RAW HOUSE DUPLEX

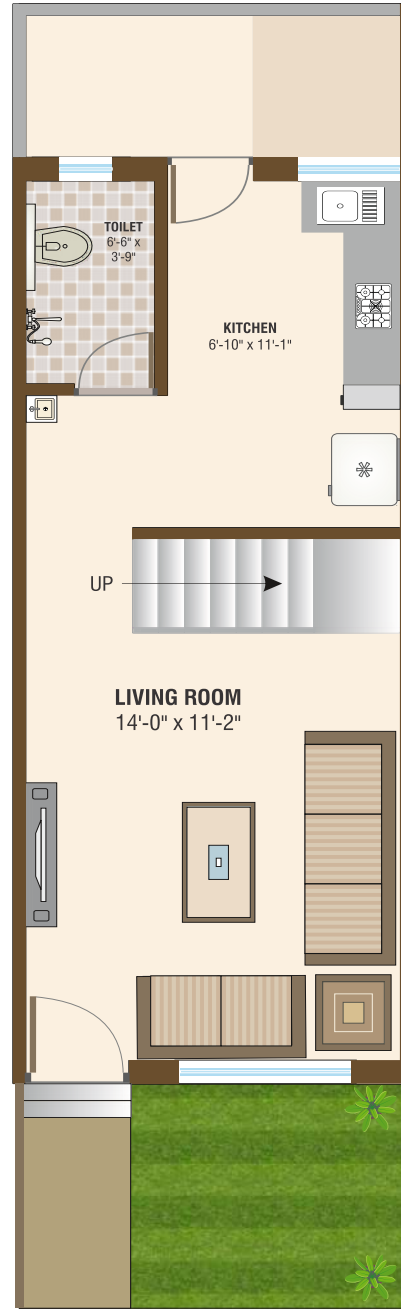

## GROUND FLOOR PLAN

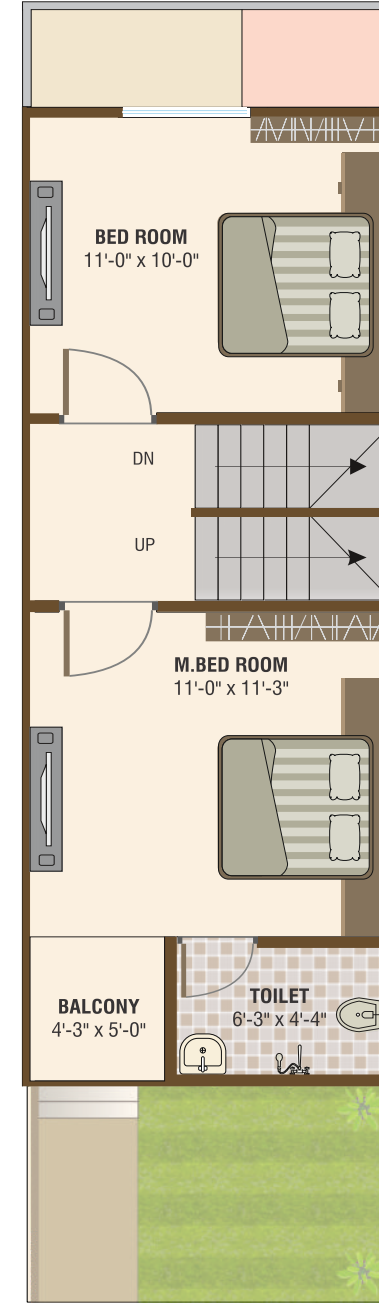

## FIRST FLOOR PLAN

## Specification

**Structure :-** All RCC & Brick work using superior quality material as per structural engineer's design.

**Bathrooms :-** Concealed type CPVC & UPVC plumbing work with branded CP fitting & designer wall tiles dado up to lintel level.

**Electrification :-** Concealed type ISI copper wiring with adequate number of point in all rooms. AC point in Master Bedroom

**Flooring :-** 2' x 2' Vitrified tiles flooring

**Doors :-** Attractive entrance door with safety lock & internal good quality laminated flush door.

**Windows :-** Good quality aluminum powder coated window with granite seal & safety grills.

**Paint :-** Internal smooth finish plaster with putty finish & external double coat plaster with weather resistant paint.

**Kitchen :-** Granite platform with S.S. Sink designer tiles above platform up to lintel level. Adequate electrical point will be provided to operate electronic appliance.

**Terrace :-** Lower terrace finish with china mosaic & upper terrace finish with chemical water proofing

**Staircase :-** S.S.Railing with glossy finish



## LAYOUT



Plot No.	Area Sq. ft.	Plot No.	Area Sq. ft.
1	926.50	14	597.40
2	492.50	15	606.40
3	500.93	16	615.30
4	509.50	17	624.25
5	518.35	18	633.20
6	527.06	19	642.15
7	535.80	20	1488.30
8	544.56	21	944.00
9	553.20	22 to 41	472.10
10	561.90	42	903.70
11	576.61	43	898.70
12	579.50	44 to 65	471.90
13	588.4	66	988.08