

A Prestigious Project By:



**SHREENATHJI
BUILDERS PVT. LTD.**

The tradition of trust
*copyright reserved

Architect:



ARCHITECT'S CLUB

Architect & Interior Designer

Brijesh Shah - 90338 66484

Site Address:



Shreenathji Aangan, Opp. Gayatri Temple, B/H Spring Field Duplex, Nr. Shreenathji Dwar, Khatamba,
New Waghodia Road, Vadodara.

Corporate House:

S.F: 201, 202, 203, 206 Sakar Complex, Nr. Super Bakery, New VIP Road, Vadodara-19.
Ph.: 0265 2513087

For Booking Contact: +91 90818 19987 / +91 88491 69701 / +91 75671 61618

www.shreenathjibuilders.com

Connect with us on:   



3 | 4 | 5 BHK 3 SIDE OPEN BUNGALOWS



*Where life is
never ending fun...*

With numerous indoor and outdoor world class amenities, the world of Shreenathji Aangan stands a class apart. Here life is not limited to the living space. Stupendous swimming pool, eye soothing landscaped gardens, senior citizens area, and kids play zone are few of the many divine features waiting for you here.





FIRST FLOOR

3
BHK

4
BHK

PLOT AREA
725 Sq. Ft.

PLOT AREA
725 Sq. Ft.

FIRST FLOOR

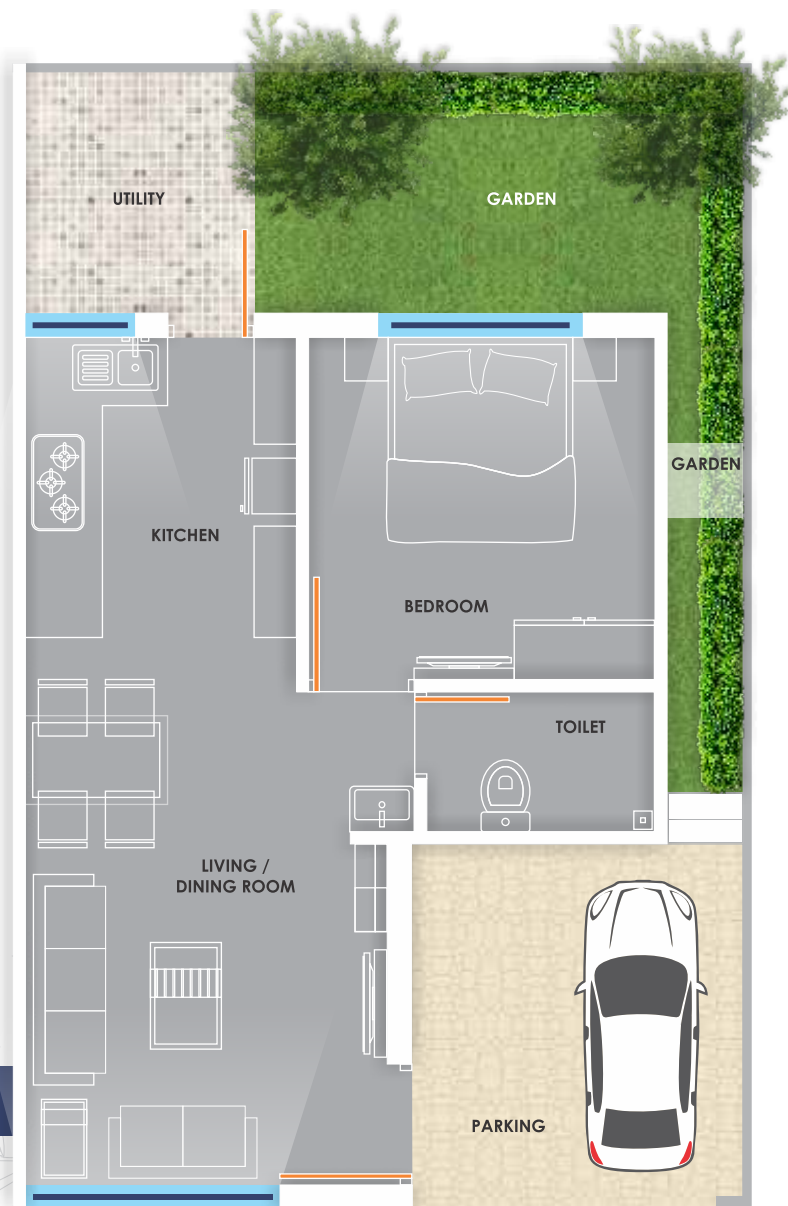
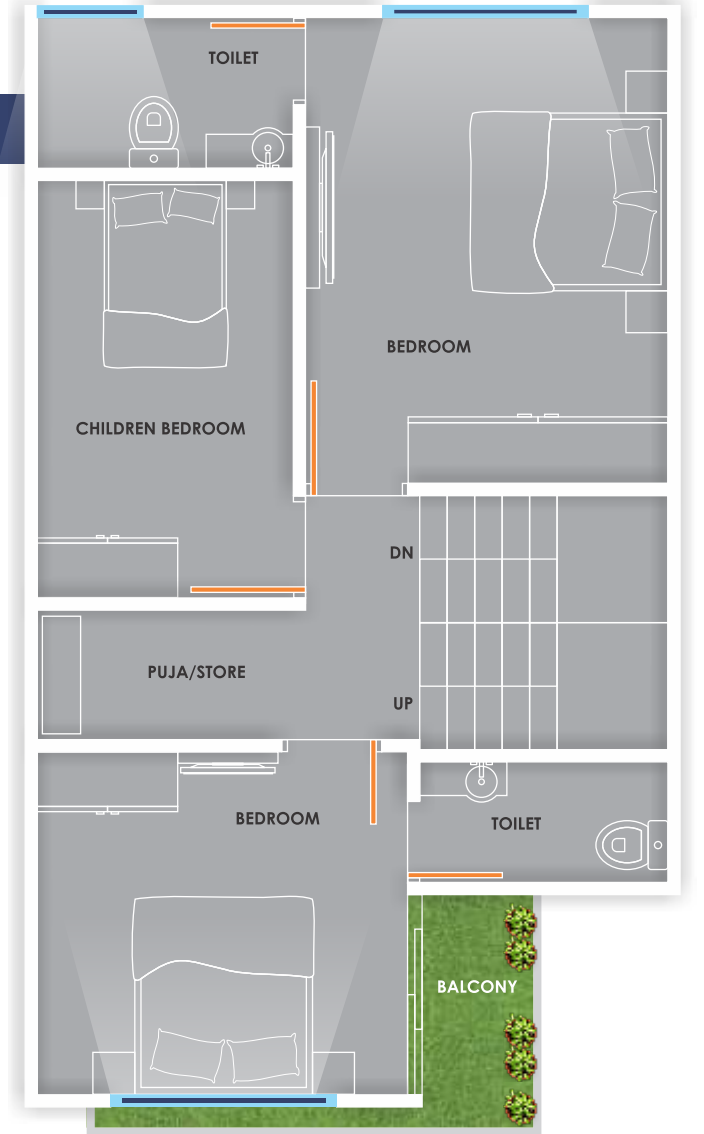

GROUND FLOOR

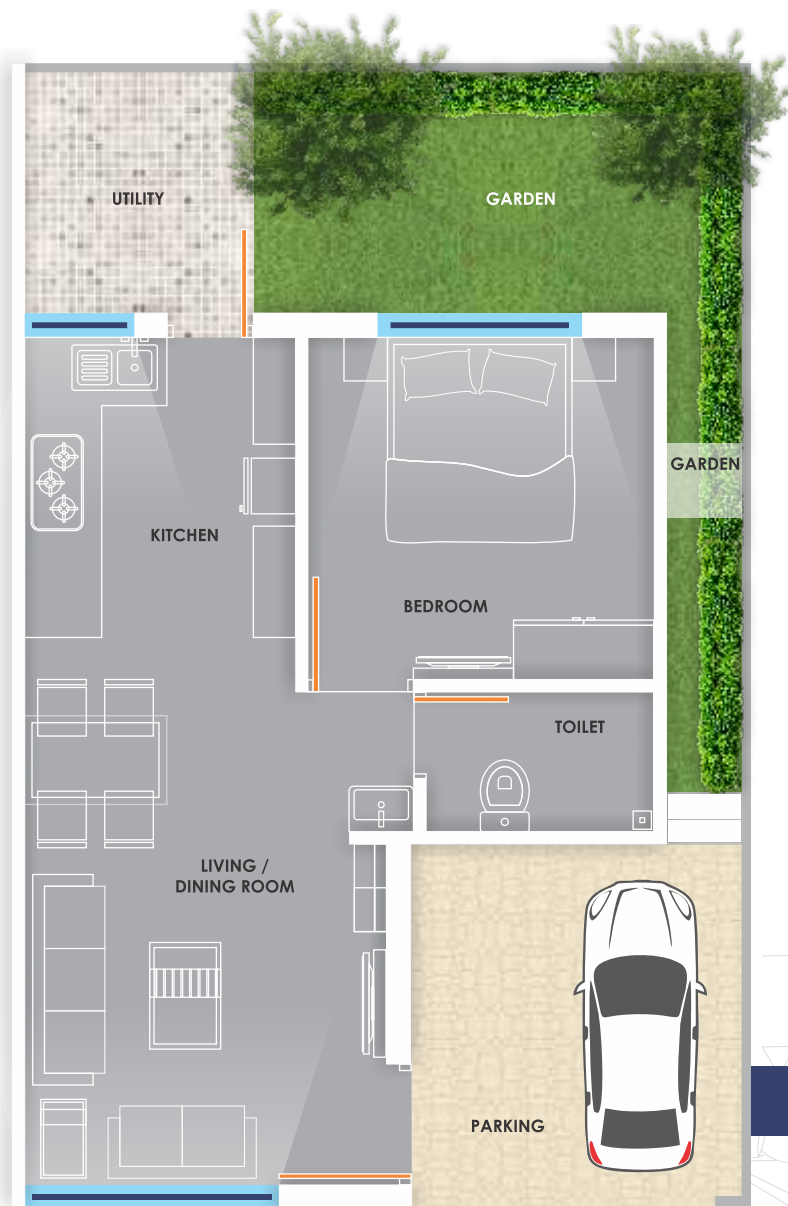

GROUND FLOOR

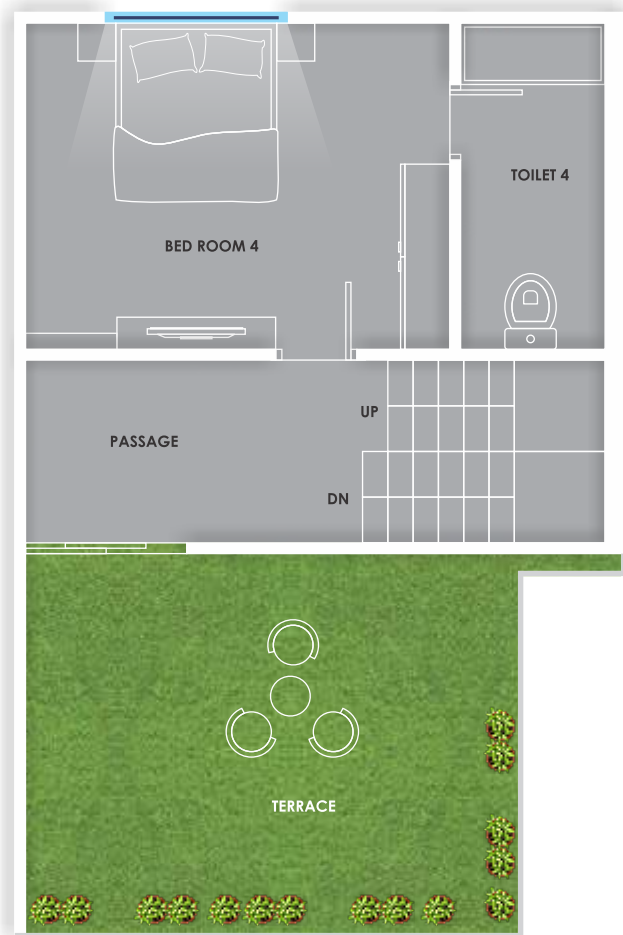

SECOND FLOOR

5
BHK

PLOT AREA
875 Sq. Ft.



FIRST FLOOR

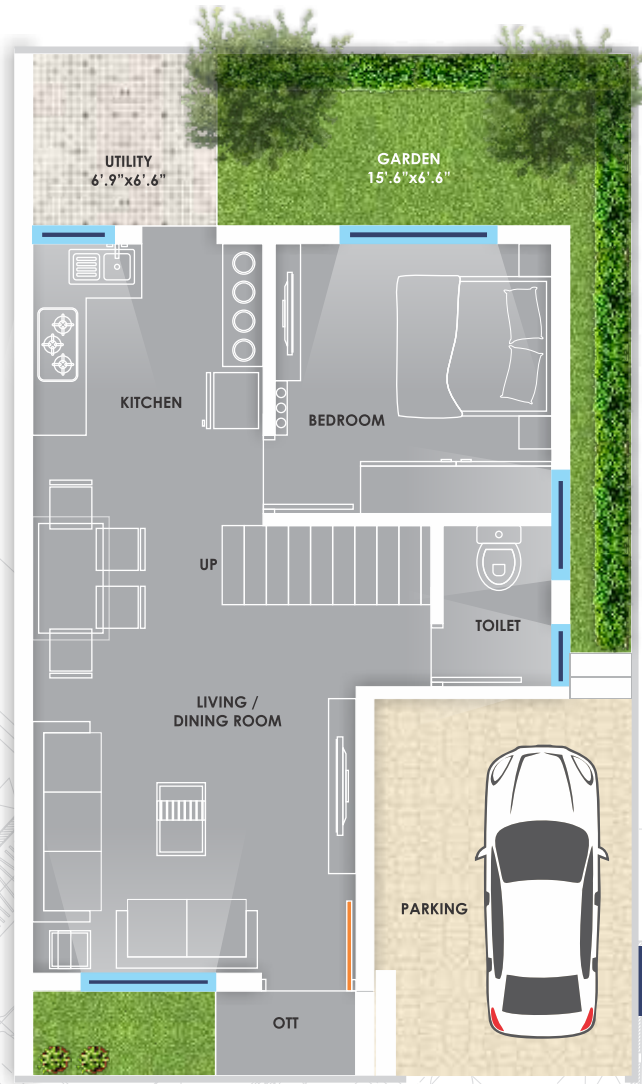

GROUND FLOOR





Clubhouse...

The exquisite clubhouse at Shreenathji Aangan is the perfect escape for you to retreat. Adorned with all the modern functionality and design, you have a space for your entertainment, fun, relaxation and bonding time all under one roof.



Specification...

Without the high prices, high quality work.

-  Structure: Earthquake resistant RCC framed.
-  Walls: "A" class brick masonry.
-  Flooring: 2'x2' vitrified nano tiles flooring in all rooms.
-  Bathroom: Designer tiles up to top level with standard quality C. P. fittings.

-  Kitchen: Granite platform with SS sink and branded wall tiles.
-  Doors: Elegant entrance with Main door veneer & internal flush door with laminate.
-  Window: Powder coated aluminum section windows with mosquito nets.
-  Finishing: Internal smooth plaster with standard quality putty & external double coat plaster with acrylic paint.

View of your home, heaven...





Key Plan...



DISCLAIMER:

Premium quality materials or equivalent branded product shall be used for all construction work. - Right of any changes in dimensions, design & specifications will be reserved with the developer, which shall be binding for all members. - External changes are strictly not allowed. - Development charges, documentation charges, stamp duty, all municipal taxes, service tax, G.E.B. Meter deposit should be levied separate. - Each member needs to pay maintenance deposits separately - In case of booking cancellation, amount will be refunded from the booking of same premise after deducting 10% of booking amount - Possession will be given after one month of all settlement of account. - Extra work at the cost of client with prior estimate needs to be given in advance but no change in elevation and plan will be done. - The developer reserve the full right to make any changes. - This brochure does not form a part of agreement or any legal document, It is easy display of project only.

PAYMENT SCHEDULE :

25% Booking | 40% Plinth level | 10% Slab level | 10% First floor slab level | 10% Plaster level | 05% Finishing

LOAN FACILITIES AVAILABLE BY:

