

KEY PLAN



Developers: **Silverline Buildcon**
 Site: Sevasi TP-3, Bh., Colabera,
 B/s. Prince & Princes Villa,
 Gotri - Sevasi Road, Vadodra,
 Call: **+91 81400 69069**

Email:
 buildsilverline@gmail.com



Architect:
 Ruchir Sheth
 (Design Studio)
 architects & interiors

Structure:
CHETAN CHEMBAR

॥ तोरण ॥
 RESIDENCY



PAYMENT (SHOPS)

10% Booking | 20% After Sale Agriment | 15% Plinth Level | 25% RCC work | 5% Masonry | 10% Plaster Level
 10% Flooring Level | 5% Finishing Level

PAYMENT (Flats)

05% Booking Amount | 35% within fifteen days of banakhat | 5% After completion of Plinth | 10% on 2nd Slab | 10% 5th Slab | 5% on 7th Slab | 5% on Brick & Internal plaster completion | 5% on completion of Sanitary, Lift & Stairs | 5% On outside plumbing & plaster | 10% Lift, Waterpump & Electric Fittings
 5% On possession

PLEASE NOTE : Premium quality materials or equivalent branded products shall be used for all construction work. - Right of any changes in dimensions, design & specifications will be reserved with the developer, which shall be binding for all members. - External changes are strictly not allowed. - Development charges, documentation charges, stamp duty, all municipal taxes, GST tax, G.E.B. meter deposit should be levied separate. - Each member needs to pay maintenance deposits separately. - In case of booking cancellation, amount will be refunded from the booking of same premise after deducting 10% of booking amount. - Possession will be given after one month of all settlement of account. - Extra work at the cost of client with prior estimate needs to be given in advance but no change in elevation and plan will be done. - The developer reserve the full right to make any changes. - This brochure does not form a part of agreement or any legal document, It is easy display of project only.

DISCLAIMER : the details , facts , specifications , figures mentioned in brochure are indicative for information purpose only and subject to modifications / compliance required as per RERA act.

Above project is registered under Gujrera.

For further details: visit: www.gujrera.gujarat.gov.in under registered project. RERA REGISTRATION NO.:





TOWER-A,B BASEMENT FLOOR PLAN

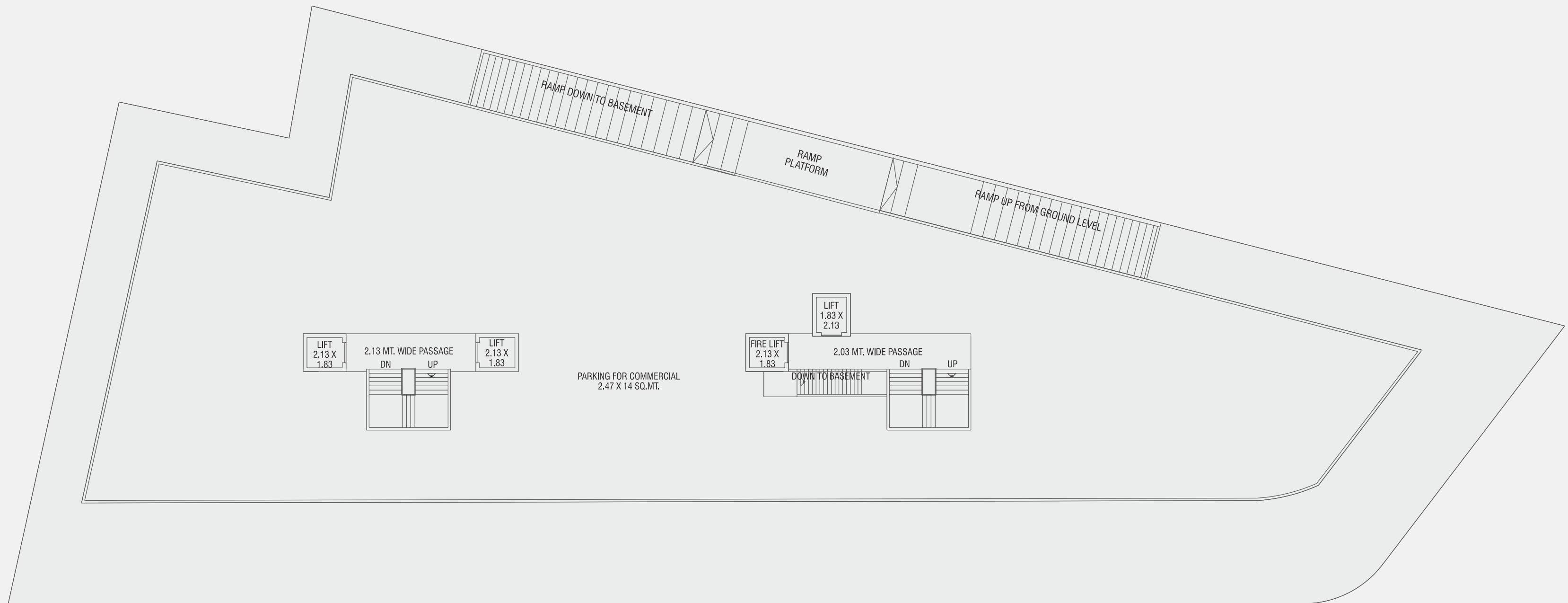



LAYOUT PLAN GROUND FLOOR

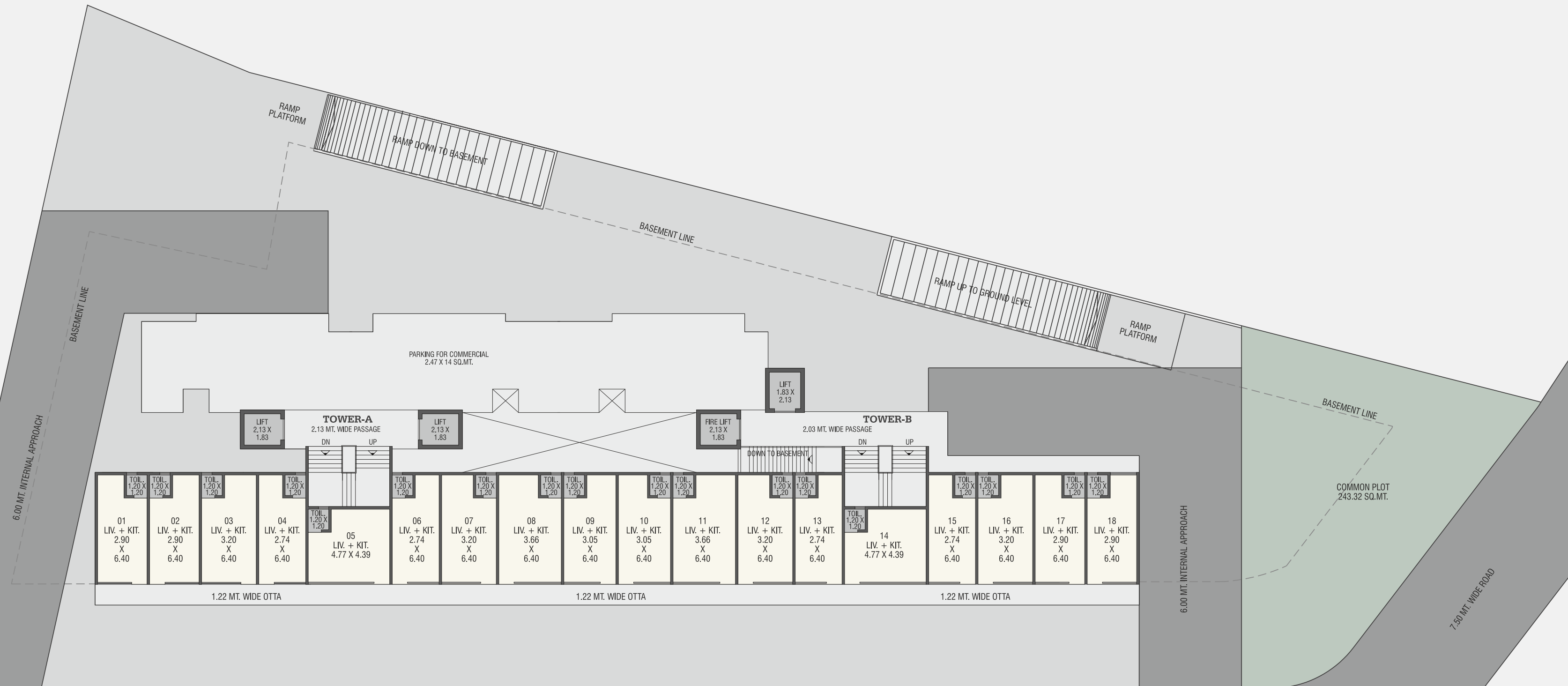

Room No.	Room Type	Area (sq.m)	Dimensions (m)
01	LIV. + KIT.	2.90	1.20 X 1.20
02	LIV. + KIT.	2.90	1.20 X 1.20
03	LIV. + KIT.	3.20	1.20 X 1.20
04	LIV. + KIT.	2.74	1.20 X 1.20
05	LIV. + KIT.	4.77 X 4.39	1.20 X 1.20
06	LIV. + KIT.	2.74	1.20 X 1.20
07	LIV. + KIT.	3.20	1.20 X 1.20
08	LIV. + KIT.	3.66	1.20 X 1.20
09	LIV. + KIT.	3.05	1.20 X 1.20
10	LIV. + KIT.	3.05	1.20 X 1.20
11	LIV. + KIT.	3.66	1.20 X 1.20
12	LIV. + KIT.	3.20	1.20 X 1.20
13	LIV. + KIT.	2.74	1.20 X 1.20
14	LIV. + KIT.	4.77 X 4.39	1.20 X 1.20
15	LIV. + KIT.	2.74	1.20 X 1.20
16	LIV. + KIT.	3.20	1.20 X 1.20
17	LIV. + KIT.	2.90	1.20 X 1.20
18	LIV. + KIT.	2.90	1.20 X 1.20

18.00 MT. WIDE ROAD

7.50 MT. WIDE ROAD

TOWER-A,B GROUND FLOOR PLAN

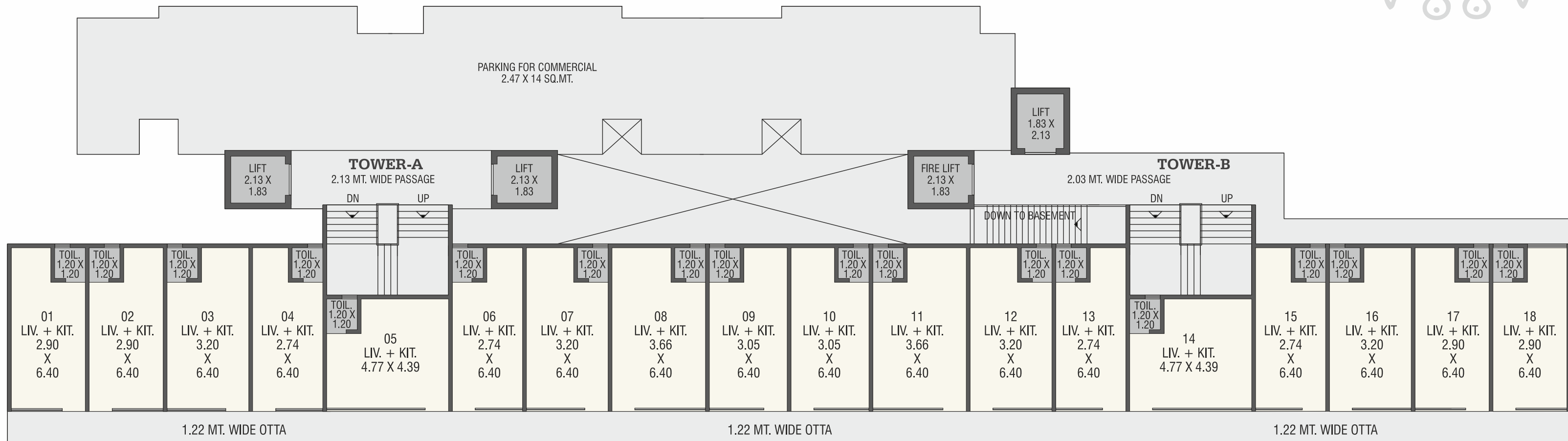
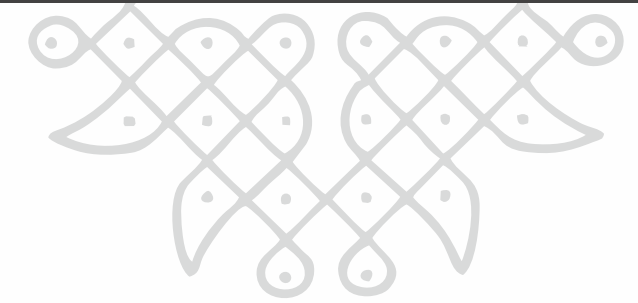

TOWER-A,B FIRST FLOOR PLAN



TOWER-A,B TYPICAL FLOOR PLAN (2nd To 10th)

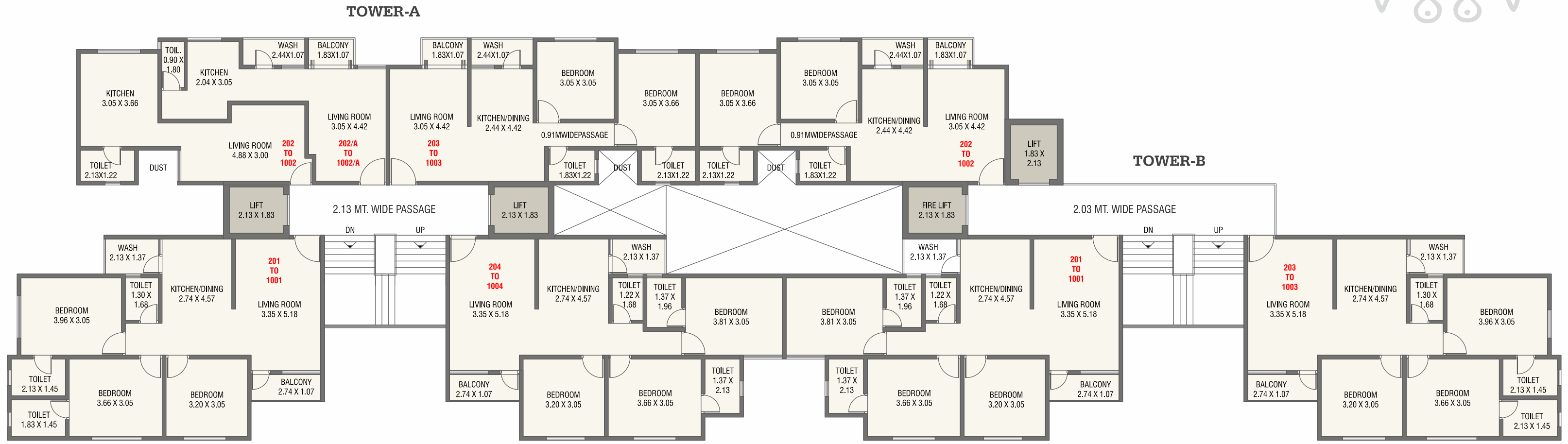
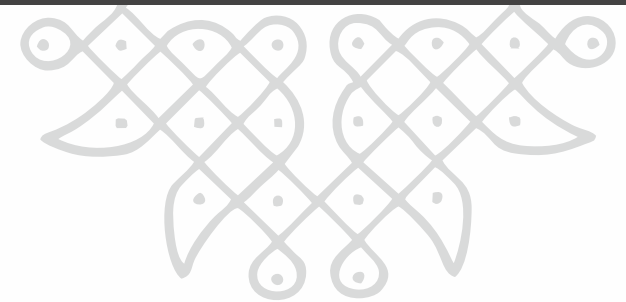



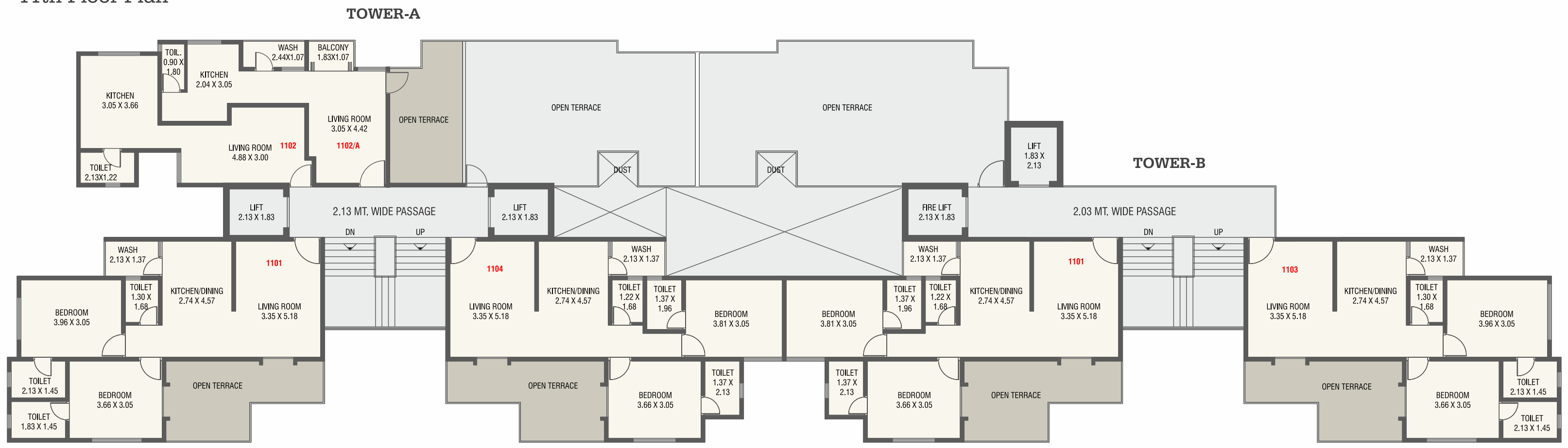





TOWER-A,B 11th Floor Plan























Leisure Amenities

-  Swimming Pool.
-  Gymnasium.
-  Indoor Games Zone.
-  Multipurpose Hall.
-  Children Play Area.
-  Cctv Surveillance.
-  Senior Citizen Sitting.
-  Lush Green Garden.
-  Designer Entrance Gate.

Value Addition

-  High quality elevator for each tower.
-  Car parking.
-  24 hour water supply.
-  Anti termite treatment in ground level.
-  Fire safety system for each tower.
-  Trimix internal roads with street light, decorative paving and
-  architectural plantation.
-  Common underground water tank & Separate overhead tank for each tower with sensor.
-  Brickbat water proofing on terrace and bath areas.
-  Decorative name plates.
-  Letter box for each flat.

Specification

-  **Structure:**
Earthquake resistant RCC frame structure as per structure design.
-  **Finishing:**
Internal smooth plaster with putty
External plaster with weather resistant paint.
-  **Doors:**
Decorative Main door & Internal flush door with laminate.
-  **Windows:**
Powder coated Aluminium sliding windows.
-  **Kitchen:**
Black Granite platform with SS Sink and Glazed tiles Dedo upto lintel level.
-  **Flooring:**
Vitrified tiles (2' x 2') flooring in all rooms.
-  **Bathroom:**
Glazed tiles upto lintel level with C.P. Fittings and sanitary.
-  **Electrification:**
Concealed copper wire with modular switches MCB for each apartment.