

V I C E N Z A
HIGHDECK-II
4B2HK LIFESTYLE APARTMENTS

DEVELOPER: **VHD REALTY**

SITE: BESIDES VICENZA HIGHDECK,
OPP. C M PATEL FARM, KALALI, VADODARA

TEL: 9313590251 EMAIL: VHD2KALALI@GMAIL.COM

RERA No.:
RERA Website: gujrera.gujarat.gov.in



V I C E N Z A
HIGHDECK-II
4B2HK LIFESTYLE APARTMENTS



BASEMENT FLOOR PLAN

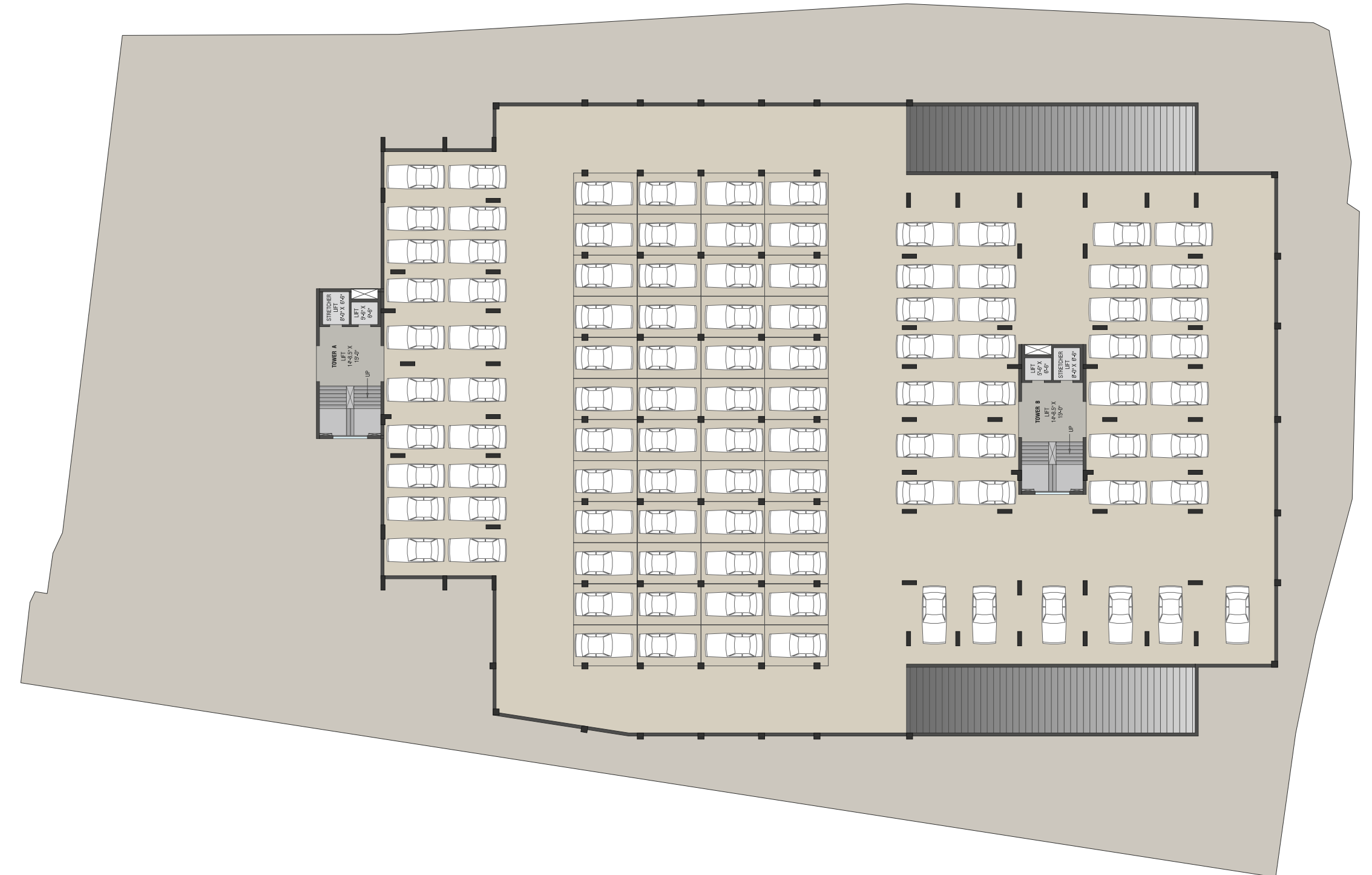

GROUND FLOOR PLAN



- | | | |
|-----------------------------------|----------------------------|------------------------------------|
| 1. CAR PARKING (TOWER-A) | 6. CLUB HOUSE | 11. TWO WHEELER PARKING (TOWER-B) |
| 1A. CAR PARKING (TOWER-A) | -G.F. SWIMMING POOL | 11A. TWO WHEELER PARKING (TOWER-B) |
| 2. TWO WHEELER PARKING (TOWER-A) | -F.F. MULTIPURPOSE HALL | 12. SITTING |
| 2A. TWO WHEELER PARKING (TOWER-A) | 7. DECK | 13. SITTING |
| 3. SITTING AREA | 8. WATER BODY | 14. DECK |
| 4. TODDLER AREA | 9. COMMON PLOT | 15. DECK |
| 5. CHILDREN PLAY AREA | 10. CAR PARKING (TOWER-B) | |
| | 10A. CAR PARKING (TOWER-B) | |

TYPICAL FLOOR PLAN



TYPICAL FLOOR PLAN



11TH FLOOR PLAN



TERRACE FLOOR PLAN



SPECIFICATIONS

STRUCTURE :

Earthquake Resistant R.C.C. frame structure with AAC block Masonry Partitions.

LOBBY & FOYER:

Elegant Rustic Finish Stone Flooring
All Lobby Walls & Ceiling In Paint With False Ceiling

WALL FINISH:

2 Coat Putty with primer finish on internal walls.
Weather Proof paint on external Texture Walls.

FLOORING :

Double charged vitrified tiles in all rooms

STAIRS: STONETREADS

DOORS & WINDOWS:

-Main Door: High Quality Wooden frame door with veneer paneling on both sides.

-Internal Doors: Wooden frames with laminated flush doors.
Powder coated aluminium sliding windows.

ELECTRICAL:

-Concealed copper ISI wiring, MCB/ ELCB & branded modular switches with sufficient electrical points in all area.
-Provision for TV & Internet points at convenient locations.
-Air Conditioning Piping Provision at convenient locations

KITCHEN:

Granite sandwiched platform with S.S. Sink & Swivel Tap
Vitrified Tiles upto lintel height over the platform
Wash Area with Tiles dado & natural stone Flooring

BATHROOMS:

Premium ceramic tiles, Branded quality bath fittings and sanitary wares.
Anti Skid Floor Tiles
Granite/Stone Counter with Ceramic Wash Basin
False Ceiling in all Bath Rooms

AMENITIES

ACTIVITY AREA ON TERRACE FOR LEISURE & CELEBRATION

-Lounge & Gazebo
-Gymnasium & Yoga
-Indoor Game
-Wash Rooms, Pantry Room
-Space For The Leisure & Celebration
-Landscaped Garden With Artificial Lawn

PREMIUM AMENITIES

-Lifestyle Club House- Swimming Pool, Multi Purpose Hall With Projector
-Landscaped Garden On Ground Level
-Children Play Area
-Water Body

-Senior Citizen Sit Out & Gazebo
-Toddlers Area

SALIENT FEATURES

-Two Allotted Car Parking Space
-Adequate Power Load To Each Unit
-Under Counter RO System For Each Apartment
-Power Back Up System For Lift & Common Lighting/water Pumps
-Solar Panel For Energy Saving For Common Electricity
-Inverter Wiring For Each Apartment
-Two Branded Elevator (stretcher+8 Passangers Lift)

SAFETY FEATURES

-Gated Community With Round The Clock Security
-CCTV System With Surveillance Cameras At Strategic Locations In Common Area
-Video Door Phone Security



KEY PLAN

NOTE : • All plans are subject to amendments and approval by the relevant authorities. • All photography and computer imagery are artist's impression and are provided for illustrative and indicative purposes only. • While every reasonable care has been taken in providing this information, the developers cannot be held responsible for any inaccuracy. • Subject to Vadodara Jurisdiction.

