

Kishan
EXOTICA

4 BHK LUXURIOUS FLATS

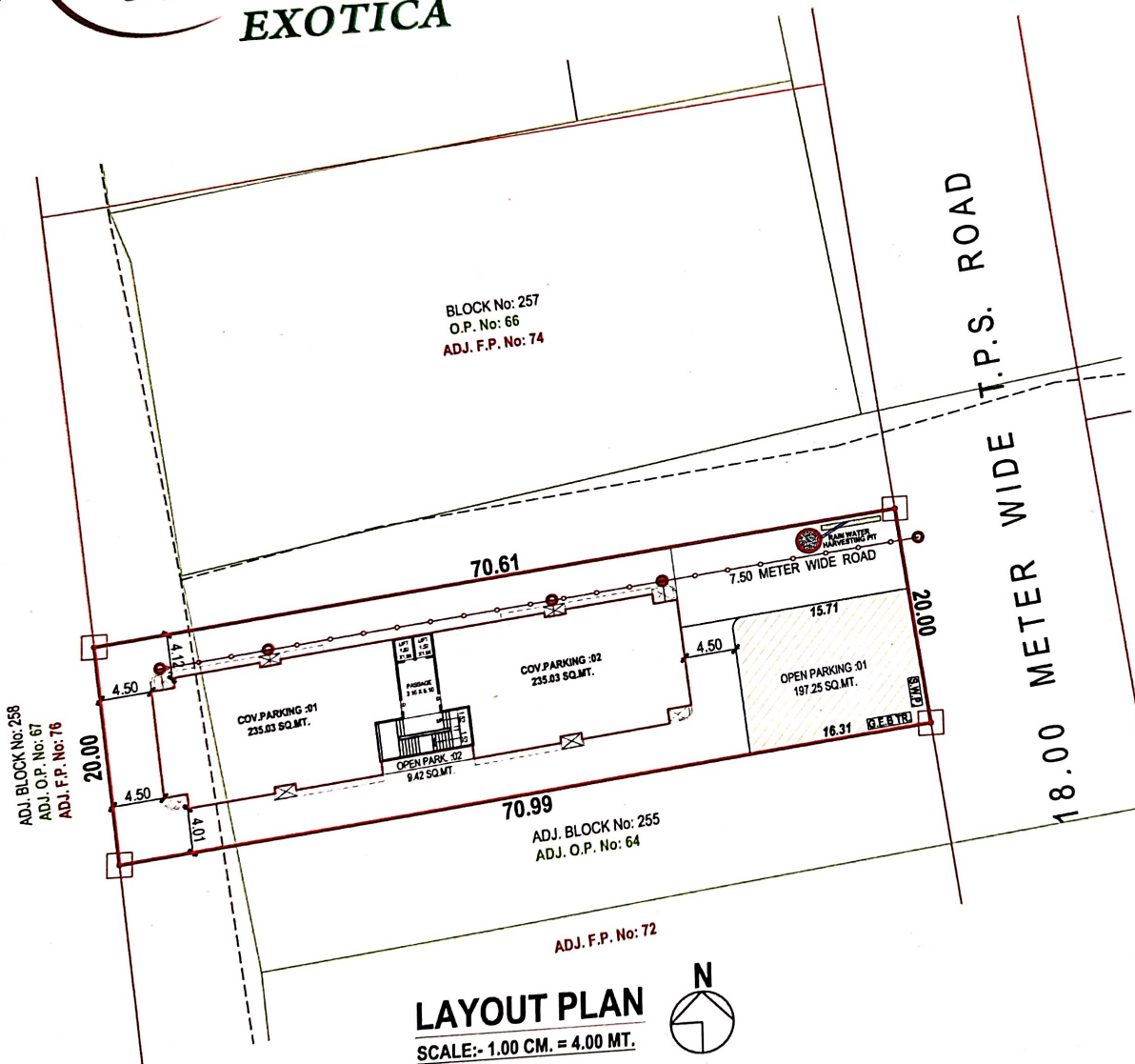

Kishan EXOTICA





Kishan EXOTICA

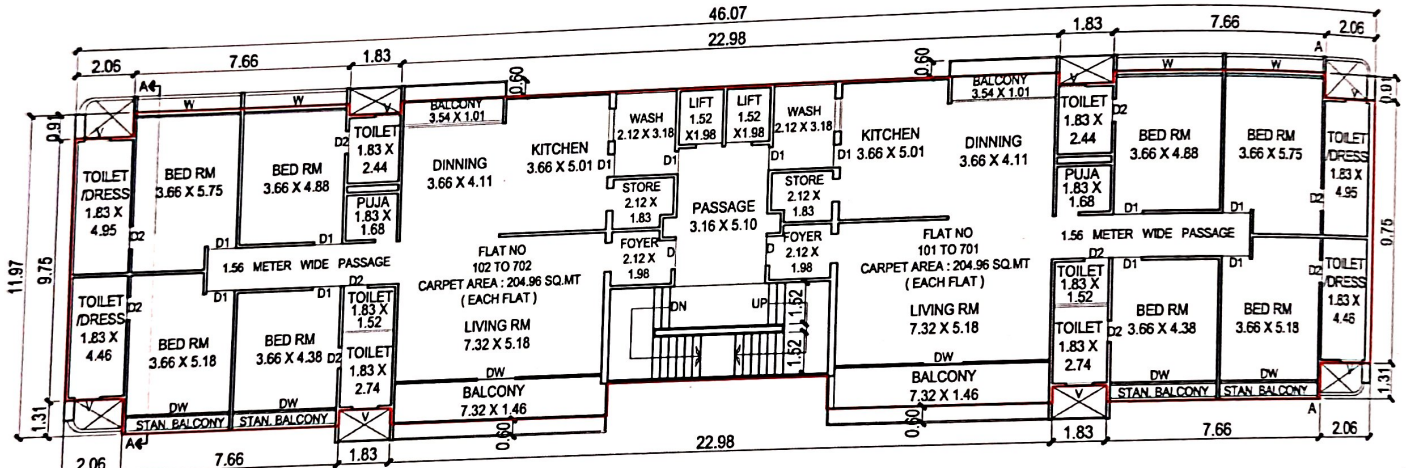

1st TO 7th FLOOR PLAN

BUILT UP AREA : 528.45 SQ.MT. (EACH FLOOR)

DEDU. : STAIR + LIFT = 50.35 SQ.MT.

F.S.I. AREA : 478.10 SQ.MT. (EACH FLOOR) CARPET AREA:203.46 SQ.MT

Kishan EXOTICA

Specifications

Structure :
Well designed Earthquake resistant RCC frame structure using superior quality materials as per structural design.

Finishing :
Internal smooth plaster with Wall Putty & External double coat plaster with weather resistant paint.

Flooring :
Wall to Wall Vitrified tiles flooring.

Doors :
Elegant entrance door & Internal flush door with laminate.

Windows:
Powder Coated/Anodized Aluminum sliding windows with glass & safety grills.

Kitchen:

Granite platform with SS Sink & premium wall tiles dedo upto lintel level.

Bathroom/ Plumbing:

Ceramic Flooring in all bathrooms and wall with Designer tiles upto lintel level with standard quality sanitary fittings & fixtures. Hot & Cold water plumbing with shower in all bathrooms.

Electrification:

Concealed ISI mark copper wiring, AC point in bedroom, Geyser point in bathroom. Good quality modular switches.

Value Added Amenities:

- 24 hours Water Supply
- Solar Power
- Sufficient Parking
- Standard quality Lift
- Security Cabin
- CCTV Camera
- Attractive name plate & letterbox
- Common garden & children play area





Payment Schedule :

Booking - 10% | Plinth Level - 10% | First To Seventh Floor Slab - 10% | Plaster Level - 5% | On Offer of Possession - 5%

Developers:
WINKLE S. DHARSANDIA

Site Address :
Kishan Exotica, B/H Broadway Pride,
Block No. 257, T.P. No.02, F.P. No. 73,
Sevasi, Vadodara.

Contact Detail :
M : +91 99241 18000
Email : sanjaydharsandia@gmail.com

Architect:
SPACE PLUS

Structure:
A. A. DESAI