

2 BHK - 10
Luxurious Flats









1st TO 5th FLOOR



102
202
302
402
502

101
201
301
401
501

M.D.

M.D.

DN

UP

LIFT

25 FEET WIDE ROAD

GROUND FLOOR

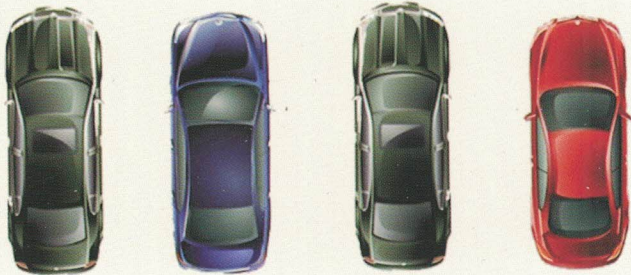
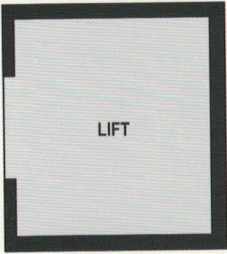
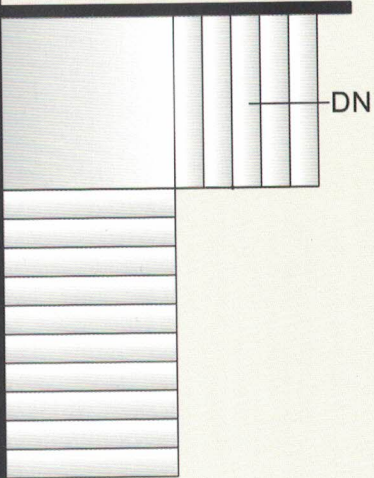
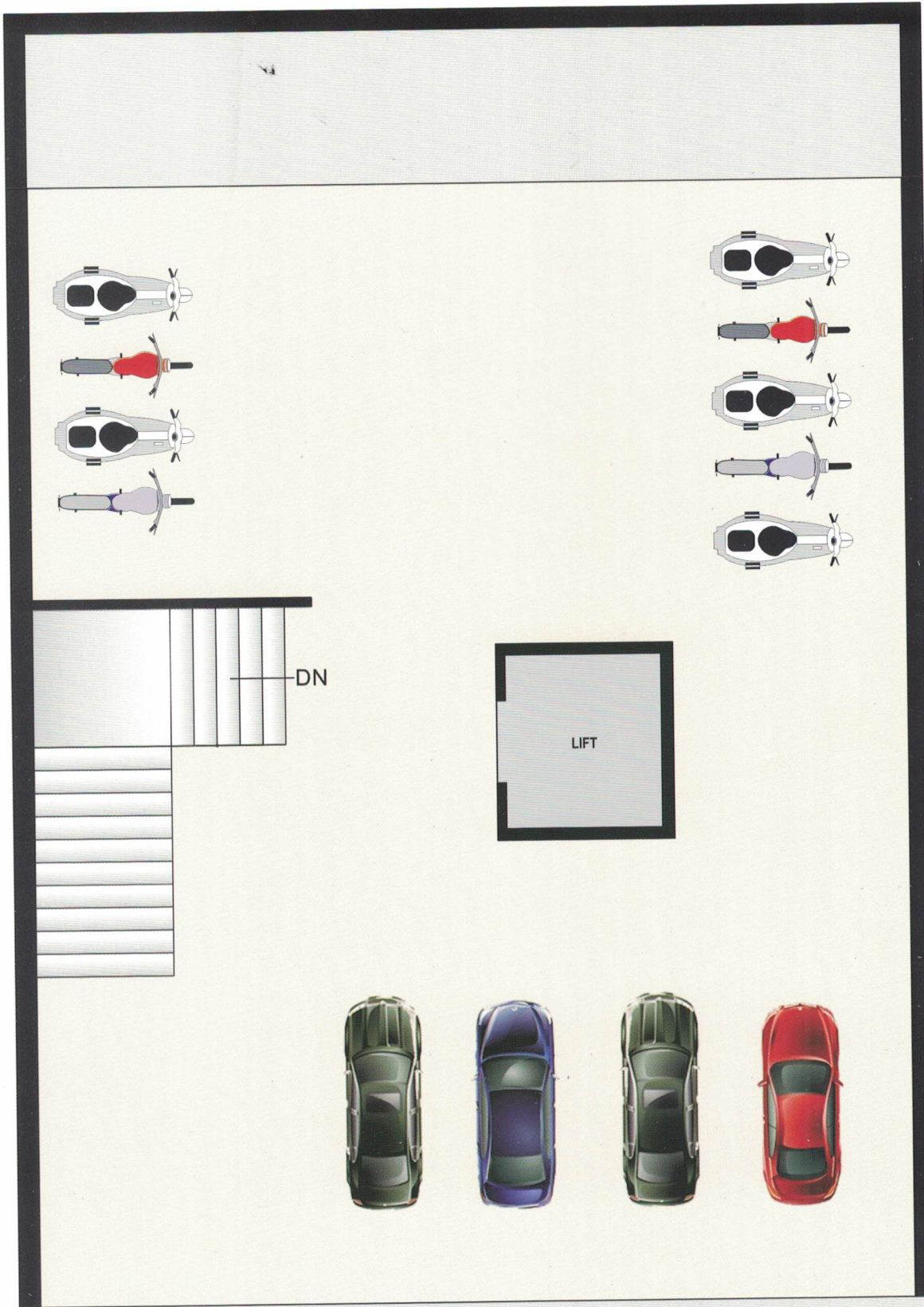

GATE

25 FEET WIDE ROAD



SPECIFICATIONS :

- **Flooring** - Vitrified Tiles of Standard Company
- **Kitchen** - Granite Platform, S.S.Sink - Wall Tiles till slab level
- **Bathrooms / Toilet** - Designer Concept Wall Tiles till slab level
- **Doors & Windows** - Decorative laminated main door and Flush door, Powder Cotting Aluminum Section Sliding windows
- **Colour** - External Attractive Paint and internal with wall putty
- **Lift** - Lift of Standard Company
- **Water Storage** - underground and over hade water tank
- **Plumbing** - Concealed Plumbing fitting of Standard Company
- **Electrification** - Modular Switch of Standard Company
- **Solar** - Standard Company
- CCTV Camera, Security Room

FEATURES :

- Attractive elivation
- Earthquake resistant, RCC frame structure building.
- Fully Parking space



NOTES:

- Stamp Duty, Registration charges, Legal charges, Serves tax, VAT, GEB, RMC charges & Ele. Co. Charges including cable & sub-station cost etc. Shall be borne by the purchaser.
- Any additional charges or duties levied by the Government / Local authorities during or after the completion of the project will be borne by the purchaser.
- In the interest of continual developments in design & quality of construction, the Developer reserve all rights to make any changes in the project including technical specifications, designs, planning, layout and all purchasers shall abide by such changes.
- The brochure is intended only for easy display and information of the project and dose not form part of legal document.



◆ Booking Contact : ◆

Sagar Patel
Mo. 96875 47741

Abhishek Mehta
Mo. 94283 48182

Architect :
Jatin Parmar - 9426764778

Engineer :
Abhishek Mehta - 94283 48182