

# KEY PLAN

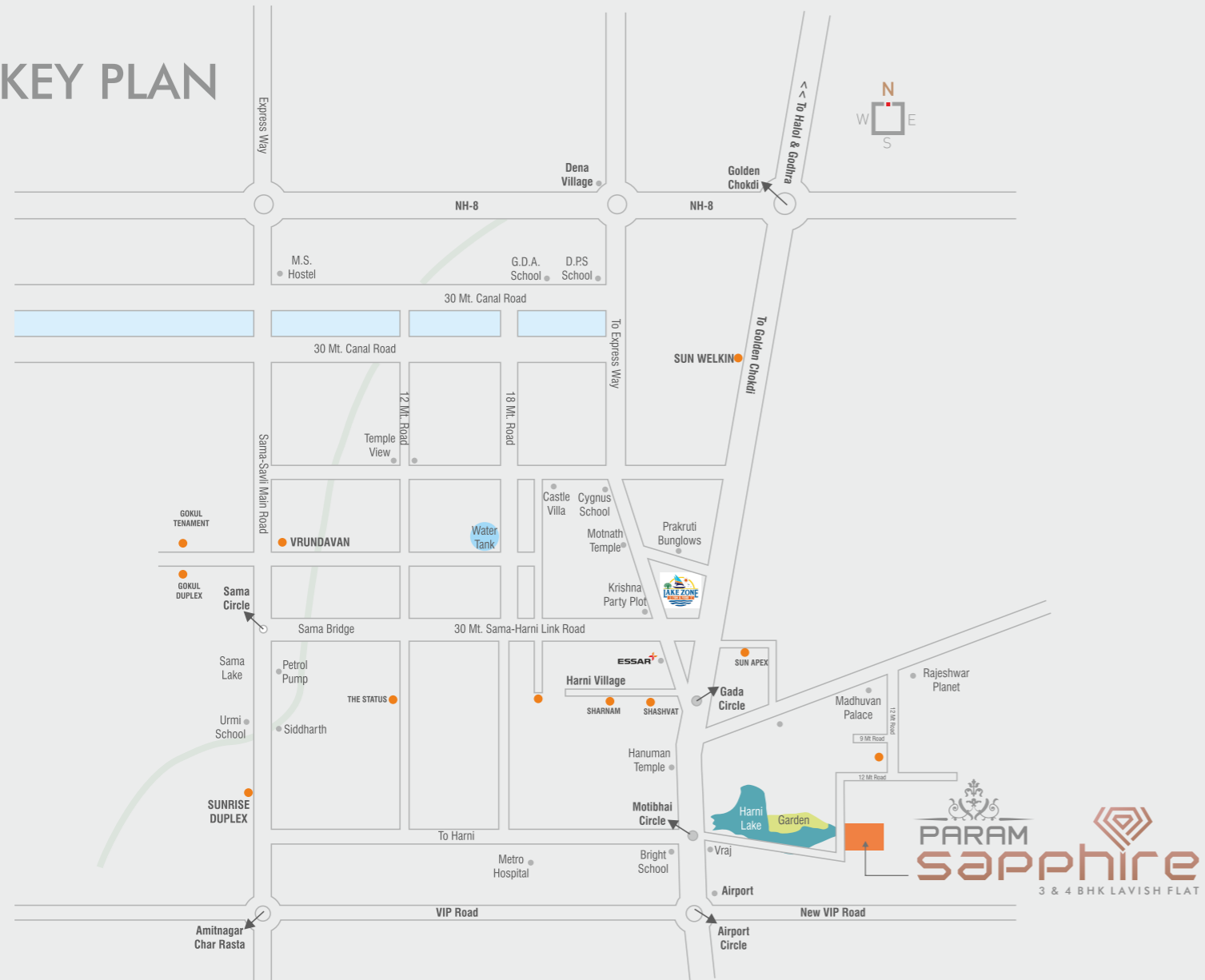

# PARAM SAPHIRE

3 & 4 BHK LAVISH FLAT

Developers :  
**Atharva Creation**

Site Address: **"PARAM SAPHIRE"**,  
Near Harni Lake Garden, Harni,  
Vadodra.

Call: **89051 55633**  
**97254 22976**  
Email: [paramsapphire2023@gmail.com](mailto:paramsapphire2023@gmail.com)

Architect:



Structure:

**ASHOK SHAH**  
& ASSOCIATES

Above project is registered under Gujrera.Rera Reg. No.: PR/GJ/VADODARA/VADODARA/Others/  
For further details visit: [www.gujrera.gujarat.gov.in](http://www.gujrera.gujarat.gov.in) under registered project. /







# TOWER-A,B LAYOUT FLOOR PLAN

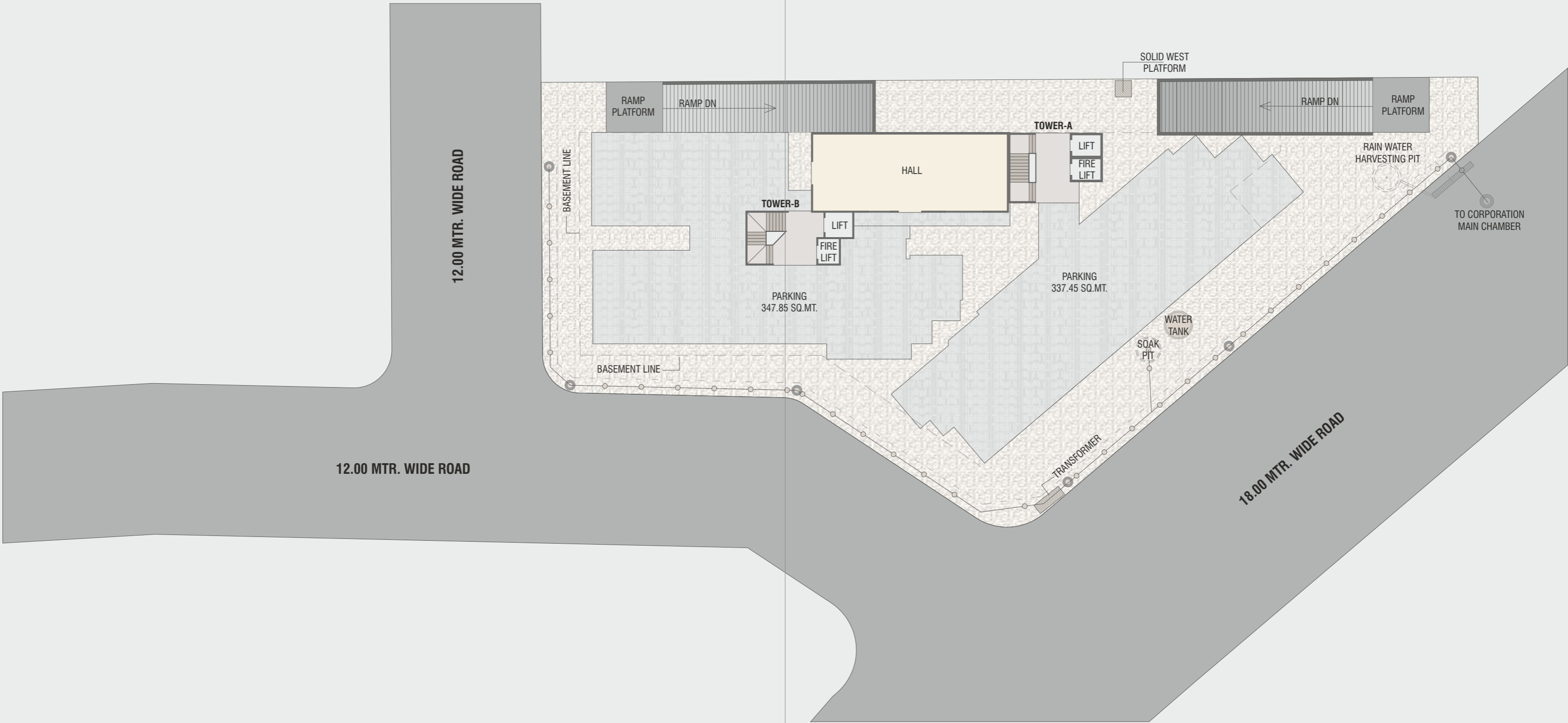

# TOWER-A,B

## BASEMENT FLOOR PLAN

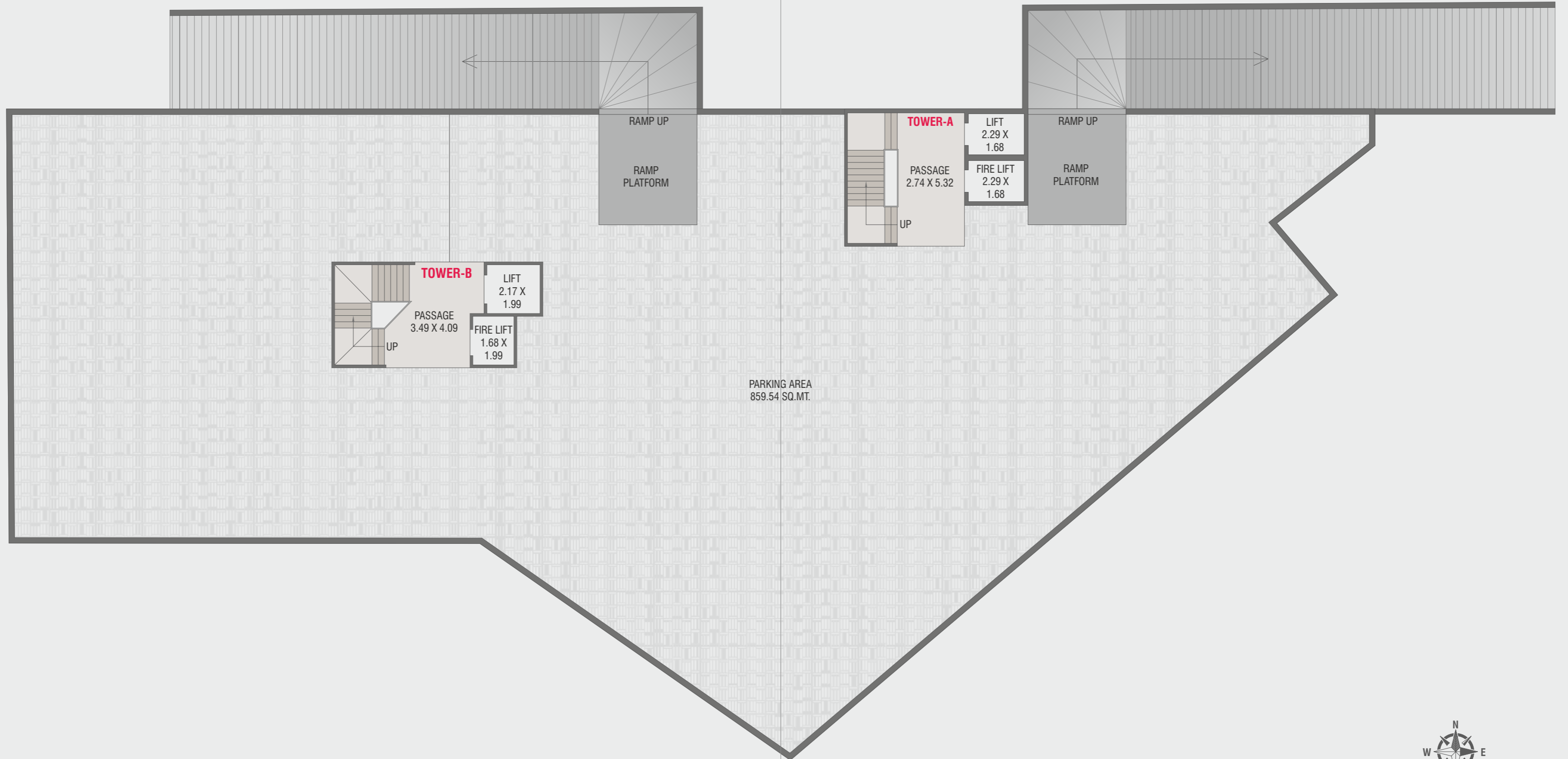

# TOWER-A,B

## GROUND FLOOR PLAN

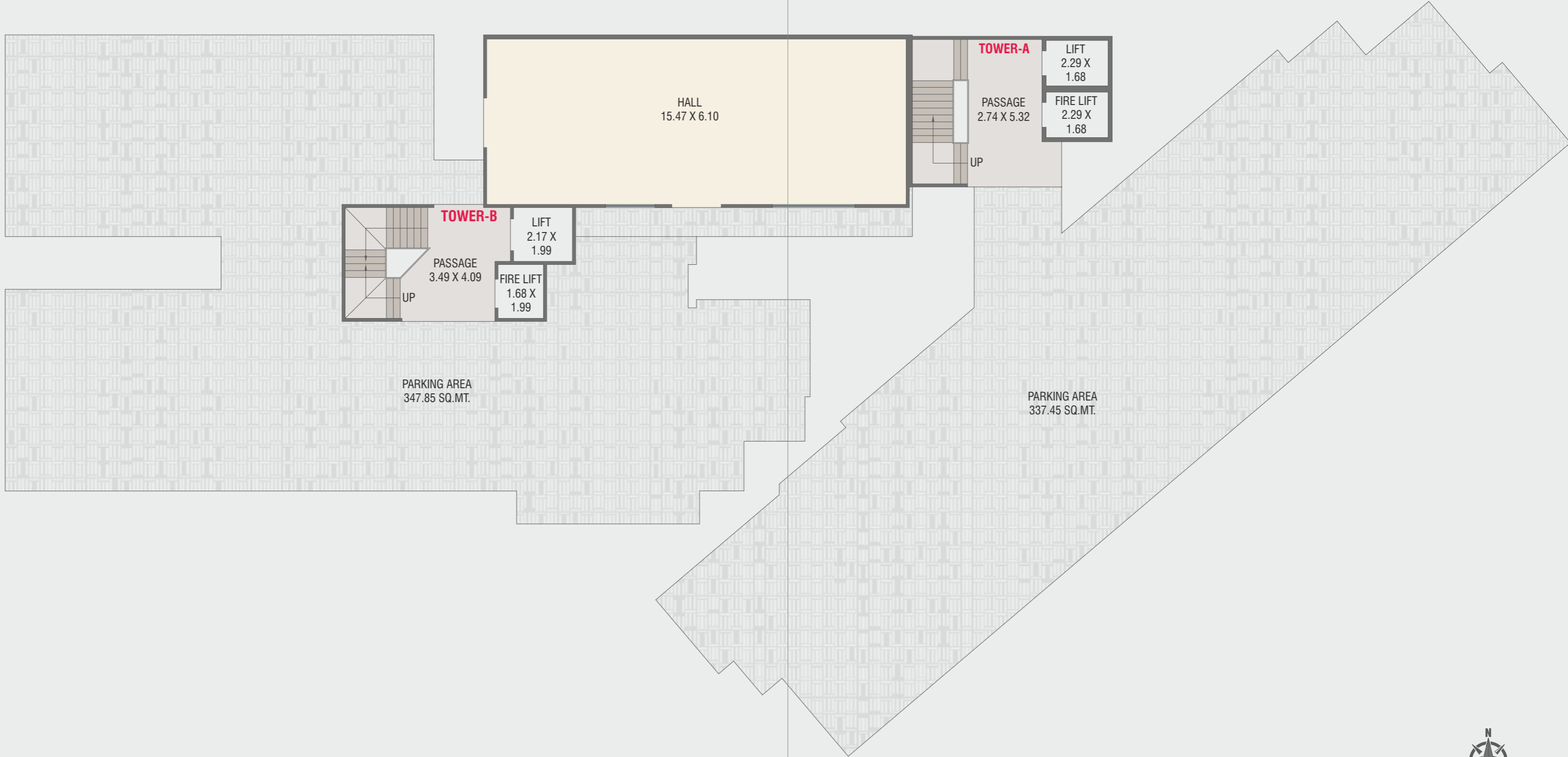

# TOWER-A,B

## TYPICAL FLOOR PLAN (1st TO 6th)

### TOWER-B





# TOWER-A,B

## TERRACE FLOOR PLAN



## SPECIFICATION

### Structure :

Earthquake R.C.C. frame structure as per structure design

### Wall Finish :

Inside walls having smooth plaster with emulsion paints and outside surface acrylic painted

### Flooring :

Vitrified flooring in all rooms

### Doors :

Decorative main door with safety lock and other are flush doors with safety lock

### Windows :

Powder coated aluminum windows with glass and safety grills

### Kitchen :

Granite sandwich platform with S.S sink,  
Glazed tiles dedo upto slab level

### Toilets :

Designer bathrooms tiles with branded fitting

### Plumbing :

Concealed plumbing with good quality fittings

### Water :

Underground & Overhead tank for 24 hours water supply from VMC connection with auto control mechanism.

Boring facility for 24 hour water supply.

### Electrification :

Concealed copper ISI wiring & branded modular switches with sufficient point.

A.C. point in Living Room & all Bedroom.

### Terrace :

Water proofing treatment with china mosaic tiles flooring

## AMENITIES

- \* Elegant Entrance Gate with Security Cabin and C.C.T.V
- \* R.O. system for Each Flat
- \* Multipurpose Hall
- \* Alloted Parking for residents
- \* Power back-up for Lift, Passage & Parking Area
- \* Entry Campus with
- \* Aluminum powder coated window with mosquito net