

Developers

SHYAM BUILDCON

Ahmedabad

📍 Behind Sthapatya Elegance, Besides UGVCL Power Station,
Opp. Gajanand Villa, Naroda-Dahegam Road,
Hanspura, Ahmedabad-382330.



🌐 www.shreeradhekrishna.com
✉ radhekrishnaroyal@gmail.com
23.082960,72.672309

📞 +91 6262 00 9999

श्री
Radhe Krishna
ROYAL

2 & 3 BHK PREMIUM APARTMENTS



Basement Parking



MODERN
ENTRANCE GATE



SECURITY
CABIN



SCHOOL BUS
PICK-UP STAND



C.C.T.V.
CAMERA



LANDSCAPE
GARDEN



SENIOR CITIZEN
SIT-OUT



DOUBLE
ELEVATOR



FIRE SAFETY



CHILDREN
PLAY AREA



24 HOUR WATER
SUPPLY



GENERATOR
POWER BACK-UP



RCC ROAD
LED STREET LIGHT

A life full of
luxury awaits you

SHREE RADHE KRISHNA ROYAL





"We are shifting to
our own heaven of

HAPPENING LIVING.

Next..

When you get back home to Shree Radhekrishna Royal you will sit back and enjoy the most happening lifestyle around you.

When you get back home to Shree Radhekrishna you will sit back and enjoy the most happening lifestyle around Speaking about world-class, the visible build quality is matched by every little detail and everything that has gone into Shree Radhekrishna



**BEAUTIFULLY DESIGNED RESIDENCES.
ADORNED BY STUNNING VIEWS.**

Shree Radhe Krishna Royal is a glorious architectural creation that is striking to behold and truly delightful to inhabit. These wonderful abodes indeed inspire a fine living.

**Radhe Krishna**
ROYAL



**BASEMENT
LAY OUT PLAN**

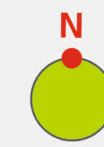

**GROUND FLOOR
LAY OUT PLAN**



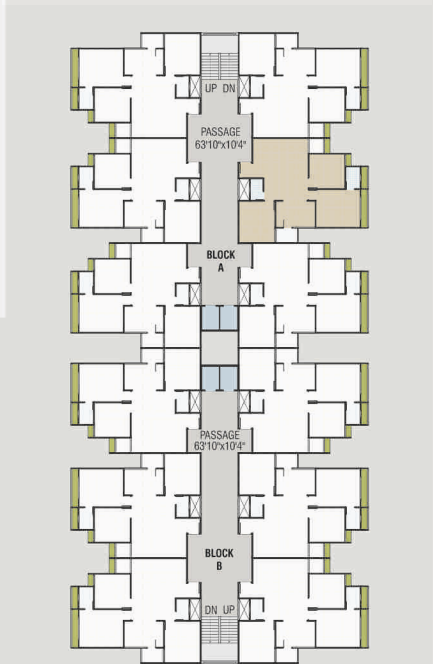

Radhe Krishna
ROYAL

BLOCK - A & B

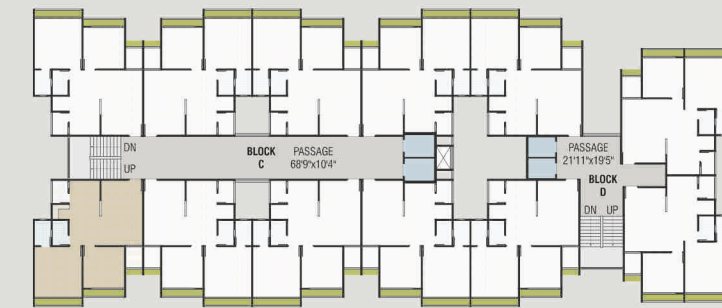

Radhe Krishna
ROYAL

BLOCK - C & D



FLOORING
Vitrified tiles for entire flooring in all apartments.



WALL FINISH / ELEVATION
Internal mala plaster with white finish putty.
Attractive external elevation with double coat sand faced plaster with 100% acrylic paints.



DOORS & WINDOWS
Decorative main door & other flush doors with wooden frame.
All windows in aluminum section.



KITCHEN
Mirror polished granite platform with S.S. sink, designer glazed tiles up to lintel level.



ELECTRIFICATION
Branded ISI modular switches with concealed copper wiring and adequate number of points.
MCB distribution panel.



PLUMBING
ISI UPVC pipes for water supply, PVC & SWR pipes for solid waste and drainage systems.
Percolation recharge wells as per the norms.



TOILET
Designer tiles on floor and walls up to lintel level.
Branded sanitary & bath fittings.



TERRACE
China mosaic for heat reflection and thermal insulation.

NOTES:

- This brochure is not as legal part of document but only for easy understanding to customer
- Irregular payment cause for cancellation of the booking
- All rights are reserved by developers to make any changes in plan, scheme elevation, dimension and other details there in to comply with statutory regulation shall be binding to all the members
- Subject to Ahmedabad Jurisdiction
- Payments in favour of "SHYAM INFRACON."



Radhe Krishna ROYAL

Behind Sthapatya Elegance, Besides UGVCL Power Station,
Opp. Gajanand Villa, Naroda-Dahegam Road,
Hanspura, Ahmedabad-382330.



Architect :
SHAPERS360°
ARCHITECTS & CONSULTANTS

Structural :
सक्षम
STRUCTURAL ENGINEERS &
PROJECT MANAGEMENT CONSULTANTS