

STRUCTURE :
RCC Frame Structure With Seismic Zone III Compliance.

FLOORING :
A Unique Designed Premium Quality Vitrified Tiles (drawing & living room 36 x 36 all other rooms 24 x 24)

KITCHEN/STORE :
Exclusive Granite/composite Marble Platform With Design Tiles Dedo-up To Lintel Level Mini Modular Kitchen Washing Machine Inlet /outlet In Wash Area. Provision For Gas Pipeline

TOILET / PLUMBING :
Western concept designed toilet, concealed plumbing with premium quality cp fitting jaquar. / Ess equivalent cera / equivalent brand sanitary ware

DOOR :
Decorative Main Door With Both Side Veneer. & internal all door Flush Door With Wooden Frame.

WINDOWS :
Fully Glazed Anodized Aluminum Windows With Stone Jamb.

ELECTRIFICATION :
Concealed Copper Wiring With Adequate Number Of Points In All Rooms
Concealed Electrification With Premium Quality Copper Wire / Cable Premium Branded Modular Switches And Accessories.
Distribution Board With MCB & ELCB
Provision For Split A/C point in all bedroom.
Three Phase Electrical Line.

WALL/PAINT :
internal finish single coat mala plaster with wall putty & external sand faced plaster with premium quality acrylic paint.

ELEVATORS :
Premium Quality High Speed Elegant With automatic door.

TERMITE TREATMENT :
Anti-Termite Treatment Shall Be Applied By Standard Materials To Completed Area.

TERRACE :
Required Water Proofing On Terrace.

SPECIFICATION :



LOCATION MAP
shubh aashish
opp.shefali center, paldi cross road,
paldi, ahmedabad.

RE DEVELOPMENT PROJECT
NEW AASHISH CO.OP. HOUSING SOCIETY LTD.

booking contact :
m. +91 7405 33 1919
e : info.shubhratna@gmail.com

DEVELOPER :
SHUBH RATNA
DEVELOPERS PVT.LTD

DESIGNER :
vaishakhee shukla
vaibhav consultants

LANDSCAPE DESIGNER :
lokendra balasaria
la spazio | 079-400 38 30

STR. CONSULTANT :
SETU

Specific Note:
1) Government and third parties if the project is subject to all necessary approvals from relevant govt. authorities, agencies or related authorities or any other external factors beyond developer's control. 2) The developer shall own the structure and appurtenances. 3) The developer reserves the right to change, modify or make any modifications, addition, omission or alteration in the address on a whole or part thereof, at their sole discretion. 4) The structure is subject to structural & ground conditions subject to soil investigation or if any, on site. 5) The structure is subject to structural & ground conditions subject to soil investigation or if any, on site. 6) The structure is subject to structural & ground conditions subject to soil investigation or if any, on site. 7) The structure is subject to structural & ground conditions subject to soil investigation or if any, on site. 8) The structure is subject to structural & ground conditions subject to soil investigation or if any, on site. 9) The structure is subject to structural & ground conditions subject to soil investigation or if any, on site. 10) The structure is subject to structural & ground conditions subject to soil investigation or if any, on site. 11) The structure is subject to structural & ground conditions subject to soil investigation or if any, on site. 12) The structure is subject to structural & ground conditions subject to soil investigation or if any, on site. 13) The structure is subject to structural & ground conditions subject to soil investigation or if any, on site. 14) The structure is subject to structural & ground conditions subject to soil investigation or if any, on site. 15) The structure is subject to structural & ground conditions subject to soil investigation or if any, on site. 16) The structure is subject to structural & ground conditions subject to soil investigation or if any, on site. 17) The structure is subject to structural & ground conditions subject to soil investigation or if any, on site. 18) The structure is subject to structural & ground conditions subject to soil investigation or if any, on site. 19) The structure is subject to structural & ground conditions subject to soil investigation or if any, on site. 20) The structure is subject to structural & ground conditions subject to soil investigation or if any, on site. 21) The structure is subject to structural & ground conditions subject to soil investigation or if any, on site. 22) The structure is subject to structural & ground conditions subject to soil investigation or if any, on site. 23) The structure is subject to structural & ground conditions subject to soil investigation or if any, on site. 24) The structure is subject to structural & ground conditions subject to soil investigation or if any, on site. 25) The structure is subject to structural & ground conditions subject to soil investigation or if any, on site. 26) The structure is subject to structural & ground conditions subject to soil investigation or if any, on site. 27) The structure is subject to structural & ground conditions subject to soil investigation or if any, on site. 28) The structure is subject to structural & ground conditions subject to soil investigation or if any, on site. 29) The structure is subject to structural & ground conditions subject to soil investigation or if any, on site. 30) The structure is subject to structural & ground conditions subject to soil investigation or if any, on site. 31) The structure is subject to structural & ground conditions subject to soil investigation or if any, on site. 32) The structure is subject to structural & ground conditions subject to soil investigation or if any, on site. 33) The structure is subject to structural & ground conditions subject to soil investigation or if any, on site. 34) The structure is subject to structural & ground conditions subject to soil investigation or if any, on site. 35) The structure is subject to structural & ground conditions subject to soil investigation or if any, on site. 36) The structure is subject to structural & ground conditions subject to soil investigation or if any, on site. 37) The structure is subject to structural & ground conditions subject to soil investigation or if any, on site. 38) The structure is subject to structural & ground conditions subject to soil investigation or if any, on site. 39) The structure is subject to structural & ground conditions subject to soil investigation or if any, on site. 40) The structure is subject to structural & ground conditions subject to soil investigation or if any, on site. 41) The structure is subject to structural & ground conditions subject to soil investigation or if any, on site. 42) The structure is subject to structural & ground conditions subject to soil investigation or if any, on site. 43) The structure is subject to structural & ground conditions subject to soil investigation or if any, on site. 44) The structure is subject to structural & ground conditions subject to soil investigation or if any, on site. 45) The structure is subject to structural & ground conditions subject to soil investigation or if any, on site. 46) The structure is subject to structural & ground conditions subject to soil investigation or if any, on site. 47) The structure is subject to structural & ground conditions subject to soil investigation or if any, on site. 48) The structure is subject to structural & ground conditions subject to soil investigation or if any, on site. 49) The structure is subject to structural & ground conditions subject to soil investigation or if any, on site. 50) The structure is subject to structural & ground conditions subject to soil investigation or if any, on site. 51) The structure is subject to structural & ground conditions subject to soil investigation or if any, on site. 52) The structure is subject to structural & ground conditions subject to soil investigation or if any, on site. 53) The structure is subject to structural & ground conditions subject to soil investigation or if any, on site. 54) The structure is subject to structural & ground conditions subject to soil investigation or if any, on site. 55) The structure is subject to structural & ground conditions subject to soil investigation or if any, on site. 56) The structure is subject to structural & ground conditions subject to soil investigation or if any, on site. 57) The structure is subject to structural & ground conditions subject to soil investigation or if any, on site. 58) The structure is subject to structural & ground conditions subject to soil investigation or if any, on site. 59) The structure is subject to structural & ground conditions subject to soil investigation or if any, on site. 60) The structure is subject to structural & ground conditions subject to soil investigation or if any, on site. 61) The structure is subject to structural & ground conditions subject to soil investigation or if any, on site. 62) The structure is subject to structural & ground conditions subject to soil investigation or if any, on site. 63) The structure is subject to structural & ground conditions subject to soil investigation or if any, on site. 64) The structure is subject to structural & ground conditions subject to soil investigation or if any, on site. 65) The structure is subject to structural & ground conditions subject to soil investigation or if any, on site. 66) The structure is subject to structural & ground conditions subject to soil investigation or if any, on site. 67) The structure is subject to structural & ground conditions subject to soil investigation or if any, on site. 68) The structure is subject to structural & ground conditions subject to soil investigation or if any, on site. 69) The structure is subject to structural & ground conditions subject to soil investigation or if any, on site. 70) The structure is subject to structural & ground conditions subject to soil investigation or if any, on site. 71) The structure is subject to structural & ground conditions subject to soil investigation or if any, on site. 72) The structure is subject to structural & ground conditions subject to soil investigation or if any, on site. 73) The structure is subject to structural & ground conditions subject to soil investigation or if any, on site. 74) The structure is subject to structural & ground conditions subject to soil investigation or if any, on site. 75) The structure is subject to structural & ground conditions subject to soil investigation or if any, on site. 76) The structure is subject to structural & ground conditions subject to soil investigation or if any, on site. 77) The structure is subject to structural & ground conditions subject to soil investigation or if any, on site. 78) The structure is subject to structural & ground conditions subject to soil investigation or if any, on site. 79) The structure is subject to structural & ground conditions subject to soil investigation or if any, on site. 80) The structure is subject to structural & ground conditions subject to soil investigation or if any, on site. 81) The structure is subject to structural & ground conditions subject to soil investigation or if any, on site. 82) The structure is subject to structural & ground conditions subject to soil investigation or if any, on site. 83) The structure is subject to structural & ground conditions subject to soil investigation or if any, on site. 84) The structure is subject to structural & ground conditions subject to soil investigation or if any, on site. 85) The structure is subject to structural & ground conditions subject to soil investigation or if any, on site. 86) The structure is subject to structural & ground conditions subject to soil investigation or if any, on site. 87) The structure is subject to structural & ground conditions subject to soil investigation or if any, on site. 88) The structure is subject to structural & ground conditions subject to soil investigation or if any, on site. 89) The structure is subject to structural & ground conditions subject to soil investigation or if any, on site. 90) The structure is subject to structural & ground conditions subject to soil investigation or if any, on site. 91) The structure is subject to structural & ground conditions subject to soil investigation or if any, on site. 92) The structure is subject to structural & ground conditions subject to soil investigation or if any, on site. 93) The structure is subject to structural & ground conditions subject to soil investigation or if any, on site. 94) The structure is subject to structural & ground conditions subject to soil investigation or if any, on site. 95) The structure is subject to structural & ground conditions subject to soil investigation or if any, on site. 96) The structure is subject to structural & ground conditions subject to soil investigation or if any, on site. 97) The structure is subject to structural & ground conditions subject to soil investigation or if any, on site. 98) The structure is subject to structural & ground conditions subject to soil investigation or if any, on site. 99) The structure is subject to structural & ground conditions subject to soil investigation or if any, on site. 100) The structure is subject to structural & ground conditions subject to soil investigation or if any, on site.

3BHK TYPE - 1
BLOCK - A UNIT NO - 3 & 4



3BHK TYPE - 2
BLOCK - A UNIT NO - 1 & 2
BLOCK - B UNIT NO - 1 & 4

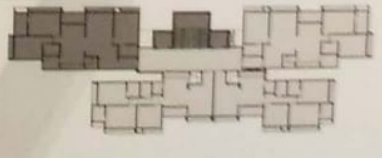



Basket ball & mini golf area



children play area & senior sit out

LEGEND

- 1 Green Gym
- 2 Toddler For Tiny Tots
- 3 Telescope
- 4 Seating
- 5 Chess Board Seating
- 6 Artificial Lawn

TERRACE PLAN



shubh aashish

ELEGANT TROPICAL
DESIGN AND AMBIANCE.



tennis court & jain derasar



entry passage



TYPICAL FLOOR PLAN



BASMENT PLAN

LEGEND

- 1 Main Entrance
- 2 Security Gate
- 3 Drop off zone with service road
- 4 Open Area
- 5 Bicycle parking
- 6 Store
- 7 Landscaping Area
- 8 Main gate
- 9 Basement car
- 10 Service
- 11 Open area
- 12 American Basketball
- 13 Security Office

GROUND FLOOR PLAN

THE LIFE THAT'S EXACTLY RIGHT FOR YOU.



Resting upon an overlooking and beautiful place, Shujibi Apartment is blessed with a spellbinding atmosphere. This splendid, contemporary styled property presents three bedrooms, a wide choice of indoor and outdoor living and dining areas, broad balconies, making it ideal for your family life.



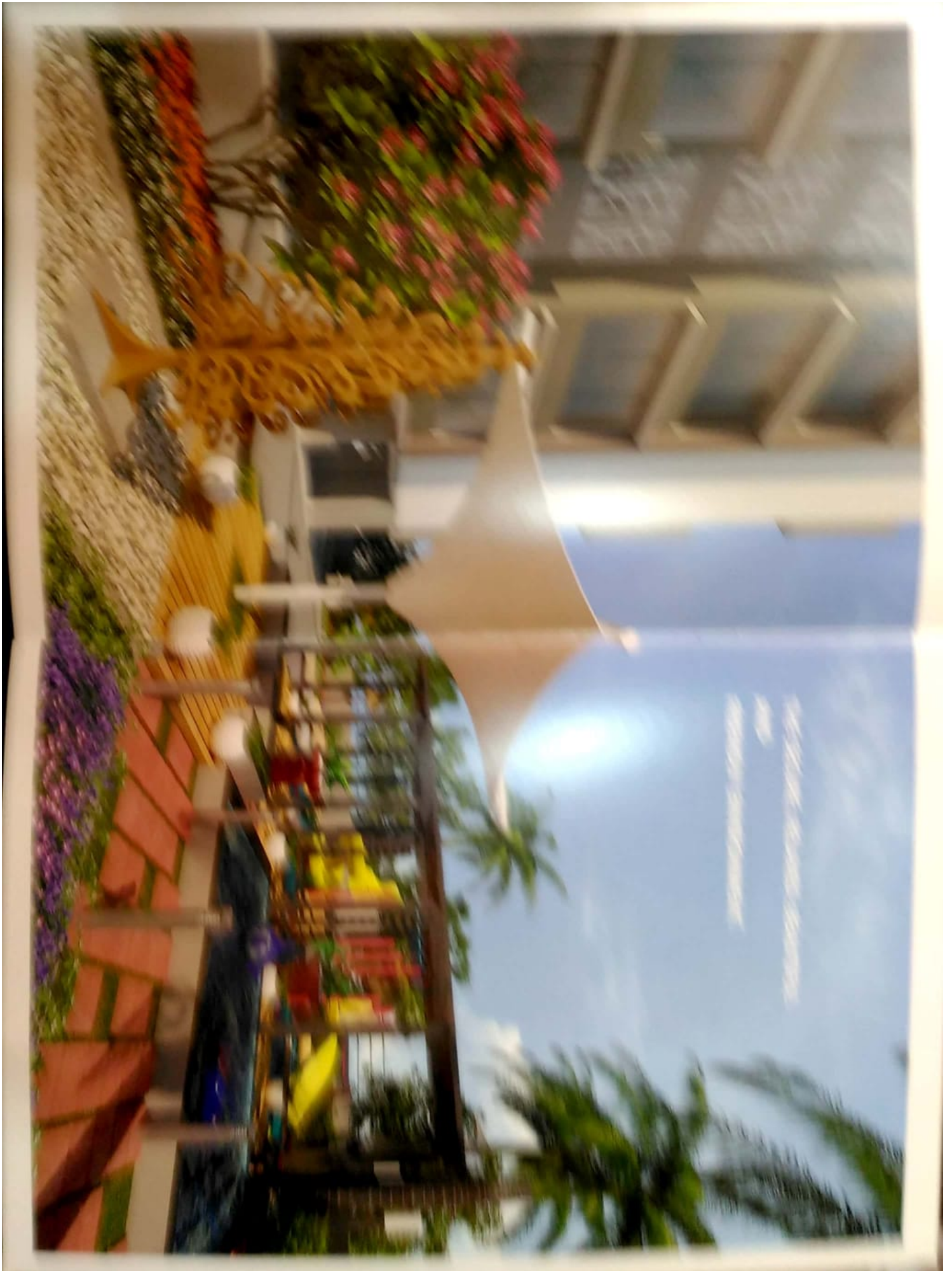

our project team :



HHRISHABH BHATT | developer

Mr. Hrishabh Bhatt, who envisioned a success story waiting to take shape in the form of a concrete raft. Since the formation of Shubh Group he's grown swiftly to become one of Gujarat's leading property investors, helping shape the skyline across the Residential sector. Mr. Bhatt, with his blend of knowledge and vision built the dreams of people. The high standards and an unyielding pursuit for excellence has led to the creation of an extensive portfolio of world-class residential spaces.



PARESH PATEL | developer

Mr. Paresh Patel has nurtured the group into one of the country's most respected residential projects with a globally recognized clientele and numerous national and international awards to its credit. His bottom-up organizational design approach worked wonders for business development, strategic planning, diversification and project management along with all other key executive functions.



VAISHAKHEE SHUKLA | designer

Shubh Aashish is a step in the arena of real estate in Rajiv, Ahmedabad by the SHUBH GROUP. The building is designed with a constant efforts to create a luxurious ambience, wedding a contemporary aesthetic with practical ease. It is designed to offer a spectacular view of the city's skyline — changing ever so often because of new constructions — supported by large windows. The long and narrow dimensions of the units have been balanced by opening up and brightening the internal spaces that offers warm ambience along with a visually pleasing spaces. Facades are treated to render an interesting mass dominated by white and a shades of grey palettes that stands out in its neighborhood.



LOKENDRA BALASARIA | architect & landscape designer

We would love this project to be a very green, peaceful and spiritual place. A living place that is more than just a living place - in sense, it should give joy good health through its environment and amenities like splash pool, gym equipments, badminton, basketball, badminton etc. Looking forward to a beautiful project.

SHUBH AASHISH
HAS
ALL IT TAKES
TO
MAKE YOUR
LIFE
UNFORGETTABLE.



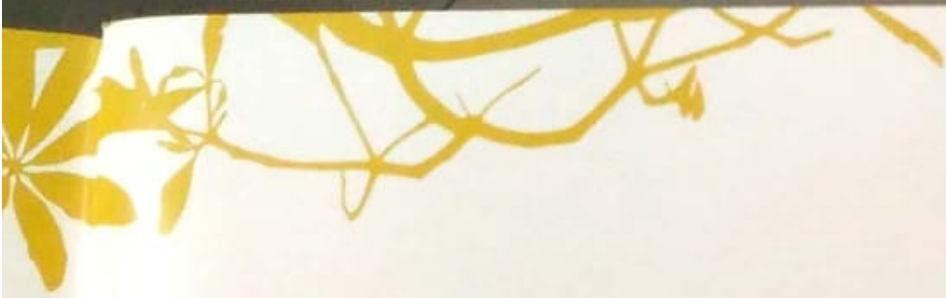

shubh  **aashish**
3 BHK
SPIRITUAL PLACE

DEVELOP BY
 **Shubh Group**