



WHERE EACH DAY LIVES BECOMES YOUR MEMORY...
1&2 BHK LIFE STYLE LIVING



Siddhi

VINAYAK
residency

TYPICAL FLOOR PLAN

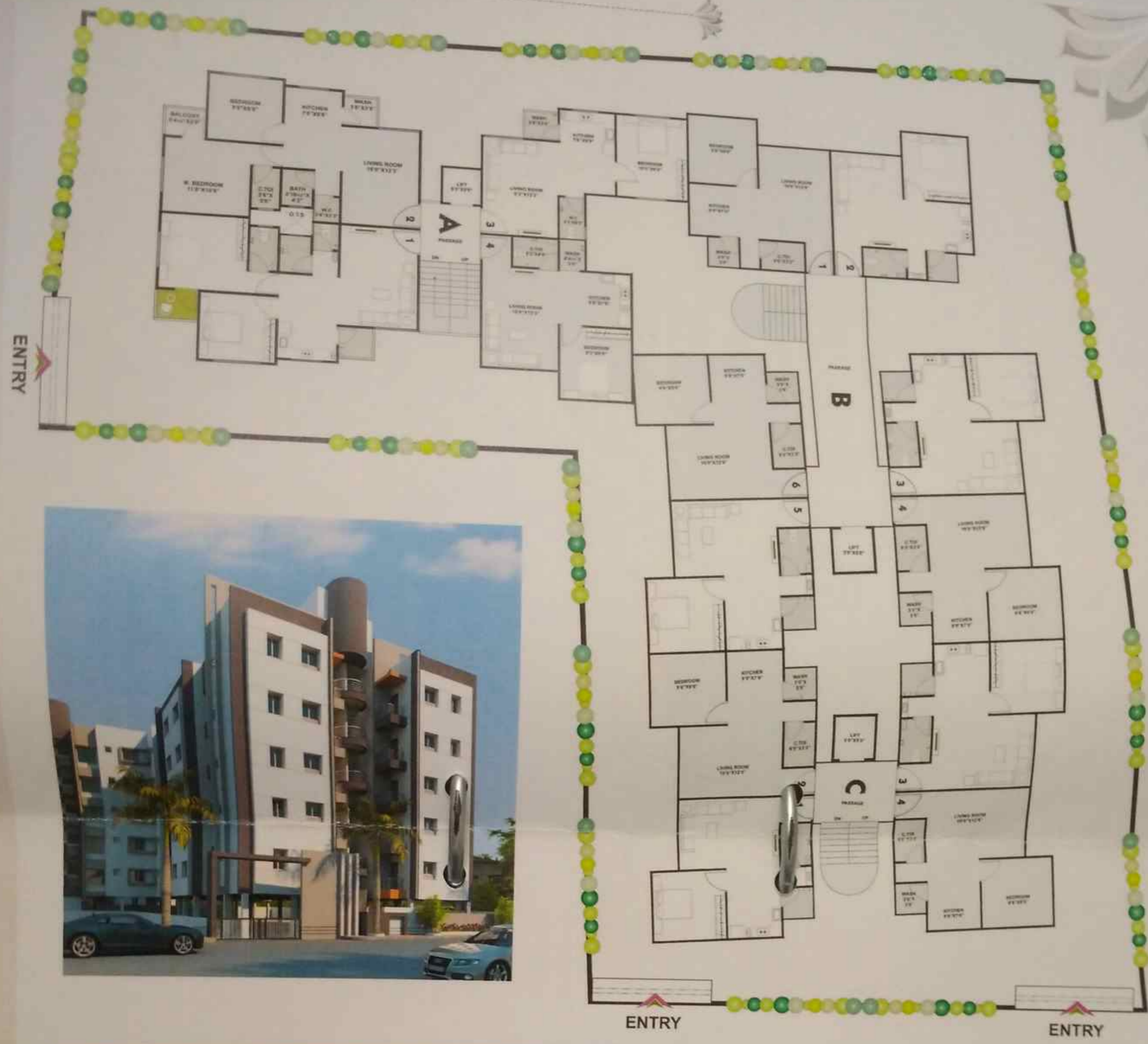

AMENITIES

Flooring
Granamite tiles 24" x 24" good quality in all rooms.

Kitchen
Granite kitchen platform with S.S. Sink, Glazed tiles dado up to lintel level above platform & wash area 3' height.

Door
Attractive main door in salwood frame, good quality flush doors and Decorative laminate sheet in main door with good quality fitting & fixtures in all room.

Electrification
Sufficient points with concealed wiring in standard (ISI) accessories & Modular switch board, T.V. & telephone point in living room & A.C. Point in master bedroom. Domestic points for refrigerator, washing machine & grinder.

Plumbing
Concealed plumbing work with good quality pipes & fitting of a standard company.

Window
Aluminum section sliding windows with powder coating & marble windows sill.

Toilet
Good quality glazed tiles dado up to full level.

Colour Work
White Putty on interior surface & texture colour on exterior walls.

PLEASE NOTE :
Legal, GE8, water/drainage/taxes (service tax, VAT - if applicable) and building maintenance extra. Internal and external changes will not be allowed. It is subject to change as per the developers rights. All details in this booklet are for easy information purpose only and cannot be form part of any agreement. Monetary and legal matters are subjected to the Surat jurisdiction.

LOCATION PLAN



SITE ADDRESS
Khadi Mahallo, Nr. Green City, Bhatha, Surat
BOOKING CONTACT - 98985 77899