



Finest Budget Homes in Surat **1-2 BHK Apartments**





Green  
**Tulip**  
Residency



## A New Home Means Aspiration









## A New Perspective to City Living







Tulip  
Club



## Lifestyle Amenities



**Club House** - Multipurpose hall for Functions and Parties, Cardio Gym and Indoor games



**Central Lush Green garden** - Party lawn, yoga park, Water body and Senior citizen seating area with gazebo



**Children's Park** - Swings, slide, seesaw etc.



**Outdoor Games** - Half Basketball Court





# PROJECT LAYOUT

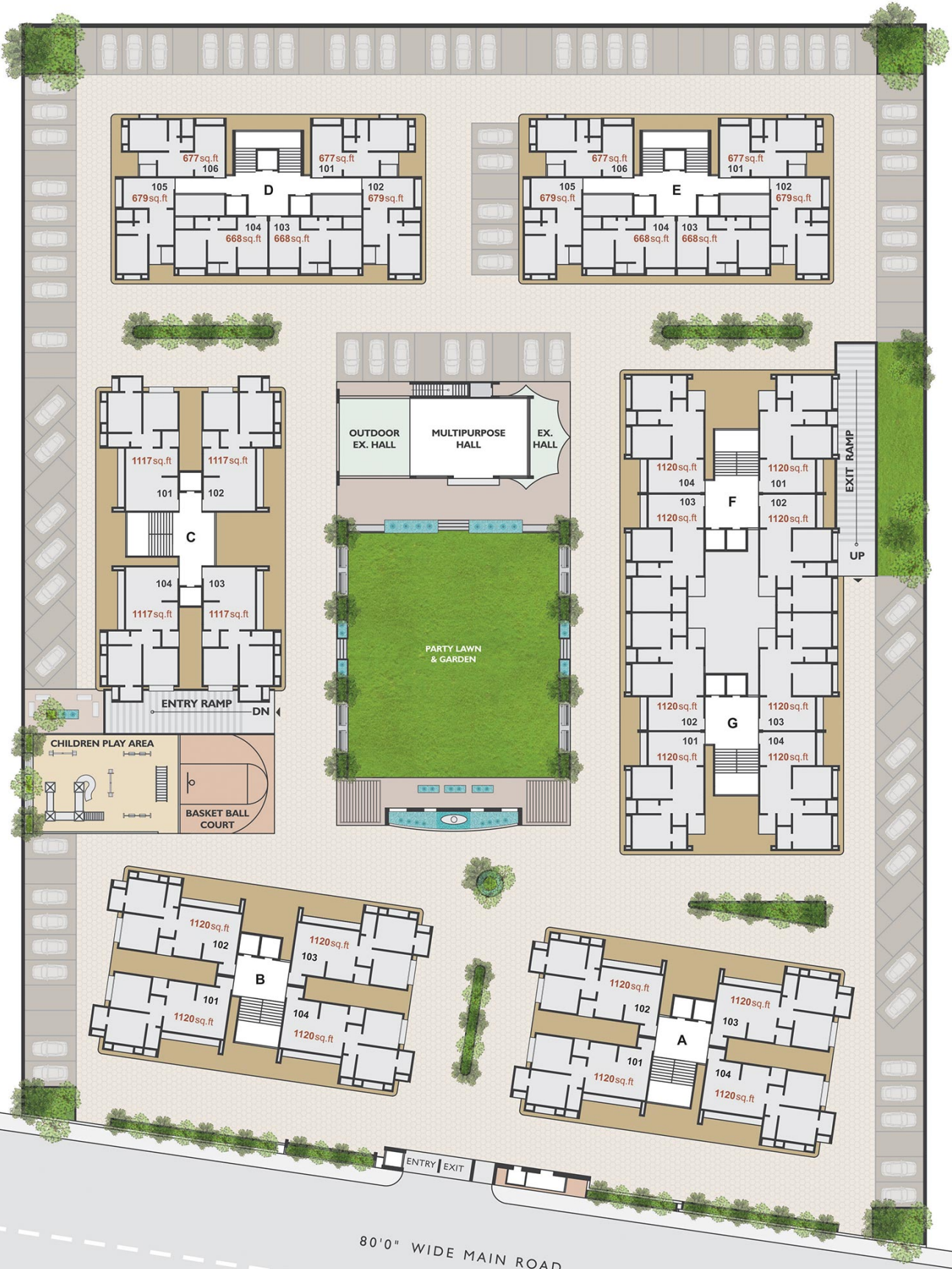

80'0" WIDE MAIN ROAD



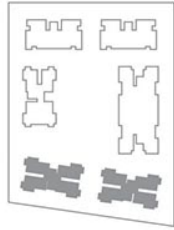

# WING A-B

## TYPICAL FLOOR - 2 BHK

Flat No.	101, 102 103, 104
Super Built Up	1120.00 sq.ft
Carpet Area	643.47 sq.ft





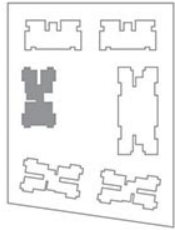

# WING C

## TYPICAL FLOOR - 2 BHK

Flat No.	101, 102 103, 104
Super Built Up	1117.00 sq.ft
Carpet Area	642.18 sq.ft





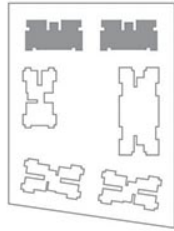

# WING D-E

## TYPICAL FLOOR - 1 BHK

Flat No.	101, 106	102, 105	103, 104
Super Built Up	677.00 sq.ft	679.00 sq.ft	668 sq.ft
Carpet Area	388.90 sq.ft	390.30 sq.ft	383.74 sq.ft





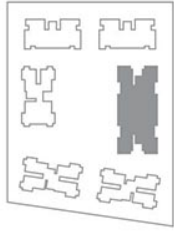

## WING F-G TYPICAL FLOOR - 2 BHK

Flat No.	101, 102 103, 104
Super Built Up	1120.00 sq.ft
Carpet Area	644.12 sq.ft





## Specifications

---

**Flooring** - Granamite tiles of 24"x 24" in the living room, kitchen, dining room and other areas of the house; Vitrified tile flooring in the common passage.

**Kitchen / Store** - Granite top kitchen platform with S.S. sink and Glazed tile dado up to the lintel level with adequate Kota stone shelves in the store room.

**Toilet / Plumbing** - Glazed tiles dado up to the lintel level with exclusive design in all toilets; Concealed plumbing with standard quality sanitary wares and C.P. fitting; Corrosion-free CPVC / UPVC pipes; Hot water supply pipelines from the wash area to all toilets; Fresh water supply in the kitchen and in all toilets, except for in the flush cock and bib cock.

**Doors** - Well Designed main door and others are flush doors with wooden frame, Toilet & Wash doors are in granite frame. S.S C.P. hardware fittings.

**Windows** - Sliding Aluminum section powder coated with a single vision reflective glass window fixed on granite stone sill.

**Electrification** - Sufficient points in concealed wiring with modular range accessories. Domestic points for household appliances. TV points in living room and master bedroom. AC point in master bedroom.

**Interior / Exterior Finish** - Internal wall surface finish with JK / Birla white Lapi Exterior wall finished with 2 coat Mala plaster and water repellent acrylic emulsion.

## Campus Features

---

**Entrance Gate** - Gorgeous entrance with landscape, Bus pick-up stand and water sculpture; Well-designed security cabin at the entrance gate.

**Reception & Foyer** - Entrance foyer with a spacious reception and waiting lounge, benches for sitting and name plates.

**CCTV Facility** - CCTV camera security system at the main gate, the entrance foyer of each building, in the indoor games room, gymnasium and garden.

**Generator Facility** - Common generator for lift, water pump and common passage.

**Parking Facility** - Ample parking space on the ground level; Basement parking with separate exit and entry ramps for vehicles.

**Compound Wall** - Well-designed compound wall around the campus.

**Road** - Well-designed paver blocks / RCC road

**Structure** - Design as per latest revised earthquake code of ISO 2016 with red bricks construction.

**Water Tank** - Underground and overhead water tanks of sufficient capacity with fully glazed tile dado in each building.

**Lift** - Two auto-door elevators in each building.

**Water Supply** - Bore water for domestic use of each flat & common amenities of project.





## Key Plan

**SURAT RAILWAY STATION 10 K.M.  
CABLE BRIDGE 7 K.M.**

Project Location : Green Tulip, TP 30, F.P. 78, Block no. 83, Vanakala – Canal Road, Surat, Gujarat.

### Architect & Landscape



### Structure Consultants



**DISCLAIMER :** This is not an offer or an invitation to offer. Designs, Costs, Facilities, Plans and Specifications in static and/or interactive publicity material depict anticipated appearance of completed development and are subject to change without notice. We have taken every care to prepare this entire literature. However, this by itself shall not create any liabilities/obligations whatsoever contractual or otherwise on Green Group.



A PROJECT BY



S I N C E 1 9 8 3  
D E V E L O P E R S

**PROMOTER**

**SRUSHTI BUILDWELL LLP**

**For More Details : 0908 1077 758**

**crm@greengroup.co.in | www.greengroup.co.in**

---

**RERA NO. - PR/GJ/SURAT/CHORASI/SUDA/RAA01437/290118**

**www.gujrera.gujarat.gov.in**