



BASIL  
**CHANDRAKANT**  
RESIDENTIAL & COMMERCIAL

THE NEST OF HAPPINESS

# THE NEST OF HAPPINESS

Like the nest, this place is created with all necessities that are required to enrich relations. Your family will experience new dimensions of relations in these homes.



BASIL  
**CHANDRAKANT**  
RESIDENTIAL & COMMERCIAL





BASIL  
**CHANDRAKANT**  
RESIDENTIAL & COMMERCIAL

## 1 & 2 BHK HOMES

These spaces are nicely-designed well-contented residences to impart an experience of complete living. Every room is a wise craft of ventilation, amenities, and the highest space utilization.



**2 BHK Apartment**

- A. Entrance Lobby
- B. Living & Dining
- C. Kitchen
- D. Dry Balcony
- E. Common Toilet

- F. Attached Toilet
- G. Master Bedroom
- H. Master Bedroom Balcony
- I. Common Bedroom
- J. Balcony

# SPECIFICATIONS

## STRUCTURE & MASONRY

- Earthquake Resistant RCC frame structure
- 5" thick Fly Ash Bricks/Siporex work Internally & Externally
- External wall Artificial sand-face double layer plaster
- Internal wall Gypsum Finish over Cement Plaster & Ceiling in Gypsum Finish

## ELECTRICAL

- Adequate Electrical points in all rooms, Concealed copper wiring with MCB
- Electrical provision for split A/C point in Master Bedroom
- T.V. point in Living Room and Master Bedroom with DTH cabling work
- Exhaust fan points provision in Kitchen and Toilet
- Water purifier point provision in Kitchen
- Washing Machine point provision in Dry Balcony
- Invertor point provision
- Electrical Charging Point provision for Electrical Vehicles in common areas

## PLUMBING

- Concealed Plumbing in CPVC Pipes
- Branded make CP fittings in Kitchen & Toilets
- Branded bathroom sanitary ware fittings
- Provision for washing machine point in dry balcony (inlet and outlet)
- Brick Bat / Chemical double coat waterproofing in Toilets, Terrace & Dry Balcony
- Provision for Geyser points in bathroom
- Solar water for Common Toilet

## KITCHEN

- Granite kitchen platform with stainless steel sink
- Dado tiles up to lintel level
- Separate water connection for drinking & domestic water

## FLOORING

- Vitrified tile flooring in each flat
- Dado tile up to lintel level in all toilets
- Ceramic flooring in toilets, terrace, and dry balcony
- Chequered tiles/Trimix in parking areas

## DOOR & DOOR FRAMES

- Attractive main door with Premium quality fittings and fixtures
- All internal room door frames in decorative pine wood door
- Toilet door frame in granite
- Waterproof flush doors in toilets
- Premium SS finish door fittings
- Powder-coated French Door opening for terrace

## WINDOWS

- Granite window sill for all windows
- 3 Track powder-coated aluminum sliding windows with mosquito mesh & louvered windows for toilets
- MS grills for windows

## PAINTINGS, GRILLS & RAILINGS

- Oil bond distemper for all internal walls
- Apex paint for all external wall
- Oil Painted MS safety grills
- MS railing for terrace

# 1ST & 2ND FLOOR PLAN

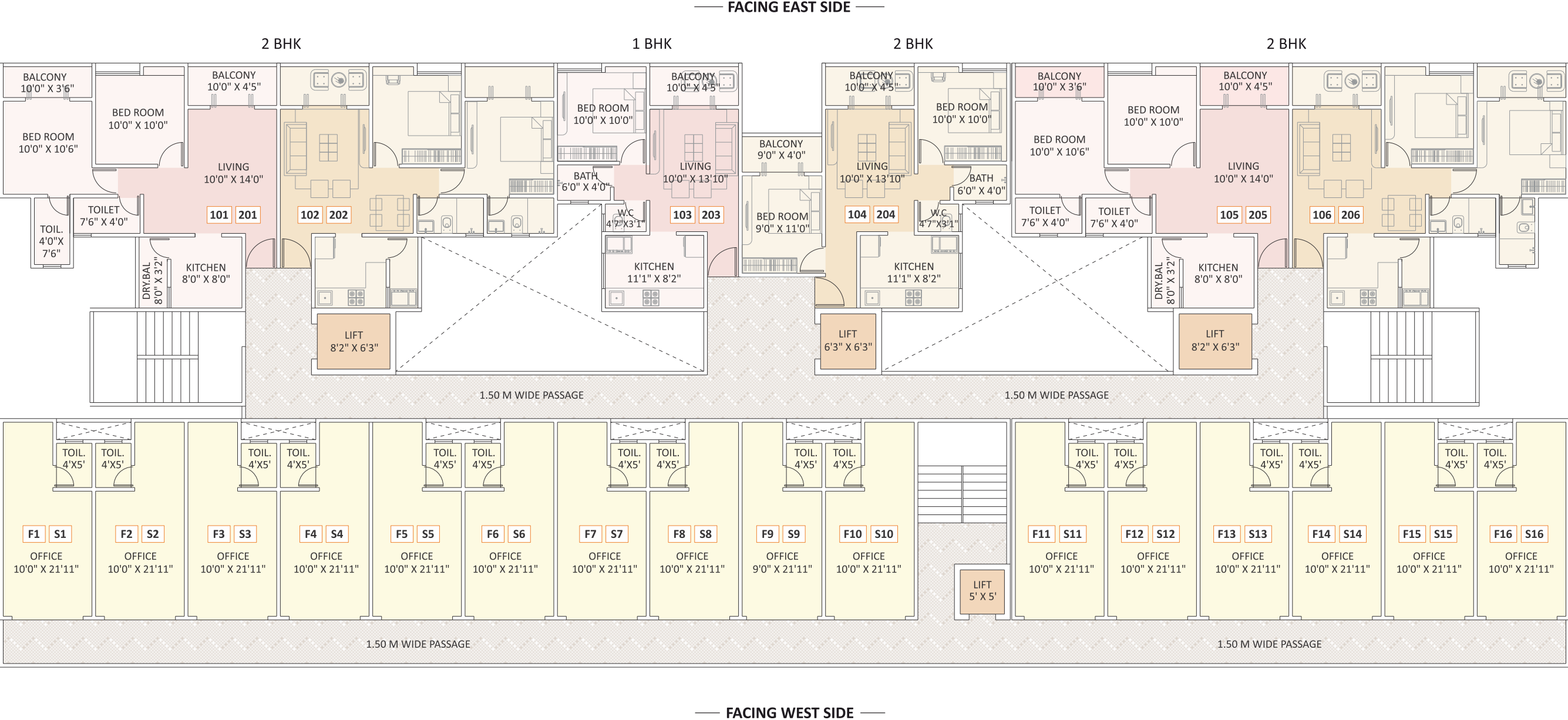

AREA STATEMENT

| OFFICE NO.  | TOTAL CARPET (SQ.M.) | TOTAL CARPET (SQ.FT.) | TOTAL SALEABLE 50% (SQ.FT.) |
|---|----------------------|-----------------------|-----------------------------|
| F1,S1 / F2,S2 / F3,S3 / F4,S4 / F5,S5 / F6,S6<br>F7,S7 / F8,S8 / F10,S10 / F11,S11 / F12,S12<br>F13,S13 / F14,S14 / F15,S15 / F16,S16 | 19.67                | 212                   | 318                         |
| F9,S9   | 17.60                | 189                   | 284                         |

AREA STATEMENT

| FLAT NO.          | TYPE  | CARPET AREA (SQ.M.) | OPEN BALCONY AREA (SQ.M.) | TOTAL CARPET (SQ.M.) | TOTAL CARPET (SQ.FT.) | SALEABLE 38% (SQ.FT.) |
|-------------------|-------|---------------------|---------------------------|----------------------|-----------------------|-----------------------|
| 101,201 / 106,206 | 2 BHK | 54.00               | 9.67                      | 63.67                | 685                   | 946                   |
| 102,202 / 105,205 | 2 BHK | 54.13               | 9.67                      | 63.80                | 687                   | 948                   |
| 104,204           | 2 BHK | 51.68               | 7.41                      | 59.09                | 636                   | 878                   |
| 103,203           | 1 BHK | 39.85               | 4.07                      | 43.92                | 473                   | 652                   |

# 4TH, 5TH, 6TH & 8TH FLOOR PLAN

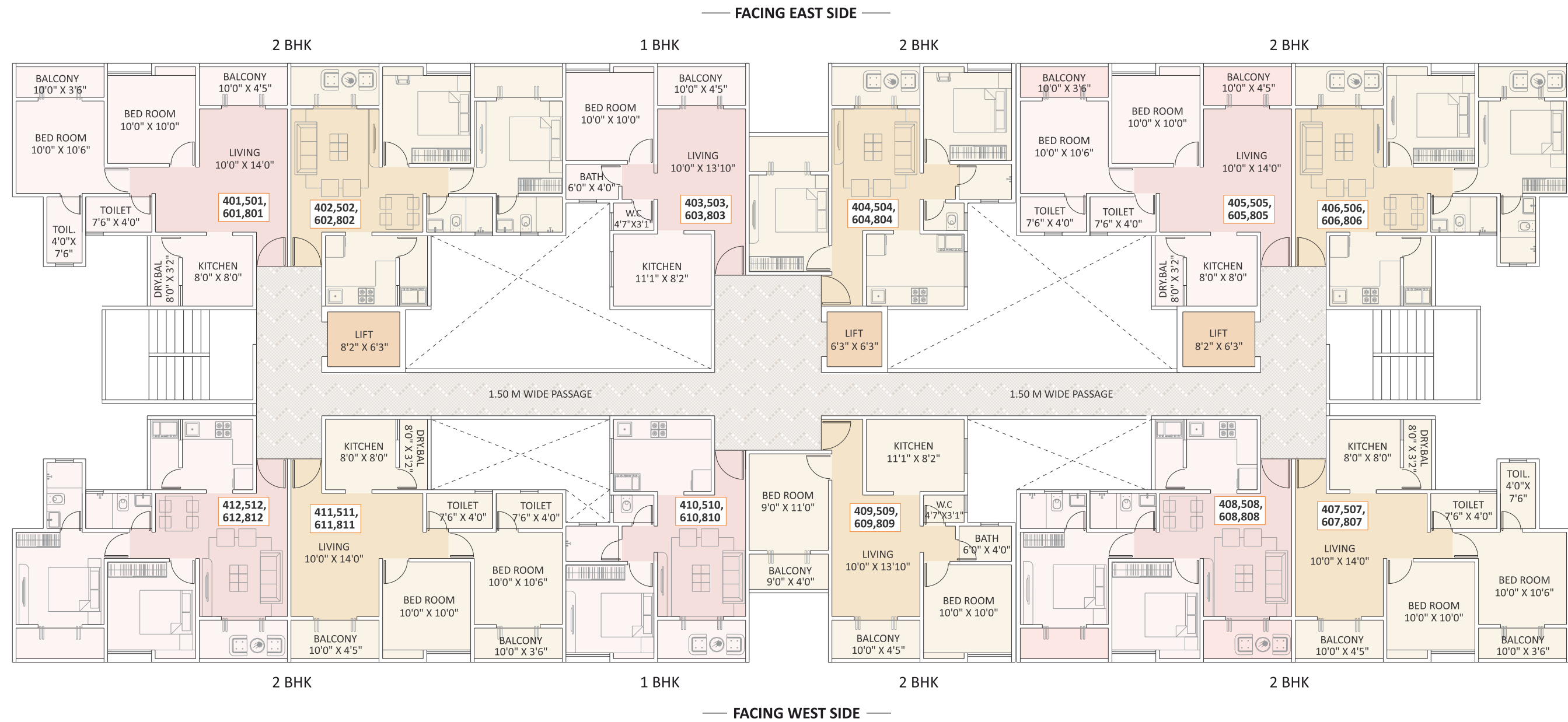

### AREA STATEMENT

| FLAT NO.   | TYPE  | CARPET AREA ( SQ.M. ) | OPEN BALCONY AREA ( SQ.M. ) | TOTAL CARPET ( SQ.M. ) | TOTAL CARPET ( SQ.FT. ) | SALEABLE 38% ( SQ.FT. ) |
|--|-------|-----------------------|-----------------------------|------------------------|-------------------------|-------------------------|
| 401,501,601,801 / 407,507,607,807                                      | 2 BHK | 54.00                 | 9.67                        | 63.67                  | 685                     | 946                     |
| 402,502,602,802 / 405,505,605,805<br>408,508,608,808 / 411,511,611,811 | 2 BHK | 54.13                 | 9.67                        | 63.80                  | 687                     | 948                     |
| 404,504,604,804 / 409,509,609,809                                      | 2 BHK | 51.68                 | 7.41                        | 59.09                  | 636                     | 878                     |
| 406,506,606,806 / 412,512,612,812                                      | 2 BHK | 54.00                 | 9.67                        | 63.67                  | 685                     | 946                     |
| 403,503,603,803 / 410,510,610,810                                      | 1 BHK | 39.85                 | 4.07                        | 43.92                  | 473                     | 652                     |





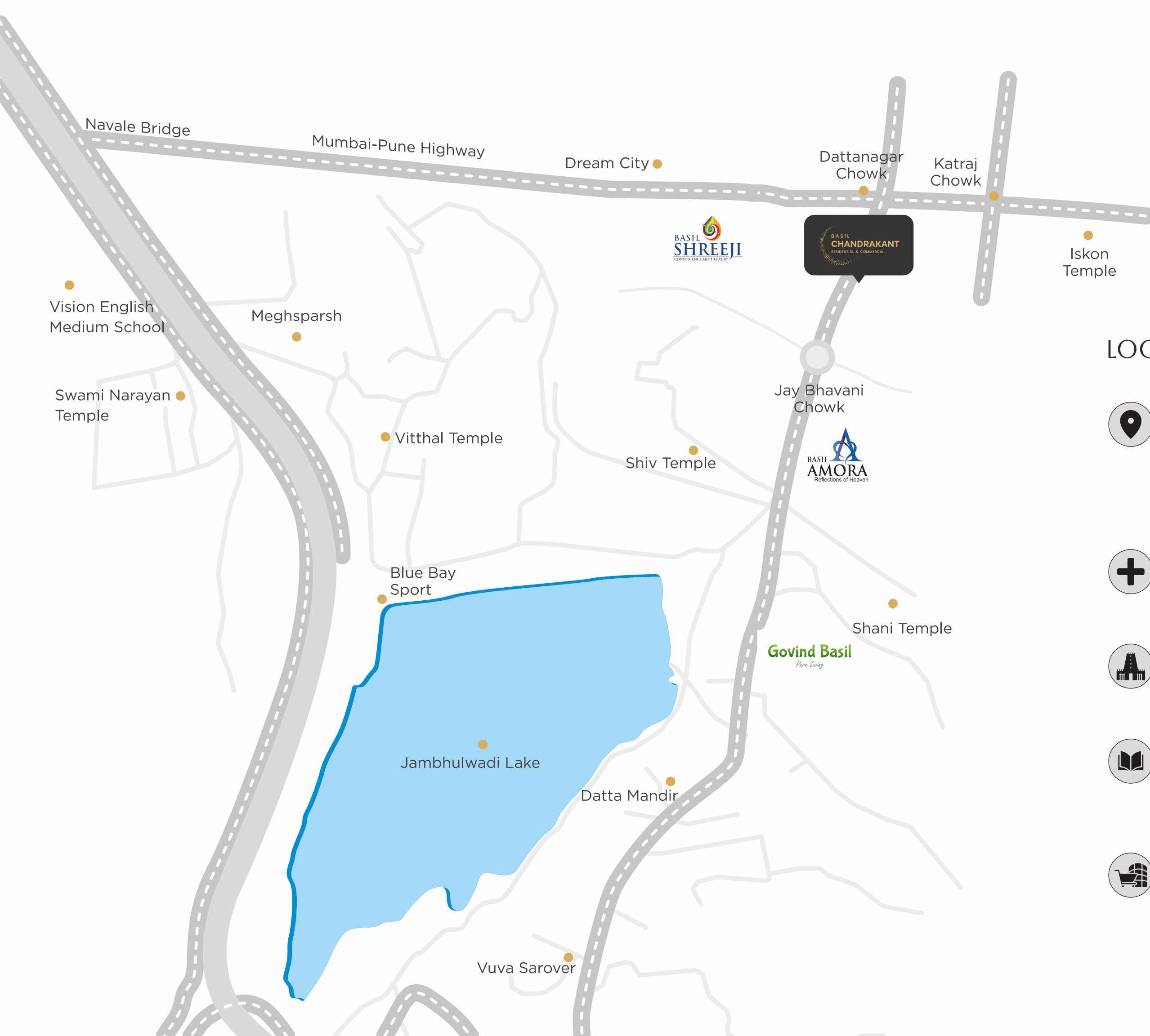

## LOCATION MAP



### Connctivity

- Jambhulwadi Lake - 0.8 km
- Pune Bangalore Highway - 0.7 km
- Katraj Bus Stand - 1.5 km
- Swargate Bus Stand - 7.2 km
- Chandani Chowk - 11.3 km



### Hospital

- Bharti Hospital - 2.6 km
- Navale Hospital - 4.2 km



### Temple

- Swami Narayan Temple - 3.4 km
- Iskon Temple - 4.3 km



### School

- Podar International School - 2.5 km
- Singhgad Institute of Technology - 3.5 km
- Aryans World School - 4 km



### Entertainment & Shopping

- MacDonald - 1.1 km
- Dmart - 1.3 km
- Rajiv Gandhi Zoological Park - 3 km
- Fun-Time Multiplex - 5.3 km
- Abhiruchi Mall - 5.1 km



**Call - 77 7009 2727 / 78 2900 2900**

Site Address: Sr. No. 45, Ambegaon (BK), Dattanagar, Pune - 411046

W: [www.basilgroup.co.in](http://www.basilgroup.co.in) | E: [basilchandrakant45@gmail.com](mailto:basilchandrakant45@gmail.com) | Follow us on :



MahaRERA Registration No.: P52100047305  
<http://maharera.mahaonline.gov.in>

This is not an offer, an invitation to offer and/or commitment of any nature. This contains artistic impressions and stock images for illustrative purpose and no warranty is expressly or impliedly given that completed development will comply in any degree with such artist's impression as depicted. All specifications of the flat shall be as per the final agreement between the Parties. Recipients are advised to use their discretion in relying on the information/amenities described/shown therein.

**CREDAI**

